

SAFETY INFORMATION

Before using this product, read the following safety instructions and follow all usual safety precautions. Any operation inconsistent with these instructions may result in damage to this product.

! ATTENTION

- 1. Only authorised technicians can disassemble this product. It is not recommended to disassemble the product by yourself.
- 2. Do not touch the battery compartment/USB port/power cord when your hands are wet/port/power cord when your hands are wet.
- 3. Keep the product away from cigarettes, lighters and other open flames, other open flames.
- 4. Do not bend the cables excessively, or place heavy and sharp objects on the machine. Sharp objects on the machine.
- 5. Do not use the product in wet environments (e.g., bathrooms).
- 6. Remove the battery from the machine before disposal.
- 7. When removing the battery, please ensure that the product is not connected to the power supply. When removing the battery, please ensure that the product is not connected to the power supply.
- 8. Please recycle the battery safely.

! WARNING

- 1. Do not use the product in an environment with open flames or fragile products. It is prohibited to use the product in an environment with open flames or fragile products.
- 2. It is prohibited to use the product in extremely hot (above 40 °C) or cold (below 0 °C) environments. It is prohibited to use the product in extremely hot (above 40 °C) or extremely cold (below 0 °C) environments.
- 3. It is prohibited to use the product on wet or waterlogged surfaces. Use of the product on wet or waterlogged floors is prohibited.
- 4. Even if the product has been severely damaged, it is prohibited to burn the product. It is prohibited to burn the product even if it has been severely damaged, as the product battery may explode. The battery of the product may explode as a result.
- 5. After unpacking, keep all packaging materials out of the reach of children. Keep all packaging materials out of the reach of children. Do not allow children to play with the children to play with the packaging materials to avoid accidental swallowing and choking to avoid accidental swallowing and choking.
- 6. Batteries should not be disassembled, struck, crushed or thrown into fire. If there is serious swelling, do not continue to use the battery. Do not use the batteries if they are severely inflated. Do not put it in high temperature environment, and do not use it after the battery is immersed in water! Do not use the battery after it has been immersed in water!

Name	Lenovo xiaoxin bt silent mouse m1
Model	Xm200
Size	(L)106.8*(w)62.7*(h)41mm
Weight	≈67g
Rated input	1.5v=20ma
Connection type	Bluetooth5.0
Pushbutton	5key+1wheel
Resolution	800/1200(default)/1600
Product standard	Qi/hdics0083-2016
System compatibility	Windows7/8/8.1/10/mac os

4

Note: The picture is for reference only, the product shall prevail in kind .

Thinkplus WL300 Bluetooth Silent Mouse



Note: Please read this document thoroughly before installing and using the product and keep it in a safe place.

Lenovo

CATALOGUE

Product Composition	2
Product Functions	2
Safety Information	4
Basic Parameters	4

Product composition (package contents)



Product Features

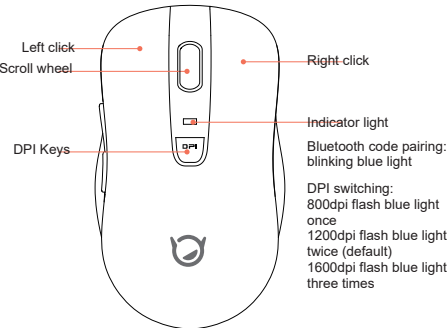

Product Features

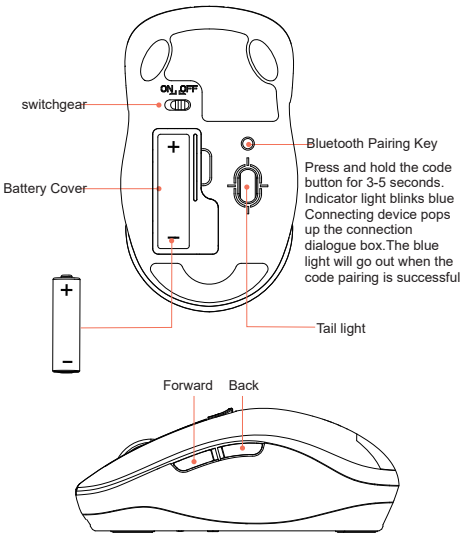

FCC Compliance Statement

Note: This equipment has been tested and found to comply with the limits for a Class B digital device, pursuant to part 15 of the FCC Rules. These limits are designed to provide reasonable protection against harmful interference in a residential installation. This equipment generates, uses and can radiate radio frequency energy and, if not installed and used in accordance with the instructions, may cause harmful interference to radio communications. However, there is no guarantee that interference will not occur in a particular installation. If this equipment does cause harmful interference to radio or television reception, which can be determined by turning the equipment off and on, the user is encouraged to try to correct the interference by one or more of the following measures:

- Reorient or relocate the receiving antenna.
- Increase the separation between the equipment and receiver.
- Connect the equipment into an outlet on a circuit different from that to which the receiver is connected.
- Consult the dealer or an experienced radio/TV technician for help.

Lenovo is not responsible for any radio or television interference caused by using other than recommended cables and connectors or by unauthorized changes or modifications to this equipment. Unauthorized changes or modifications could void the user's authority to operate the equipment.

This device complies with Part 15 of the FCC Rules. Operation is subject to the following two conditions: (1) this device may not cause harmful interference, and

(2) this device must accept any interference received, including interference that may cause undesired operation.

Responsible Party:
Lenovo (United States) Incorporated
7001 Development Drive
Morrisville, NC 27560
Email: FCC@lenovo.com
Industry Canada Compliance Statement
CAN ICES-003(B) / NMB-003(B)

This device contains licence-exempt transmitter(s)/receiver(s) that comply with Innovation, Science and Economic Development Canada's licence-exempt RSS(s). Operation is subject to the following two conditions: (1) This device may not cause interference. (2) This device must accept any interference, including interference that may cause undesired operation of the device.

Le présent appareil est conforme aux CNR d'Industrie Canada applicables aux appareils radio exempts de licence. L'exploitation est autorisée aux deux conditions suivantes : (1) l'appareil ne doit pas produire de brouillage, et (2) l'utilisateur de l'appareil doit accepter tout brouillage radioélectrique subi, même si le brouillage est susceptible d'en compromettre le fonctionnement.

This equipment complies with Industry Canada radiation exposure limits set forth for an uncontrolled environment. Cet équipement est conforme à l'exposition aux rayonnements Industry Canada limités établies pour un environnement non contrôlé.