

「QUICK START GUIDE」



Homebase KIT

Content

In the Box	02
Product Overview	04
Basic Parameters	06
Connect the Homebase to App	07
Connect Cameras to Homebase	15
Add Cameras to Homebase	17
Mount Your Camera	23
Notice	26
Customer Service	30

In the Box

After opening the box, please check the following pictures to see if the accessories are complete.

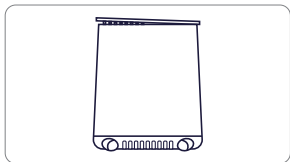

Homebase



Quick
Start Guide

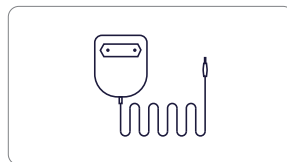

Power Adapter

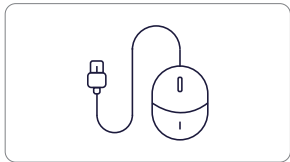

USB Mouse

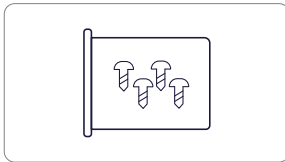

Hard Drive Screws

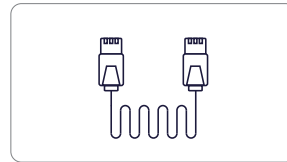

Network Cable
(Optional)

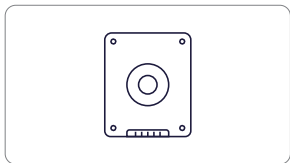

Hard Drive
(Optional)

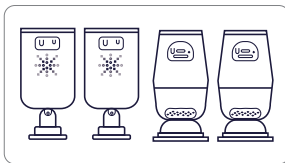

Add-On Cameras
(Optional)

Introduction

1. Effortless Installation

Connect up to 8 cameras without any cables. The homebase reduces the installation difficulty significantly compared with solo type cameras.

2. Seamless Monitoring

Support local decoding and HDMI display. View live streams in 10 areas at the same time on one monitor screen and implement a wireless security cameras system.

3. App Remote Control

Let you preview and control the cameras which had been added to homebase from the APP. The homebase also provides instant notifications and stable live view.

4. Local Storage

Support local HDD storage and TF card storage, which ensure ample and secure data recording with no extra costs. No additional subscription for cloud storage anymore.

Product Overview

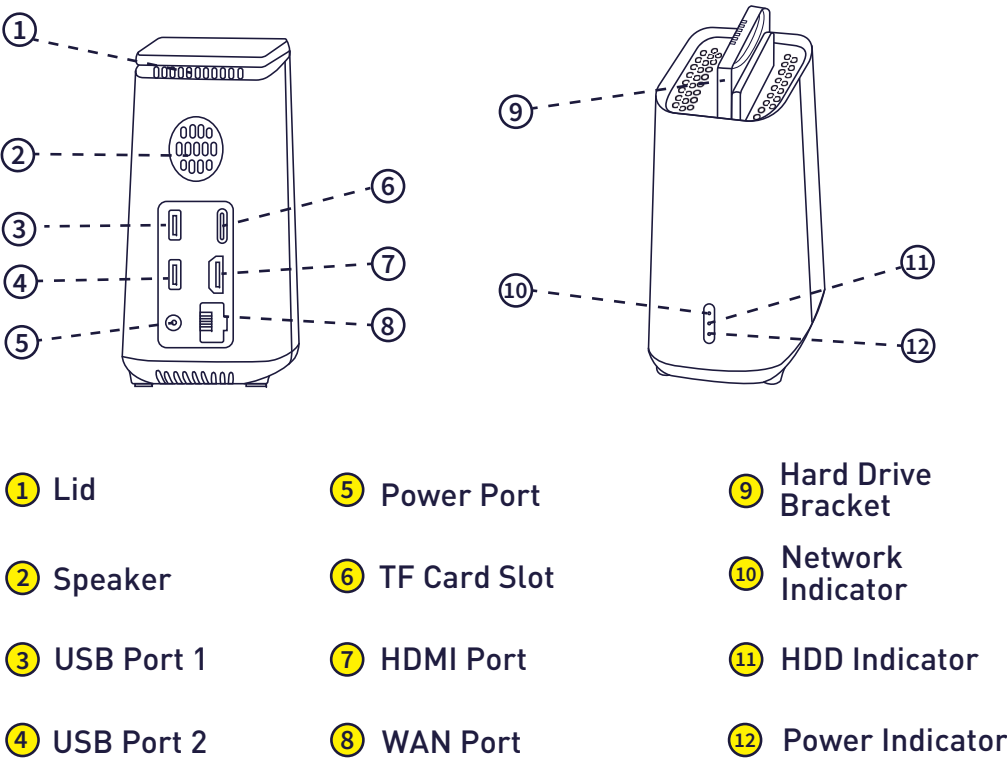

Type	Status LED	Description
Power Indicator	Solid on	Connected to power
	Fast Blinking	Failed to enter the system
	Slow Blinking	System upgrading
	Off	Not powered on
HDD Indicator	Solid On	Insert a TF card or hard drive, and work normally
	Fast Blinking	Formatting
	Off	No TF card or hard drive inserted
Network Indicator	Solid On	Homebase has been added and Network connected
	Slow Blinking	Network connected
	Off	No network connection

Basic Parameters

Max Number of Connection	8CH	HDMI Output	1280x720@60, 1280x1024@60, 1920x1080@60, 4K@30
Network	WiFi Station and AP+100Mbps Ethernet	Storage	4TB SSD or 2TB HDD, 512G TF Max
Power Supply	DC 12V-2A	Operating Temperature	-10°C~+50°C
Item Weight	414g	Product Dimensions	113.5(L)*70(W)* 141.5(H)mm

Connect the Homebase to App

There are two ways to connect Homebase to the App. If you have an Ethernet cable and can connect to the router, you can use Method 1. If you have a monitor and want to use wireless Wi-Fi, you can use Method 2. Go to Page 11.

Method 1: Ethernet Cable Connection

Step 1

Power on the Homebase, then use the network cable provided to connect the Homebase to your home router. The Network LED Indicator turns blue (this may take up to 1min) when Homebase is ready for setup.

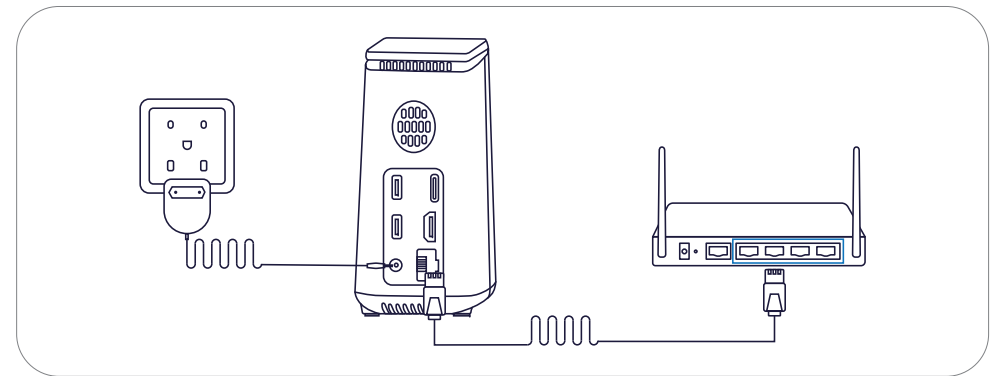

Step 2

Connect your phone to the same router that the Homebase is connected to.

Step 3

Download the Tuya Smart or Smart Life App from the Apple App Store or Google Play, or by scanning the QR code below.

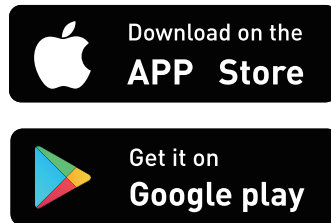

Step 4

1. Sign up an App account, go to the App homepage, tap the "+" button, then tap Add Device, and select the NVR.



Please make sure your phone and the Homebase connect to the same router.

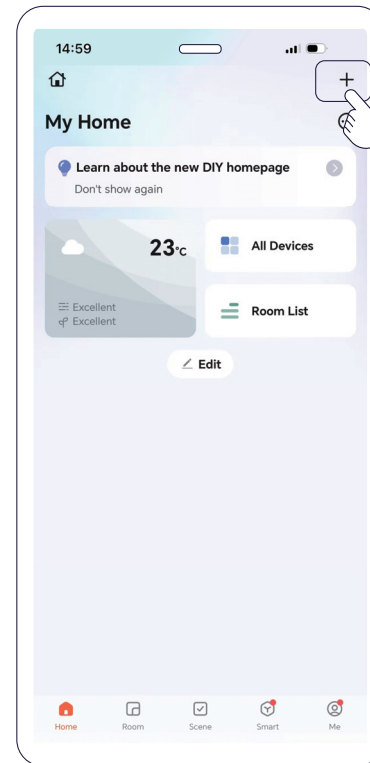

2. Follow the prompts of the App to complete the addition.

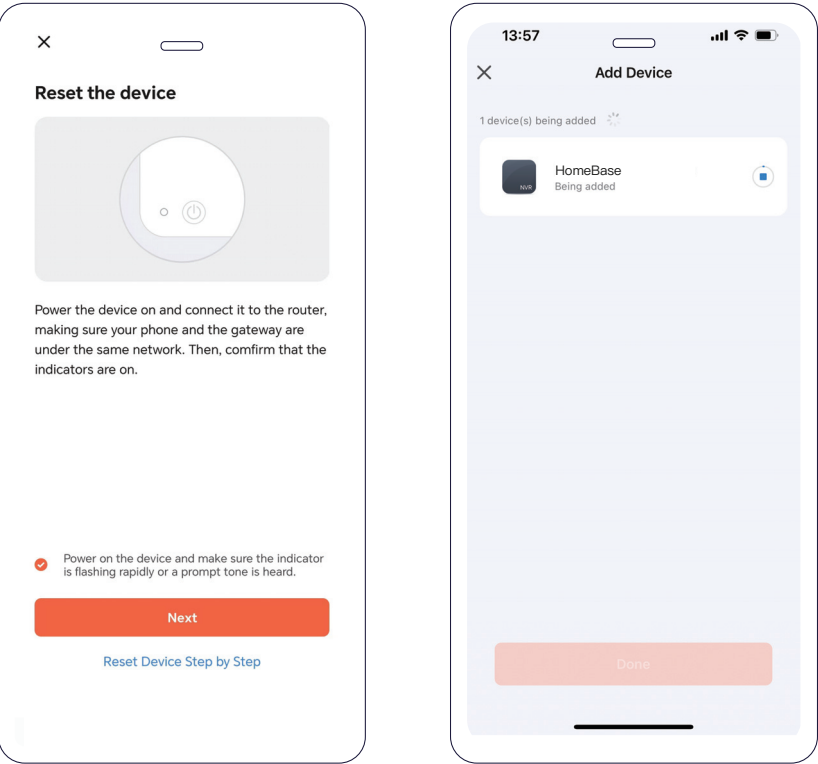

Method 2: Wireless Connection

Step 1

Power on the Homebase and connect the mouse to the USB port of the Homebase, then connect the Homebase to a monitor via an HDMI cable.

A line-art diagram illustrating the connection setup for the Homebase device. The Homebase is a vertical rectangular unit. A power cord is plugged into a wall outlet on the left. A mouse is connected to the top USB port of the Homebase. An HDMI cable is connected to the bottom port of the Homebase and the back of a monitor on the right. A dashed circle highlights the HDMI connection point on the Homebase, with the label "HDMI" next to it.

Step 2

There are two ways to connect your Homebase to the Internet :

Method 1: Use an Ethernet cable to directly connect your Homebase and router.

Method 2: Connect Homebase to the Wi-Fi network. As shown in the figure below, during initialization, select your Wi-Fi on the screen and enter the password to wait for the network to be successfully connected.

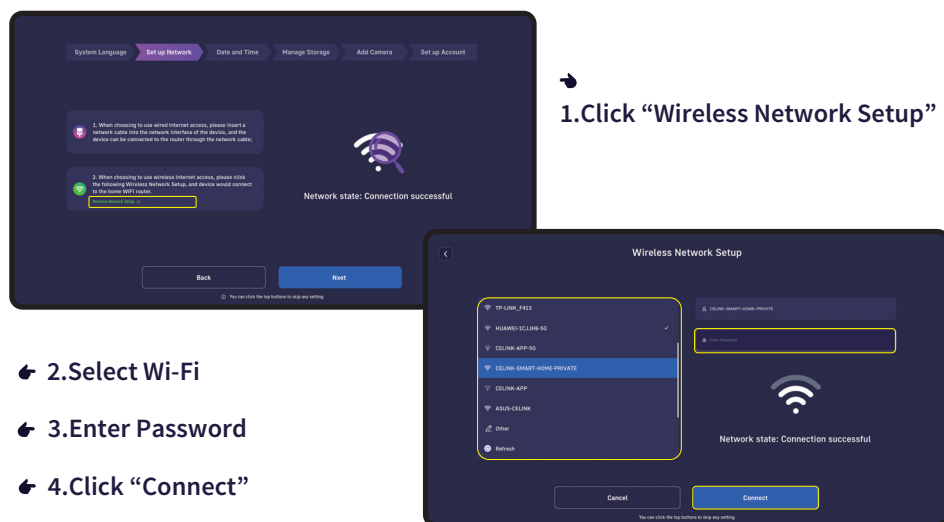

12

Step 3

1. After initialization, click the Settings button, and then click the 'Account/App' item after entering the Settings page.
2. Download the Tuya Smart or Smart Life App from the Apple App Store or Google Play, or scan the App QR code on the screen.

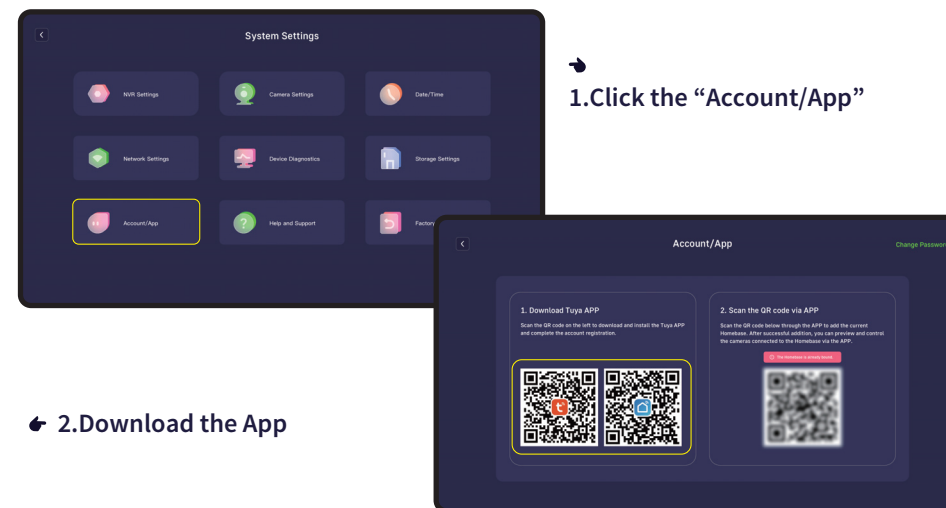

13

Step 4

Sign up an App account, go to the App homepage, tap the "+" button, then click the scan item to scan the QR code on the screen, and finally wait for the App to connect successfully.

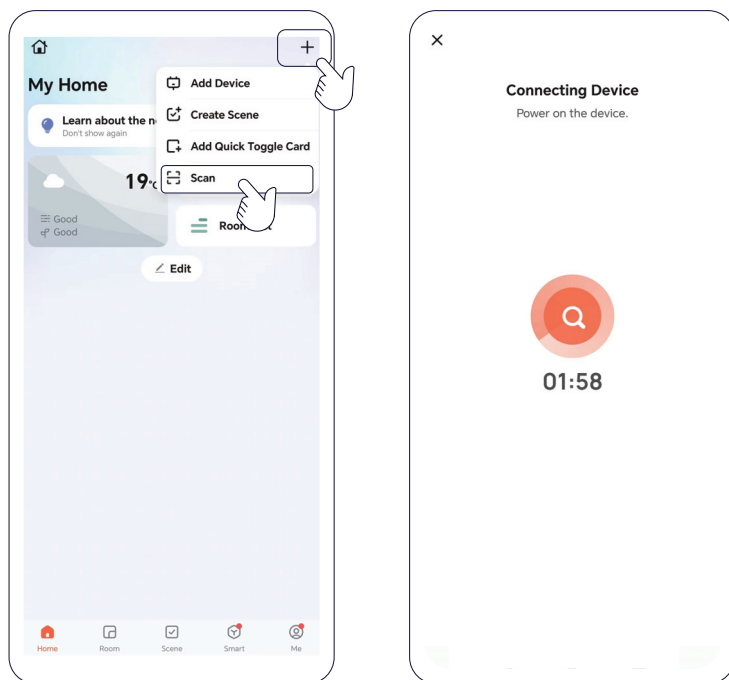

14

Connect Cameras to Homebase

Preparing for Homebase Storage

Please add a TF card or hard drive to make sure the homebase has enough space for saving video recordings.

Follow the steps to complete the addition of the hard drive.

Step 1

Remove the lid and take out the hard drive bracket.

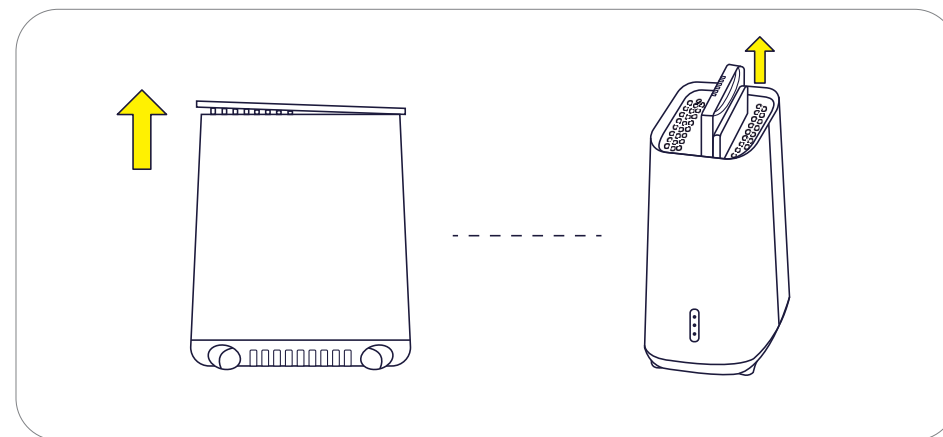

15

Step 2

Place your hard drive onto the bracket and then turn it over to secure it with the provided screws, and the size of the hard drive must be 2.5 inch.

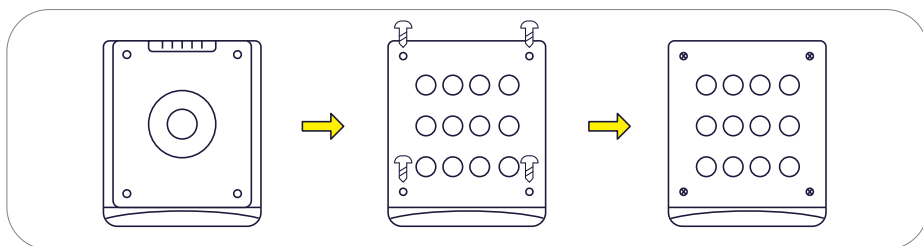

Step 3

Insert the bracket back to the Homebase, then put the top lid back into place.

If the hard drive is being inserted into Homebase for the first time, please format it via the App or the monitor connected to Homebase.

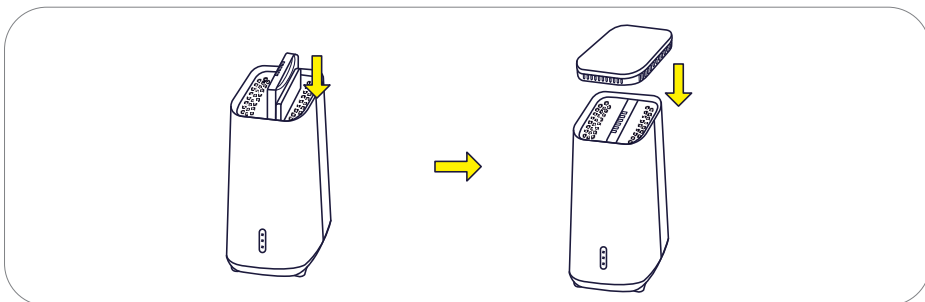

16

Add Cameras to Homebase

There are two ways to connect the camera to Homebase. Method 1 is to operate through the Tuya App; Method 2 is to operate on the monitor. Please jump to page 19.

Method 1: Add via App

Step 1

Open your bound Homebase device on the Tuya App, click the More icon, then open the Add Camera button, and hear the Homebase prompt "Connecting the camera".

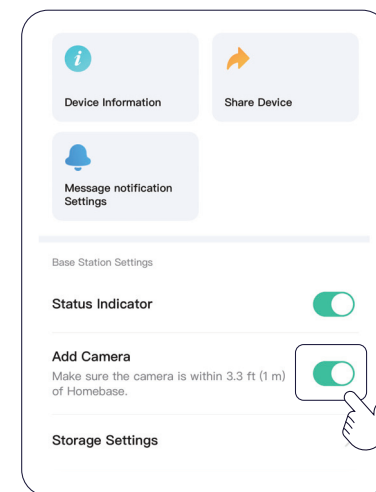
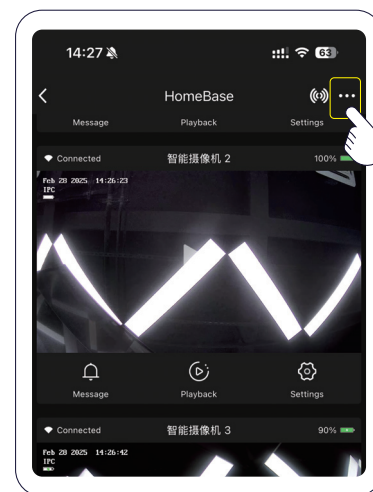

17

Step 2

1. Please ensure that the distance between the camera and the Homebase does not exceed 3.3 ft (1 m) during the addition.
2. Press and hold the camera power button for 3 seconds to turn on the camera, then press and hold the camera reset button for 5 seconds until the status light flashes red.
3. Wait for Homebase to connect to the camera (about 1 min) until all camera status lights turn solid blue and the connection is successful. After completing the addition, turn off the add camera switch on the App.

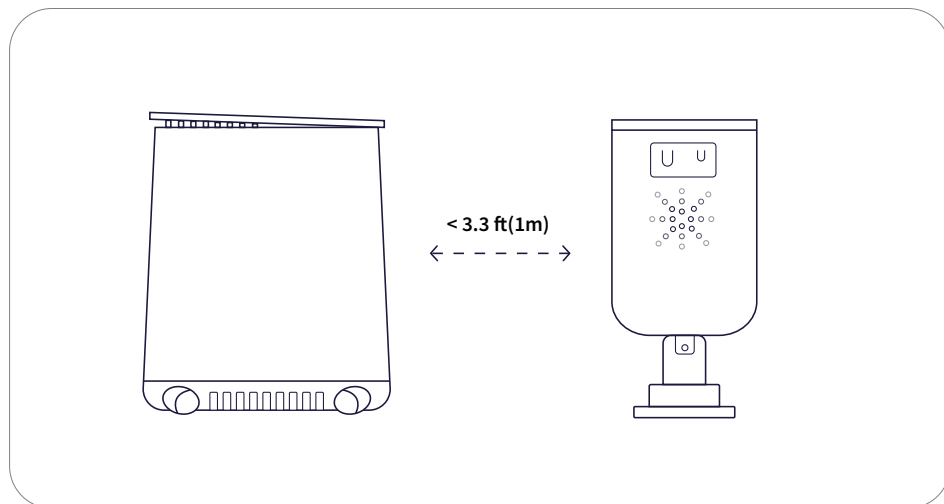

18

Method 2: Add via Monitor

Step 1

Power on the Homebase and connect the mouse to the USB port of the Homebase, then connect the Homebase to a monitor via an HDMI cable.

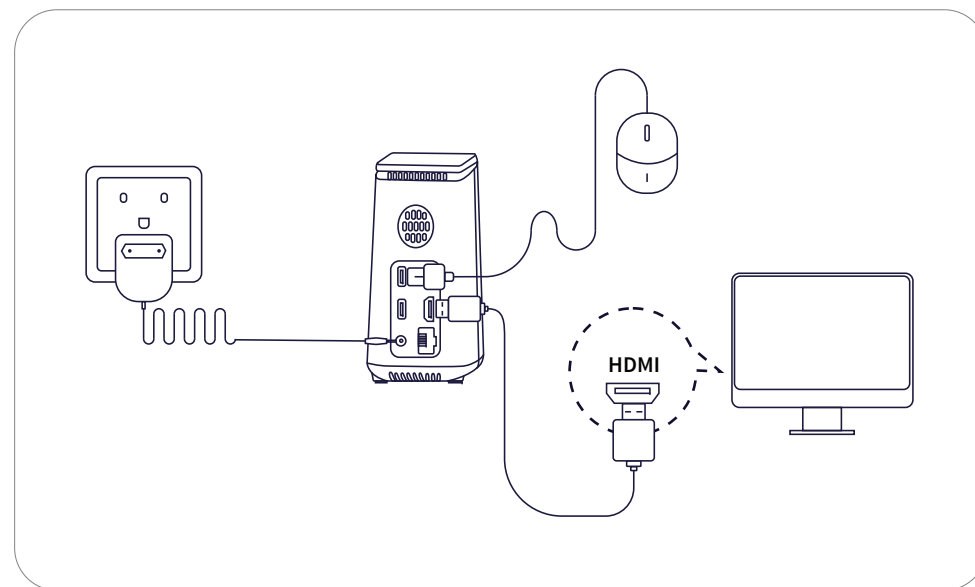

19

Step 2

Follow the setup wizard on the monitor to complete the initial setup. And on the Home Screen, click "+" button to add devices.

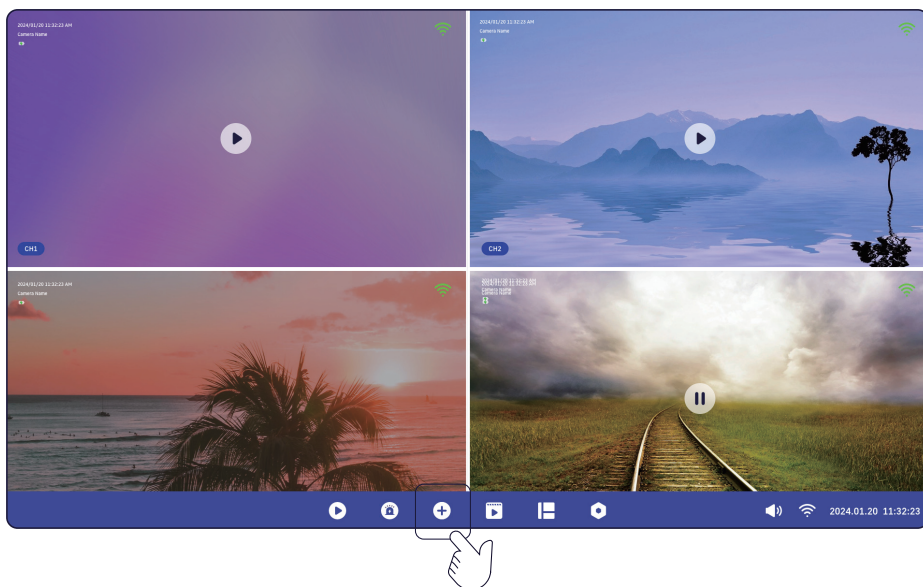

20

Step 3

Please ensure that the distance between the camera and the homebase does not exceed 3.3 ft (1 m) during the addition.

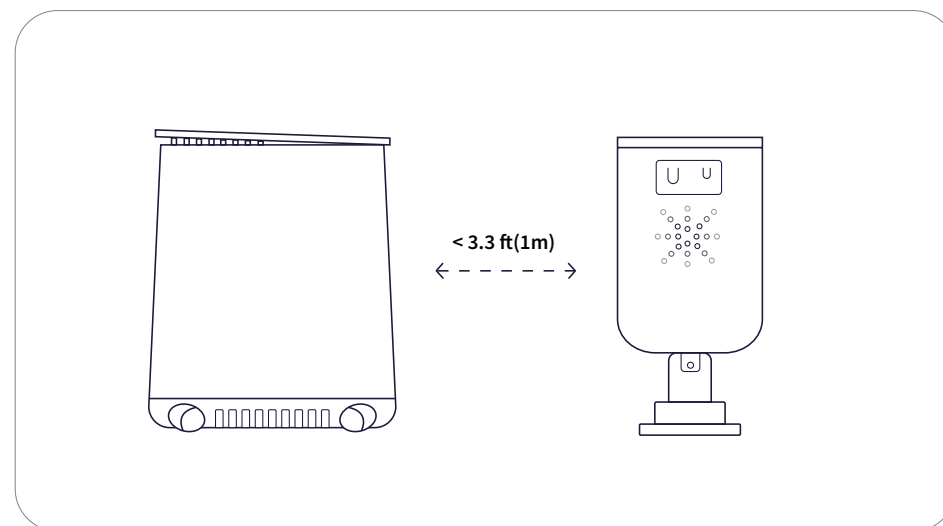

Enter the page of Add Camera, follow the prompts to reset the camera and finish the addition.

21

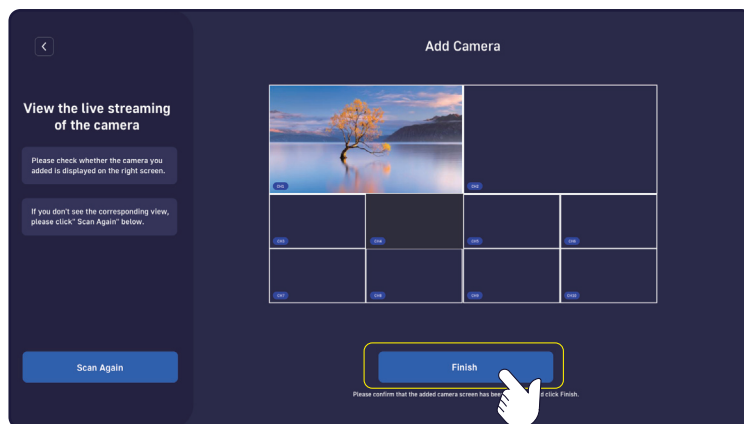
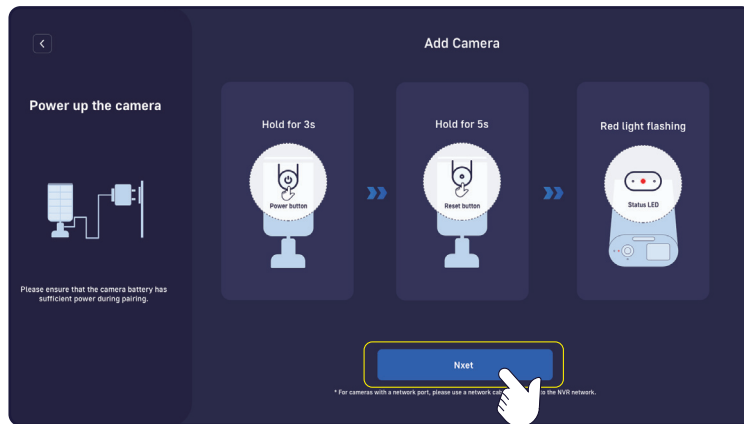

22

Mount Your Camera

Select a location

The camera can be mounted on a wall. Select a location where you can get the desired view and make sure the solar panel is fully exposed to direct sunlight.

Make sure to pick a place within range of your home network. Please try streaming video before you mount your camera.

We recommend hanging it 2.5m (8.2 ft) above the ground and maintaining an angle of about 25 degrees from the horizontal ground.

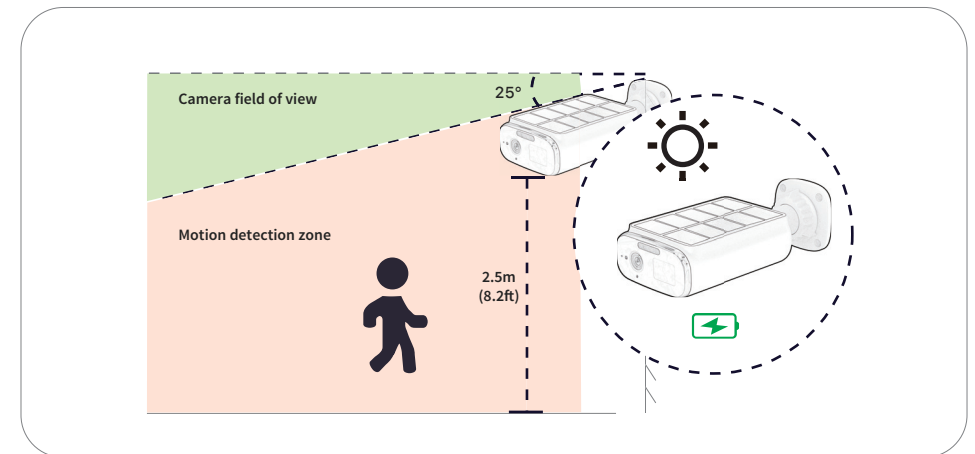

23

Mount the camera

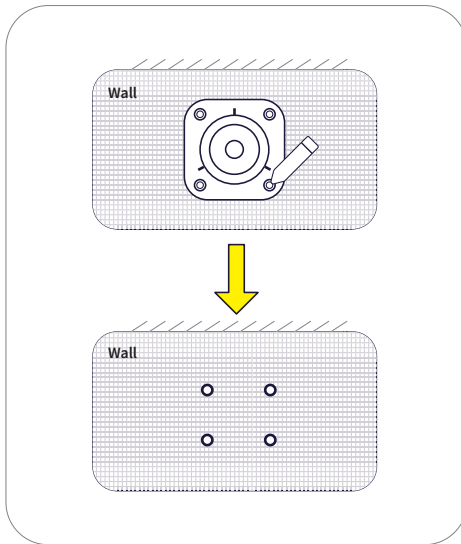

Step 1

Align the mounting plate and mark the four circles where the holes need to be drilled.

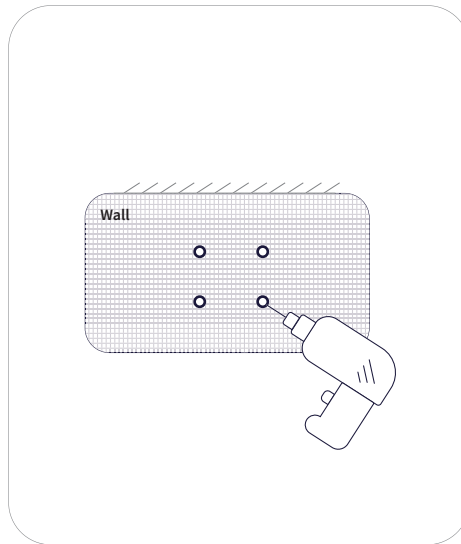

Step 2

Drill four holes above the four marked circles.

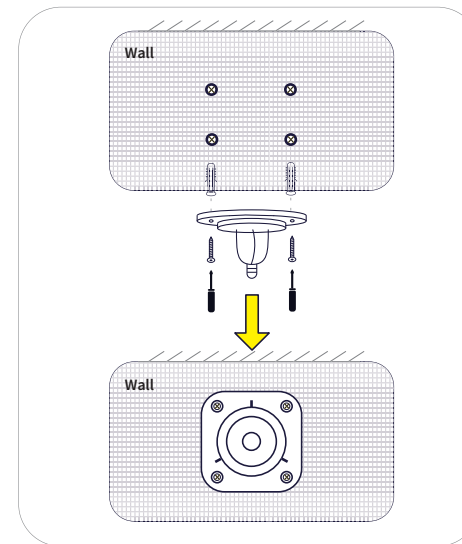

Step 3

Insert four anchors into the holes and use the screws to affix the bracket over the anchors.

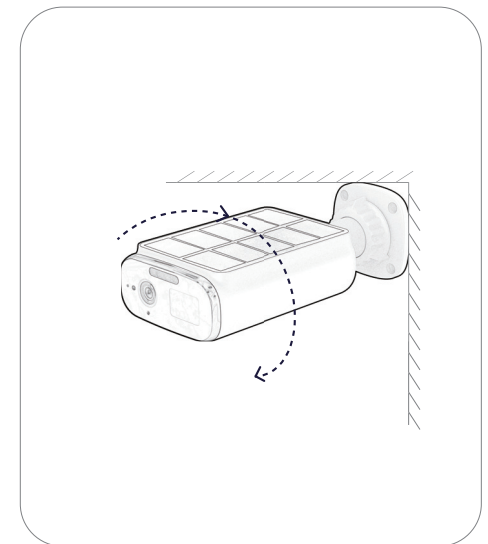

Step 4

Align the hole at the bottom of the camera with the mounting bracket, and turn the camera clockwise to fix the camera to the mounting bracket. Rotate the camera to adjust the view and check it using the live stream which you can access in the App.

Notice

FCC Radiation Exposure Statement:

This equipment complies with FCC radiation exposure limits set forth for an uncontrolled environment. This equipment should be installed and operated with minimum distance 20cm between the radiator & your body.

FCC Warning

This device complies with Part 15 of the FCC Rules. Operation is subject to the following two conditions:

(1) This device may not cause harmful interference, and (2) this device must accept any interference received, including interference that may cause undesired operation.

Note: This equipment has been tested and found to comply with the limits for a Class B digital device, pursuant to part 15 of the FCC Rules. These limits are designed to provide reasonable protection against harmful interference in a residential installation. This equipment generates, uses and can radiate radio frequency energy and, if not installed and used in accordance with the instructions, may cause harmful interference to radio communications. However, there is no guarantee that interference will not occur in a particular installation. If this equipment does cause harmful interference to radio or television reception, which can be determined by turning the equipment off and on, the user is encouraged to try to correct the interference by one or more of the following measures:

- Reorient or relocate the receiving antenna.
- Increase the separation between the equipment and receiver.
- Connect the equipment into an outlet on a circuit different from that to which the receiver is connected.
- Consult the dealer or an experienced radio/TV technician for help.

NOTE 2: Any changes or modifications to this unit not expressly approved by the party responsible for compliance could void the user's authority to operate the equipment.

Caution:

Intended for sale and application in a business environment. Use the Product in the environment with the temperature Between -10℃ and 50℃; Otherwise, it may damage your product. Products can only be used below 2000m altitude.

For the following equipment:

Product Name: Homebase KIT

Brand Name: CE-LINK

Model No.: W2000, K100, K101, K102, K120, K121, W2000-xx (xx indicates color, e.g. WH indicates Withe)

CE LINK LIMITED

qihua.liu2@ce-link.com



The product shall only be connected to a USB interface of version USB2.0 and that the connection to a power USB is allowed.

Adapter shall be installed near the equipment and shall be easily accessible.
Only can use adapter as below:
Power Adapter Model: K25E120200G
Input: 100-240V~50/60Hz 0.6A
Output: 12.0V=2.0A 24.0W
Dongguan Guanjin Electronics Technology Co., Ltd.
The plug considered as disconnect device of adapter.
This product is intended for sale and application in a business environment.

RED Article 10 2
-This product can be used across EU member states
RED Article 10 10
-The product is class 1 product, No restrictions

The RF distance between body and product is 20cm

Technical Characteristics	
Wi-Fi(2.4GHz)- (BL-M6355XU1)	
Support Standards:	802.11b, 802.11g, 802.11n-HT20/40, 802.11ax-HE20/40
Frequency Range:	2412-2472MHz for 802.11b/g/n/ax(HT/HE20); 2422-2462MHz for 802.11n/ax(HT/HE40)
Max.RF Output Power:	18.52dBm (EIRP)
Wi-Fi(2.4GHz)- (RTL8192)	
Support Standards:	802.11b, 802.11g, 802.11n-HT20/40
Frequency Range:	2412-2472MHz for 802.11b/g/n(HT20); 2422-2462MHz for 802.11n(HT40)
Max.RF Output Power:	Antenna 1: 18.72dBm(EIRP); Antenna 2: 18.95dBm(EIRP)

Customer Service

Warranty

12-month Limited Warranty