

QUICK START GUIDE



Solar Wall Light Camera

Content

In the Box	02
Product Overview	04
Basic Parameters	06
Set Up Your Camera	07
Mount Your Camera	11
Notice	17
Customer Service	19

In the Box

After opening the box, please check the following pictures to see if the accessories are complete.

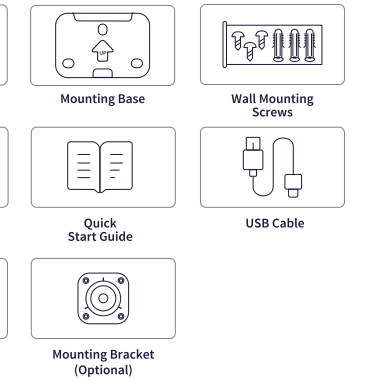

Introduction

1.Green Energy:

The wall light camera will keep working permanently with an integrated solar panel if it has gotten 2 hours sunshine each day.

2.Long Working Time:

The camera can work around 1.5 months without any sunshine if triggered 20 times per day (10 times in the day and 10 times in the night).

3.Freely Lighting:

Adjust floodlights freely to the desired comfortable level through APP for cozy illumination at night.

4.Light your way home:

See clearly what's happening around your home with 600 lumens of floodlights, crisp HD live view, infrared night vision, and person detection.

5.Storage:

Support Local TF card (Max 256G) and cloud storage.

Product Overview

Appearance

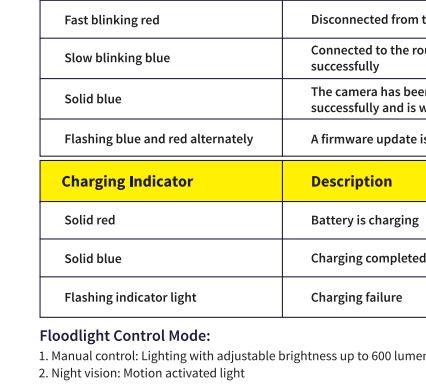
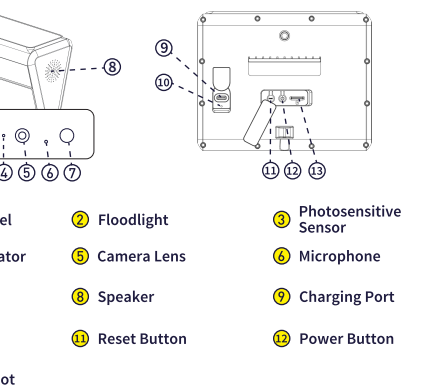

Status LED

Status LED	Description
Slow blinking red	Ready to connect
Fast blinking red	Disconnected from the internet
Slow blinking blue	Connected to the router successfully
Solid blue	The camera has been added successfully and is working normally
Flashing blue and red alternately	A firmware update is in progress

Charging Indicator

Charging Indicator	Description
Solid red	Battery is charging
Solid blue	Charging completed
Flashing indicator light	Charging failure

Floodlight Control Mode:

1. Manual control: Lighting with adjustable brightness up to 600 lumens
2. Night vision: Motion activated light

Basic Parameters

Effective Pixels	2304*1296	Storage	TF Card (Max 256G)
Resolution	2K	Wi-Fi	Only 2.4GHz
FOV(H/V/D)	100°/52°/120°	Network Security	WPA-PSK /WPA2-PSK
Lens	3.5mm@F2.0	Battery Capacity	5200mAh
IR LED	8m	Item Weight	530g
Floodlights	10m	Product Dimensions	166(L)*79(W)*132(H) mm
Audio	Built-in Mic / Speaker	Charging Power	Sunshine or DC5V-1A
PIR	8m(120°)	Mounting Type	Wall Mount
Water Proof	IP65	Working Temp	-20~+50°C
Solar Panel	1.5W	Charging Temp	0°C~+45°C

Set Up Your Camera

Step 1 Download

Download the Tuya Smart or Smart Life App from the Apple App Store or Google Play, or by scanning the QR code below.



Step 2 Connect it to the App

1. Sign up an App account, go to the App homepage, tap Add Device, and select the smart camera(Wi-Fi).

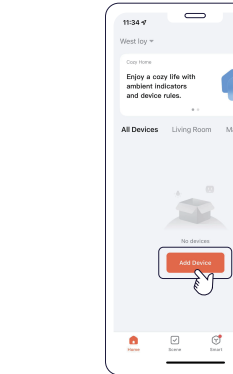

Please follow the prompts of the App to allow relevant permissions, otherwise it will affect the addition and use of the device.

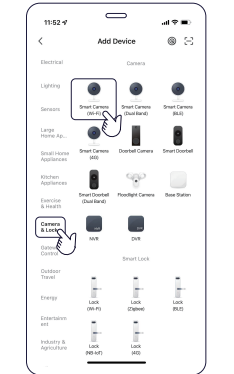

Please follow the prompts of the App to allow relevant permissions, otherwise it will affect the addition and use of the device.

2. Press and hold the power button for 3s until the status LED is slow blinking red or heard "Waiting to receive the wireless configuration"

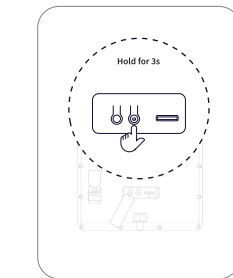

Reset the device
If the SSID of your home Wifi have been changed, you need to reconfigure the network. Please hold the reset button for 5-6 seconds until you heard "reset successfully", then take the prompts to add the device again

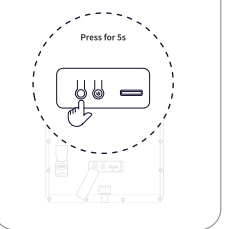

Please choose a 2.4GHz Wi-Fi, the camera does not support the 5GHz Wi-Fi.