

Auzura
your better choice

BT1101

 **Bluetooth® Speaker**

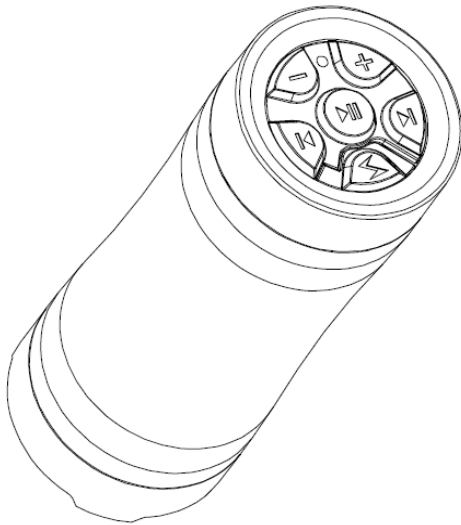

User Guide

Overview

1. Multi-function Button (MFB)

- Power On / Off
- Pair with mobile phone
- Answer / End a call
- Call waiting
- Play / Pause Button

2. LED Status Indicator

3. Volume Up

4. Volume Down

5. Backward Button

6. Forward Button

7. Power Socket

8. Microphone

9. Speaker

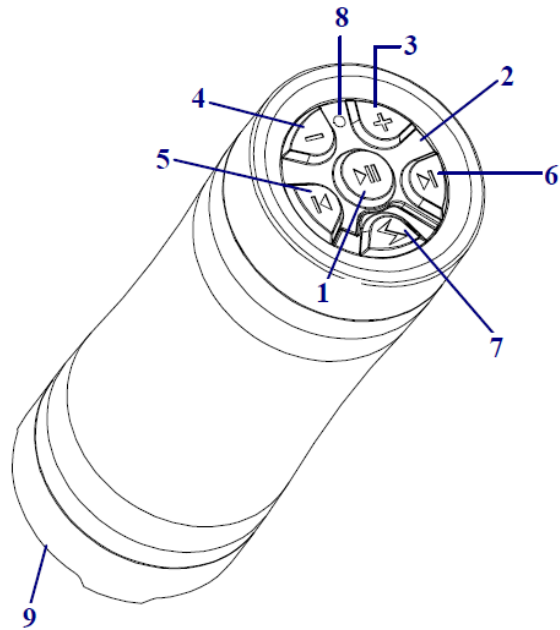

Getting Started

To use your BT1101 Bluetooth Speaker, please follow the steps below:

1. Ensure your speaker is fully charged.

*From completely flat to full charge will take approximately 6 hours.

2. Pair your charged Bluetooth Speaker with a Bluetooth-enabled mobile phone.

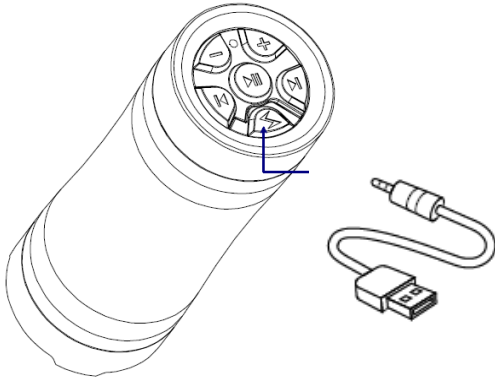

Charging Your BT1101 Bluetooth Speaker

The BT1101 Bluetooth Speaker comes with a built-in rechargeable battery. Prior to using the speaker for the first time, it is recommended to fully charge the battery.

Insert the charger's plug into the speaker's charging socket and plug to the PC/notebook USB port.

Use only the supplied USB charging cable to charge the speaker.

Charging Your BT1101 Bluetooth Speaker

Indicator Light

Bluetooth Speaker Status	Status Indicator Light
<ul style="list-style-type: none">• Standby• Charging (OFF MODE)*• Fully charged (OFF MODE)• Low battery• Out of battery• Out of Range	<ul style="list-style-type: none">• Flash Blue LED• Solid Red LED• Red LED turns off• Flash Red LED with short beep every minute• The LED OFF• Flash Purple LED 3 times

Use only the USB charging cable to charge the Bluetooth Speaker.

◆ Charging indication will be delayed for a few seconds if the Bluetooth Speaker has not been used for a long time or the battery is drained.

◆ 6 hours are required to fully charge the Bluetooth Speaker.

◆ The Bluetooth Speaker remains in standby mode after being turned on.

BT1101 Bluetooth Speaker to Charging Your Mobile Phone Devices

BT1101 is not only Bluetooth Speaker but also can be backup battery feature to charge your mobile phone devices.

Connect the Adaptor Tip Cable to Bluetooth Speaker and then connect your device with the correct tip.

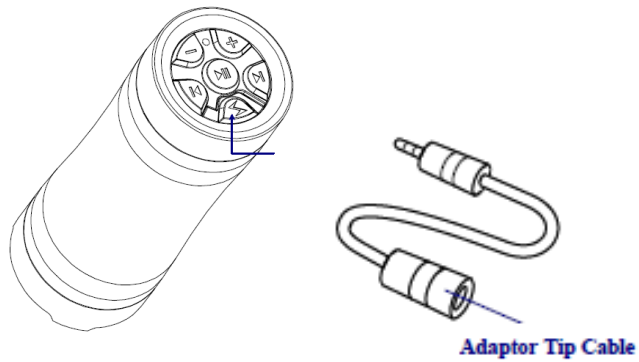

Charging Tips

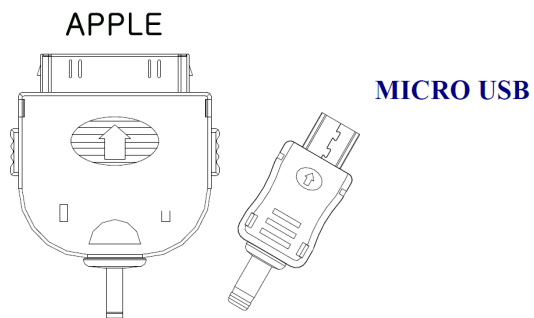

Pairing Your BT1101 Bluetooth Speaker with Bluetooth Mobile Phone

- 1) Ensure the BT1101 Bluetooth Speaker is off.
- 2) To activate the pairing mode, press and hold the Bluetooth Speaker's MFB for 8 seconds without releasing your finger until its status indicator flashes Blue and Red LED alternately.
- 3) Activate your mobile phone's Bluetooth, search Bluetooth devices, select "BT1101" and enter the passcode "0000". When the pairing is completed, the Bluetooth Speaker's status indicator will flash blue rapidly 5 times and you can hear a long beep.

If the pairing cannot be completed within 3 minutes after the pairing mode has been activated, the speaker's status indicator will flash blue rapidly 5 times.

Then the speaker turns off. Repeat steps 1 to 3 to pair both devices again.

Using your BT1101 Bluetooth Speaker

Function	Button	Speaker	Status indicator
POWER ON	Press and hold the MFB for 5 seconds	Short beep	Flash blue light 3 times
When you turn on your speaker for the first time, the Bluetooth Speaker proceeds into pairing mode, i.e. the status indicator flashes blue and red alternately, so that you can immediately pair it with your mobile phone.			
POWER OFF	Press and hold the MFB for 5 seconds	Long beep	Long red for 2 seconds
Incoming call		Ringtone through the speaker ON	Blinking red
Answer / End a call	Press the MFB once	Short beep	

Last no. Re-Dial*	In any mode, Double Click MFB (within 1.2 sec)	Long Beep	
Reject incoming call*	Hold MFB 2 Sec	Long beep	
Adjust Volume	Press VOL UP or VOL DOWN	Short beep at max. and min. volume	
Voice Dialing*	In any mode, press and hold Forward and Backward at the same time	Short beep	
Say the voice tag as soon as you hear the short beep and you must have recorded the voice tag into your mobile phone.			
<p>Call Waiting allows you to hold up the current caller and pick up the second caller.</p> <p>To pick second call: Press MFB once and first call will be released.</p> <p>To pick second call and Hold first call: Double press MFB;</p> <p>- If end second call and Active first call: Short press MFB</p> <p>To reject second call, press MFB 1 second.</p>			
Music enjoyment – BT1101 support A2DP* and AVRCP* profiles which let you enjoy and remote control the music.			
Play	Press Play/Pause once		
Pause	Press Play/Pause once		
Track forward	Press Forward Button once		
Track backward	Press Backward Button once		
* Subject to mobile support			

Resetting Your Bluetooth Speaker / Removing the Pairing History

You may reset the Bluetooth Speaker to its default settings. Resetting will also remove the pairing history of your speaker with the mobile phone.

1. During OFF mode, plug charging cable into the charging socket, then hold the Forward and Backward key 5 second until the Bluetooth Speaker for short beeps.
2. Release the Forward and Backward key.

You may also reset the Bluetooth Speaker to its default settings by hardware reset.

1. Plug charging cable into the charging socket
2. The Bluetooth Speaker is reset.

Auzura Bluetooth Speaker is designed to work with Bluetooth devices. Due to large variability between different Bluetooth devices from different manufacturers, interoperability between the speaker and all Bluetooth-enabled products is not guaranteed.

Declaration of Conformity

We, Auzura Company Limited, declare that the following product:

Product Name: Auzura Bluetooth Speaker

Model Number: BT1101

is in conformity with the following essential requirements of Council Directive 1999/5/EC (referred to as R&TTE Directive): Article 3.1a, 3.1.b and 3.2. and the product is manufactured in accordance with Annex II of the above directive.

A copy of the Declaration of Conformity can be found at

<http://www.auzura.com>

The Stylized Auzura logos are registered trademarks.

Bluetooth® and the Bluetooth logos are trademarks owned by Bluetooth SIG, Inc, USA and licensed to Auzura Company Limited.

Auzura declares under our sole responsibility that the Bluetooth Speaker is in conformity with the provisions of the following Council Directives: 1999/5/EC



■ Dispose of the packaging and this product in accordance with the latest provisions.

11/2011

Printed in China

<http://www.auzura.com>



FCC ID: A4I-BT1101

Troubleshooting

I can hear crackling noise.

To receive the best audio quality, it is recommended to wear your Bluetooth Speaker on the same side of the body as your mobile phone.

I can't hear anything in my Bluetooth Speaker.

- Ensure the Bluetooth Speaker is turned on and is properly charged.
- Ensure the Bluetooth Speaker is properly paired with the mobile phone.
- Make sure that the mobile phone is connected with the Bluetooth Speaker – if it does not connect, either refer to the mobile phone's Bluetooth menu or by pressing the MFB once (see “Using Your Speaker” and “Pairing Your Bluetooth Speaker with a Bluetooth Mobile Phone”).

I can't connect my Bluetooth Speaker with my mobile phone.

- Ensure your Bluetooth Speaker is turned off and is properly charged.
- Ensure the Bluetooth Speaker is properly paired with your mobile phone.
- Ensure your mobile phone's Bluetooth feature is activated. Please refer to your mobile phone user guide for specific instruction.
- Ensure the Bluetooth Speaker is within ten meters range of your mobile phone and there are no obstructions, such as walls or other electronic devices in between.

If the above steps do not solve your problem, please recharge the Bluetooth Speaker and remove your mobile phone's battery for a while.

I can't turn off the Bluetooth Speaker or the Bluetooth Speaker does not respond

- You may do a “hardware reset” on your Bluetooth Speaker if you can't turn it off or it doesn't respond.

Safety Information

- Check and observe local laws regarding the use of a mobile phone and a Bluetooth Speaker while driving. If you use the Bluetooth Speaker while driving, ensure your full attention and focus. It is your responsibility to drive safely. Consider to pull off the road before making or answering a call.
- Never leave your Bluetooth Speaker above any air bag deployment area inside your car as serious injury may result when an air bag deploys.
- Never allow children to play with the Bluetooth Speaker – small parts may be of choking hazard.
- Observe all signs and displays that require an electrical device or RF radio product to be switched off in designated areas. These could include hospitals, blasting areas, and potentially explosive atmospheres.
- Turn off your Bluetooth Speaker prior to boarding an aircraft. Do not use your Bluetooth Speaker inside an aircraft.
- To prevent damage to your hearing, please do not set the listening volume too high.
- Do not attempt to modify the Bluetooth Speaker.
- Do not use the Bluetooth Speaker in stormy weather.
- Do not clean the Bluetooth Speaker while it is being charged. Always disconnect the charger from the Bluetooth Speaker before cleaning.
- Do not attempt to force open the built-in battery.
- Only charge the Bluetooth Speaker's built-in battery in accordance with the instructions described in this user guide.

Care and Maintenance

Bluetooth Speaker

- Turn off your Bluetooth Speaker before placing it in your pocket or bag. If the MFB is accidentally depressed, your mobile phone may place an unintended call.
- Do not use abrasive cleaners to clean the Bluetooth Speaker.
- Do not expose the Bluetooth Speaker to extremely high or low temperatures.
- Do not leave the Bluetooth Speaker in direct sunlight for an extended period of time.
- Do not leave the Bluetooth Speaker near open flames such as cooking burners.
- Do not dispose of the Bluetooth Speaker in a fire, as it will result in explosion.
- Do not bring the Bluetooth Speaker into contact with any sharp objects, as this will cause scratches and damages.
- Do not stick anything inside the Bluetooth Speaker, as this may damage internal components.
- Do not attempt to disassemble the Bluetooth Speaker as it does not contain serviceable components.
- If you do not plan to use the Bluetooth Speaker for a long period, please store it in a dry place that is free from extreme temperatures and dust.
- Avoid charging the Bluetooth Speaker in extremely high or low temperatures.
- Dispose of the battery and the Bluetooth Speaker according to local regulations. Do not dispose of them as household waste.

Built-in Battery

- Do not attempt to replace the speaker's battery as it is in-built and is not changeable.
- Do not intent to open or disassemble the products, such action will void the warranty.
- Do not store in high temperature environment, including intense sunlight heat
- Do no place speaker in fire or other excessively hot environment.
- Dispose of the battery according to local regulations. Do not dispose of the battery as household waste.
- Charge the battery in accordance with the instructions supplied with this user guide.

Charging Cable

- Use only the charging cable supplied by the Bluetooth Speaker's original manufacturer to charge the Bluetooth Speaker. Other charging cable may look similar but using them could be dangerous and could damage the Bluetooth Speaker.

Notes on Environmental Protection

After the implementation of the European Directive 2002/96/EU in the national legal system, the following applies: Electrical and electronic devices must not be disposed of with domestic waste. Consumers are obliged by law to return electrical and electronic devices at the end of their service lives to the public collection points that are set up for this purpose or designated points of sale. However, such details are defined by the national law of the respective country. This symbol on the product, the instruction manual or the packaging indicates that the product is subject to these regulations. By recycling, reusing the materials, or other forms of utilizing old devices, you are making an important contribution in protecting our environment.

FCC RF Radiation Exposure Statement:

This equipment complies with FCC radiation exposure limits set forth for an uncontrolled environment.

Federal Communications Commission (FCC) Statement

This device complies with Part 15 of the FCC Rules. Operation is subject to the following two conditions: (1) this device may not cause harmful interference, and (2) this device must accept any interference received, including interference that may cause undesired operation.

Changes or modifications not expressly approved by the party responsible for compliance could void the user's authority to operate the equipment.

15.21

You are cautioned that changes or modifications not expressly approved by the part responsible for compliance could void the user's authority to operate the equipment.

15.105(b)

This equipment has been tested and found to comply with the limits for a Class B digital device, pursuant to part 15 of the FCC rules. These limits are designed to provide reasonable protection against harmful interference in a residential installation. This equipment generates, uses and can radiate radio frequency energy and, if not installed and used in accordance with the instructions, may cause harmful interference to radio communications. However, there is no guarantee that interference will not occur in a particular installation. If this equipment does cause harmful interference to radio or television reception, which can be determined by turning the equipment off and on, the user is encouraged to try to correct the interference by one or more of the following measures:

- Reorient or relocate the receiving antenna.
- Increase the separation between the equipment and receiver.
- Connect the equipment into an outlet on a circuit different from that to which the receiver is connected.
- Consult the dealer or an experienced radio/TV technician for help.