

# Selfie screen user manual

# Product intro

This product is a 6-in-1 upgraded mobile phone wireless selfie screen. Compared with traditional selfie mirroring, the JQ668 added audio screencasting, wireless and wired screencasting (when the live broadcast battery is low, it can be directly cast with a wired connection), and the ability to switch between and English languages. The 3.97-inch screen with no Wi-Fi image transmission technology helps users solve the problem of not being able to see the screen when using mobile phone's high-end rear camera to shoot selfies/live broadcasts/shots. It is especially useful for long focal length shooting in large scenes. It helps users take selfies, faster output of photos, and higher quality photos and Vlog.

# Specifications

- Model: JQ668
- Screen size: 3.97 inches
- Resolution: 480×800 pixels
- Connection: wifi.USB-C cable
- Wireless operating range: 5-8m.16ft-26ft
- Battery capacity: 1800mAh
- Input voltage: DC 5V = 2A
- Charging output: DC 5V = 1A
- Size: 103.5\*62\*11mm
- Weight: 110g
- Input/Output: USB-C
- Compatibility: iOS and Android devices

Audio screen mirroring—Wireless screen mirroring  
Wired screen mirroring—Language self-switching  
photo capture—Power bank output

# Button function

- Up arrow button** ▲  
【Not connected】Increase the screen brightness (short press)  
【Connected Status】Switch screen display (long press)
- Down arrow button** ▼  
【Not connected】Decrease the screen brightness (short press)  
【Connected Status】Screen flip vertically (long press)
- Power button** ⏻  
Power on/off (long press)  
On/Off sleep mode and wake up the screen(Short Press)
- Photo button** 📷  
【Not connected】Switch language (long press)  
【Connected Status】Start screen mirroring (long press)  
Take photo (short press)

Tip: Automatic shutdown after 5 minutes of inactivity.

# Teleportation function

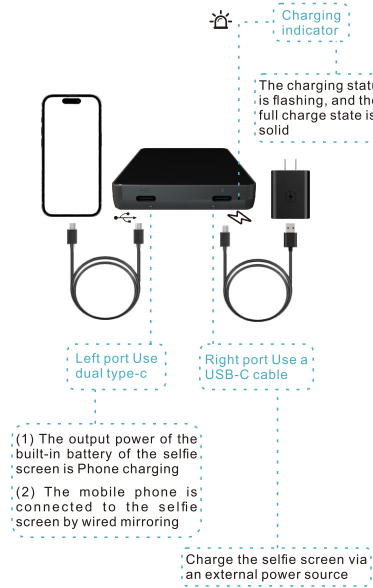

# Wired mirror connection

- Step 1: Press and hold the power button to turn on** ⏻
- Step 2: Connect the dual Type-C cables**  
\*iPhone: Connect directly to the left port and start mirroring automatically.  
\*Android: For the first connection, please follow the instructions below to install the dedicated screen mirroring application:  
(1)Connect the Android device to the left port of the selfie screen using a data cable. The installation prompt will automatically pop up on the Android device's screen, follow the instructions to complete the installation of the screen mirroring APP [HCCast]:

Download order: 1→4

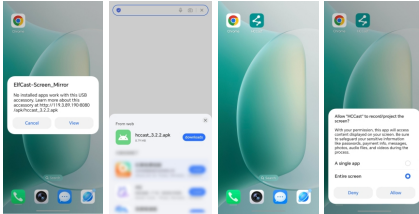

(2)After installation is completed, please unplug the data cable and connect it to the data port on the left side of this device again. Open the installed screen mirroring:APP and the wired mirroring connection will start automatically (subsequent wired connections can be completed directly through the cable).

# Wireless connection

- Step 1: Press and hold the power button to turn on** ⏻
- Step 2: (iOS) Connect the selfie screen**  
WiFi network name: **SCREEN\_\*\*\*\*\***  
Password: **12345678**  
\*Android users can skip this step.
- Step 3: Phone screen mirroring selection**  
Projection: **SCREEN\_\*\*\*\*\***



Tips: The wireless range of 5-8 meters is the open space test value, the actual distance may be shortened due to obstacles (such as walls) or interference, and the screen may not be fully filled due to the difference in the aspect ratio of different devices, which is normal.

# Safety Notes

- To avoid fire, electric shock or personal injury, follow these rules:**  
(1) It is forbidden to expose the equipment to liquid or humid environments.  
(2) Stay away from high temperatures, direct sunlight or open flames.  
(3) Do not use broken or non-compliant charging cables or adapters.  
(4) It is forbidden to disassemble, puncture or modify the equipment.  
(5)Adult supervision is required when children use it.  
(6) The equipment has been damaged, please stop using it immediatel.

# Maintenance and upkeep

- Cleaning:** Wipe with a soft, dry cloth, no alcohol, solvents or abrasives.
- Storage:** Store in a cool and dry place to avoid high temperature and humidity.
- Battery Maintenance:** Charge regularly to maintain battery activity.
- Recycling:** Batteries are recycled in accordance with local regulations and should not be discarded with household waste.

# Packing list

- Selfie screen ×1
- Double-headed type-cData Cable ×1
- type-c Charging cable ×1
- User Manual ×1

# FCC Warning

**This device complies with Part 15 of the FCC Rules. Operation is subject to the following two conditions:**

- (1) This device may not cause harmful interference, and
- (2) this device must accept any interference received, including interference that may cause undesired operation.

NOTE 1: This equipment has been tested and found to comply with the limits for a Class B digital device, pursuant to part 15 of the FCC Rules. These limits are designed to provide reasonable protection against harmful interference in a residential installation. This equipment generates, uses and can radiate radio frequency energy and, if not installed and used in accordance with the instructions, may cause harmful interference to radio or television reception, which can be determined by turning the equipment off and on, the user is encouraged to try to correct the interference by one or more of the following measures:

- Reorient or relocate the receiving antenna.
- Increase the separation between the equipment and receiver.
- Connect the equipment into an outlet on a circuit different from that to which the receiver is connected.
- Consult the dealer or an experienced radio/TV technician for help.

NOTE 2: Any changes or modifications to this unit not expressly approved by the party responsible for compliance could void the user's authority to operate the equipment.

The device has been evaluated to meet general RF exposure requirement. The device can be used in portable exposure condition without restriction.

# Warranty card

Product Model: JQ668

Contact Email: \_\_\_\_\_

Contact number: \_\_\_\_\_

Date of purchase: \_\_\_\_\_

Order Number: \_\_\_\_\_

Problem description: \_\_\_\_\_

## Warranty:

(1) This equipment is covered by a one-year limited warranty, covering defects in materials or workmanship under normal use after the date of purchase.

(2) Valid proof of purchase (such as invoice) is required for warranty.

## Warranty exclusions:

- (1) Man-made damage, improper use, or unauthorized modification.
- (2) Problems caused by accidental drops, liquid immersion or extreme temperatures.

## Warranty process:

- (1) Contact customer service and provide proof of purchase.
- (2) Describe the problem and send it back for testing or repairing as instructed.