



Wireless Presenter

P90



# Instruction Manual

## User Guide (English)

### Overview

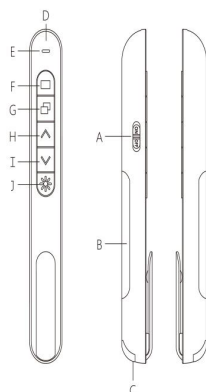

1

No.	Parts name	Function
A	Power switch	Turn on/off the laser pen
B	Battery compartment	Hold an AAA battery for power supply
C	Receiver	Receive signal from Laser Pen to operate the files
D	Laser hole	Emits infrared laser
E	LED Indicator	Indicate working status Low battery: Battery needs to be replaced when LED flashes slowly after tapping PgUp/PgDn button. (LED indicator doesn't shine when battery has sufficient power)
F	Blank Screen Switching	Blank screen/Return blank screen
G	Full Screen Switching	Full Screen/Return full screen
H	PgUp	Tap: Page up
I	PgDn	Tap: Page down
J	Laser button	Press to emit laser rays, and release the button to cancel laser.

### Note

Only Page up, Page down, Play/ESC and blank screen functions work in Mac system Keynote software, except for the hyperlink function.

### Packing list

- USB Receiver\*1
- User manual\*1

2

## Product Use

### Battery Installation

The laser pen is power supplied by an AAA battery. Open the battery compartment cover and place an AAA battery then close it.

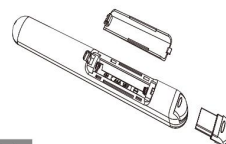

### Note

1. Ensure the battery polarity (+) (-) is correct.
2. Do not leave damaged or used-up battery in the device.
3. Please remove the battery if the device will not be used for a long period.
4. Please replace the battery if a malfunction occurs or operating distance shortened.

### Install USB receiver

Pull the mini USB receiver out of the pen, plug it into computer's USB port, and then "Found new hardware" pops out in the lower right corner of the desktop. The system will install the program automatically. Installation completes when Windows shows "New hardware installed and can be used".

a Take out the receiver

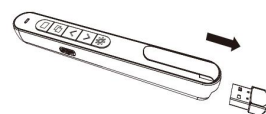

3



### Note

Upon the first installation on mac, Keyboard Set Assistant may appear and prompt that the keyboard cannot be identified. Just click "continue" to finish the installation, and then the presenter will work accordingly.

### Operating the Wireless Laser Pen

- a. Switch the power button OFF to ON, and the LED indicator blinks twice meaning the presenter is ready to go.
- b. Start PowerPoint or Keynote and open the document
- c. Refer to the button features to operate file Page Up/Down, full screen, black screen, and hyperlink.

### Note

1. The Laser Pen will enter into the sleep mode automatically when there is no activity for a while, and wakes up by pressing any button.
2. The transmission distance between the USB receiver and Laser Pen will be decreased by the disturbance of electronic devices around.

### Turn off the Wireless Laser Pen

Please insert the USB receiver back into the Laser Pen and turn off the power switch in order to prevent damage caused by the power button being squeezed in a bag.

### FAQ

- How to detect the battery inside has power?

4



1. Press the laser button when power on. If there is no laser ray, it means the battery has no power.
2. Press other buttons when power on, if LED indicator does not blink, it means the battery has no power.

### Laser Pen does not blink.

1. Ensure the battery + - has been installed correctly.
  2. Ensure the battery has sufficient power.
  3. Make sure the power switch has turned on.
- If the Laser Pen works normally except without laser ray, this may be caused by the laser modular, please contact our after-sales service.

### Receiver unidentified.

1. Ensure the computer USB port works normally and try other ports.
2. Try on another computer, if it works fine, then it may cause by USB driver, please reinstall the USB driver.

### What to do with non-functional laser ray?

Please replace a battery with sufficient power.

### What to do when some buttons do not work?

This may be caused by some shortcuts of the operating system or application program (such as PowerPoint) have been changed. Please check the system or application's shortcut key settings, or

5

reinstall the operating system and application after backing up your data.

### Safety Measures

- To avoid possible eye damage, never point the device at people especially their faces, or look directly into the device's laser beam.
- Avoid pointing the device's laser beam at a mirror or other highly reflective.
- Keep the device away from children.
- Never view the device's laser beam using telescopic devices, such as a microscope or binoculars.
- Any attempt to disassemble, adjust or repair the device may result in exposure to laser light or other safety hazards.

### Specifications

Transmitter	
Remote control	Radio Frequency Technology
RF Frequency	2.4GHz
Control distance	100m
Laser ray	2R laser
Output power	<1mW
Laser distance	200m
Laser wave length	650nm(red)
Working voltage	1.5V
Sleeping current	<10uA
Dimension	160*20*18mm
Weight	28g(Without battery)
Receiver	
Operating system	Windows XP /7/8/10,Mac OS, Linux,Android
USB version	Compatible with USB1.1, USB2.0, USB 3.0
Working Voltage	4.5-5.5V
Dimension	24.8*14.1*7.8mm
Weight	1.6g

6

This equipment has been tested and found to comply with the limits for a Class B digital device, pursuant to part 15 of the FCC Rules. These limits are designed to provide reasonable protection against harmful interference in a residential installation. This equipment generates, uses and can radiate radio frequency energy and, if not installed and used in accordance with the instructions, may cause harmful interference to radio communications. However, there is no guarantee that interference will not occur in a particular installation. If this equipment does cause harmful interference to radio or television reception, which can be determined by turning the equipment off and on, the user is encouraged to try to correct the interference by one or more of the following measures:

- Reorient or relocate the receiving antenna.
- Increase the separation between the equipment and receiver.
- Connect the equipment into an outlet on a circuit different from that to which the receiver is connected.
- Consult the dealer or an experienced radio/TV technician for help.

Caution: Any changes or modifications to this device not explicitly approved by manufacturer could void your authority to operate this equipment.

This device complies with part 15 of the FCC Rules. Operation is subject to the following two conditions:

(1) This device may not cause harmful interference, and (2) this device must accept any interference received, including interference that may cause undesired operation.

This equipment complies with FCC radiation exposure limits set forth for an uncontrolled environment. This transmitter must not be co-located or operating in conjunction with any other antenna or transmitter.