

V1.0

Camera instruction manual

Quick Start Guide Low power battery camera



Scan the QR code to
download the "Eseecloud" APP

M8-WH

Note: Apple requires IOS 9.0 or above, and
Android requires Android 5.1 or above.

Please read the quick operation guide carefully
before using the product and keep it safe.

1. Add device-wiFi camera

1.1 Open the "Eseecloud"
APP, click the "+" icon in the
middle of the interface, and
enter the scanning interface;

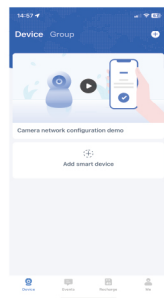

1.2 Scan the QR code on the
machine of the code equipment;



1.3 After checking the status
of the equipment, such as the
device indicator light;



1.4 Select the WIFI corresponding
to "2.4G" and write the correct
password and click Next.



After the network configuration is successful, add a setting name
to the device to add it successfully.

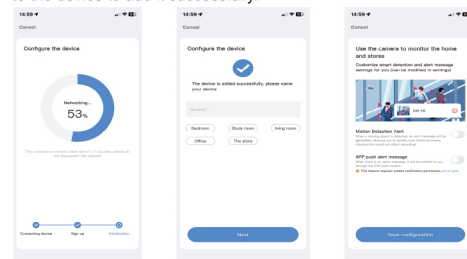

2. Bluetooth network addition

* Before adding a camera, please make sure that the Bluetooth
function of the mobile phone has been turned on, and do not turn
off Bluetooth during the addition process. If the prompt box that
needs to turn on Bluetooth authorization pops up
during the addition process, please follow the steps in the prompts
to turn it on;

2.1 Turn on the device on, wait for the device to rotate the white
check. After hearing the prompt tone of "Please configure the
network", click the "+" sign in the upper right corner, and automatically
search for the nearby device ID that has been powered online. Click
on the right to add it according to the corresponding device ID.

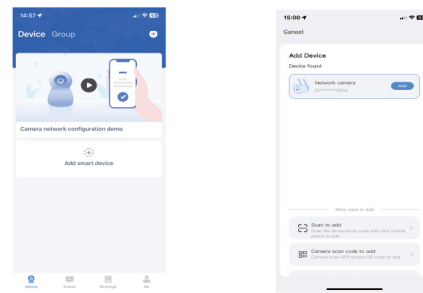

2.2 Select the corresponding
"2.4G" WIFI, enter the exact
password and click Next;

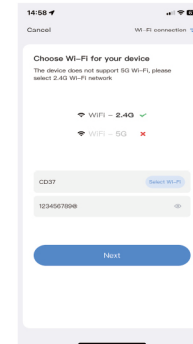

2.3 After waiting for the successful configuration of the camera
network, set the name of the camera and click the next step to
complete the addition.

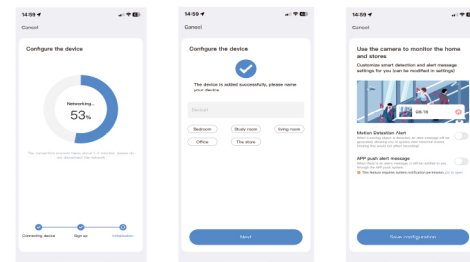

* During the distribution process, if Bluetooth is abnormally
disconnected or the information transmission fails, it will
automatically jump to the QR code to scan the code
distribution page.

This device complies with part 15 of the FCC Rules. Operation is subject to the following two conditions: (1) This device may not cause harmful interference, and (2) this device must accept any interference received, including interference that may cause undesired operation.

Any Changes or modifications not expressly approved by the party responsible for compliance could void the user's authority to operate the equipment.

Note: This equipment has been tested and found to comply with the limits for a Class B digital device, pursuant to part 15 of the FCC Rules. These limits are designed to provide reasonable protection against harmful interference in a residential installation. This equipment generates uses and can radiate radio frequency energy and, if not installed and used in accordance with the instructions, may cause harmful interference to radio communications. However, there is no guarantee that interference will not occur in a particular installation. If this equipment does cause harmful interference to radio or television reception, which can be determined by turning the equipment off and on, the user is encouraged to try to correct the interference by one or more of the following measures:

- Reorient or relocate the receiving antenna.
- Increase the separation between the equipment and receiver.
- Connect the equipment into an outlet on a circuit different from that to which the receiver is connected.
- Consult the dealer or an experienced radio/TV technician for help.
- This equipment complies with FCC radiation exposure limits set forth for an uncontrolled environment. This equipment should be installed and operated with minimum distance 20cm between the radiator & your body.