

User Manual

Q8



Scan the QR code to download the APP

Thank you for choosing our products. Please read the product manual carefully before using this product.

1.Charge the Device

- Please charge the device fully (5-7 hours) before first use.
- Connect the included power cord to the charging port of the device and use a 5V DC/1A charger to charge the device.
- While the device is charging, the red power indicator light will turn on, and when charging is complete, the red power indicator light will turn off.
- You may proceed to Step 2 before the charging finishes.

2.Product use Procedure

- Open the card slot and insert a SIM card that supports GPRS Internet access.
- Select the appropriate SIM card. Please refer to the following figure for the size and style of the SIM card.
- After inserting the card, press the power button for 3~5 seconds until the indicator lights up. If your tracker without button, inserting the card will automatically turn on.



3.Indicator Status Description

Blue light: GPS signal indicator

Note: Fast flashing means there is GPS signal, and constant light means there is no GPS signal.

Green light: GSM signal indicator

Note: Fast flashing means there is signal; slow flashing means no network; constant light means no SIM card.

Red light: Power indicator

Note: The red light is on when charging, and the red light goes out when fully charged, and the red light goes out when working normally.

4.Download and install App

Download the App on your smart phone.

Scan the QR code or Search "QXGPS" App in Google Play for Android or App Store for IOS to download the App.

Click on "sign up now" Follow the instructions in the app to setup your account.

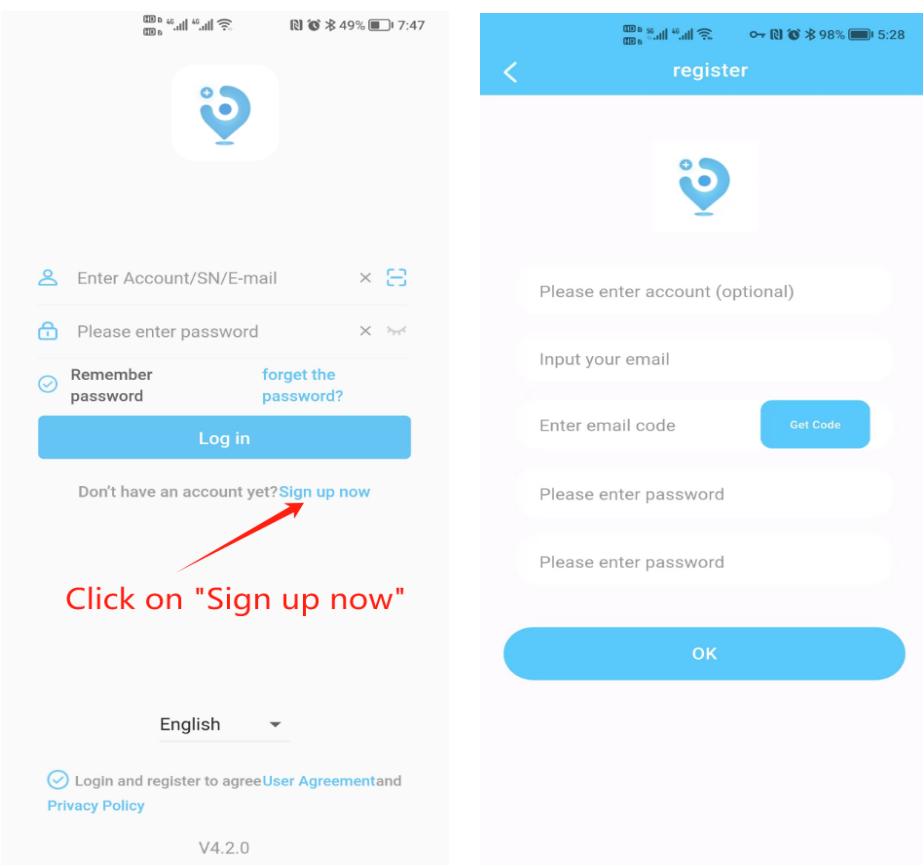

5.Activate your device and add to APP

· Power On

Disconnect the GPS tracker from the power source.

Press and hold the Power button for 3 seconds to turn on the unit.

- To associate a device with your account, go to "Add Device"
- Scan the barcode on the device or enter the device ID.
- Make sure your GPS tracker is on, wait one minute, the system will automatically try to connect to the device.

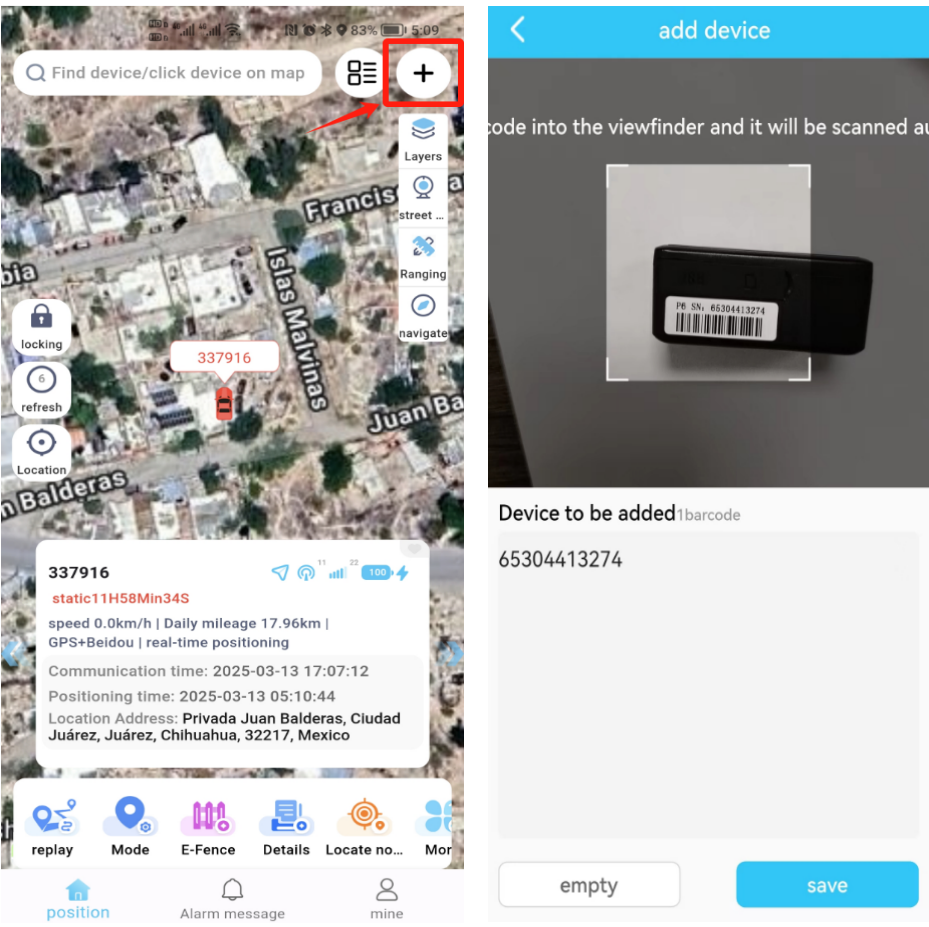

6.Web login

<https://www.gps666.net>

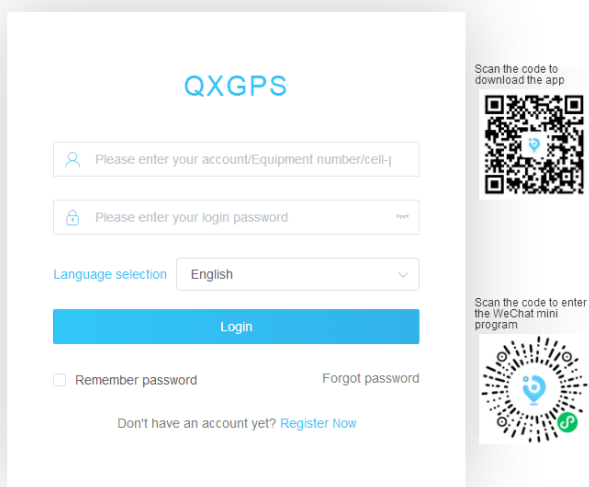

- You can log in using your registered account.
- You can log in by entering or scanning the barcode SN number on the device, the default password is 123456.
- You can log in by entering the email address you have bound.

7.Take Outside for Test

Take your unit outdoors for a 10-15 minute walk or drive.so that it can establish a GPS connection.

FAQ's

1. Why is the device positioning inaccurate? What should we pay attention to?

GPS trackers need a clear view of the sky to properly receive signals from satellites and work best when the device is outdoors and in or under a vehicle.

Please be aware that when the GPS signal is blocked by buildings, trees, heavy clouds or when the device is indoors,it uses nearby GSM celular antenna towers to approximate its location. This is less accurate than GPS location and might show the device to be hundreds of feet or even a few miles away in a non-urban area. For indoor tracking, the device can also use its Wi-Fi tracking feature where Wi-Fi routers are available.

2. When I log in, I don't see my device. Why?

Your device may not have established a GPS connection yet.If you already test drove with the unit and it is still not tracking:

- Take the device outside.
- Turn off the tracker(Press and hold the power button for 3 seconds. All indicators flash 3 times and then release your hand to turn off the device). Wait 30 seconds and turn the tracker back on.
- Check whether your device subscription package has expired and recharge the device in time. The recharge steps are as shown in the figure

3.Where on the vehicle can I place the device?

For best signal place the device in any of the red areas indicated.Avoid placing the unit too far underneath the vehicle or inside the trunk/front hood of the car.

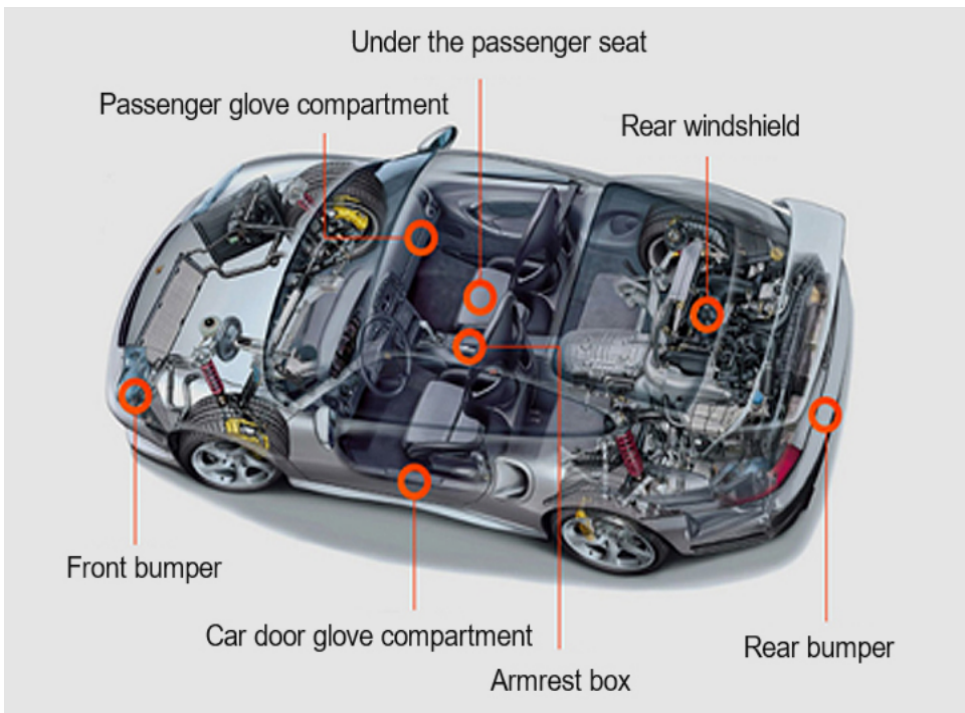

4. Having trouble logging in , can't find the E-mail containing your username and password?

- On the GPS login page select "Forgot Password."
- Your email is also your username.Enter the email address that you used when you placed your order and press "Reset password."
- Check your email. Follow the instructions to reset your password.

Important Tips

- (1) Do not immerse the product in water;
- (2) Keep the product away from fire, high temperature, extreme high temperature and other extreme environments;
- (3) It is strictly forbidden to disassemble, repair or modify the product.
- (4) This product is for personal or company use only. Please abide by laws and regulations and prohibit illegal use of this product.

Thank you for reading this user manual carefully!
If you have any questions, please contact distributor.

FCC Warning:

This equipment has been tested and found to comply with the limits for a Class B digital device, pursuant to part 15 of the FCC Rules. These limits are designed to provide reasonable protection against harmful interference in a residential installation. This equipment generates, uses and can radiate radio frequency energy and, if not installed and used in accordance with the instructions, may cause harmful interference to radio communications. However, there is no guarantee that interference will not occur in a particular installation. If this equipment does cause harmful interference to radio or television reception, which can be determined by turning the equipment off and on, the user is encouraged to try to correct the interference by one or more of the following measures:

- Reorient or relocate the receiving antenna.
- Increase the separation between the equipment and receiver.
- Connect the equipment into an outlet on a circuit different from that to which the receiver is connected.
- Consult the dealer or an experienced radio/TV technician for help.

Caution: Any changes or modifications to this device not explicitly approved by manufacturer could void your authority to operate this equipment.

This device complies with part 15 of the FCC Rules. Operation is subject to the following two conditions:

(1) This device may not cause harmful interference, and (2) this device must accept any interference received, including interference that may cause undesired operation.

This equipment complies with FCC radiation exposure limits set forth for an uncontrolled environment. This equipment should be installed and operated with minimum distance 20cm between the radiator and your body.