APP Operation

App Store search [Smart Life] Download and sign in.

1、Add device

After entering the APP, click "+" in the upper right corner of the home page to add the device, and enter the "Add Device" page;

1) WiFi distribution network

- Select [Camera&lock] and click "Video lock (Wi-Fi)" to jump to the next page.
- "Reset the device" interface, click Next, check the Scan the QR code with door lock camera,click [Next].
- Select WIFI and enter password, click [Next].
- After entering the "Reset the device" page, keep waiting, go to the smart door lock operation, let it enter the network mode.
- Point the QR code of the mobile phone at the camera. When the lock end plays a "stomp" prompt tone, click "I Hear a prompt" to enter the distribution state.

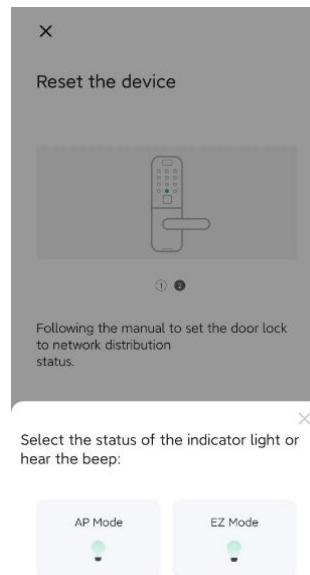
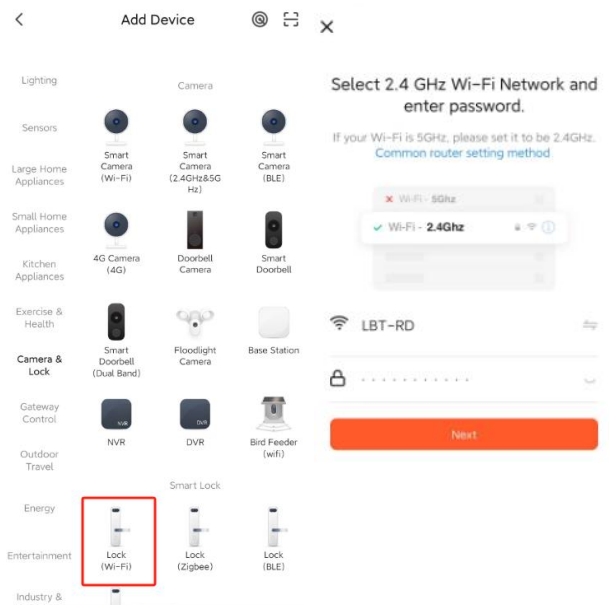

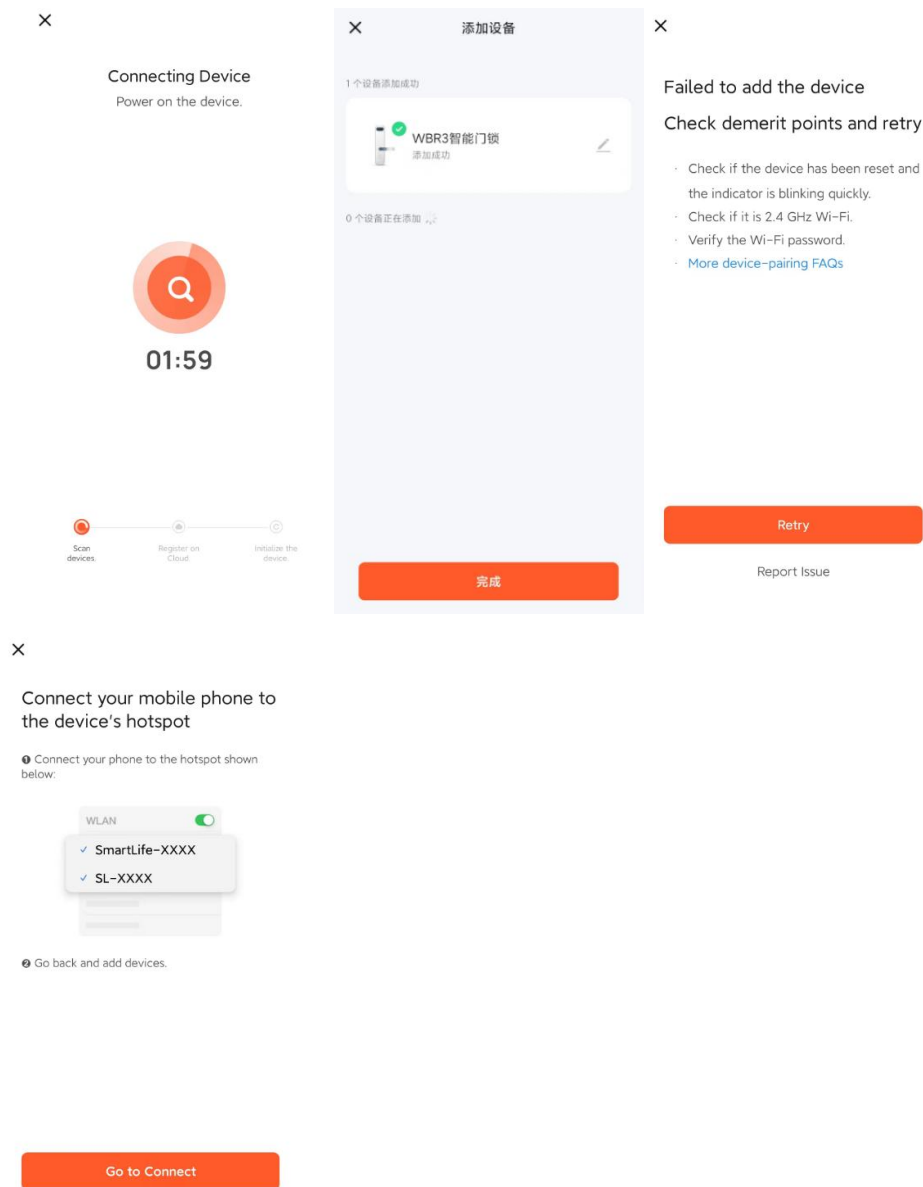

2) Bluetooth distribution network

- Press * and # on the door lock and enter the administrator password to enter the networking Settings;
- The voice prompt on the lock end is "Network configuration, please wait". Check whether the mobile phone has a prompt "Turn on Bluetooth" (Bluetooth is not enabled). If it is not enabled, turn on the Bluetooth function of the mobile phone;
- The mobile phone prompts "Discover device", click Add, enter the router wifi information, click Next to enter the device add process;
- If the network connection is successful, the APP will display "Add success", you can click "finish", and the door lock will prompt "Operation success"; Otherwise, the system displays "Operation Failed."

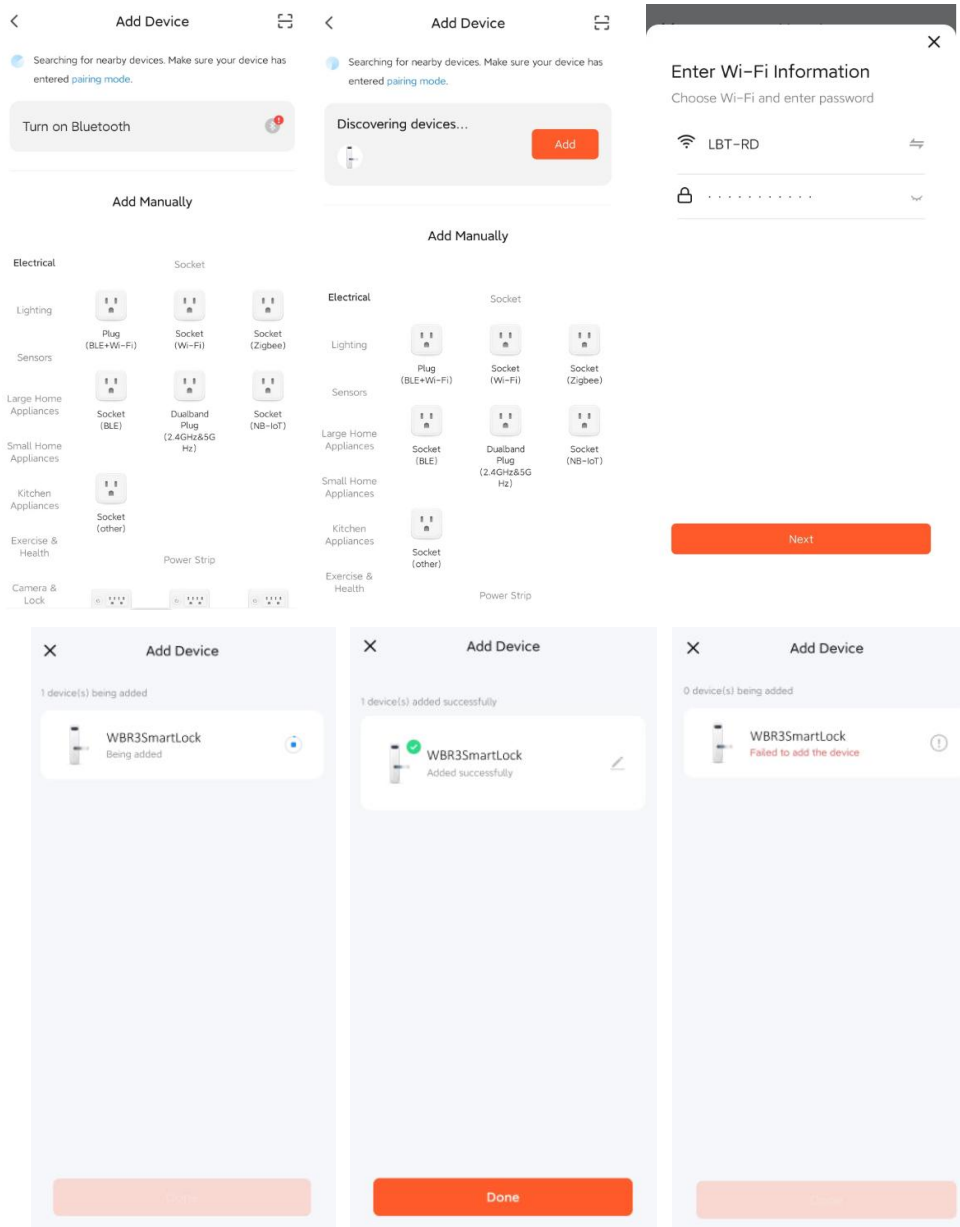

2、Remote unlocking

- When the doorbell rings, the user's mobile phone can receive a remote unlock message push.
- Hold down the icon button and swipe to unlock it.

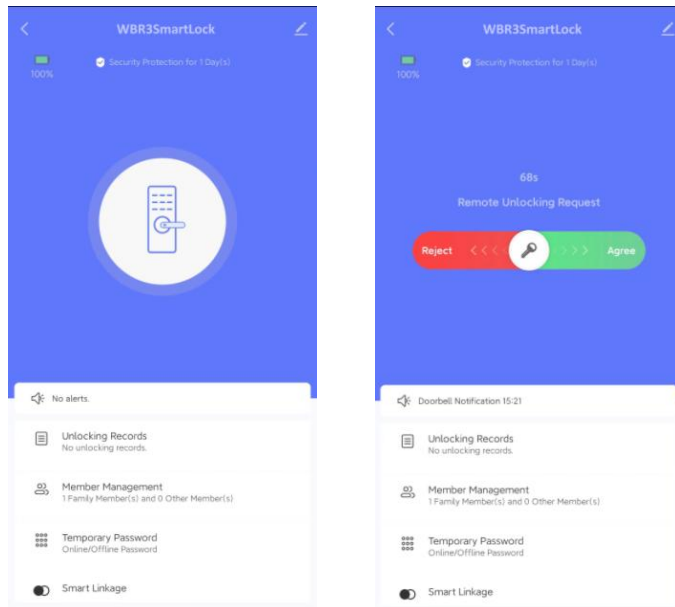

3、Record query

Doorbell push, illegal user alarm, low power alarm, unlocking and other messages can be recorded and queried.

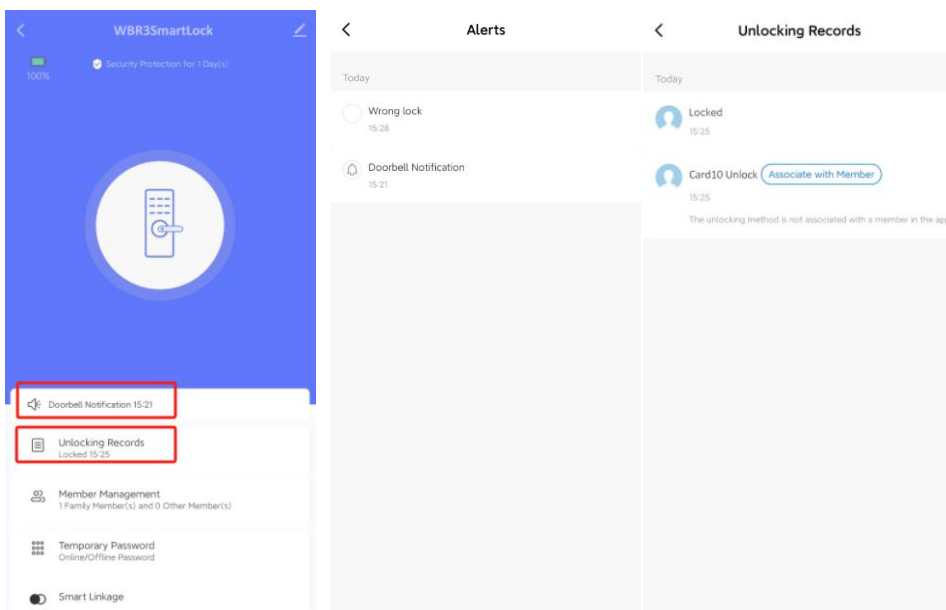

4、Member management

- Click [Member Management] to enter the member management page.
- Click [+] in the upper right corner to select other members.
- Enter the name of the member to be bound.
- On the Member information page, click Manage Unlock Mode.
- Select the user number to be bound and click OK

Note: Account number - User code generated when the door lock is added.

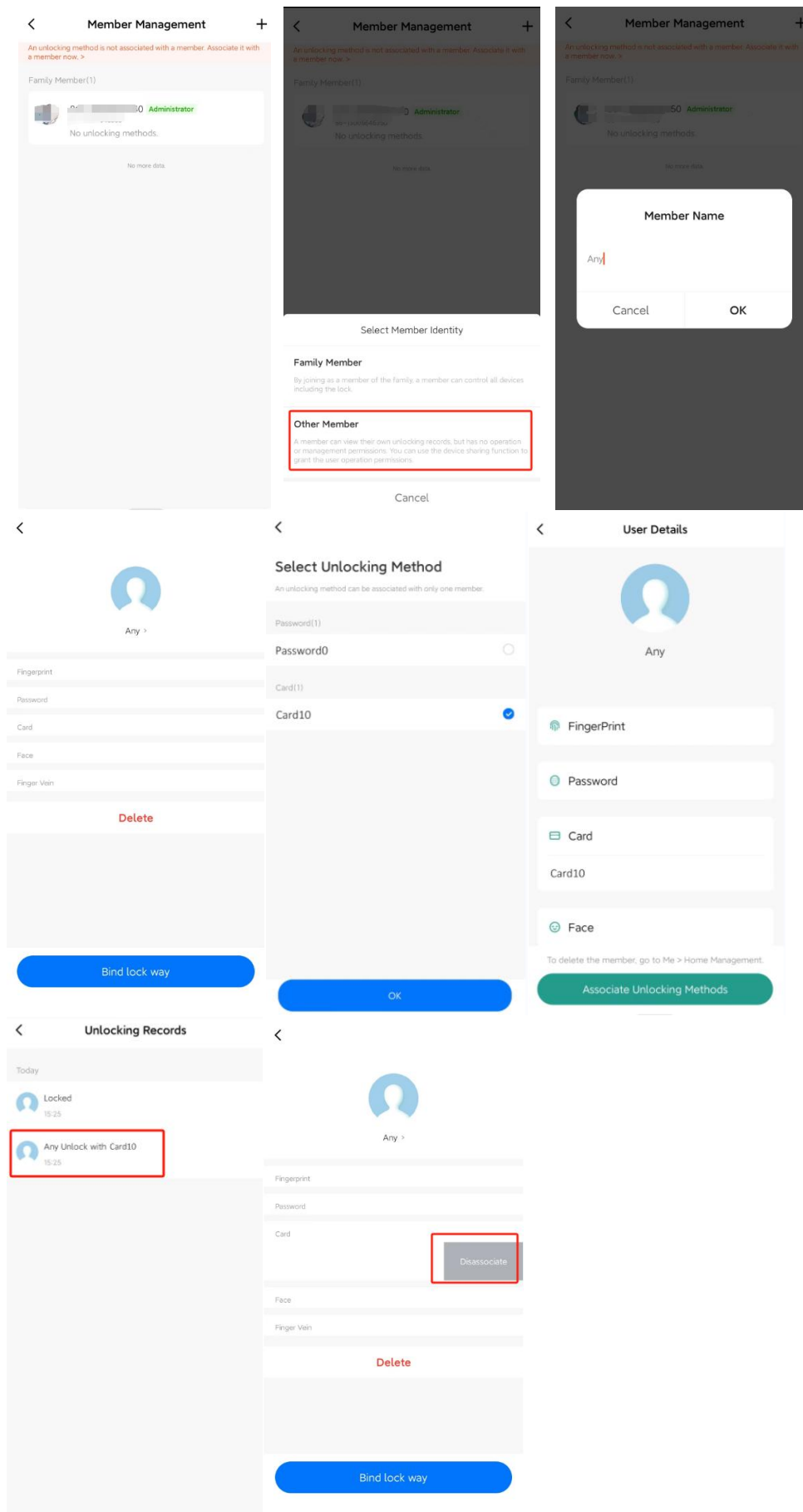

5、Temporary password

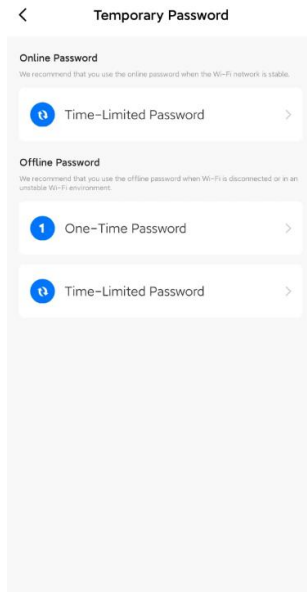

1) One-time password

Select a one-time password and click Add or the + sign in the top right corner; Click to obtain the password, the system automatically generates a set of ten-digit password, click to complete.

The password must be used within 6 hours after it is generated. The password can only be used once within the valid period.

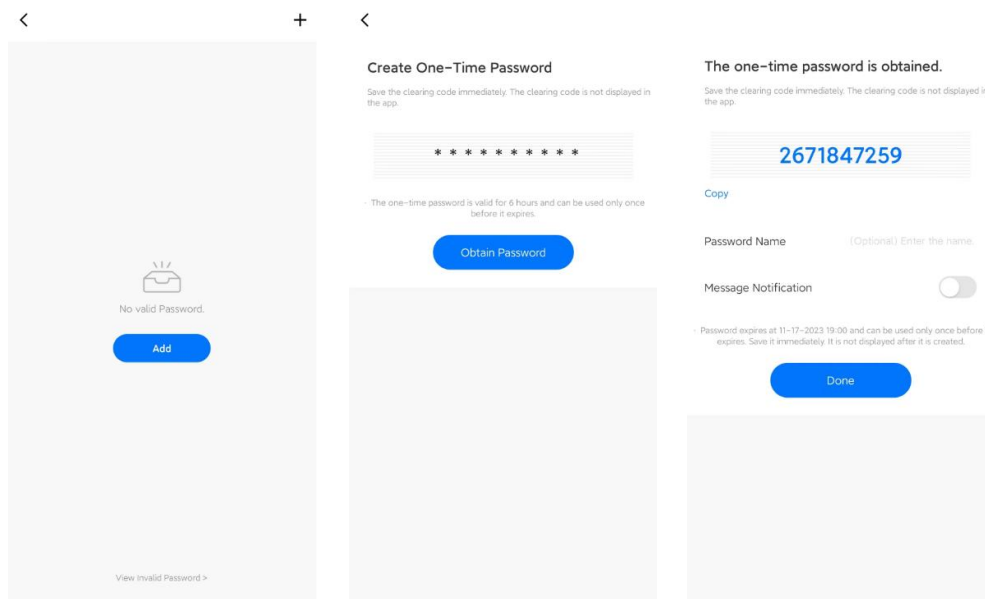

2) Unlimited password

Select an unlimited password and click Add or the + sign in the top right corner; Select effective time and implementation time; Click to obtain the password, the system automatically generates a set of ten-digit password, click to complete.

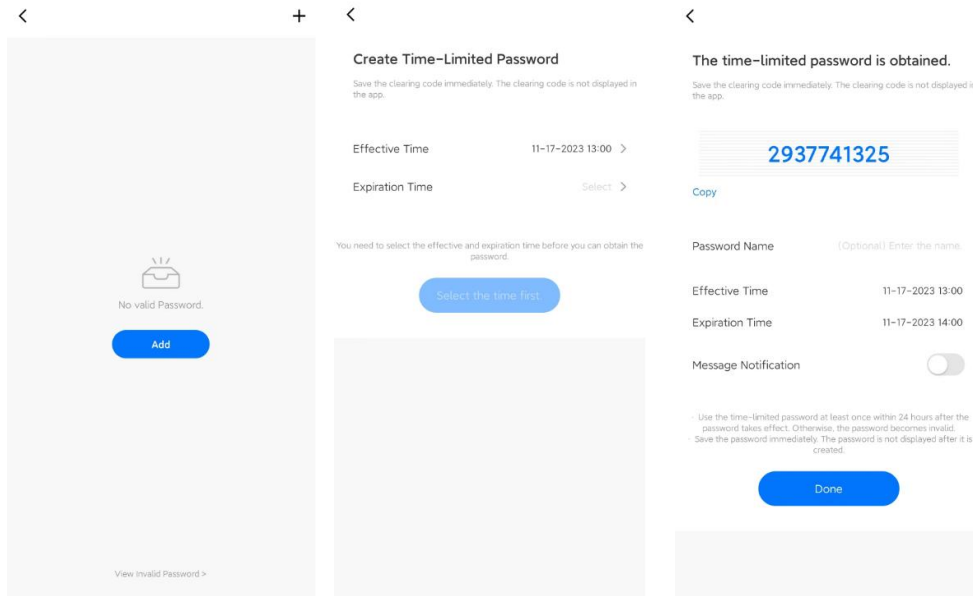

FCC Caution:

This device complies with part 15 of the FCC Rules. Operation is subject to the following two conditions: (1) this device may not cause harmful interference, and (2) this device must accept any interference received, including interference that may cause undesired operation.

Any changes or modifications not expressly approved by the party responsible for compliance could void the user's authority to operate the equipment.

NOTE: This equipment has been tested and found to comply with the limits for a Class B digital device, pursuant to Part 15 of the FCC Rules. These limits are designed to provide reasonable protection against harmful interference in a residential installation. This equipment generates, uses and can radiate radio frequency energy and, if not installed and used in accordance with the instructions, may cause harmful interference to radio communications. However, there is no guarantee that interference will not occur in a particular installation.

If this equipment does cause harmful interference to radio or television reception, which can be determined by turning the equipment off and on, the user is encouraged to try to correct the interference by one or more of the following measures:

- Reorient or relocate the receiving antenna.
- Increase the separation between the equipment and receiver.
- Connect the equipment into an outlet on a circuit different from that to which the receiver is connected.
- Consult the dealer or an experienced radio/TV technician for help.

To maintain compliance with FCC's RF Exposure guidelines, This equipment should be installed and operated with minimum distance between 20cm the radiator your body: Use only the supplied antenna.