

Fig.3

#### CLEANING INSTRUCTIONS

Cleaning behind the heater

It is very easy to clean behind it. Holding both sides of the heater, lift upwards and then pull forwards. The heater requires regular cleaning, to ensure trouble-free operation:

- Isolate the power supply to the heater before cleaning.
- Ensure that the heater has been allowed to cool down completely before cleaning.
- Use a damp cloth (not wet) to wipe the exterior of the heater to remove dust and dirt.
- Use a vacuum cleaner to remove dust and fluff from around the grilles. (Failure to do this may cause discoloration)
- Ensure the heater is dry before connecting back into the mains supply.

#### SERVICE

When you require service, contact your local dealer.

#### REPLACEMENT OF SUPPLY CORD

The supply cord damaged must be replaced by a service agent or equivalent qualified person in order to prevent a hazard.

#### STORAGE

If you do not plan to use the heater for extended periods of time, it is recommended that the heater is cleaned and then stored (preferably in its original packaging) in a cool dry place.

# TECXERLLON

## CONVECTION HEATER User Manual

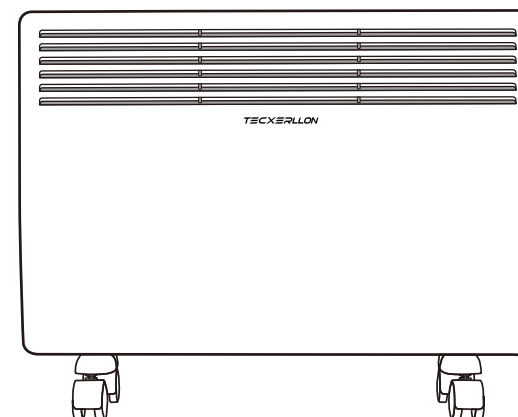

Model: TX-15KWWH / TX-15KWBK

User instructions  
Please read and save these **instructions**

## 100% Customer Satisfaction Guarantee

Customer experiences may vary, But We are dedicated to ensuring your satisfaction. If you experience any issues, please contact us at the email provided, and we'll promptly resolve them to your satisfaction.

### 1.Received a Used Product

If Amazon mistakenly delivers a used product, please provide your order number and shipping address. We will ship a new replacement immediately.

### 2.Defective or Missing Accessories

If your product arrives defective or with missing accessories, we'll send a replacement within 24 hours at no additional cost.

### 3.Damage Within One Year

If your device is damaged during use within one year of purchase, we'll send a free replacement within 24 hours.

### 4.Satisfaction Guaranteed

If you're dissatisfied for any reason, such as style, a description mismatch, or a change of mind, you can request a quicker refund directly from us than through Amazon.

### 5.Dedicated Customer Support

For any concerns or issues, let us know. We resolve most problems within 24 hours.



support@tecxerllon.com

## Download APP

Scan the QR code below for a simple download using your smart device. Alternatively, search 'Smart Life' on your device application store to download.

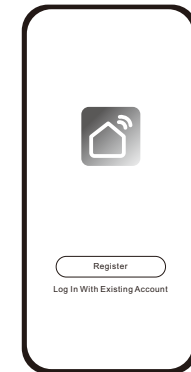

### Connect Heater

1. Enter the interface.
2. Click the + icon in the upper right-hand corner or alternatively press Add Device.
3. Go to Small Home Appliances and select Heater.
4. Enter the corresponding password to the chosen Wi-Fi network account.
5. Check that the Wi-Fi icon is blinking on the device and tick the 'Confirm indicator rapidly blinking' box. If the indicator is not blinking reset the Wi-Fi (see Operation Instructions).
6. Set the device information and press Done to enter the control interface where you will now be able to control the heater.

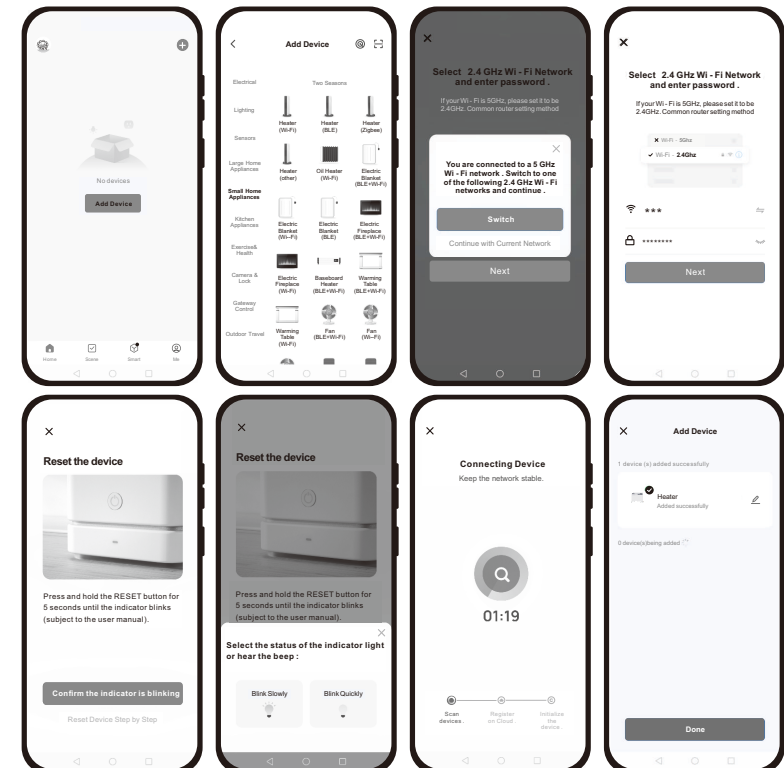

## OPERATION

### GETTING STARTED

- Carefully remove the heater from the box (keep the box for off-season storage).
- Ensure the power switch is turned off before plugging the unit in.
- Make sure the heater is safely installed in accordance with the installation instructions.
- It is best to avoid using the heater in an outlet that is already being used for other high-power electrical equipment, to avoid overloading the circuit.

### POWER ON

- When the product is connected to the power supply, the power indicator will illuminate and the Wi-Fi indicator (📶) will begin to flash.
- Press the power button (🔌) to switch the unit on.

### POWER OFF

- Hold the power button (🔌) for three seconds to switch the unit off.

### HALF POWER AND FULL POWER SELECTION

- Press the heating power button (🔥) to change the power to partial or full load.
- At full heating capacity, "HI" is shown on the display and the half heating capacity "LO" is deactivated.
- In the case of partial capacity heating, "LO" is activated on the display and "HI" is deactivated.

### WIFI RESET

- Hold the heat capacity button (🔥) for 5 seconds to re-set the Wi-Fi.
- Tip: Make sure to use the same WiFi network before using it. Please turn on the WiFi and Bluetooth functions of your mobile device before connecting to the heater.

### SETTING THE TEMPERATURE

- The unit of measure for the target temperature is .
  - Press the Power/Set button (🔌), and then select a temperature using the up (⬆) and down (⬇) buttons. The temperature range is between 41 and 113°F.
  - If no action is taken for 10 seconds after the setting is completed, the system automatically saves the setting and exits the menu.
- Temperature Setting Range is 41-113°F. But  
L0-L9 corresponds to 100-109°F  
C0-C3 corresponds to 110-113°F  
The full temperature is shown on the WiFi-enabled app

### SETTING THE TIMER 24 HOUR SHUTDOWN

- Press the Power/Set button (🔌) twice then use the up (⬆) and down (⬇) buttons to select a shutdown timer within 24 hours.
- When a timer is set the Timer Indicator (🕒) will illuminate.

### SIGNAL SOUND

- An acoustic signal sounds each time a key is pressed on the unit. If a button is held continuously the unit will only signal once.

### CHILD LOCK

- When the unit is in operation, press the up (⬆) and down (⬇) buttons simultaneously for 3 seconds.
- The control panel will now be locked.

### UNLOCK CHILD LOCK

- Press the up (⬆) and down (⬇) buttons simultaneously for 3 seconds.



## Caution

**1. In order to avoid overheating, do not cover the heater**

**2. Some parts of this product may become very hot and may cause burns. Particular attention should be paid to areas where children and vulnerable persons are present.**

**3. This heater must ONLY be operated at 120V (±10%) as specified on the nameplate.**

**4. A slight odor during initial use is normal. This is caused by a protective oil coating on the heating element and will dissipate within 30 minutes. Rest assured, this is safe.**



**DO NOT COVER**



**HOT SURFACE DURING USE, DO NOT TOUCH**

\*Please use the heater in accordance with this instruction manual. To avoid fire, electric shock or injury, do not use this heater with instructions from other manufacturers' products.

Thank you for purchasing our product! To help you get the best performance from it, please read this manual carefully before use and keep it handy for future reference.

## SAFETY INSTRUCTIONS

1. This heater must only be operated at 120V AC/60Hz ( $\pm 10\%$ ) as specified on the nameplate.
2. Do not block air intakes or outlets. Keep flammable materials at least 3 feet (1 meter) from front, sides, and rear. Overheating may cause fire.
3. Install away from other heat-producing appliances.
4. NEVER use near:
  - Gas lines or fuel storage areas
  - Locations where paint or flammable liquids are used/stored\*
5. Avoid skin contact with hot surfaces. Allow unit to cool completely before relocating.
6. Do not dry clothing or place items on the heater
7. Never insert objects into vents. Metallic items may cause electric shock, fire, or damage.
8. Do not immerse in water or allow liquid ingress. Electric shock hazard exists.
10. Ensure hands are completely dry before touching unit.
12. Do not install near windows. Curtain contact may cause fire or shock.
13. Regularly remove dust and filth with a soft, damp cloth.
14. Complete installation before powering on.
15. Not for outdoor, damp, or wet locations. Keep away from tubs, showers, and pools.
16. Secure firmly to wall in upright position per installation manual.
17. CORD SAFETY
  - Never coil power cord during use
  - Extension cords not recommended
  - Keep cord away from hot surfaces
  - Avoid high-traffic areas to prevent tripping
  - Prevent sharp bends or abrasion
18. Unplug when not in use.
19. NOT SUITABLE for rooms with shag carpeting.
21. Store ONLY after complete cooling.
22. Not for use by children or persons with reduced abilities. Prevent children from playing near unit.
24. Do not install directly below electrical receptacles.
25. Damaged outer casings expose live parts. Replace compromised parts immediately.
26. Protect power cord from pets. Exposure to liquids or chewing may cause shock.
27. Ensure unit is stably mounted before operation.

## Ceiling/Picture frame

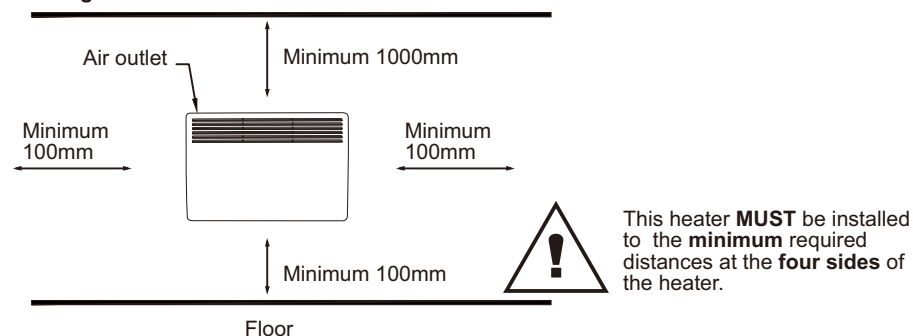

## Caster Installation&removal

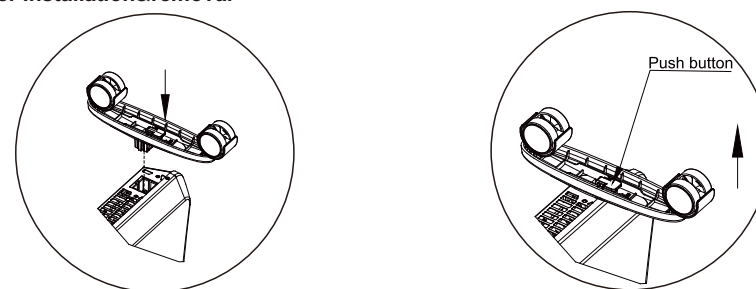

if the installation is complete, it's will hear a sound click.

press the button up, take down the caster

## Control panel

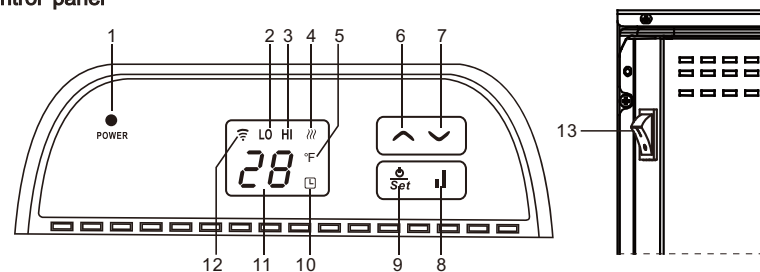

## Guide to the control panel

- |  |  |
|--|--|
| 1. Power icon                          | 9. Power/Set Button                          |
| 2. Half Power icon (LO)                | 10. Timer icon                               |
| 3. Full Power icon (HI)                | 11. Temperature And Time icon                |
| 4. Heating icon                        | 12. Wi-Fi icon                               |
| 5. Temperature Measure                 | 13. Power Switch                             |
| 6. Upward Adjustment Button            | 14. Range 100-109°F → Display shows L0 to L9 |
| 7. Downward Adjustment Button          | 15. Range 110-113°F → Display shows C0 to C3 |
| 8. Select Full/Half Capacity Heat Mode |  |

## Mounting Guide

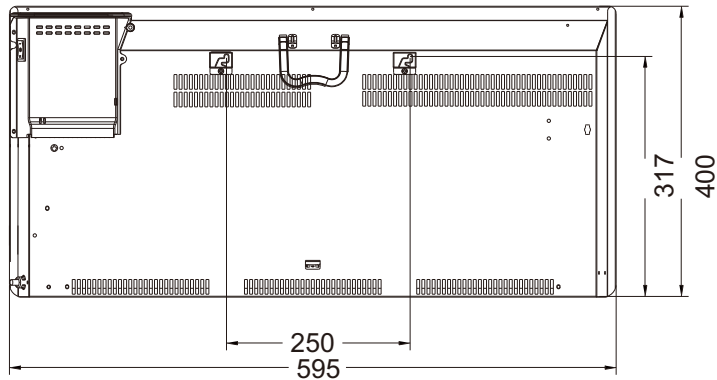

### Wall mounted mode

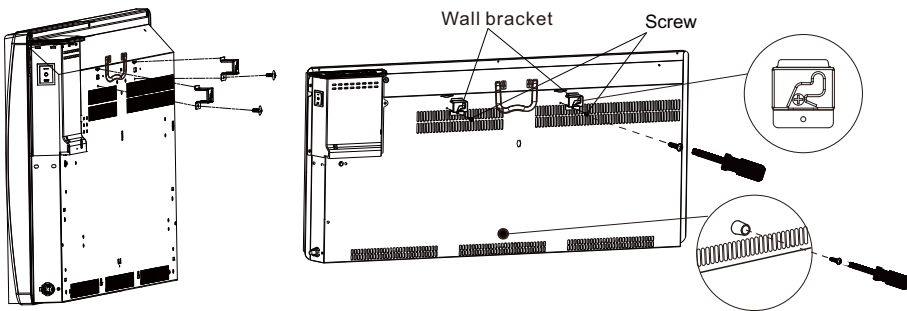

1. Insert the wall bracket into the hole, lift it up to align the screw holes, and tighten the screws (Allow 3-5 mm clearance for product installation).
2. Press the rubber pad (in the hole), fasten it with screw.

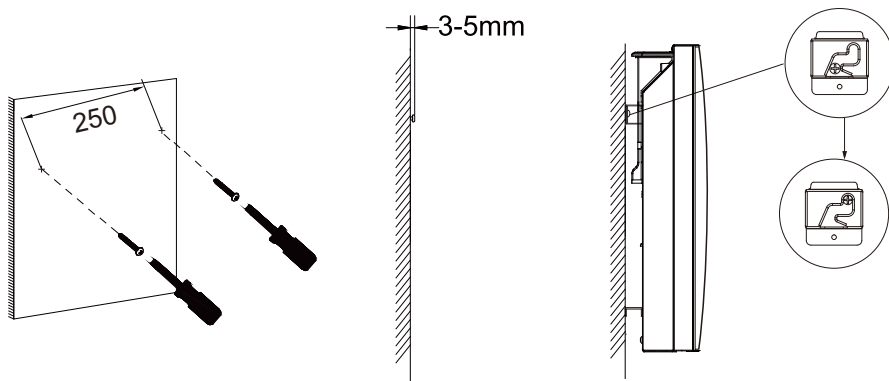

## IMPORTANT

**CAUTION:** Some parts of this product can become very hot and cause burns. Particular attention has to be given where children and vulnerable people are present.

**WARNING:** In order to avoid overheating, do not cover the heater.

**WARNING:** The heater must not be located immediately below a socket outlet.

**WARNING:** The heater must not be used if the front panel is damaged.

**WARNING:** Do not use this heater in small rooms when they are occupied by persons not capable of leaving the room on their own, unless constant supervision is provided.

**CAUTION:** In order to avoid a hazard due to inadvertent resetting of the thermal cutout, this appliance must not be supplied through an external switching device, such as a timer, or connected to a circuit that is regularly switched on and off by the utility.

- This appliance can be used by children aged from 8 years and above and persons with reduced physical, sensory or mental capabilities or lack of experience and knowledge if they have been given supervision or instruction concerning use of the appliance in a safe way and understand the hazards involved. Children shall not play with the appliance. Cleaning and user maintenance shall not be made by children without supervision.
- Children of less than 3 years should be kept away unless continuously supervised.
- Children aged from 3 years and less than 8 years shall only switch on/off the appliance provided that it has been placed or installed in its intended normal operating position and they have been given supervision or instruction concerning use of the appliance in a safe way and understand the hazards involved. Children aged from 3 years and less than 8 years shall not plug in, regulate and clean the appliance or perform user maintenance.
- If the supply cord is damaged, it must be replaced by the manufacturer, its service agent or similarly qualified persons in order to avoid a hazard.
- To reduce the risk of fire, keep textiles, curtains, or any other flammable material at a minimum distance of 1m from the heater.
- Remove all firm, liquid and gaseous materials that might ignite from the heating area of the appliance.
- Never insert any fingers or foreign objects into the openings of the appliance.
- Connect the power plug to an easily reachable socket outlet so that in case of an emergency the appliance can be unplugged immediately. Pull the power plug out of the socket outlet to completely disconnect the appliance from the voltage.

ELECTRICAL CONNECTION

This heater is for use on 120 volts. The cord has a plug as shown at A in below Figure. An adapter as shown at C is available for connecting three-blade grounding-type plugs to two-slot receptacles.

The green grounding lug extending from the adapter must be connected to a permanent ground such as a properly grounded outlet box. The adapter should not be used if a three-slot grounded receptacle is available.

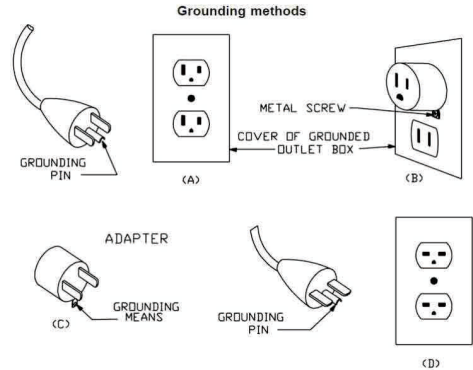

FCC Warning

This device complies with part 15 of the FCC Rules. Operation is subject to the following two conditions. (1) This device may not cause harmful interference, and (2) this device must accept any interference received, including interference that may cause undesired operation.

Note: This equipment has been tested and found to comply with the limits for a Class B digital device, pursuant to part 15 of the FCC Rules. These limits are designed to provide reasonable protection against harmful interference in a residential installation. This equipment generates, uses and can radiate radio frequency energy and, if not installed and used in accordance with the instructions, may cause harmful interference to radio communications. However, there is no guarantee that interference will not occur in a particular installation. If this equipment does cause harmful interference to radio or television reception, which can be determined by turning the equipment off and on, the user is encouraged to try to correct the interference by one or more of the following measures:

- Reorient or relocate the receiving antenna.
- Increase the separation between the equipment and receiver.
- Connect the equipment into an outlet on a circuit different from that to which the receiver is connected.
- Consult the dealer or an experienced radio/TV technician for help.

Note: The Grantee is not responsible for any changes or modifications not expressly approved by the party responsible for compliance. such modifications could void the user's authority to operate the equipment.

To maintain compliance with FCC's RF exposure guidelines, the distance must be at least 20cm between the radiator and your body, and fully supported by the operating and installation configurations of the transmitter and its antenna(s).

Overview of the appliance

Fig.1

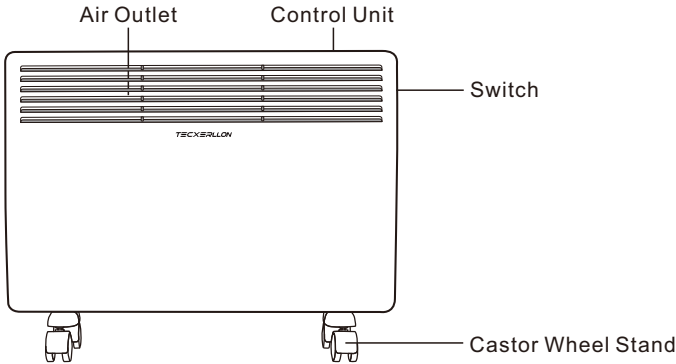

Specifications

Model Number	TX-15KWWH / TX-15KWBK
Rated Power	1500W
Rated Voltage	120V~ 60Hz
Dimensions (mm )	595*90*400

Circuit Diagram

