



REMOTE CONTROL ANTI-THEFT BIKE HORN



Accessory List

Horn *1

Fixed bracket *1

Remote control *1

Remote control holder *1

Remote control anti-slip mat *1

Remote Control Strap *2

25.4 Washer *1

22.2 Washer*1

Phillips screwdriver *1

HEX 3mm *1

M4 nut *1

M4X14 screw *1

Type-C cable *1

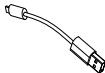

Horn Parameters

Model: EH-2PRO

Decibel: 120dB

Material: Plastic

Weight: about 45g

Standby: >60 days

Receiving frequency: 433.92MHz

Waterproof rating: IPX5

Battery parameters: 300mAh/3.7V/1.11Wh

Charging input: DC5V-260mA

Charging time: 1 hour 55 minutes

Colour: red, blue, black

Remote Control Parameters

Material: plastic

Transmission frequency: 433.92MHz

Remote control distance: <25 metres

Weight: about 17.2g

Standby: >60 days

Waterproof grade: IPX5

Battery parameters: CR2032/3V

Usage

1. Remote control pairing

Press and hold the unlock button of the remote control, then press the button on the horn 2 times quickly, when the horn emits a locking sound effect, it means the remote control is paired successfully.

2. There is only one button on the horn, a mode of sound, click the button to sound, long press the button horn sound will only sound for 1 second; long press the button for 5 seconds, the horn will shut down, shut down can not be controlled using the remote control, at this time click the button on the horn, you can switch on the power (it is recommended that the horn be switched off when it is not in use for a long time)

3. There are three buttons on the remote control, which are lock, unlock and ring.

Installation

① Depending on the diameter of the handlebar, choose to use a washer of the corresponding size, or install it directly.

② Lock the mounting bracket screws with the matching hexagonal spanner.



③ Align and push the slot at the bottom of the speaker into the slot of the fixing bracket, and then use a screwdriver to lock the screw at the end of the horn.



④ Remote control base installation:

First assemble the rubber pad to the bottom of the remote control mount, so that its 4 posts are stuck to the corresponding position on the remote control mount disk; then install it to the appropriate position on the handlebar (note that the two slots on the remote control mount are positioned one in front and one in the back) and finally cross-tie it with two straps to adjust the appropriate position.

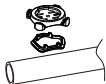

⑤ Remote control installation:

First, align the two tabs at the bottom with the two slots of the remote control holder, then press down and rotate it about 90 degrees to snap it tightly, and when you take out the remote control, rotate the remote control about 90 degrees to take it out.



Charging method

- ① Lift the waterproof plug at the back of the horn, and then plug the charging cable into the charging port inside to charge;
- ② Charging port position red light, fully charged green light;
- ③ When charging is completed, pull out the charging cable and make sure to install the waterproof plug.



Removing Insulation Tabs

Replacing Batteries in Remote Control

- ① First time use, please take out the insulating sheet of CR2032 battery first;
- ② Take out the two screws at the bottom of the remote control, and then take out the bottom cover;
- ③ Replace the CR2032 battery, the positive pole of the battery facing out, put it into the battery compartment of the remote control, and then install the bottom cover, and finally use 2 screws to lock it.

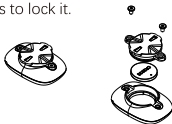

Maintenance issues

- ① Do not press the keys with sharp objects to avoid damaging the silicone keys.
- ② The product has a certain degree of waterproof performance, but please avoid soaking in water for a long time.
- ③ When not in use for a long time, please long press the horn button for 5 seconds to switch off the horn.

Note

- ① Do not use this product in a crowded room, so as not to cause trouble to others.
 - ② The product has a built-in battery, keep the product away from fire and high temperature objects.
- When replacing the CR2032 battery of the remote control, please dispose of the waste battery according to local environmental regulations.

Certification

RoHS
compliant

**UK
CA**

CE



FCC



**PS
E**



MADE IN CHINA

Manufacturer: Shenzhen Hongbo Kechuang Technology Co., LTD
Address: No.12 Tianxi Road, Fucheng Street, Longhua District,
Shenzhen, Guangdong, China
Website: www.sztwooc.com
Technical support email: techsupport@sztwooc.com

Button Battery Warning:The product contains a removable button battery, please prevent children from accidentally ingesting it, if children experience the following symptoms, please seek medical attention immediately.

No obvious symptoms

Unfortunately, when a button battery or button cell gets stuck in a child's oesophagus (food pipe) there are no specific symptoms associated with this.

The child may.

Cough, vomit or drool.

Seem to have an upset stomach or a virus.

Be sick.

Point to their throat or stomach.

Have pain in the abdomen, chest or throat.

Tired or lethargic.

Quieter than usual or more clingy or otherwise 'not themselves' Loss of appetite or loss of appetite

Don't want to eat solid food / can't eat solid food.

These symptoms may change or fluctuate and then subside as the pain increases.

A specific symptom of button battery and button battery ingestion is vomiting fresh (bright red) blood.



BATTERY WARNING

KEEP OUT OF REACH OF CHILDREN

Swallowing can lead to chemical burns, perforation of soft tissue, and death. Severe burns can occur within 2 hours of ingestion. Seek medical attention immediately.



WARNING

- **INGESTION HAZARD:** This product contains a button cell or coin battery.
- **DEATH** or serious injury can occur if ingested.
- A swallowed button cell or coin battery can cause **Internal Chemical Burns** in as little as **2 hours**.
- **KEEP** new and used batteries **OUT OF REACH** of **CHILDREN**
- **Seek immediate medical attention** if a battery is suspected to be swallowed or inserted inside any part of the body.



- Keep in original package until ready to use;
- Immediately dispose of used batteries and keep away from children. Do NOT dispose of batteries in household trash.



RIDING SAFETY GUARDIAN

FCC Caution:

This device complies with part 15 of the FCC Rules. Operation is subject to the following two conditions: (1) This device may not cause harmful interference, and (2) this device must accept any interference received, including interference that may cause undesired operation.

Any changes or modifications not expressly approved by the party responsible for compliance could void the user's authority to operate the equipment.

NOTE: This equipment has been tested and found to comply with the limits for a Class B digital device, pursuant to Part 15 of the FCC Rules. These limits are designed to provide reasonable protection against harmful interference in a residential installation. This equipment generates, uses and can radiate radio frequency energy and, if not installed and used in accordance with the instructions, may cause harmful interference to radio communications. However, there is no guarantee that interference will not occur in a particular installation. If this equipment does cause harmful interference to radio or television reception,

which can be determined by turning the equipment off and on, the user is encouraged to try to correct the interference by one or more of the following measures:

- Reorient or relocate the receiving antenna.
- Increase the separation between the equipment and receiver.
- Connect the equipment into an outlet on a circuit different from that to which the receiver is connected.
- Consult the dealer or an experienced radio/TV technician for help.

The device has been evaluated to meet general RF exposure requirement. The device can be used in portable exposure condition without restriction.