

User Manual

Model:JL-NEON714-5V

FCC ID: 2BR6E-JL-NEON714

Packsging content

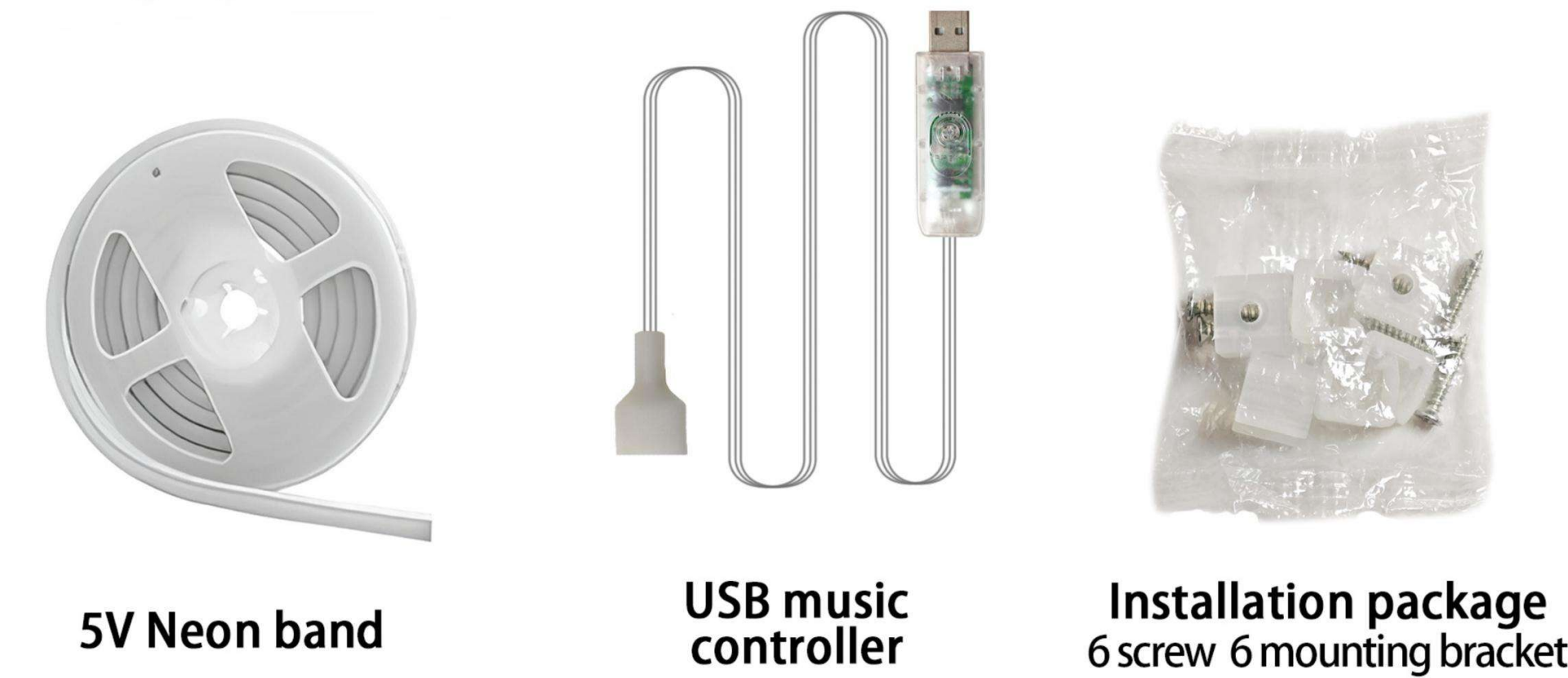

Input	DC5V-2A	Colork	Colorful LED
Controlmode	APP	LED chip	Silicone Neon LED
B2ck Adhesive	Double-sided tape	Temperature	-20℃--45℃

Scan two-dimensional code download APP

Support APP remote control,scan the QR code on the modile phone,down-load and install the application

- 1.The light strip is connected to the controller,and the controller USB is plug and play
- 2.Scan the controller QR code and download the dimming app
- 3.Turn on Bluetooth,launch the application,search and connect to the controller to control the color change of the light

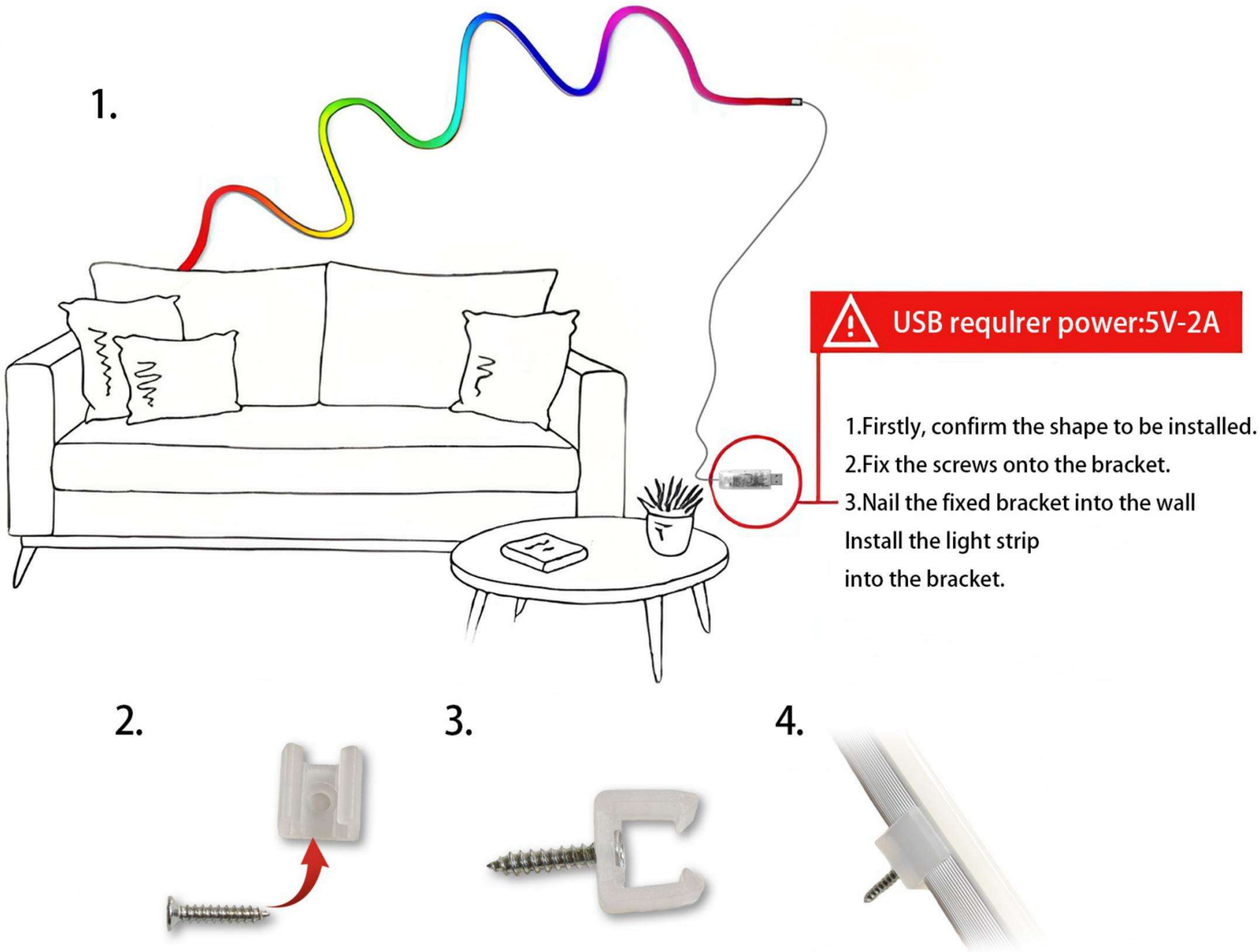

Use your imagination DIY various patterns

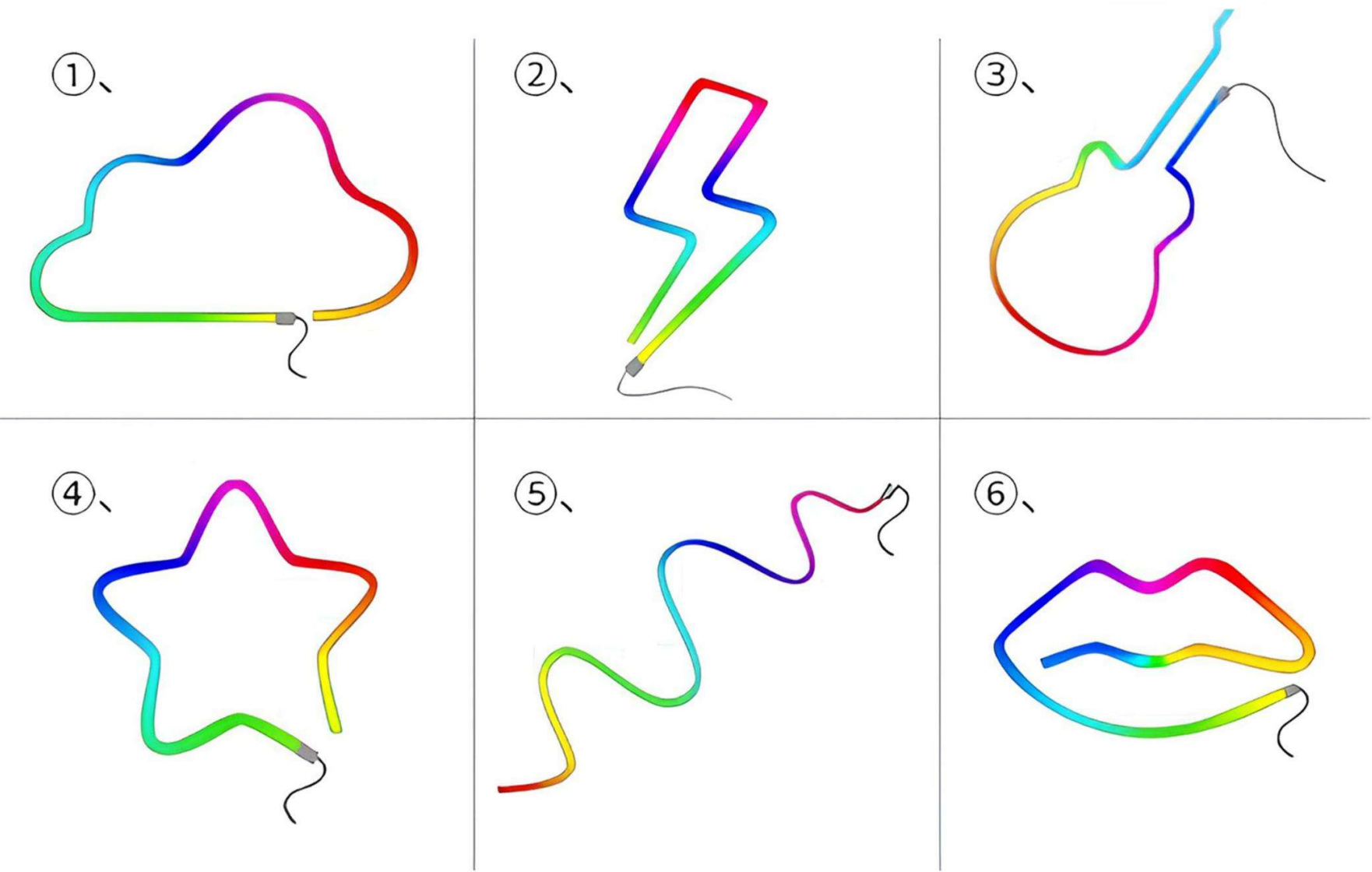

CAUTION:
Changes or modifications to this unit not expressly approved by the party responsible for compliance could void the user's authority to operate the equipment.

CAUTION:
This device complies with part 15 of the FCC Rules. Operation is subject to the following two conditions:(1) This device may not cause harmful interference, and (2) this device must accept any interference received, including interference that may cause undesired operation.

FCC Statement: This equipment has been tested and found to comply with the limits for a Class B digital device, pursuant to part 15 of the FCC Rules. These limits are designed to provide reasonable protection against harmful interference in a residential installation. This equipment generates, uses and can radiate radio frequency energy and, if not installed and used in accordance with the instructions, may cause harmful interference to radio communications. However, there is no guarantee that interference will not occur in a particular installation.

If this equipment does cause harmful interference to radio or television reception, which can be determined by turning the equipment off and on, the user is encouraged to try to correct the interference by one or more of the following measures:
—Reorient or relocate the receiving antenna.
—Increase the separation between the equipment and receiver.
—Connect the equipment into an outlet on a circuit different from that to which the receiver is connected.
—Consult the dealer or an experienced radio/TV technician for help.

RF exposure compliance statement:This device has been evaluated to meet the general RF exposure requirement.