

Morrivol 觅音探索



Morrivol Pro 声平衡技术开放式真无线耳机
用户手册

规格参数



产品名称	开放式耳机
型号	Morrirol Pro
版本	BT5.4
版本协议	A2DP,HFP,HSP,AVRCP,SBC,AAC
驱动单元大小	12mm
充电输入	USB-C 5V \equiv 0.5A
电池容量（耳机）	60mAh*2
电池容量（充电盒）	500mAh
保修	12个月

佩戴方法

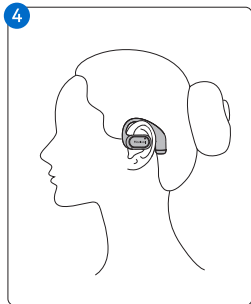
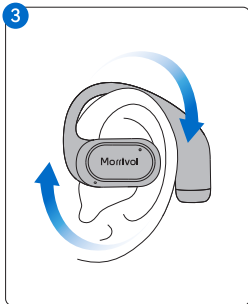
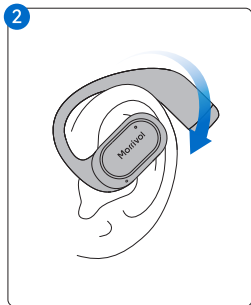
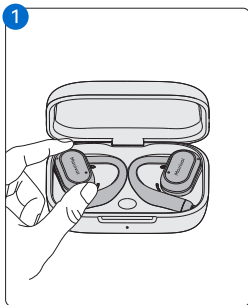

包装内容

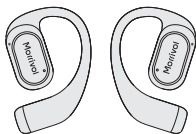

耳机x1



用户手册x1



充电仓x1

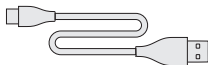

充电线x1

产品介绍



请使用标配的Type-C充电线进行充电

充电

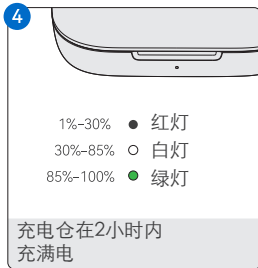
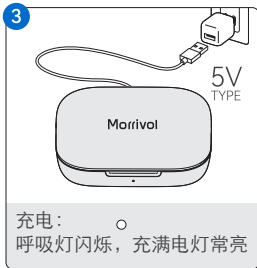

配件

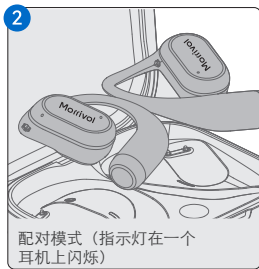

功能操作

🎵		📶	
	单击左边或右边	▶/⏸ 播放/暂停	📶 接听
	双击右边	▶▶ 下一曲	📶/📶 挂断/拒接
	双击左边	◀◀ 上一曲	📶/📶 挂断/拒接
	三击左边或右边	🎤 语音助手	/
	四击左边或右边	🎮 游戏模式	/
	长按左边	🔊- 音量减	🔊- 音量减
	长按右边	🔊+ 音量加	🔊+ 音量加

当听到声音滞后于视频时
请打开游戏模式
游戏模式默认关闭。

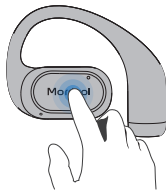

接触区域

耳机在仓内

耳机在仓外

开机

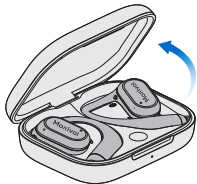

打开充电仓



长按3秒开机

关机



关闭充电仓



长按5秒关机

故障排除

充电器不充电

检查电源适配器是否正常工作，或者尝试使用不同的充电线。

耳机未连接到蓝牙或未找到蓝牙信号：

打开手机设置，删除蓝牙配对记录，然后搜索耳机蓝牙信号重新连接。

耳机不上电

保持充电仓有电，并尝试充电一段时间后开机。

恢复出厂设置

将耳机放入充电仓中，长按充电仓触摸区域8秒。当充电仓外红色LED灯亮1秒时，耳机白灯亮1秒，耳机恢复出厂设置成功。

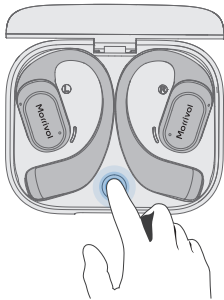

有毒有害物质名称及含量标识

有毒有害物质名称及含量标识						
部件名称	有毒有害物质或元素					
	铅 (Pb)	汞 (Hg)	镉 (Cd)	六价铬 (Cr(VI))	多溴联苯 (PBB)	多溴二苯醚 (PBDE)
耳机	○	○	○	○	○	○
电池	○	○	○	○	○	○
充电线	○	○	○	○	○	○

本表格依据 SJ/T 11364 的规定编制。

●:表示该有毒有害物质在该部件所有均质材料中的含量均在 SJ/T26572 标准规定的限量要求以下。

X:表示该有毒有害物在该部件的某一均质材料中的含量超出 SJ/T26572 标准规定的限量要求。

注:环保使用期限取决于产品正常工作的温度和湿度等条件。

本产品所含有的有害物质都是由于现阶段技术限制而找不到可供替代的物质导致的,符合中国《电器电子产品有害物质限制使用管理办法》的要求,且属于欧盟 RoHS 豁免范围内。在产品的设计时已经做了特别考虑,确保外观部件均采用无毒无害的绿色环保材料制造,消费者在正常使用情况下不会接触到有害物质,不会对人体造成危害。

安全信息

在使用和操作设备前,请阅读并遵守下面的注意事项,以确保设备性能最佳,并避免出现危险或非法情况:

- 1.请勿在多灰、潮湿、肮脏或靠近磁场的地方使用本设备,以免引起设备内部电路故障。
- 2.请勿将设备包裹、密封或在设备上覆盖毛巾及放置其它物品,请勿将设备放在盒子、箱子等封闭环境中使用。
- 3.请勿将设备靠近热源或裸露的火源,如电暖器、微波炉、炉火、热水器、蜡烛或其他可能产生高温的地方。
- 4.请勿使用微波炉或吹风机等外部加热设备对其进行干燥处理。
- 5.请勿使设备及其配件受到强烈的冲击或震动,以免损坏设备及其配件,导致电池爆炸或设备故障。
- 6.请使用清洁、干燥的软布擦拭设备。清洁和维护前请停止使用本设备。
- 7.请在温度 5°C~35°C 范围内使用本设备,并在温度 5°C~35°C 范围内存放设备及其配件。当环境温度过高或过低时,可能会引起设备故障。当温度低于 5°C 时,电池的性能会受到限制。
- 8.请将设备或其配件放置在通风、阴凉、无阳光直射的地方。
- 9.本设备并非玩具,儿童应在成人监护下使用本设备。本设备及其配件可能包含一些小零件,请将其放置在儿童接触不到的地方。儿童可能无意损坏设备及其配件,或吞下小零件导致窒息或其他危险。
- 10.本设备配有不可拆卸的内置可充电电池。请勿自行更换电池。电池只能由授权服务中心更换。
- 11.请勿擅自拆卸或改装设备及配件,否则该设备及配件将不在本公司保修范围之内,设备发生故障时请联系授权服务中心。
- 12.请勿将本设备及其配件作为普通的生活垃圾处理,请遵守本设备及其配件处理的本地法令,并支持回收行动。
- 13.在明文规定禁止使用无线设备的医疗和保健场所,请遵守该场所的规定,并关闭设备。
- 14.设备产生的无线电波可能会影响植入式医疗设备或个人医用设备的正常工作,如起搏器、植入耳蜗、助听器。若您使用了这些医用设备,请向其制造商咨询使用本设备的限制条件。
- 15.在使用本设备时,请与植入的医疗设备(如起搏器、植入耳蜗等)保持至少 15 厘米的距离。
- 16.使用未经许可或不兼容的电源、充电器或电池,可能引发火灾、爆炸或其他危险。消费者若使用电源适配器充电,则应购买配套使用获得 CCC 认证并满足标准要求的电源适配器。

Morrivol 觅音探索



Open Ear True Wireless Earbuds
with Sound Balance Technology
User Guide

SPECIFICATIONS



Product Name	Open earphones
Model	Morrival Pro
BT Version	BT5.4
BT Protocol	A2DP,HFP,HSP,AVRCP,SBC,AAC
Driver Unit Size	12mm
Charging Input	USB-C 5V \equiv 0.5A
Battery Capacity(Earphones)	60mAh*2
Battery Capacity(Charging Case)	500mAh
Warranty	12 months

WEARING METHOD

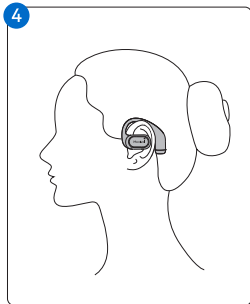
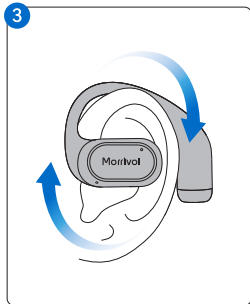
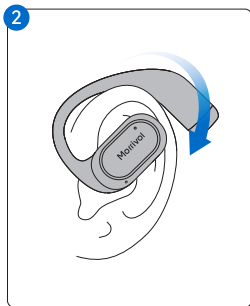
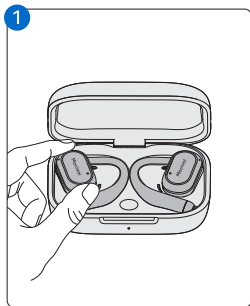

PACKAGE CONTENTS

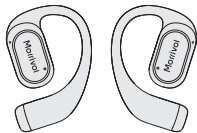

Headphone×1

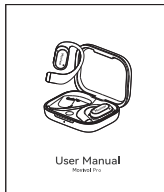

User Manual×1



Charging Case×1

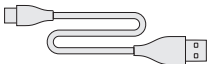

Charging Cable×1

PRODUCT INTERODUCTION

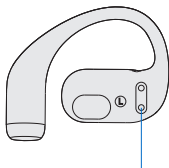
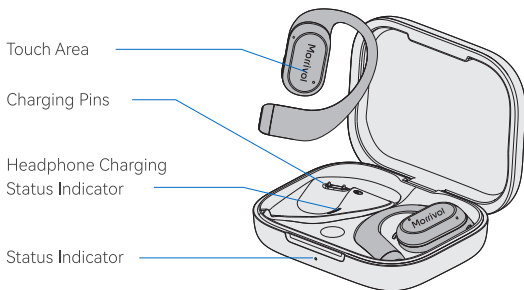

Charging Contacts

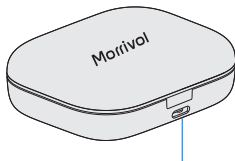

Charging Interface



Please use the provided Type-C Charging Cable to charge.

CHARGING

1

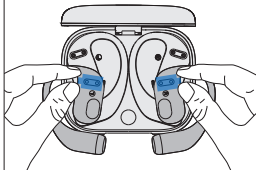

Please remove the insulating sheet and all protective stickers before the first use.

2

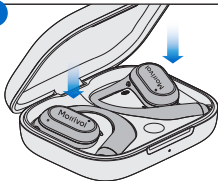

Put the Headphones into the charging case and the Headphones status indicator will light up.

3

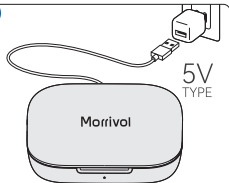

Charging : ○
Fully Charge : The light goes off.

4



1%~30% ● Red light
30%~85% ○ White light
85%~100% ● Green light

The charging case can be fully charged in 2 hours.

PAIRING

1

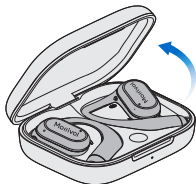

Automatic pairing after opening lid

2

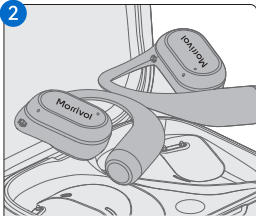

Pairing mode(indicator on one earphone only).

3

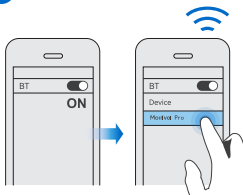







4



Power on and connected to a device.

FUNCTION

		🎵	☎
	(1x) L/R	▶	📞
	(2x) R	▶▶	🔊 / 📞
	(2x) L	◀◀	🔊 / 📞
	(3x) L/R	🗣 Voice Assistant	/
	(4x) L/R	🎮 Toggle Game Mode	/
	(HOLD L)	🔊-	🔊-
	(HOLD R)	🔊+	🔊+

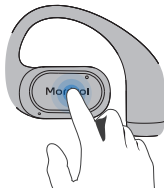

*Please turn on game mode when you notice that the sound is lagged behind the video

*Game mode is switched off by default.

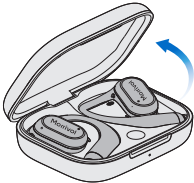
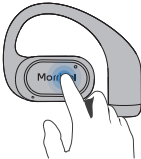

Touch area

POWER ON/OFF

	With Headphone Case	Without Headphone Case
Power On	 <p>Open the charging case</p>	 <p>Tap and hold for 3 seconds to power on a headphone individually.</p>
Power Off	 <p>Close the charging case</p>	 <p>Tap and hold for 5 seconds to power off a headphone individually</p>

TROUBLE SHOOTING

1.Charging case not charging:

Check if the power adapter is working, or try using a different charging cable.

2.Earphones not connecting to Bluetooth or Bluetooth signal not found:

Open your phone's settings, delete the Bluetooth pairing records, and then search for the earphones Bluetooth signal to reconnect.

3.Earphones won't power on:

Ensure the charging case has power and try charging the earphones for a while before attempting to power them on.

Restore Factory Settings

Put the earphones into the charging box and press and hold the touch area of the charging box for 8 seconds.

When the red LED light outside the charging compartment stays on for 1 second, the clear recording is completed.

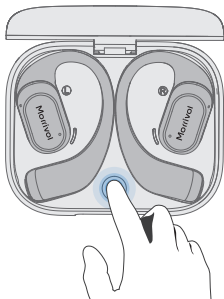

Toxic and Hazardous Substance Names and Content Labeling

Toxic and Hazardous Substance Names and Content Labeling						
Parts	Toxic and hazardous substances or elements					
	Plumbum (Pb)	Hydrargyrum (Hg)	Cadmium (Cd)	Chromium VI (Cr(VI))	polybrominated biphenyl (PBB)	Polybrominated diphenyl ethers (PBDE)
Earbuds	○	○	○	○	○	○
Battery	○	○	○	○	○	○
Charging cable	○	○	○	○	○	○

This form has been prepared according to the specifications of the SJ/T 11364.

● Indicates that the content of toxic and hazardous substances in all homogeneous materials of the component is below the limits specified in SJ/T 26572 standard.

⊗ Indicates that the content of the toxic and hazardous substance in a homogeneous material of the component exceeds the limit requirements specified in SJ/T 26572 standard.

Note: Service life depends on the temperature and humidity conditions in which the product normally operates.

Harmful substances contained in this product are due to technical constraints at this stage and no substitutes can be found, in accordance with the requirements of China's "Management Regulations on Restriction of the Use of Harmful Substances in Electrical and Electronic Products", and are exempted from the RoHS requirements of the European Union. Special care has been taken in the design of the product to ensure that the external parts are made of non-toxic and non-hazardous green environmentally friendly materials, and that consumers will not come into contact with hazardous substances during normal use, and that no harm will be caused to the human body.

Safety Information

Before using and operating the equipment, please read and observe the following precautions to ensure optimum performance and to avoid hazardous or illegal situations:

- do not use the equipment in dusty, damp, dirty or near magnetic fields as this may cause the internal circuitry of the equipment to malfunction.
- do not wrap, seal or cover the equipment with towels or place other objects on top of the equipment and do not use the equipment in an enclosed environment such as a box or case.
- do not place the product near heat sources or naked flames, such as electric heaters, microwave ovens, stoves, water heaters, candles, or other places where high temperatures may be generated.
- Do not dry the unit with external heat sources such as microwave ovens or hairdryers.
- Do not subject the product and its accessories to strong shocks or vibrations as this may damage the product and its accessories, cause the battery to explode or the product to malfunction.
- Wipe the unit with a clean, dry, soft cloth. Do not use the unit before cleaning and servicing.
- Use the unit within the temperature range of 5°C~35°C and store the unit and its accessories within the temperature range of 5°C~35°C. If the ambient temperature is too high or too low, it may cause the unit to malfunction. If the temperature is below 5°C, the performance of the battery will be limited.
- Please store the unit or its accessories in a ventilated, cool place without direct sunlight.
- This device is not a toy and children should use this device under adult supervision. This product and its accessories may contain small parts, so keep them out of the reach of children. Children may unintentionally damage the apparatus and its accessories or swallow small parts, resulting in suffocation or other hazards.

FCC Caution:

This device complies with part 15 of the FCC Rules. Operation is subject to the following two conditions: (1) This device may not cause harmful interference, and (2) this device must accept any interference received, including interference that may cause undesired operation.

Any changes or modifications not expressly approved by the party responsible for compliance could void the user's authority to operate the equipment.

NOTE: This equipment has been tested and found to comply with the limits for a Class B digital device, pursuant to Part 15 of the FCC Rules. These limits are designed to provide reasonable protection against harmful interference in a residential installation. This equipment generates, uses and can radiate radio frequency energy and, if not installed and used in accordance with the instructions, may cause harmful interference to radio communications. However, there is no guarantee that interference will not occur in a particular installation. If this equipment does cause harmful interference to radio or television reception, which can be determined by turning the equipment off and on, the user is encouraged to try to correct the interference by one or more of the following measures:

- Reorient or relocate the receiving antenna.
- Increase the separation between the equipment and receiver.
- Connect the equipment into an outlet on a circuit different from that to which the receiver is connected.
- Consult the dealer or an experienced radio/TV technician for help.

The device has been evaluated to meet general RF exposure requirement. The device can be used in portable exposure condition without restriction.