



星佳遥控

STAR HOME REMOTE CONTROL  
GOOD AND DURABLE

## PRODUCT USER MANUAL

# PRODUCT MANUAL

PLEASE READ THIS INSTRUCTION MANUAL CAREFULLY BEFORE  
INSTALLATION AND USE. THE INSTRUCTION MANUAL INCLUDES THE  
"PRODUCT WARRANTY CARD". PLEASE KEEP IT SAFE.

Shanghai Xingjia Electronic Technology Co., Ltd

## Warranty situation

### 1. Quality Assurance

(1) Our company guarantees that the products are in full compliance with all published specifications upon leaving the factory. As long as they are installed correctly, they can be used normally. However, our company does not guarantee that the operation of the products will be uninterrupted or error-free.

(2) This product is covered by a one-year warranty from the date of purchase, ensuring that customers will not encounter any quality issues within one year. If any quality defect is found within the warranty period, our company is willing to repair or replace the product with the same type. Any product requiring repair must be sent to the service center (dealer) designated by our company. The customer is responsible for the one-way shipping cost to the service center (dealer), and our company's service center (dealer) will complete the inspection and repair of the product within the warranty period and return it to the customer.

### 2. Maintenance items not included.

- (1) Worn parts such as buttons, relays, fuses, batteries, etc.
- (2) Damage to the circuit board due to installation.
- (3) Faults caused by improper use by the customer, force majeure, natural factors, lack of maintenance, negligence in the operating environment, unauthorized, incorrect usage, or customer-set interfaces.

### 3. Description

- (1) The above warranty matters, there are no other express or implied warranty matters.
- (2) This manual is formulated according to new regulations of the lifting industry, and some industries do not need safety.

Key, no such configuration, no separate description; fingerprint and other custom remote control, the instructions for use will be described separately.

(3) The provided maintenance is the only compensation to the customer, our company does not assume any direct, indirect, special, accidental or causal responsibility.

## Precautions

### 1. General Precautions

- (1) Persons without professional training are not allowed to disassemble the machine to avoid causing damage.
- (2) This manual is for reference only. For detailed technical issues, please consult the manufacturer or distributor.
- (3) The machine has been precisely tested before leaving the factory, it is prohibited to use it in high-risk situations or where damage may occur.
- (4) After use, the crane's main power supply should be turned off and the receiver's power should be cut off.
- (5) The transmitter should be placed in a safe place, and non-professionals should not press it arbitrarily to accidents.
- (6) The crane should have a main power relay, limit switch, and other safety facilities.
- (7) Use should be stopped in the event of lightning strike or interference.
- (8) Ensure that the transmitter battery is sufficient and the receiver power is normal.
- (9) When installing or repairing, the crane's main power supply and the power inside the receiver should be turned off to avoid electric shock.

(10) The manufacturer of this manual may modify the content at any time without further notice.

(11) Some of the technical aspects of this are not public, and the original factory may add new functions at any time, and its instructions may not match the machine.

### 2. Operator Precautions

- (1) Users must undergo professional pre-job training to be familiar with the operation methods.
- (2) Operators must be in good health, both physically and mentally, and be able to identify and judge the safety of the operation.
- (3) The product has a sturdy transmitter that withstand considerable impacts, but excessive or deliberate collisions and compressions may still cause damage.
- (4) The operator should pay attention to the indicator light on the transmitter. Under normal, the green light blinks when a key is pressed. If the red light continues to blink, there may be an abnormality or fault, or it could be that the power has been exhausted. In this case, the battery should be replaced immediately (two batteries must be replaced at the same time).
- (5) The operator should pay attention to the indicator light on the receiver. Under normal use, the power indicator light blinks red continuously.
- (6) If serious interference is detected, operation must be stopped immediately.
- (7) If the remote control is not used for a long time, the battery inside the transmitter must be removed.

### 3. Safety Precautions

- (1) Ensure that the overhead crane's main power is turned off before installation to prevent electric shock.
  - (2) Understand the overhead crane's power distribution and the function settings of the remote control (including relay outputs) to avoid incorrect wiring. Use electrical tape to wrap up wire ends.
  - (3) When installing the receiver, choose a location with no sparking nodes, such as away from motors, relays, and cables, to avoid proximity high-voltage wiring or facilities. Also, consider avoiding conflicts with protruding parts of the building and preventing the obstruction of radio wave transmission.
  - (4) The receiver must be installed inside the electrical control box. The correct installation method is to fix the receiver at an appropriate position on the top (or outside) of the electrical control box and then pass receiver output cable through the electrical control box for proper wiring.
  - (5) Ensure that the receiver is securely fastened during installation to prevent it from becoming loose or falling off.
- Note:** For the wiring diagram of the remote control, please refer to the wiring label on the back of the receiver.

In the event of an emergency, please follow the following steps and immediately notify the dealer:

1. Press the "Stop button" or the "Emergency stop switch" on the transmitter;
2. Turn the key switch/rotary key switch of the transmitter to the OFF position and remove it;
3. Turn off main power supply of the crane;
4. Notify the dealer and find out the cause.



## Ordinary operation

### 1. Normal operation

- (1) Insert two AA (5 alkaline) batteries with full power into the battery box of the transmitter in the correct direction lock the battery cover.
- (2) Power-on method of each series of remote control 1. Rotate the power key to ON as shown to turn on the power 2. Rotate the emergency stop button out in the direction of the arrow; 3. Press the "Power On Key" and the power indicator light of the transmitter will green, 4. Press any function key, and the power indicator light of the transmitter will flash green when it can be operated.
- (3) Operate correctly according to function set by each key on the transmitter.

### 2. After operation, handle in the following sequence

- (1) Press the "Stop" key or the "Emergency Stop Switch" on the transmitter.
- (2) If not used for a long time, remove the batteries from the battery box.

**Note:** The transmitter has a power detection function and indicates the power level with an LED light.

Transmitter LED indicator light	Green light flashing	Transmitter normally emits signals
	Red light flashing	The transmitter has no signal output
	Red light remains on	Transmitter battery low, replace battery

## Receiver power selection

### 1. The receiver provides a variety of voltage options

380V and 36V can be directly converted  
other voltages need to be customized such as:  
12V, 24V, 220V, 24-440V wide voltage, etc.

### 2. Voltage conversion method

(1) Ordinary 36V and 380V voltage can be converted receiver: First, turn off receiver power, and then pull up the original inserted voltage selection switch. (As shown in the figure below) Select the corresponding input voltage as needed, directly insert into the corresponding voltage, and the operation is complete.

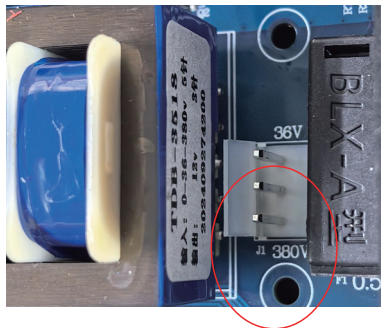

Voltage selector switch

(2) Customized 24-440V wide voltage receiver: Just check if the input voltage is within the range of 24-40V, no need to change the plug position (universal for AC and DC)

## Transmitter replacement, copy issue

### 1. Change the transmitter

The same series and model remote control, the transmitter can be replaced at will, the method is as follows:

- (1) Press any action key to process the signal elimination without installing the battery in the new transmitter.
- (2) Take out the E card of the original transmitter and insert it into the position of the new transmitter, pay attention to the direction.
- (3) Install the battery and observe the power indicator of the transmitter. If the green light flashes once and the light once, it indicates that the replacement is successful and can be used normally.

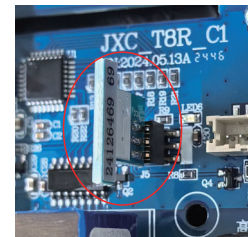

Receiver E card

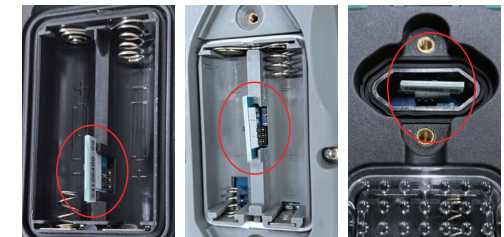

Various transmitters E card

### 2. Copy the transmitter

If the original transmitter of the remote control is lost and needs to be re-paired with a transmitter:

- (1) Press action key without installing the battery to process the signal elimination.
- (2) Take out the E card from the receiver and insert it into the corresponding position of the new transmitter, attention to the direction.
- (3) Install new batteries and observe the power indicator of the transmitter at the same time. If the green light flashes once and the red light once, indicates that the replacement is successful and can be used normally.

FCC Warning:

This equipment has been tested and found to comply with the limits for a Class B digital device, pursuant to part 15 of the FCC Rules. These limits are designed to provide reasonable protection against harmful interference in a residential installation. This equipment generates, uses and can radiate radio frequency energy and, if not installed and used in accordance with the instructions, may cause harmful interference to radio communications. However, there is no guarantee that interference will not occur in a particular installation. If this equipment does cause harmful interference to radio or television reception, which can be determined by turning the equipment off and on, the user is encouraged to try to correct the interference by one or more of the following measures:

- Reorient or relocate the receiving antenna.
- Increase the separation between the equipment and receiver.
- Connect the equipment into an outlet on a circuit different from that to which the receiver is connected.
- Consult the dealer or an experienced radio/TV technician for help.

Caution: Any changes or modifications to this device not explicitly approved by manufacturer could void your authority to operate this equipment.

This device complies with part 15 of the FCC Rules. Operation is subject to the following two conditions:

(1) This device may not cause harmful interference, and (2) this device must accept any interference received, including interference that may cause undesired operation.

This equipment complies with FCC radiation exposure limits set forth for an uncontrolled environment. This equipment should be installed and operated with minimum distance 0cm between the radiator and your body.