

COB led strip lights



Download App

Product overview

Packaging content

- COB led strip lights
- 13 key infrared remote control
- led controller
- Power supply
- Operating instructions

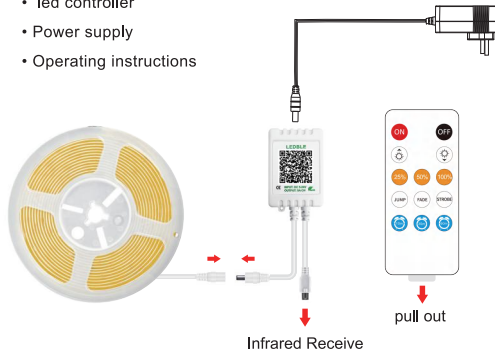

Attentions

LED Strip Lights take full control of your lighting with smartphone before using the app to control the lights. Please search and install

the application in Google Play or Apple Store or scan the QR code on the controller and also scan the QR code in the manual. APP name is "Lotus Lantern pro".



Scan the QR code on the controller to download the app.



Scan the QR code in manual to download App



when you installing the controller. The infrared receiver should be exposed and face to the direction of remote control.

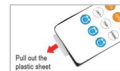

Please pull out the plastic film before use the Controller.



When using in segments, you can cut according to the desired length by pressing the scissors icon

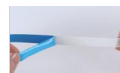

Clean up the area to be pasted, ensuring that the surface to be pasted is clean, flat, and dry. Tear off the backing adhesive, paste the LED strip light into the area to be installed, and press it tightly.

13 key infrared remote control

Within a controllable distance of 8 meters, brightness can be adjusted, static colors can be changed, or other effects can be achieved

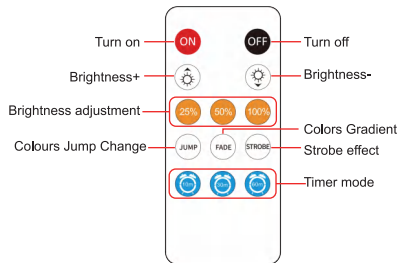

Attentions:

The brightness of the light strip has three levels: 25%, 50%, and 100%

1. Turn on the light strip, select 25%, and the brightness of the light will become 25% of the current brightness. Adjust the current brightness through the up and down keys, with the maximum brightness not exceeding 25% of the maximum brightness of the light strip.
2. Turn on the light strip, select 50%, and the brightness of the light will become 50% of the current brightness. Adjust the current brightness through the up and down keys, with the maximum brightness not exceeding 50% of the maximum brightness of the light strip.
3. Turn on the light strip, select 100%, and the brightness of the light will become 100% of the current brightness. Adjust the current brightness through the up and down keys, with the maximum brightness not exceeding 100% of the maximum brightness of the light strip.

Common Troubleshooting

The controller was connected the power, but not light up

1. Check the input power supply: please use the power adapter that we equipped or the same specification adapter as ours .
The input voltage must meet the voltage required by the lamp.
When the input voltage is too low, the lamp will not be light, and the high voltage may damage the circuit.
The output power of the adapter (KW value) must be equal to or greater than the power of the LED lamp belt.
2. Check whether the controller and the lamp are connected correctly, Make sure each interface is connected correctly.
3. Check whether the remote control is open.

LED light up, but the remote control does not work or can't control LED light belts

1. Check whether the insulation sheet is removed from the remote control.
2. Make sure the battery on the remote control is installed correctly.
3. Ensure that is being used within 8 meters and aligned to the infrared receiver of the controller.
4. Try to replace the battery



The strip lights are not waterproof and are suitable for indoor use. Make sure the surface you are going to paste is clean, flat and dry. And the power and controller are also not waterproof, for safety reasons. Please hide the controller and adapter away from the water on using.

Attentions:

Lamp belt must be used under 24V
Remote control must be aligned to the Infrared Receiver of the controllers
This light strip belt must be connected correctly as showed method

a) The statement Remove and immediately recycle or dispose of used batteries according to local regulations and keep away from children.

Do NOT dispose of batteries in household trash or incinerate."

b) The statement Even used batteries may cause severe injury or death."

c) The statement Call a local poison control center for treatment information."

d) A statement indicating the compatible battery type (e.g., LR44, CR2032). e) A statement indicating the nominal battery voltage.

f) The statement Non-rechargeable batteries are not to be recharged."

g) The statement Do not force discharge, recharge, disassemble, heat above (manufacturer's specified temperature rating) or incinerate.

Doing so may result in injury due to venting, leakage or explosion resulting in chemical burns."

a) The statement Ensure the batteries are installed correctly according to polarity (+ and -)."

b) The statement Do not mix old and new batteries, different brands or types of batteries such as alkaline, carbon-zinc, or rechargeable batteries."

c) The statement Remove and immediately recycle or dispose of batteries from equipment not used for an extended period of time according to local regulations."

d) The statement "Always completely secure the battery compartment. If the battery compartment does not close securely

stop using the product, remove the batteries, and keep them away from children."



WARNING

DO NOT IMMERSE IN WATER DO NOT IMMERSE IN FIRE
CHILDREN UNDER THE AGE OF 16 SHOULD USE THIS
PRODUCT UNDER ADULT SUPERVISION.

If you have any question after receiving the products, please contact our customer service, we will reply to you within 24 hours.

E-Mail: **yeesupport@163.com**

FCC Warning

This device complies with part 15 of the FCC rules. Operation is subject to the following two conditions: (1) this device may not cause harmful interference, and (2) this device must accept any interference received, including interference that may cause undesired operation.

Changes or modifications not expressly approved by the party responsible for compliance could void the user's authority to operate the equipment.

NOTE: This equipment has been tested and found to comply with the limits for a Class B digital device, pursuant to part 15 of the FCC Rules. These limits are designed to provide reasonable protection against harmful interference in a residential installation. This equipment generates uses and can radiate radio frequency energy and, if not installed and used in accordance with the instructions, may cause harmful interference to radio communications. However, there is no guarantee that interference will not occur in a particular installation. If this equipment does cause harmful interference to radio or television reception, which can be determined by turning the equipment off and on, the user is encouraged to try to correct the interference by one or more of the following measures:

-Reorient or relocate the receiving antenna.

- Increase the separation between the equipment and receiver.

- Connect the equipment into an outlet on a circuit different from that to which the receiver is connected.

- Consult the dealer or an experienced radio/TV technician for help.