

Smart LED Ceiling Light with Bluetooth Speakers

US WIFI QC Series Instruction Manual

Before installation, please read thoroughly and understand this instruction manual.

- Settings may be a little bit different according to the product model.
- Drawings and content in this manual are provided for reference only and may differ from the actual product specifications.
- When installing this product, ensure you are in an environment with stable Wi-Fi signal.
- This product supports 2.4 GHz Wi-Fi or dual-channel (mixed mode) 2.4 GHz / 5 GHz Wi-Fi.
Please note: It cannot be used with 5 GHz Wi-Fi only.
- If you have any questions during installation or use, feel free to contact our customer support.



To Dear Valued Customer

Thank you for choosing our products/services. Your trust is our greatest motivation.
We understand the expectations behind every purchase and handle each order with meticulous care.

Your Experience Matters:

Quality Assurance

Every product undergoes rigorous inspection to ensure it matches its description.

Hassle-Free Support

Encountered issues? (e.g., shipping damage, unresponsive remote, unstable Wi-Fi® connectivity)

→ Contact us via your original point-of-purchase or support channels below

→ Receive resolution within 24 business hours: free replacement or other appropriate solutions.

Drive Our Improvement

Your feedback is invaluable:

You are welcome to make suggestions through [email/sales evaluation system] to help us do better.

We appreciate your support. Moving forward, we remain committed to our customer-first philosophy, continuously enhancing our offerings.

Reach Our Support Team:

 chysongoods@outlook.com (Support in English)

 0086137-1289-9030 (English service)

* You are responsible for any phone charges incurred.



Product Description

1. Accessories List

- 1.1 Before assembly, verify that all parts and accessories are included.
- 1.2 Illustrations in the manual are representative only and may differ from the actual product.
- 1.3 Accessory , quantities, appearance, and specifications are subject to change without notice due to model update or product improvements.

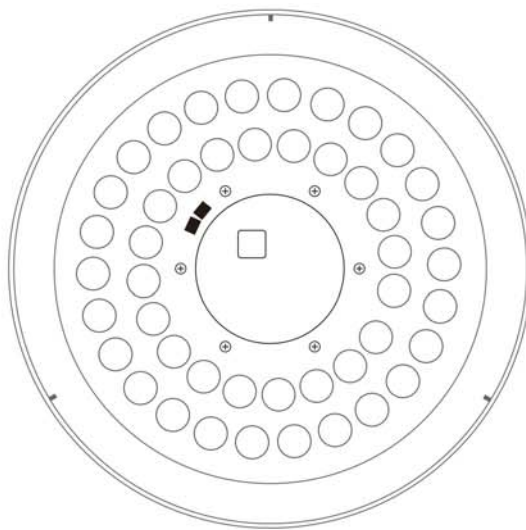

Lighting Base



lampshade



Chassis Components



Screw

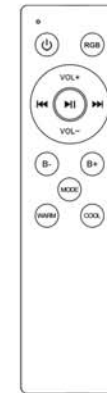

Remote Controller



Manual

2. Installation Notice

Before installation, following as below:

- 2.1 Always turn off the wall switch to prevent electric shock. If the switch status is unclear, shut off the main circuit breaker for the room.
- 2.2 Use only standard ON/OFF wall switches. Dimmer/smart wall switches are prohibited (fire risk).
- 2.3 Built-in Wiring Device (Square Hook-Type Ceiling Device) in Chassis Components: Do not install if loose or damaged.

Installation Method: Quick Install

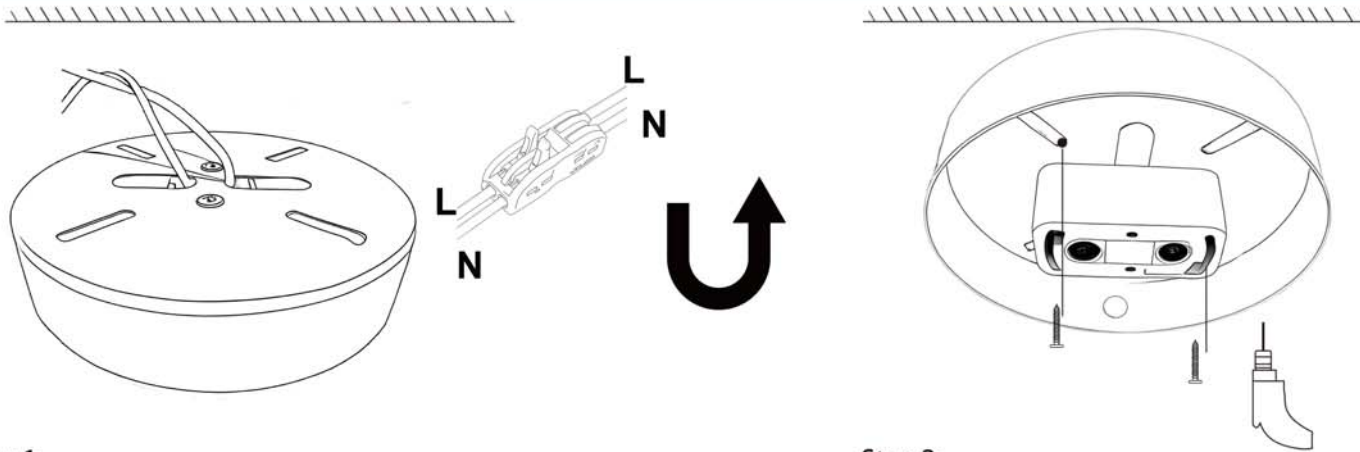

Step 1:

Connect the wires and make sure they are securely connected

Step 2:

Locate the holes from the wall and Secure the chassis components with 2 screws to the ceiling.

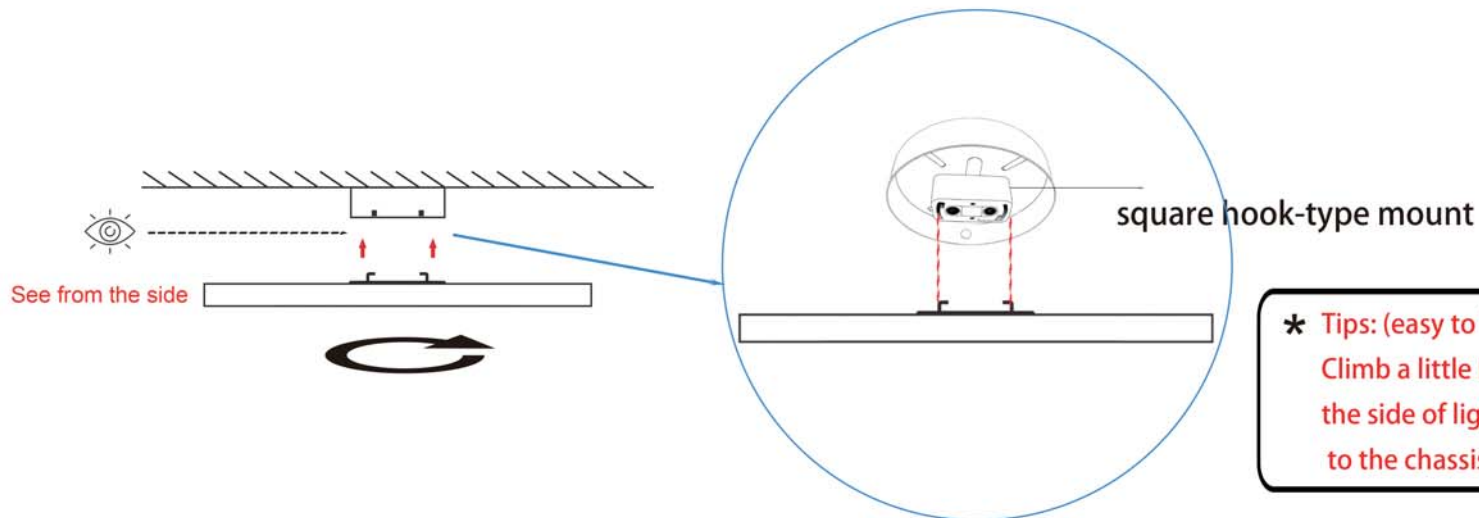

Step 3:

Align the hook of the lighting base to the chassis components(square hook-type mount) and rotate clockwise to lock.

* Tips: (easy to install)

Climb a little high and make sure you can see the hook from the side of light base . then you can very easy to align the base to the chassis compannien and lock them together.

Installation Method: Quick Install

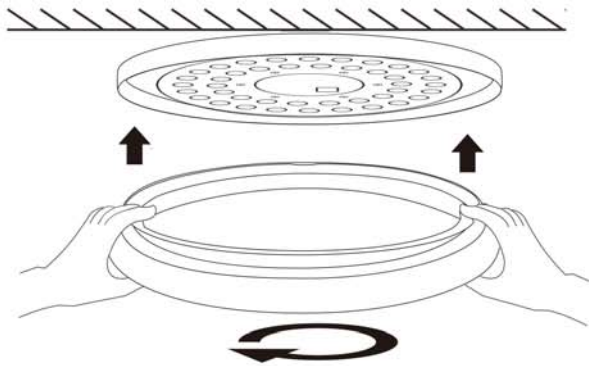

Step 3:
Rotate the cover clockwise to attach it to the main body.

Unlock Button inside

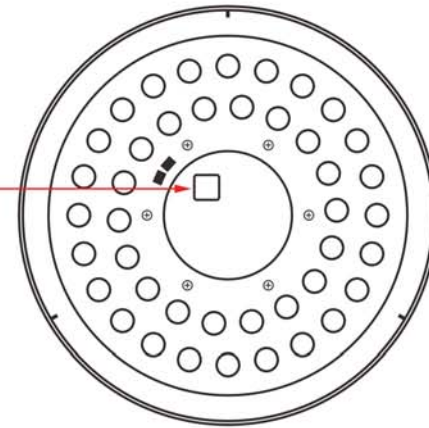

Uninstallation Instructions:

Cut power off

Press the inside button and rotate the base counterclockwise to unlock for removal.

3.Important Safety Instructions

3.1 Installation Precautions: Cut power off before installation.Licensed electrician recommended .

3.2 Electric Shock Warning: Do not touch LED bean or surrounding components during/after operation.

3.3 Standby Power Alert :Device still in power if only turned off via app/remote.

Product Features

- Control Methods: Works with wall switches, remote control, app, voice control.
- Dimming & Color Temp (White Light): Adjust brightness and color temperature from warm white to daylight (2700K - 6500K).
- RGB Mode: Easily customize your favorite colors via the app to set the mood.
- Memory Function: Restores your last used settings when turned back on.
- Night Light Mode: Low-power (4W) lighting for nighttime use.

4.Remote Control

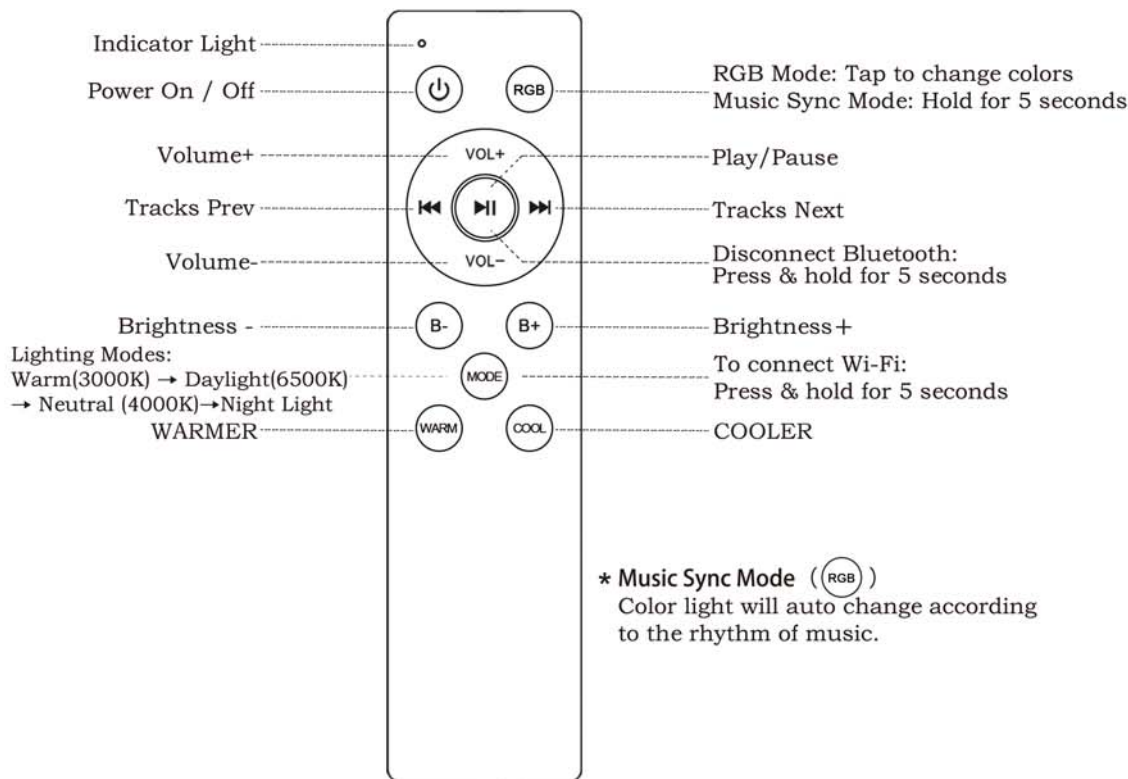

Notes:

1. Batteries: 2 × AA alkaline required (not included)
2. Operating Range: Up to 65 ft (20 m) unobstructed. Walls/floors may reduce range.

Usage of Remote Control

1) Initial Setup: This universal remote comes pre-programmed with your light please use directly, no pairing needed.

For dedicated 1:1 control, pair manually using the steps as below.

2) Low Battery Indicator: If the remote status light stays SOLID RED, replace both AA alkaline batteries immediately.

3) Slow Response Troubleshooting: If the remote responds slowly:

a. 🔄 Replace batteries

b. ⌚ Remove batteries for 60 seconds to clear Bluetooth cache

If issues persist:

➡ Contact Support via your purchase platform

➡ Or email: chysongoods@outlook.com

We'll ship a free replacement remote if verified under warranty.

Pairing Procedure:

1. Power on the ceiling light using the wall switch.
2. Hold both <⏻> and <RGB> buttons simultaneously for 5 seconds.
3. Pairing completes when the light change from flashing to steady light.
(Pairing must be initiated within 20 seconds of power-on.)



Need video guidance?

Scan the QR code → Watch step-by-step demos

Contact Support:

✉ chysongoods@outlook.com

☎ +0086137-1289-9030

* You are responsible for any phone charges incurred.

App to Wi-Fi Connection

5. Pre-Connection Setup

5.1 Download the Dedicated App:

Scan either QR code below to download the app:

- Required for advanced features: Alexa integration and RGB dimming functionality
- Compatible with both iOS and Android

* Important Notes:

Both "Tuya Smart" and "Smart Life" apps control this product

Dual QR codes accommodate existing users of either platform

New users: Install either app (no need for both)



Tuya Smart Download



Smart Life Download



Alternative Download Methods

5.2 Account Setup: Open the app.

New users: Tap "Create Account" and complete registration

Grant permissions when requested:

Bluetooth access (device pairing)

Location services (network scanning)

Failure to enable permissions will prevent device detection.

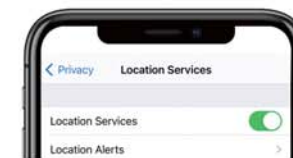

5.3 Light Setup: Before connecting to the app, enable Wi-Fi pairing mode.

Power on the ceiling light, Press and hold the remote's [] Wi-Fi button for 5 seconds. Confirmation: When the light blinks, the unit has entered pairing mode

▲ Remote Not Responding?

If the remote fails to activate pairing: Re-pair the remote using instructions in the Remote Control Setup section of this manual.

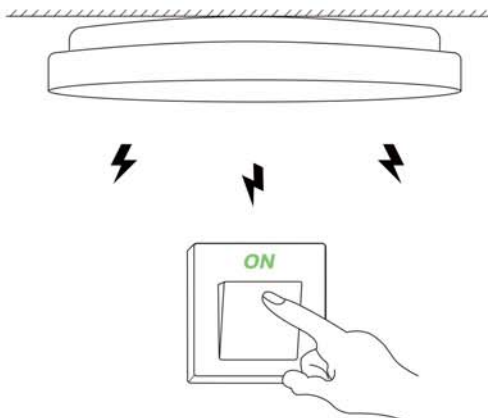

Press and hold for at least 5 seconds

6. Connect the App to Wi-Fi

Complete Light, App & Wi-Fi Connection, Follow these steps:

- ① Open the app, select "Add Device", then tap the "+" icon (top-right)
- ② The app will detect your ceiling light → Select the device listed as "wifi smart light"
- ③ Choose your Wi-Fi network and enter the password
- ④ Connection established - Your light is now linked to the app

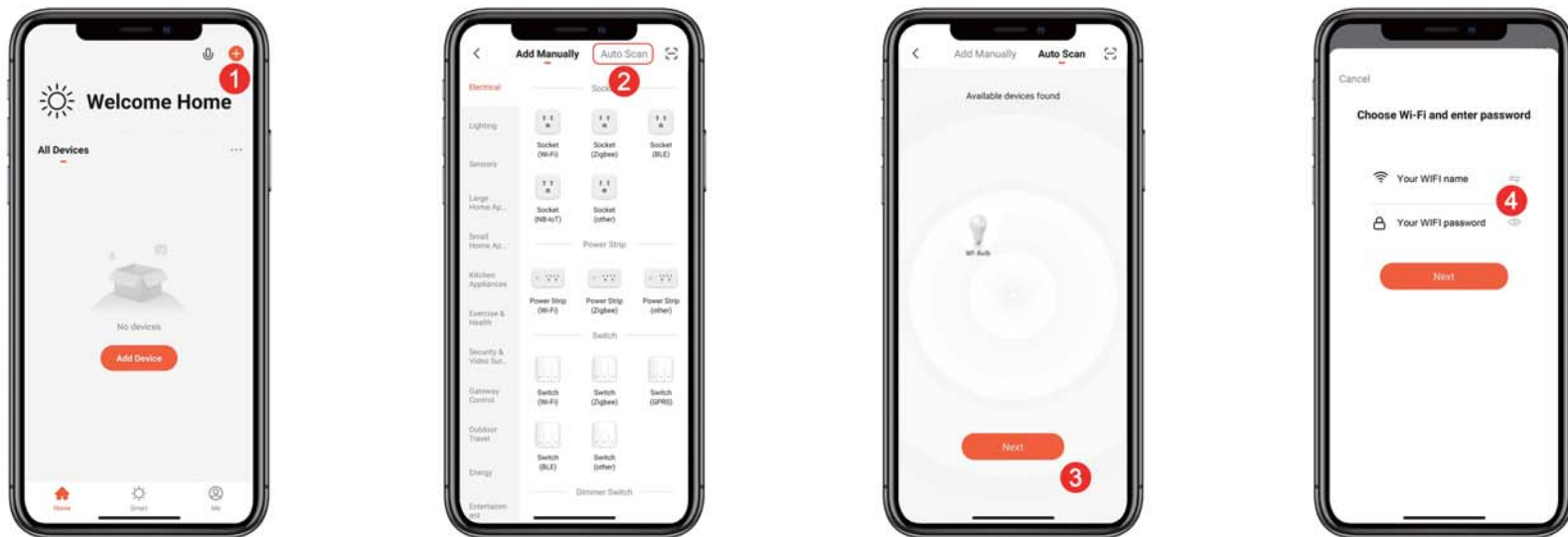

Note:

- 1.The steps and images above are based on Tuya Smart App v3.34. Button locations and procedures may differ slightly after app updates.
- 2.Product names shown during setup are for reference only. Naming conventions may change due to product model revisions.
- 3.If the app fails to detect your ceiling light:
 - * Confirm Wi-Fi environment (2.4GHz band required)
 - * Verify Wi-Fi pairing mode is enabled per Section 5.3

Contact Support if issues persist during setup.

Connecting to Third-Party Smart Devices (Alexa, etc.)

After completing Wi-Fi setup, when controlling your light via the app, the screen shown in Figure 5 will appear. Follow these steps to connect:

- ⑤ Tap the Edit icon "✎" in the top-right corner of the screen
- ⑥ Select your target device (e.g., Alexa) under "Compatible Devices"
- ⑦ Log in to the required account (Amazon account for Alexa) on the displayed page
- ⑧ Tap "Authorize" to complete the connection

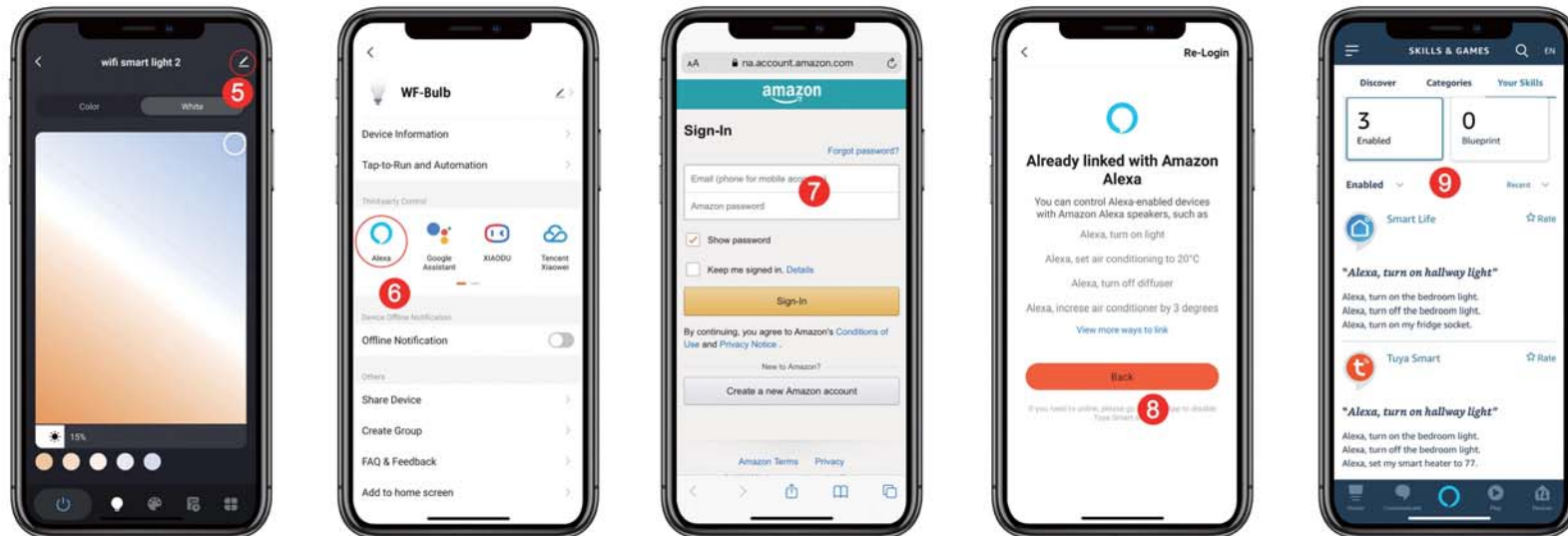

< Important > Post-Connection Verification

In the Alexa app's Skills section:

- Confirm "Tuya Smart" or "Smart Life" shows as "Enabled"

Post-Connection Functionality:

All devices managed through Tuya Smart/Smart Life (including this product) will support voice control via Alexa, etc.

Music Features of the Bluetooth Speaker

Music Features of the Bluetooth Speaker

The built-in Bluetooth speaker can connect to the following devices:

Smartphones, tablets, PCs (Bluetooth-compatible models), Echo devices (for music playback), etc.

■ Pairing Instructions

Open Bluetooth Settings on your source device (e.g., smartphone).

Search for nearby devices and select "JB スピーカー".

Complete pairing (same process as standard Bluetooth speakers).

■ How to Reset Pairing

(Use when incorrectly connected or after pairing by another user)

1. Press and hold the remote control's Play/Pause button for 5 seconds.
2. Confirmation: Flashing light + notification tone indicates reset completion.
3. Repeat the pairing process.

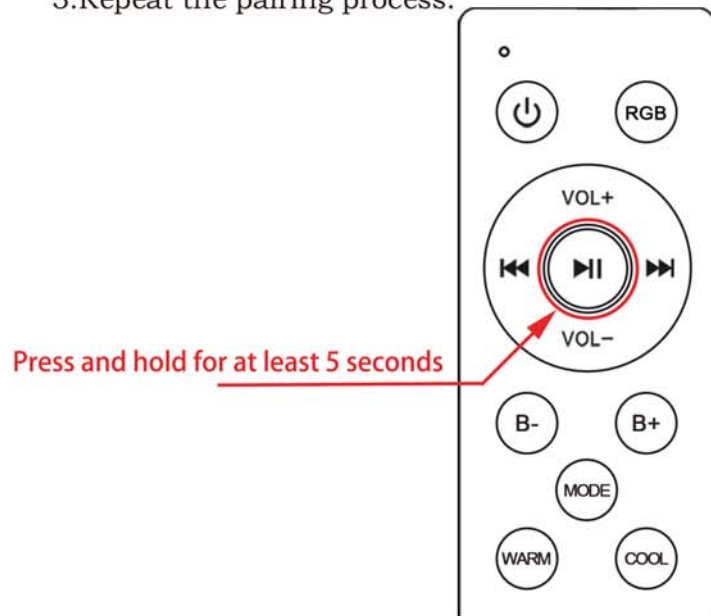

Phone Settings > Bluetooth



Pair with "JB スピーカー"



Play music through your music app



To watch the setup video:

Scan the QR code on the right with your smartphone

View the demonstration video

For Support:

Need help? Contact our Support Center.

chysongoods@outlook.com(English)

+0086137-1289-9030(English)

* You are responsible for any phone charges incurred.

FCC WARNING

This device complies with part 15 of the FCC Rules.

Operation is subject to the following two conditions: (1) this device may not cause harmful interference, and (2) this device must accept any interference received, including interference that may cause undesired operation. Any changes or modifications not expressly approved by the party responsible for compliance could void the user's authority to operate the equipment.

NOTE: This equipment has been tested and found to comply with the limits for a Class B digital device, pursuant to Part 15 of the FCC Rules.

These limits are designed to provide reasonable protection against harmful interference in a residential installation.

This equipment generates, uses and can radiate radio frequency energy and, if not installed and used in accordance with the instructions, may cause harmful interference to radio communications. However, there is no guarantee that interference will not occur in a particular installation.

If this equipment does cause harmful interference to radio or television reception, which can be determined by turning the equipment off and on,

the user is encouraged to try to correct the interference by one or more of the following measures:

- Reorient or relocate the receiving antenna.
- Increase the separation between the equipment and receiver.
- Connect the equipment into an outlet on a circuit different from that to which the receiver is connected.
- Consult the dealer or an experienced radio/TV technician for help.

To maintain compliance with FCC's RF Exposure guidelines,

This equipment should be installed and operated with minimum 20cm distance between the radiator and your body:

Use only the supplied antenna.

Version Number: US-JYWF-2025