

MAXONAR

Page Turner

User Manual - CGA011-MX

Specifications:

Page Turner:

Battery Capacity: 250mAh
Charging input: 5V \equiv 200mA
Charging time: approximately 1.5 hours
Charging Way: Put the clip on the charging contact of the remote control.

Remote Control:

Battery capacity: 750mAh
Charging input: 5V \equiv 400mA
Charging time: approximately 2.5 hours
Charging interface: USB C

Packaging List

- ❶ Page Turner*1
- ❷ Remote Control*1
- ❸ USB C Charging Cable*1
- ❹ Lanyard*1
- ❺ User Manual*1

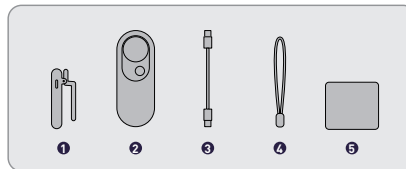

Product Diagram:



Instructions for use:

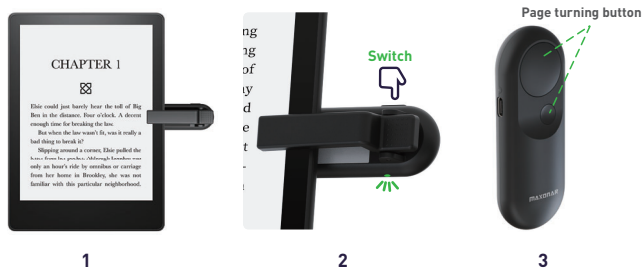

1. Clamp the clip in the appropriate position on the kindle.

2. Press the switch button of the clip for 1 second, and wait for the green indicator to flash once.

3. Press the page-turn button to start reading.

***Without any operation for 30 minutes, then will be automatically shut down.**

Charging Instructions:

1. How to charge the page turner: Put the clip on the charging contact of the remote control. The red light remains on during charging and goes off when fully charged.

2. How to charge the remote control: Charge through the usb c data cable. The red light remains on during charging and goes off when fully charged.

3. Low battery reminder: When the voltage is below 3.3V, the indicator light on the remote control flashes red. When the voltage is below 3.2V, the remote control shuts down and cannot be turned on. At this time, you should charge it.

Caution and Safety Information:

- ⚠ It is recommended to charge the page turner and remote control once a month to extend the battery life if it has not been used for a long time.
- ⚠ The contact area between the page turner and the screen should be kept clean and intact to avoid a decrease in sensitivity due to dirt or damage.
- ⚠ This product is not waterproof. Please do not use it in extremely cold, high temperature, or high humidity environments.

FCC Caution.

This device complies with part 15 of the FCC Rules. Operation is subject to the following two conditions:

(1) This device may not cause harmful interference, and

(2) this device must accept any interference received, including interference that may cause undesired operation.

Any Changes or modifications not expressly approved by the party responsible for compliance could void the user's authority to operate the equipment.

Note: This equipment has been tested and found to comply with the limits for a Class B digital device, pursuant to part 15 of the FCC Rules. These limits are designed to provide reasonable protection against harmful interference in a residential installation. This equipment generates uses and can radiate radio frequency energy and, if not installed and used in accordance with the instructions, may cause harmful interference to radio communications. However, there is no guarantee that interference will not occur in a particular installation. If this equipment does cause harmful interference to radio or television reception, which can be determined by turning the equipment off and on, the user is encouraged to try to correct the interference by one or more of the following measures:

- Reorient or relocate the receiving antenna.

- Increase the separation between the equipment and receiver.

- Connect the equipment into an outlet on a circuit different from that to which the receiver is connected.

- Consult the dealer or an experienced radio/TV technician for help.

*RF warning for portable device :

The FCC certification of this device refers to RF exposure testing performed in typical operating conditions, where a person is no closer than 0 centimeters from the device surface at all times, except for non-repetitive patterns with transient time intervals in the order of a second. Only in the stated conditions, the device is shown to fully comply with the FCC RF Exposure requirements of KDB 447498.