

# Pannacy-Far

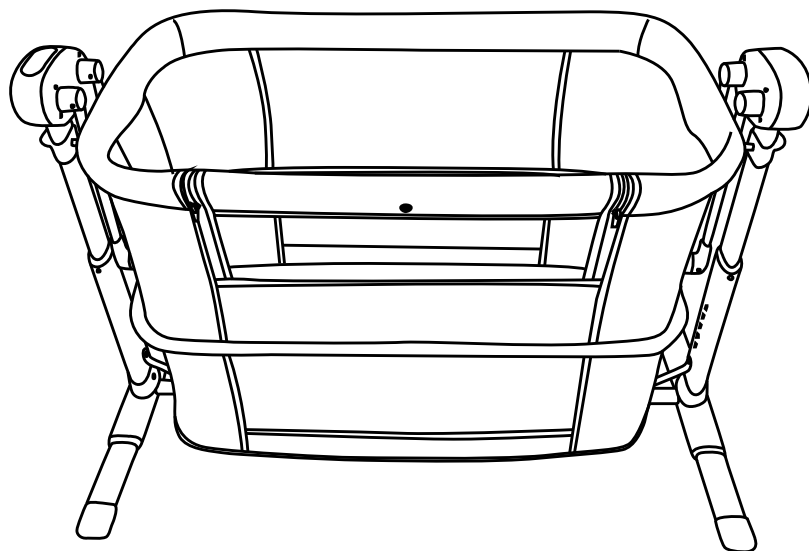

**IMPORTANT! READ CAREFULLY AND KEEP  
FOR FUTURE REFERENCE**

## **WARNING**

- TO AVOID DANGER OF SUFFOCATION BEFORE USE, REMOVE AND DISPOSE OF ALL PLASTIC BAGS AND PACKAGING MATERIALS AND KEEP THEM OUT OF REACH OF CHILDREN.
- Failure to follow these warnings and the instructions could result in serious injury or death. Always follow assembly instructions for each product use mode.
- Read the instructions for use for the list of components. Periodically check product for loose, damaged, or missing parts.
- This product is intended for use for babies aged between 0 and 6 months, weighing up to a maximum of 9 kg.
- Stop using the product as soon as the child can sit or kneel or pull itself up.
- DO NOT use bedside sleeper if any parts are missing, damaged, or broken. Contact ANHUI COOL BABY SCIENCE & TECHNOLOGY DEVELOPMENT CORPORATION for replacement parts and instructional literature if needed. DO NOT substitute parts.
- All opening, adjusting, anchoring and positioning operations of the product must be carried out exclusively by an adult.
- The product is ready for use only when the locking mechanisms are engaged. Make sure they are securely fixed before use.
- Be aware of the risk of fire and other sources of strong heat, such as electric bar fires, gas fires, etc. In the near vicinity of the crib.
- The product must always be placed on a horizontal surface. Do not place the product onto a sloped surface with your child inside.
- That product should be locked in the fixed position when a child is unsupervised in it.
- All assembly fittings should always be tightened properly and that care should be taken that no screws are loose and no open zippers or buttons, because a child could trap parts of the body or clothing (e.g. strings, necklaces, ribbons for baby, dummies, etc ) which would pose a risk of strangulation.

## **WARNING**

- Do not place the product close to another product, which could present a danger of suffocation or strangulation. (e.g. strings, blind/curtain cords, etc.)
- Young children should not be allowed to play unsupervised in the vicinity of a product.
- There must be no gaps between the product and the mattress of the parents' bed. DO NOT use the product if there are any gaps. **Gaps should not be filled with pillows, blankets or other items.**
- Keep the fastening belts out of reach of children.
- Do not use more than one mattress in the product.
- Only use the mattress sold with this crib, do not add a second mattress on this one. Suffocation Hazards!
- Do not adjust or move the product when the child is inside.
- Do not use the product for more than one child at a time.
- Do not use the product without the frame.
- Do not position the crib near walls and obstacles to prevent trapping hazards.
- Placing additional items in the product may cause suffocation.
- Do not leave additional items(e.g. toys, pillows...) inside the product that could reduce its depth.
- The maximum of mattress **thickness** for crib shall not be more than 50mm.
- The thickness of the mattress must be such that the vertical height (upper surface of the mattress until the upper edge of the product's sides) is at least 200mm. Do not use more than one mattress in the crib.

### **WARNING:**

Only use the mattress sold with crib, do not add a second mattress on this one. Suffocation Hazards!

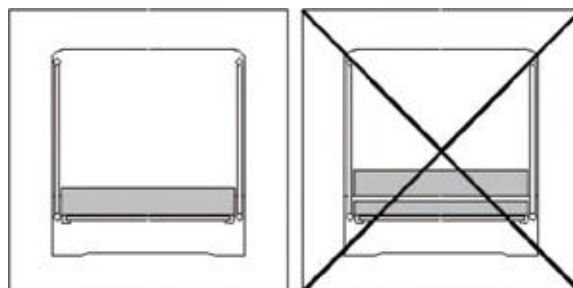

## ACCESSORIES

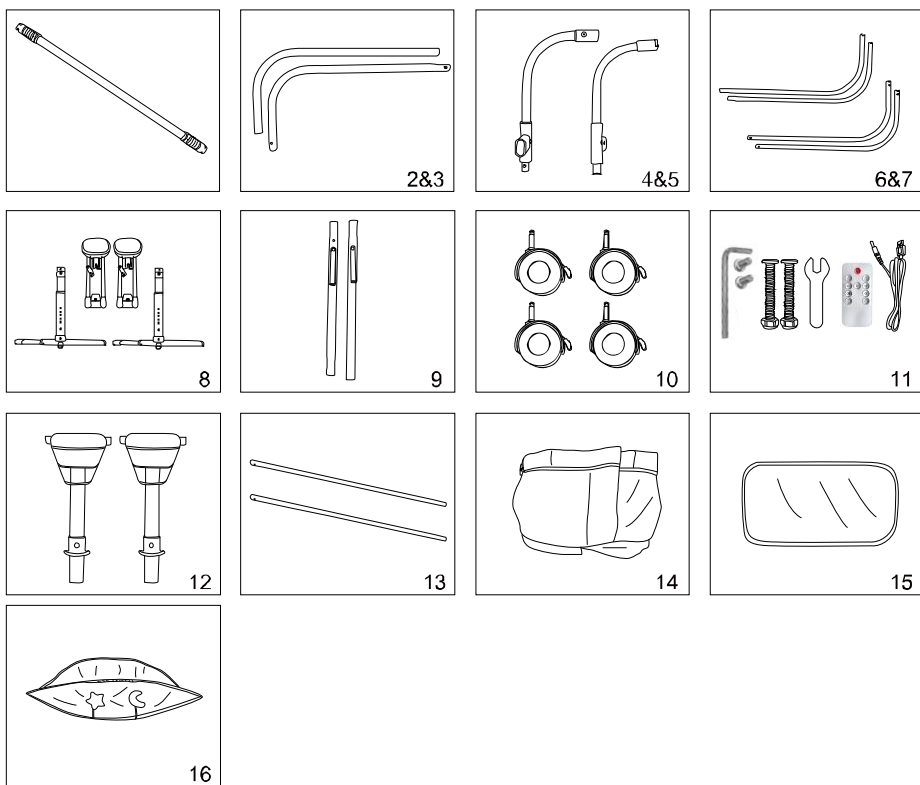

## INTERNAL ROCKING INSTALLATION STEPS

### Splicing of upper girth tube:

After connecting part 2 and part 3 with shard,  
the assembly is completed.

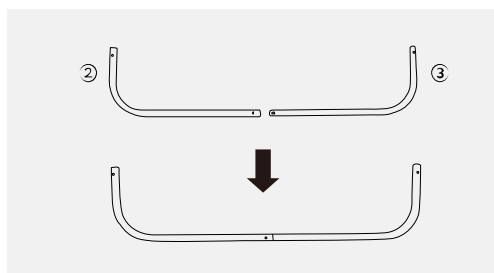

### Bed bottom pipe splicing:

the parts 6 and 7 with shrapnel  
connection, complete assembly.

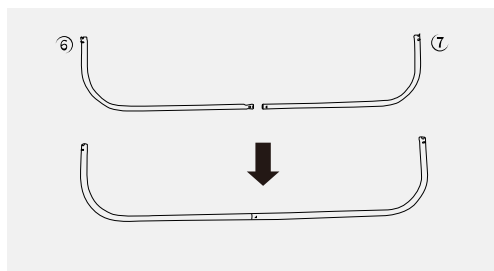

**Bed plate and two-layer bed tube:**  
After the folded bed plate is expanded, the parts are inserted along one opening to complete the assembly.

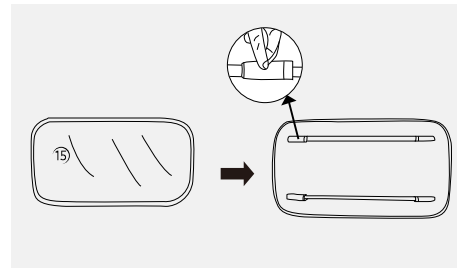

**Install the upper girth tube into the cloth sleeve:**  
insert the assembled parts 2 and 3 into the 14th to complete the steps.

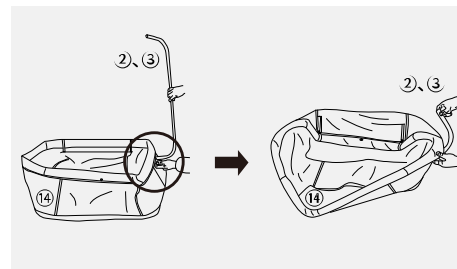

**Connection between the upper girth short pipe and the bed girth connecting pipe:**  
The assembly is completed by connecting part 4 and part 12 with shrapnel.

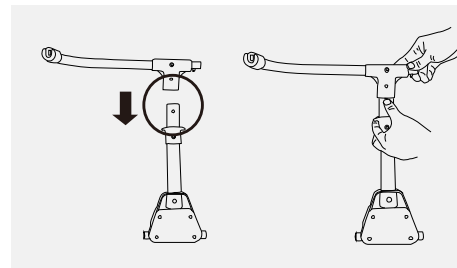

**Upper bobbin fittings:**  
Insert the assembled part 4 and some undesigned content into Part 14 ,Complete these steps.

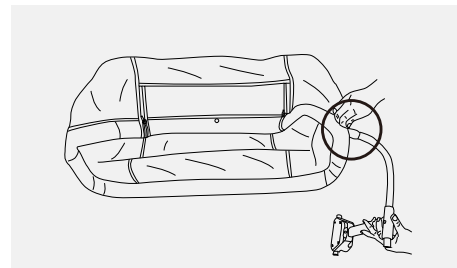

**Bed bottom pipe assembly:** Insert the assembled parts 6 and 7 into the parts 14, and connect the two ends with shrapnel.

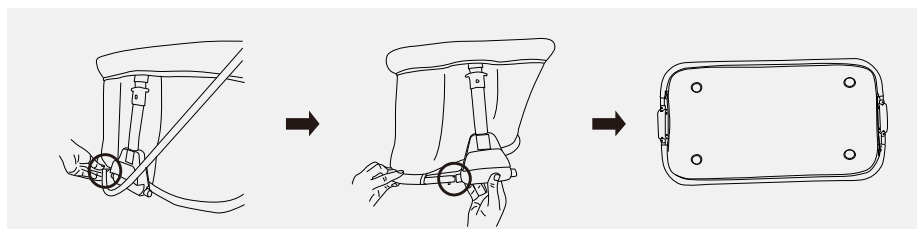

**Assembly of upper enclosure door pipe:**

Insert part 1 into part 14 as shown in the drawing, part 1 and part 4 are stuck, and the assembly is completed.

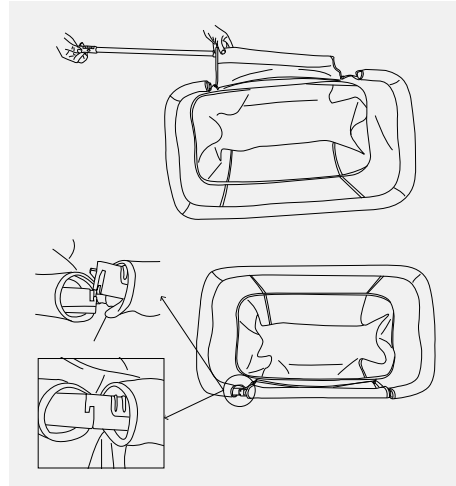

**Place the bed board:**

Place part 14 as shown in part 14 to form the inner swing ring assembly.

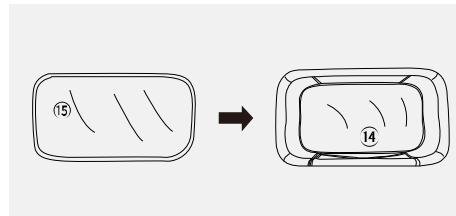

**BED INSTALLATION STEPS**

**Bottom horizontal support component:**

The ⑨ is connected with the figure o form the bottom horizontal support assembly.

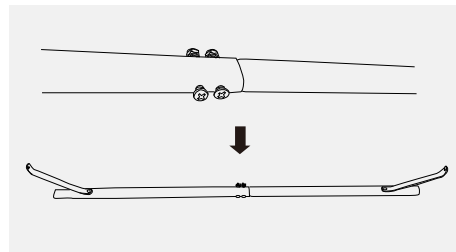

**Bed frame group:**

Connect the bottom crossbar assembly and the bed leg assembly with the inner hexagonal screw to form the bed frame group.  
Insert the two host boxes

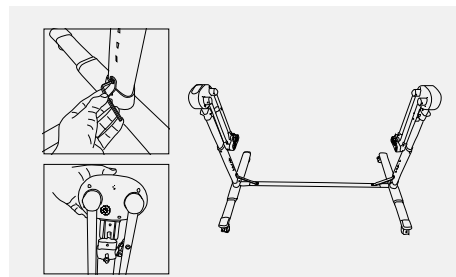

Assembly of the inner swing ring assembly and bed frame group as shown in Fig.

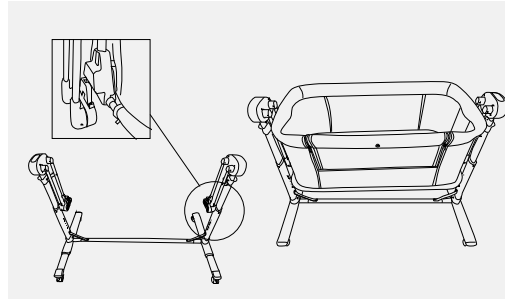

**Net assembly:**

Fasten the button on the net part ⑩ to the cloth cover part ⑭.

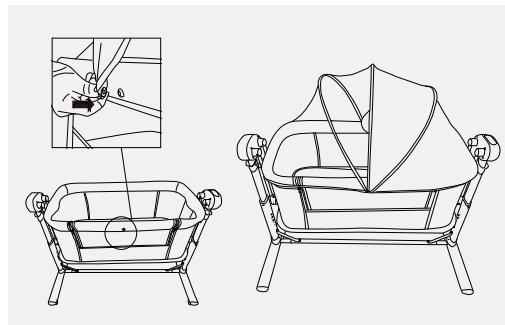

## Functional Demo

**Put on the wheel:** Fit the wheel into both ends of the bed leg.

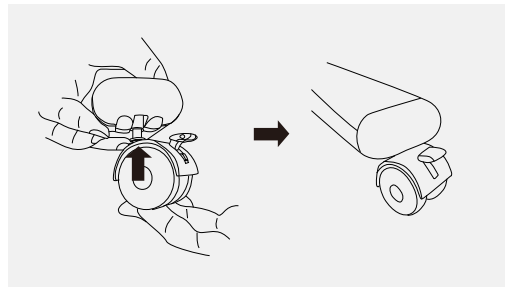

**Up and down gear function:**  
Pull the handle shown in the diagram to adjust the height of the bed.

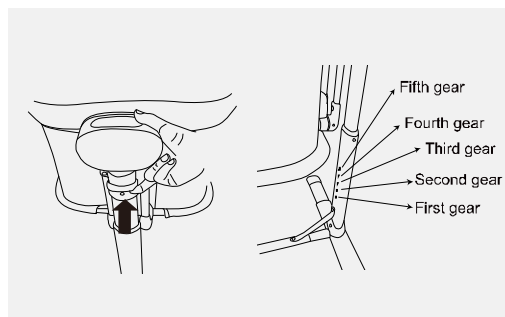

**Stop rocker function:** Rotate the safety hook shown in the picture to **lock** or **unlock** the rocker function.

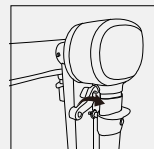

Unlocked

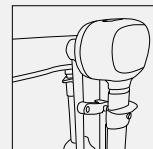

lock

**Universal wheel and brake function:** Press the brake lever, the wheel is fixed. Lift the brake lever and unlock the wheel.

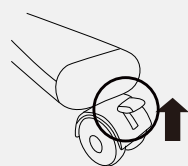

Unlocked

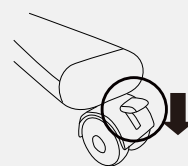

Lock

## Functional Demo

**Bedside mode:** Unzip and unlock the button as shown.

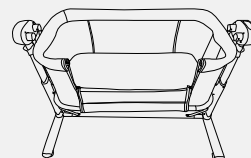
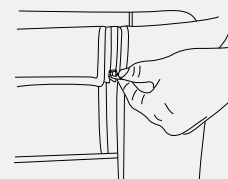
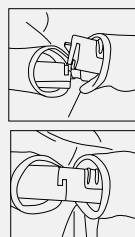

**Second bed mode:** Release the bottom 2 zippers to unlock the second bed mode.

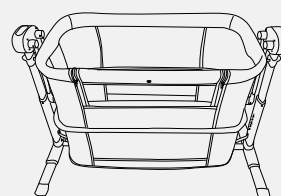
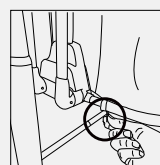



## WARNING:

This bedside sleeper is designed for use only with adult beds that are between 22 and 26 inches (56-66 cm) from floor to top of adult mattress. A bedside crib is designed to provide a sleeping area for an infant until he/she begins to push up on hands and knees or approximately 6 months of age. Move your child to another sleeping

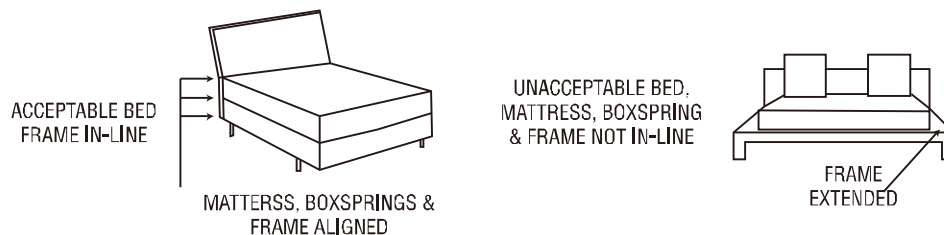

## ELECTRONIC PART SPECIFICATION

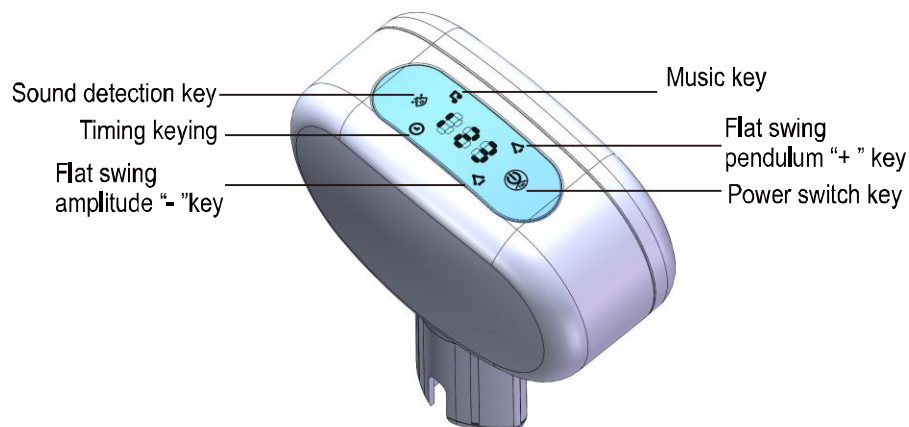

1. Power switch When powering on, the power button light (all lights are on).
2. press the power switch to turn on, the internal light of the powerswitch is on, and the internal light of other function keys is on.
3. Touch the "Flat swing +" button short, and the gear indicator will switch until the "third gear indicator" is on.
4. Touch the "Flat swing -" button, and the gear indicator will switch until the indicator is not bright at all (0 gear, swing stop gear).
5. Press and hold the "Flat Swing +" key, music volume "+".
6. Long press "Flat Swing -" key, music volume "-".

### **Timing key**

— Short touch "Timing key" timing lamp gear is on, press this key continuously, timing lamp gear cycle switch

1. Regular gear: 15 minutes
2. Timed second :30 minutes
3. Timing three :45 minutes

— Sound detection key

Short trigger sound detection key - all working functions stop entering the sound detection system, and the indicator light in the sound detection touch key flashes; When the baby cries or other sounds greater than 65dBA are received, the light inside the touch key will no longer blink, the music will sound, and the bed will start working in the first gear state (working time is tentatively set at 15 minutes). If the user does not exit at this time, it will automatically enter the sound detection standby state after 15 minutes.

Note: If you do not want to enter the sound detection system, press the sound touch button to exit the sound detection mode. Maintain the current state at the time of exit.

### **Music keys**

— Short touch "Music" button, music - pause - next song - pause - down - first so cycle, note: local music 11.

Second, the indicator light: there are 12 indicators and 1 infrared signal receiver

1. There are 3 gear indicators, 1 indicator for each of the 3 gear positions, and the 0 gear is completely off
2. Three timing indicators

One for each of the 3.6 buttons

4. 1 infrared signal receiving tube

3. Functional design: Power on DC power supply, insert DC plug into the DC seat of the product, "power key indicator" flashes three times, and the product enters the startup state.

Four. Power supply mode: two ways

1. The product is equipped with USB-DC power cable, you can use the phone charger to connect the power supply;
2. The product is equipped with a USB-DC power cable, which can be connected with a mobile power supply (charging bank).

## Remote control panel definition

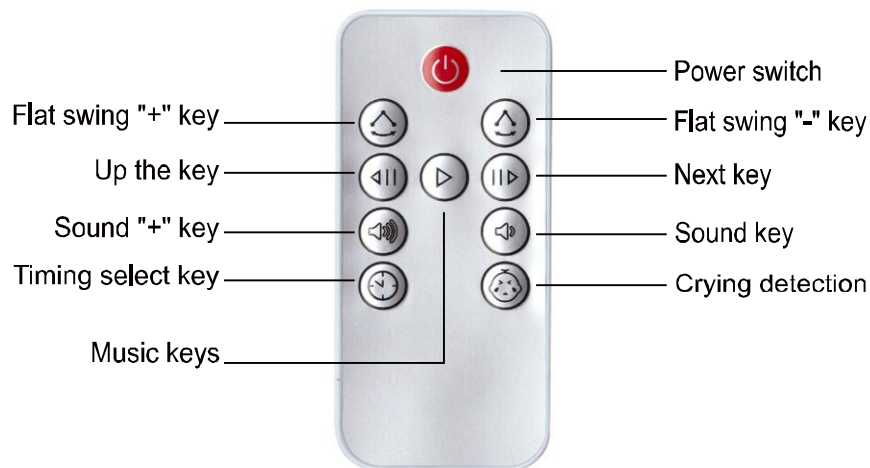

## Remote control key definition: there are 10 keys

1. Power button
  - Hold down the 3S switch
2. Flat swing + key
  - Short press the "Flat swing +" key, the gear light increases one step, and press this key continuously to reach the maximum gear to stop increasing;
3. Flat swing amplitude - key
  - Short press the "flat swing -" key, the gear light decreases one gear, press this key continuously, reduce to flat swing stop;
4. Up key
  - Tap to play the previous song
5. Play music/Pause Key 1 - Tap to play music/pause
6. Next key
  - Tap to play the previous song

7. Volume + key

– Press the volume to increase

8. Volume - key

– Press the volume to decrease

9. timing select key

Press the Timing key to turn the timing light on. Press this key continuously to switch the timing light on

① Timing gear: 8 minutes

② Timing second: 15 minutes

③ Timing three: 30 minutes

10. Sound detection key

– Press the sound detection key to turn on/off the sound detection function

11. Remote control battery packing method

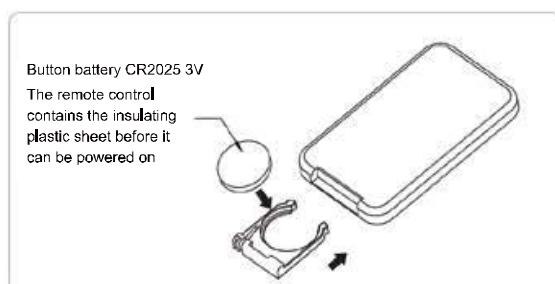

Note: As long as you open the mobile phone Bluetooth function search COOLBABY P780D name pairing, you can use Bluetooth function to play mobile phone music.

Please do not use a plug with a voltage higher than 6V.

## Maintenance & cleaning:

- Please make a routine check to make sure that bassinet is secure.
- Please use the soft and dry cloth or sponge to clean the bassinet. Do not use alkaline or acidic water to wash the bassinet to avoid the water corrode the iron pipes or hardware.
- Do not use or keep the bassinet in a wet, cold or high temperature environment for extended periods of time. Please use a brush or other clean tools to clean any splotches on the fabric.

## FCC Warning

This device complies with part 15 of the FCC Rules. Operation is subject to the following two conditions:

(1) This device may not cause harmful interference, and (2) this device must accept any interference received, including interference that may cause undesired operation.

Any Changes or modifications not expressly approved by the party responsible for compliance could void the user's authority to operate the equipment.

**Note:** This equipment has been tested and found to comply with the limits for a Class B digital device, pursuant to part 15 of the FCC Rules. These limits are designed to provide reasonable protection against harmful interference in a residential installation. This equipment generates uses and can radiate radio frequency energy and, if not installed and used in accordance with the instructions, may cause harmful interference to radio communications. However, there is no guarantee that interference will not occur in a particular installation. If this equipment does cause harmful interference to radio or television reception, which can be determined by turning the equipment off and on, the user is encouraged to try to correct the interference by one or more of the following measures:

- Reorient or relocate the receiving antenna.
- Increase the separation between the equipment and receiver.
- Connect the equipment into an outlet on a circuit different from that to which the receiver is connected.
- Consult the dealer or an experienced radio/TV technician for help.

\* RF warning for Portable device:

The device has been evaluated to meet general RF exposure requirement. The device can be used in portable exposure condition without restriction.