

118 E-F-G-H

用户手册

USER MANUAL

键盘使用说明

** 使用前请仔细阅读操作说明 **

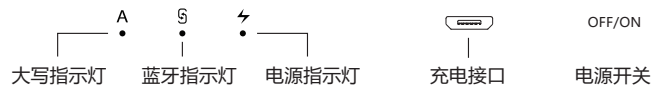

A》单通道蓝牙键盘连接操作：

- 1、开启电源，绿色指示灯点亮 1 秒（若指示为红色请及时充电）；
按下配对键 Fn+C/ ∞ 2 秒蓝牙指示灯闪烁进入配对状态，有效时间约 120 秒；
开启外部设备的蓝牙搜索功能，点击搜索到的 “Wireless Keyboard”；
配对成功后指示灯常亮，即可使用键盘。
- 2、如果在 10 分钟内没有操作，键盘将进入休眠状态，按任意键等待 2~3 秒即可唤醒。

B》三通道蓝牙键盘连接操作：（部分产品支持）

- 1、开启电源，绿色指示灯点亮 1 秒（若指示为红色请及时充电）；
按下配对键 Fn+C/ ∞ 2 秒以上蓝牙指示灯闪烁进入配对状态，有效时间约 120 秒；
开启外部设备的蓝牙搜索功能，点击搜索到的 “Wireless Keyboard”；则默认连接第一台设备 ∞ 配对成功后指示灯常亮，即可使用键盘。
- 2、在按下Fn+ ∞或者 ∞时，再按下配对键Fn+C/ ∞ 2 秒以上蓝牙指示灯闪烁进入配对状态，有效时间约 120 秒；开启外部设备的蓝牙搜索功能，点击搜索到的 “Wireless Keyboard”. 配对成功后指示灯常亮，即可使用键盘。
- 3、如果在 10 分钟内没有操作，键盘将进入休眠状态，按任意键等待 2~3 秒即可唤醒。
- 4、 按下Fn+ ∞或者 ∞或者 ∞。即可在三通道设备之间切换使用键盘，切换时蓝牙灯会点亮表示切换完成。

断开键盘连接：

- * 若要断开键盘与设备的连接，请在设备中清除配对的信息，或直接关闭键盘电源。

电量指示：

- * 若电源指示灯为红色慢闪，表示电池电量偏低，请及时进行充电，充电时红灯长亮；当指示灯为绿色时表示充电完成，请断开充电电源确保安全。

快捷功能键：请留意，功能键只在相应操作界面下才会有作用；如果功能键为蓝色表示时，请先按下 Fn 键组合使用；由于外部设备或系统更新，可能会出现个别功能键与说明不一致，发生如此情况，请以实物为准。

功能键图标参照说明：



请根据所购产品实际功能，查阅如下说明：

部分功能按键特别说明：（部分产品支持）

- 1、 + 背光灯开启、关闭及亮度调节，操作方式是：首次按灯光开启，第二次按是灯光亮度增强，第三次按灯光达到最亮，第四次按则关闭灯光。（**仅背光灯**）
- 2、 + 背光颜色切换，按这两个键可以切换六种不同的彩虹色和白色。（**仅背光灯**）
- 3、呼吸灯模式：有2个组合键， + 控制呼吸灯灭和亮， + 控制呼吸灯快和慢。（**仅背光灯**）
- 4、智能语音：打开设置→智慧助手→电源键唤醒打开→按 →智能语音
- 5、部分字符快捷键：
全选： + 复制： + 粘贴： + 剪切： +
- 6、 大小写切换
- 7、Fn+PgUp=主页 Fn+PgDn=结束

基本参数：（部分参数存在客观因素会有所差异）

工作电压：	3.0V~4.2V	工作电流：	≤3.0mA
工作时长：	≥80小时	低电报警：	3.0~3.3V
休眠电流：	≤0.3mA	待机时长：	≥100天
电池容量：	≥150mAh	按键力度：	50g~70g
按键寿命：	300万次	充电输入：	5V --- 1A
连接距离：	≤10m	充电时长：	2-3小时
充电电流：	≤200mA	唤醒时长：	2~3秒
充电接口：	MicroUSB (TYPE-C)	工作温度：	-10℃~+55℃
配对密码：	无		

维护与警告：

- * 不要挤压或扭曲、拍打键盘。
- * 不要进行微波扫描，远离磁场。
- * 远离液体，并在干燥环境中使用。
- * 用软布清洁键盘，长期不用请关闭电源。
- * 不要随意丢弃键盘，请按类别回收放置。

常见连接故障排除：

- * 确保电源已开启，且电池电量充足。
- * 如果多次无法充电，请尝试更换充电线。
- * 确保键盘在工作距离范围内。
- * 确保键盘和设备已经配对连接。
- * 清除设备的配对记录，并关闭蓝牙功能；再重新配对，必要时重启设备。
- * 请不要同时配对连接多个蓝牙键盘；如有需要请逐个连接。

触控板：（部分产品支持）

触摸滑鼠：适配不同的操作系统，手势命令会有所差别，请以产品实际情况为准。

单指操作



双指操作



三指操作



四指操作



Keyboard instruction

Please read the instructions carefully before use

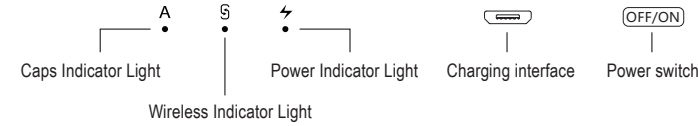

Keyboard connection operation:

- Turn on the power supply, and the green indicator light will be lit for one second (if the instruction is red, please charge in time).
Press the matching key "Fn+C/🔌" for 2 second, the Wireless indicator lights flicker into the pairing state, and the effective time is about 120 seconds.
Open the Wireless search function of the external device, click the "Wireless Keyboard" searched.
After the pairing is successful, the indicator lights go out, and you can use the keyboard.
- If there is no operation in 10 minutes, the keyboard will go to sleep state and wait for 2~3 seconds by any key to wake up.

Three-channel Bluetooth keyboard connection operation:

- Turn on the power supply, the green indicator lights for 1 second (if the indicator is red, please charge in time)
Pressing the matching key " Fn+C/🔌 " above 2 seconds, the Wireless indicator lights flicker into the pairing state, and the effective time is about 120 seconds.
Open the Wireless search function of the external devices, click the "Wireless Keyboard" searched.
After the pairing is successfully, the indicator lights go out, the first device 📶 is connected by default and you can use the keyboard.
- Pressing Fn+📶 or 📶, then pressing the matching key " Fn+C/🔌 " above 2 seconds, the Wireless indicator lights flicker into the pairing state, and the effective time is about 120 seconds. Open the Wireless search function of the external devices, click the "Wireless Keyboard" searched. After the pairing is successful, the indicator lights go out, and you can use the keyboard.

- If there is no operation in 10 minutes, the keyboard will go to sleep state and wait for 2~3 seconds by pressing any key to wake up.
- Pressing Fn+ 📶 or 📶 or 📶 to switch the keyboard between three-channel devices. When switching, the Bluetooth light up, indicating that the switch is completed.

Disconnect the keyboard connection:

- If you want to break the connection between keyboard and device, please clear the pairing information in the device, or turn off the keyboard power directly.

Electricity indicator:

- If the power indicator light is red slowly, the power is low, please charge it in time, the red light is bright when charging. When the indicator is green, it is full, please disconnect the charging power to ensure safety.

Shortcut function key: Please note that the function key only works under the corresponding operation interface; If the function key is blue, please press Fn key combination to use; Due to external device or system update, there may be some inconsistency between individual function keys and instructions. If this happens, please refer to the real object.

Refer to the function key icon for instructions:

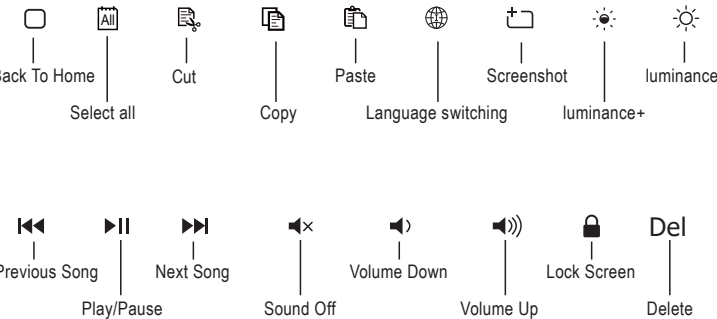

Please refer to the following instructions according to the actual functions of the purchased products : (Partial product support)

Special key instructions

- Fn + ✱ Turn on/off or adjust the backlit.
Operating method: Press once to turn on the backlit; Press again will increase the brightness; The third time will maximize the brightness; The fourth time will turn off the backlit (**only backlight version**)
- Fn + 🌈 Press these two keys to switch the rainbow backlight and white color (**only backlight version**)
- Breathing light model: Two key combinations, Fn + 🌈 can control breathing light off/on
Fn + 🌈 can adjust the speed of the breathing light. (**only backlight version**)
- Intelligent voice: turn on settings → intelligent assistant → power key wake-up on → press 🗨️ → intelligent voice
- Partial character shortcut keys:
Select all: Ctrl + A Copy: Ctrl + C Paste: Ctrl + V Shear: Ctrl + X
- Cap Lock Switch uppercase or lowercase:
- Fn+PgUP=home page Fn+PgDn=terminate

Basic parameters: (part of the parameters are objective factors will vary).

Working Voltage:	3.0V~4.2V	Working Current:	≤ 3.0mA
Working Time:	≥80 Hours	Low Voltage Alert:	3.0~3.3V
Sleeping Current:	≤0.3mA	Battery Standby Time:	≥100 Days
Battery Capacity:	≥150mAh	Keystrokes:	50g~70g
Keyboard Lifetime:	300 Million Times	Charge Input:	5V --- 1A
Connect Distance:	≤10m	Charging Time:	2~3 Hours
Charging Current:	≤200mA	Awaken Time:	2~3 Seconds
Charging Port:	Micro USB (or Type-C)	Working Temperat:	14°F~131°F
Matching Password:	No		

Maintenance and warning:

- Do not squeeze or twist, clap the keyboard.
- Do not scan the microwave and get away from the magnetic field.
- Away from the liquid and used in a dry environment.
- Clean the keyboard with soft cloth, do not turn off the power for a long time.
- Other routine maintenance of electronic products.

Common connection Troubleshooting:

- Make sure the power is turned on and the battery is sufficient.
- Make sure that the keyboard is within the range of working distance.
- Make sure that the Wireless related function of the device has been opened.
- Make sure that the keyboard and the device have been paired.
- Clear device pairing record and turn off Wireless function; re match.
- Please do not connect multiple Bluetooth keyboards at the same time; if necessary, please connect one by one.
- Please try to change charging cable if repeated failure to charge.

** This product will not be updated in time for continuous product improvement. If there is any discrepancy, please refer to physical products.

Touch the trackpad: Different operating system, gesture command will be different, please refer to the actual situation of the product.

One Finger

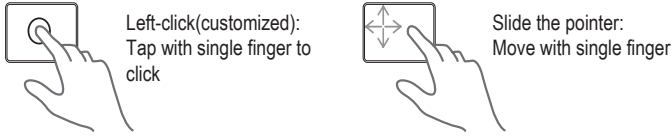

Double Fingers

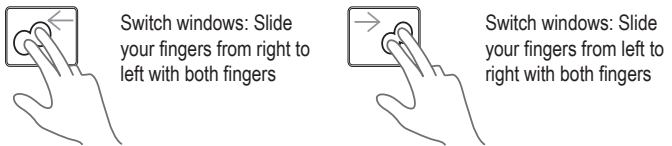

Three Fingers

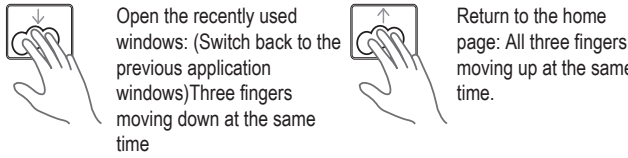

Four Fingers

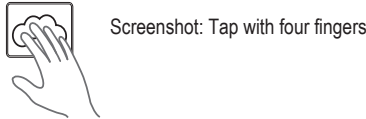

*We won't note you if changing the content of user manual.
MADE IN CHINA

FCC Caution.

This device complies with part 15 of the FCC Rules. Operation is subject to the following two conditions:

- (1) This device may not cause harmful interference, and
- (2) this device must accept any interference received, including interference that may cause undesired operation.

Any Changes or modifications not expressly approved by the party responsible for compliance could void the user's authority to operate the equipment.

Note: This equipment has been tested and found to comply with the limits for a Class B digital device, pursuant to part 15 of the FCC Rules. These limits are designed to provide reasonable protection against harmful interference in a residential installation. This equipment generates uses and can radiate radio frequency energy and, if not installed and used in accordance with the instructions, may cause harmful interference to radio communications. However, there is no guarantee that interference will not occur in a particular installation. If this equipment does cause harmful interference to radio or television reception, which can be determined by turning the equipment off and on, the user is encouraged to try to correct the interference by one or more of the following measures:

- Reorient or relocate the receiving antenna.
- Increase the separation between the equipment and receiver.
- Connect the equipment into an outlet on a circuit different from that to which the receiver is connected.
- Consult the dealer or an experienced radio/TV technician for help.

FCC Radiation Exposure Statement:

The device has been evaluated to meet general RF exposure requirement. The device can be used in portable exposure condition without restriction.