

Dymesty AI Glasses Instruction Manual

Items in the Packaging

- Dymesty AI Glasses
- Glasses case
- Product instruction manual
- USB-C charging cable
- Cleaning cloth

Product Illustration

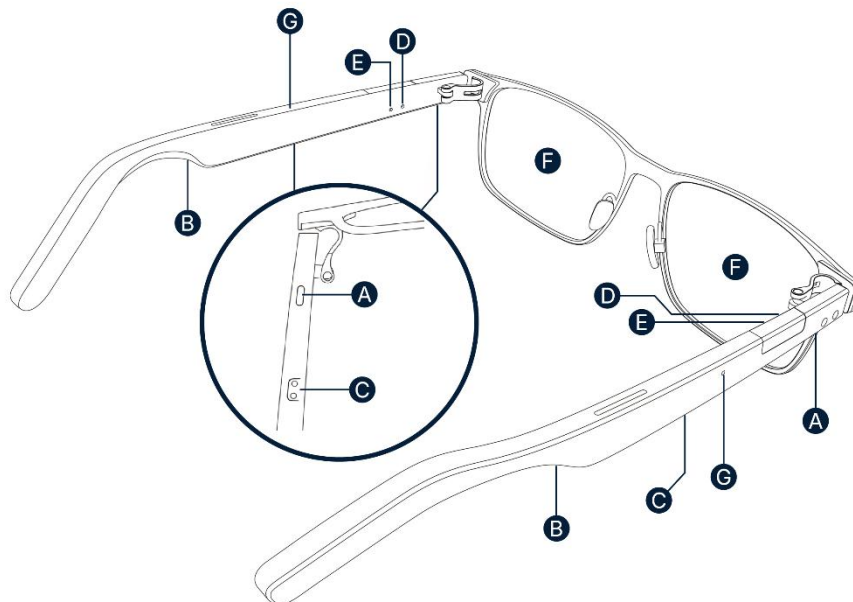

- A. Button
- B. Built-in Speaker
- C. Charging Port
- D. Status Indicator
- E. Omnidirectional Microphone
- F. Lenses (Clear or Polarized Sunglass Lenses)
- G. Noise-Reduction Microphone

Requirements

1. AI Glasses Requirements

Devices with Bluetooth connectivity, such as smartphones, laptops, tablets, etc.

2. Dymesty AI Glasses App Requirements

2.1 iOS 12 / Android 8.1 (or later) device with Bluetooth

2.2 Internet connection for app installation

Registration

Download the Dymesty App, register/login, and receive a 1-month free trial of AI Meeting Recording, AI Translation, and other features.



DYMESTY

Quick Start Guide

1. Charging Your Dymesty AI Glasses

1.1 Connect the charging pins to the ports at the bottom of each temple. Plug the USB-C cable into a power source. First-time use: Fully charge before initial use (~1 hour for depleted battery).

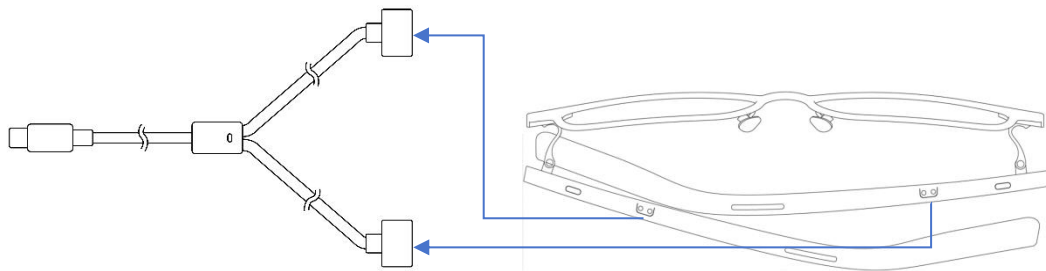

1.2 When charging, Dymesty AI Glasses will continuously display the current charging status through two indicator lights as follows:

Red light flashing indicates charging in progress.

Green light staying on indicates fully charged.

2. Pairing with Mobile Device

To power on and activate pairing mode, simply unfold both temple arms of the glasses. The device will emit a prompt tone, indicating it is searching for compatible Bluetooth devices, while the

status indicator light flashes white. Follow your device's instructions to pair it with the Dymesty AI Glasses. Upon successful pairing, the status indicator will flash green once.

Note: After initial pairing, the glasses will automatically attempt to connect to the paired mobile device each time you open the temple arms. If connection fails within 10 seconds, the glasses will revert to pairing mode. The glasses can connect to one device at a time but support pairing with up to 6 devices.

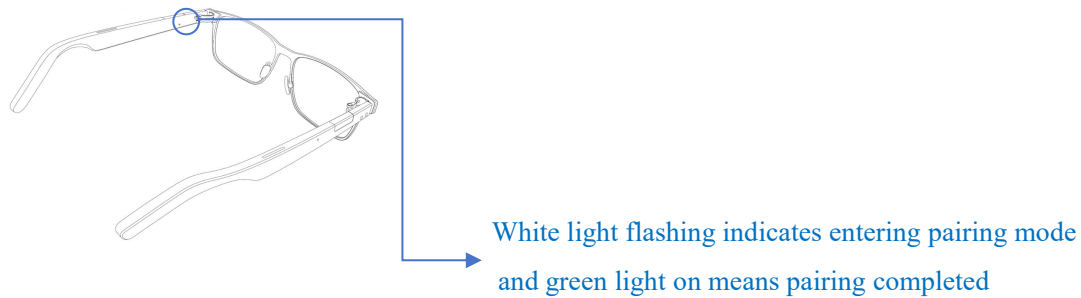

3. Using Your AI Glasses

Dymesty App Features

Access advanced AI functions: Meeting Recording, Real-time Translation, etc.

3.1 Search for "dymesty" in the iOS/Android app store and download the application.

3.2 Launch the app and follow on-screen instructions.



DYMESTY

4. Power On/Off

To turn off the glasses, close both temple arms. To turn on the power, open both temple arms.

Dymesty AI Glasses will emit a prompt tone to notify you when the power is turned on or off.

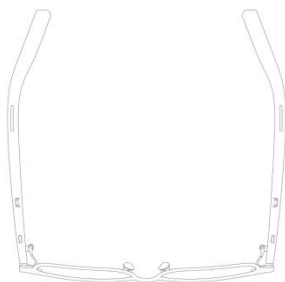

Power on

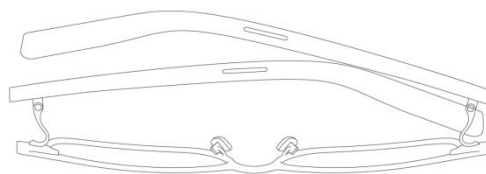

Power off

5. Auto Power-Off

Glasses shut down after several minutes if disconnected/unpaired (audible alert). Wake by closing/opening temples.

6. Pairing Management

6.1 Re-pairing

When the glasses are already paired, to pair them with another device, press and hold the button on one temple arm for 6 seconds to activate pairing mode. The glasses will emit a prompt tone to indicate they are searching for compatible Bluetooth devices. Simply follow the instructions of the new device to pair it with the Dymesty AI Glasses.

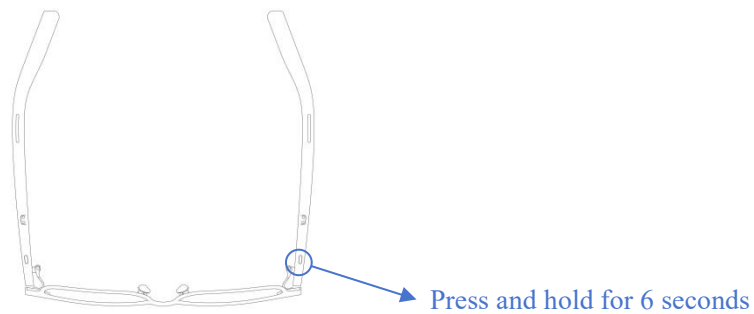

6.2 Remove paired device

To remove a paired device, go to the Bluetooth settings interface of the device and cancel the pairing with Dymesty AI Glasses.

7. Low Battery Alert

When not connected to a power source, if the glasses need charging, the status indicator will flash red three times, accompanied by a voice prompt.

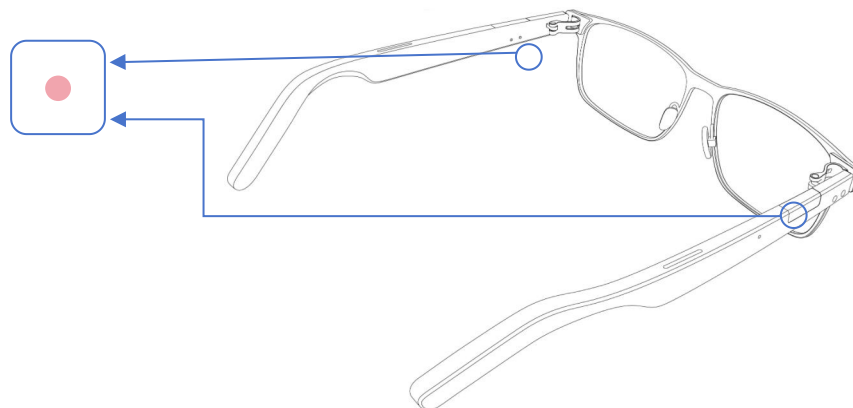

8. Button Controls Quick Reference

The following functions can only be used when the glasses are paired with a mobile device and the APP is downloaded and connected. These functions can be controlled by any button on the left or right temple. Visit our official website www.dymesty.com to learn more about the features of your new AI glasses.

Action	Function	Audible Feedback	Light Indicator
Single Press	Answer call	None	None
	End call	None	None
	Play-Pause media	None	None
Double Press	Activate voice assistant	Prompt tone	None
Hold 1s	During an incoming call alert: Reject the call.	None	None
	When not in an incoming call alert state: Turn recording on/off.	Prompt tone	None
Hold 3s	Mute one side (mutes the side where the button is pressed)	None	Red light (1s)
	Unmute one side (unmutes the side where the button is pressed)	None	Green light (1s)
Hold 6s	Re-pairing	Prompt tone	White blinking light

FCC Statement

This device complies with part 15 of the FCC Rules. Operation is subject to the following two conditions: (1) This device may not cause harmful interference, and (2) this device must accept any interference received, including interference that may cause undesired operation.

This equipment has been tested and found to comply with the limits for a Class B digital device, pursuant to part 15 of the FCC Rules. These limits are designed to provide reasonable protection against harmful interference in a residential installation. This equipment generates, uses and can radiate radio frequency energy and, if not installed and used in accordance with the instructions, may cause harmful interference to radio communications. However, there is no guarantee that interference will not occur in a particular installation. If this equipment does cause harmful interference to radio or television reception, which can be determined by turning the equipment off and on, the user is encouraged to try to correct the interference by one or more of the following measures:

- Reorient or relocate the receiving antenna.
- Increase the separation between the equipment and receiver.
- Connect the equipment into an outlet on a circuit different from that to which the receiver is connected.
- Consult the dealer or an experienced radio/TV technician for help.

Caution: Any changes or modifications to this device not explicitly approved by manufacturer could void your authority to operate this equipment.

RF Exposure Information

The device has been evaluated to meet general RF exposure requirement. The device can be used in portable exposure condition without restriction.