

Multi-purpose Aircraft

User Manual

Thank you for purchasing our products. To ensure correct use and safety, please read this instruction manual carefully before using the product and keep it properly for future reference.

CONTENTS

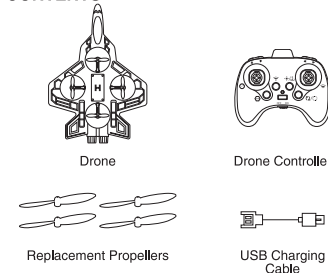

HOW TO REPLACE PROPELLER

1. Pull hard to remove the damaged propeller, replace it with a new one, and push hard and carefully.
2. There is a letter on each blade, match the blade with the corresponding letter on the drone.

CHARGING/BATTERY DRONE

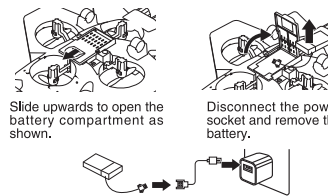

Insert the USB port of the USB charging cable into the computer's USB port (or use a 5V-2A power adapter), and connect the other end of the USB charging cable plug to the battery socket. When charging, the indicator light on the USB charging cable stays on, and it turns off when charging is complete.

REMOTE CONTROL

Open the battery cover and install it 2X1.5V "AA" batteries, as shown in figure

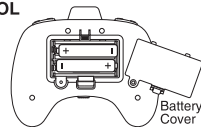

RECHARGEABLE BATTERY WARNING (REPLACEABLE BATTERY)

There is a risk of fire and personal injury if the battery is punctured, damaged or misused.

- Do not disassemble, crush, burn or use short-circuit batteries
- Do not expose the battery to extreme temperature or humidity
- Keep away from flammable materials and direct sunlight
- Only use the charger, wire or adapter provided
- The battery can only be charged by adults
- Adult supervision is required when charging
- Allow the battery to cool to the proper temperature before charging
- Please stop charging if the battery gets hot, expands, smokes or gives off a strong smell
- Charge on non flammable materials and keep away from flammable materials
- Battery chargers, power cords, plugs, enclosures and other components used with this product should be checked regularly and observed for damage or not, if damaged, used after repair of the damage
- Remove the battery before storage (if removable)
- Recycle or dispose of batteries according to local laws
- The battery or battery pack should not be disassembled, crushed, punctured, opened or otherwise destroyed
- If the battery is swallowed, seek medical advice immediately
- If the electrolyte comes into contact with skin or eyes, rinse immediately with fresh water for at least 15 minutes and seek medical advice immediately
- Store batteries in their original packaging and keep away from metal objects that may short circuit them
- Do not drop the battery or subject it to strong mechanical impact
- During use and storage, keep the battery or battery pack clean and dry. If the metal terminal is dirty, please wipe it with a soft dry cloth
- Charge the battery or battery pack before use
- It may be necessary to charge and discharge the battery or battery pack twice or three times to obtain the best performance when it is used for the first time or stored for a long time
- It is better to charge the battery or battery pack at 15 °C to 30 °C Unless otherwise specified by the manufacturer
- Keep original product information for future reference

Battery warning

- Do not mix old and new batteries
- Do not mix alkaline batteries, standard batteries (carbon zinc batteries) or rechargeable batteries
- Alkaline batteries are recommended (only batteries of specified voltage are used)
- Insert the battery with the correct polarity, be sure to use it under the supervision of an adult, replace the battery and charge it (if applicable)
- Do not try to charge a non rechargeable battery
- Do not short circuit the battery supply terminal
- Do not handle the battery in the fire, the battery may explode or leak
- Remove the battery before storage
- Recycle or dispose of batteries according to local laws
- Please keep these instructions for future reference

OVERVIEW

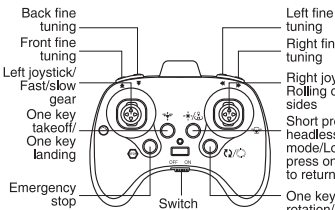
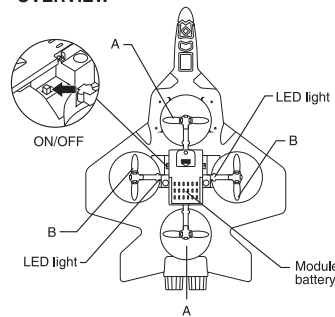

DRONE OPERATION GUIDE

1. Pre flight inspection

1. Read all the warnings and instructions
2. Install batteries of drone and remote control
3. Make sure the drone and remote control are powered off
4. Charge the battery

2. Select location

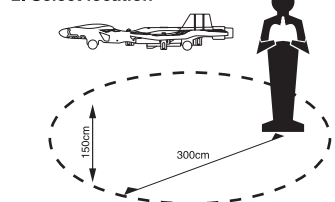

Before retrieving or picking up the drone, be sure to turn off the remote control to avoid starting the propeller accidentally

3. Paired drone

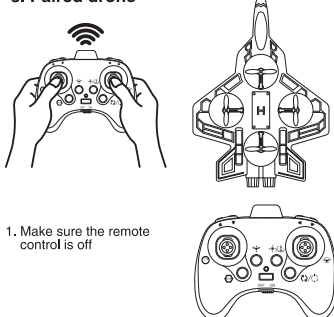

1. Make sure the remote control is off

2. Turn on the drone switch

3. Put the drone on flat ground

4. Turn on the remote control and automatically adjust the frequency.

5. The light of drone will flicker during the pairing process and remain on after pairing

6. Calibrate the drone (calibrate the drone when the drone is unstable and flying wildly)

Turn on the aircraft and place it flat on the ground, then turn on the remote control. Before takeoff, push the two joysticks to the outer tilt angle for 2-3 seconds, and wait for the aircraft lights to flash from fast to long. The aircraft calibration is completed.

CIRCLING

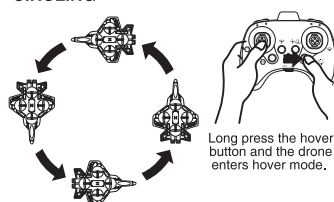

ONE KEY TAKE OFF & LANDING

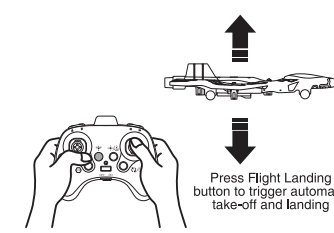

SURROUND

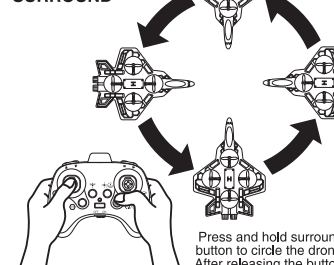

OPERATION INTRODUCTION

Hover up and down

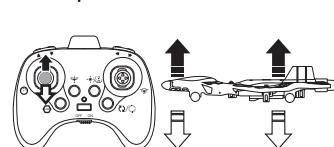

Turn left / right

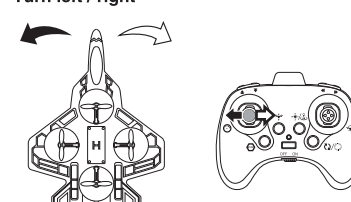

Forward and backward

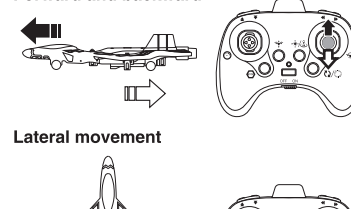

Lateral movement

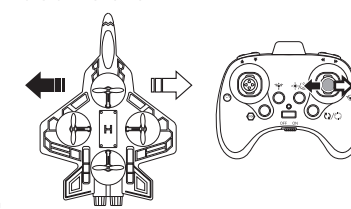

ADVANCED MODE

1. 360° rotation

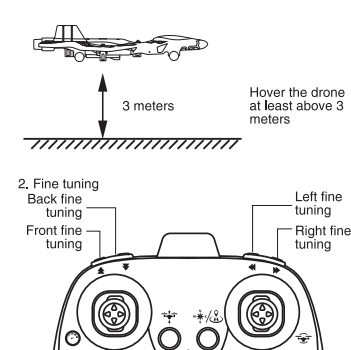

3. Press down on the right joystick and move it left or right to flip the drone left or right (flipping must be achieved with sufficient power)

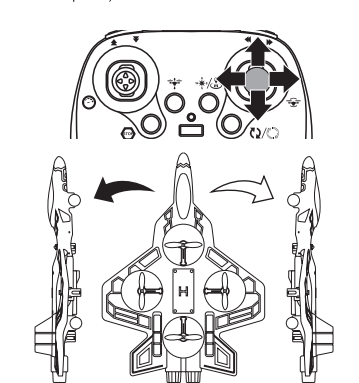

AUTO ORIENTATION

When the drone is in auto orientation mode, the drone will orient to the user (remote control) no matter which direction the drone faces

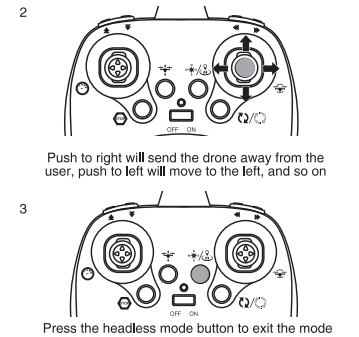
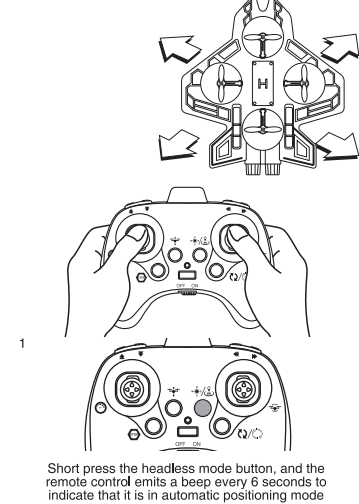

TIPS
WARNING: Without the explicit approval of the responsible party, changes or modifications to the device may cause the user to lose the authority to operate the equipment

- Do not crash the drone into sand or sand, the gears of the drone may be clogged
- When learning to fly for the first time, practice taking off and spinning
- Please keep several feet away from the walls and buildings
- Always press the throttle lever all the way after crashing or when something gets stuck in the propellers
- Do not use drone above or near people, sudden change of wind or other conditions may cause accidental crash
- You should be cautious when flying the drone, abide by the relevant laws, and respect the privacy and property rights of others
- The drone shall never be modified or used for anything except its intended purpose

TROUBLE SHOOTING

When the remote control switch is turned on, the remote control lamp does not light:

- 1) Check that the battery in the remote control is installed correctly
- 2) Replace the battery with a new one

The remote control power indicator flashes during flight

- 1) The remote battery is low. Land the drone immediately
- 2) Replace the old battery

The drone and the remote control are paired correctly, but the drone can not take off:

The drone battery needs to be charged, use the USB charging cable to connect the drone battery to the power source

After fine-tuning the drone, the flight is very unstable, unable to fly normally:

- 1) One or more blades may be damaged. Please replace the appropriate blades and try to fly again
- 2) Press down the remote control lever to inner side of the remote control for 5 seconds, the remote control will make 2 beeps, and the gyroscope reset
- 3) Turn off the drone and remote control, and then pairing the drone

Remote control and drone cannot be paired:

The remote control must be within 3 meters of the drone. Note: If there are multiple unpaired drones within 3 meters, one must be successfully paired before other drones can be paired

FCC Caution.

This device complies with part 15 of the FCC Rules. Operation is subject to the following two conditions:

- (1) This device may not cause harmful interference, and
- (2) this device must accept any interference received, including interference that may cause undesired operation.

Any Changes or modifications not expressly approved by the party responsible for compliance could void the user's authority to operate the equipment.

Note: This equipment has been tested and found to comply with the limits for a Class B digital device, pursuant to part 15 of the FCC Rules. These limits are designed to provide reasonable protection against harmful interference in a residential installation. This equipment generates uses and can radiate radio frequency energy and, if not installed and used in accordance with the instructions, may cause harmful interference to radio communications. However, there is no guarantee that interference will not occur in a particular installation. If this equipment does cause harmful interference to radio or television reception, which can be determined by turning the equipment off and on, the user is encouraged to try to correct the interference by one or more of the following measures:

- Reorient or relocate the receiving antenna.
- Increase the separation between the equipment and receiver.
- Connect the equipment into an outlet on a circuit different from that to which the receiver is connected.
- Consult the dealer or an experienced radio/TV technician for help.

* RF warning for Portable device:

The device has been evaluated to meet general RF exposure requirement. The device can be used in portable exposure condition without restriction.