

# **Intelligent Air Pillow**

**U Pillow Cube**

## **User Manual**

Please read this manual carefully before use

**1. Product Overview**

The intelligent air pillow consists of a pillow, air bag, and control box to form a snoring relief system.

When the user snores, the sensor inside the pillow will collect and analyze it through the built-in algorithm. After determining the snoring sound and sensing the snoring vibration, the pressure sensor will identify the position of the user's head and transmit the data to the control system. The control system automatically inflates the corresponding flexible airbag on the head slowly based on the received data, pushing the snorer to move the head position, thereby adjusting the airway angle to alleviate snoring until the snoring is weakened or eliminated.

**2. Main Technical Specifications**

Name	Intelligent Air Pillow
Model	U Pillow Cube
Pillow Size	600mm*440mm
Controller Size	154.5mm*139mm*81mm
Net Weight	Approximately 2.9kg
Input Voltage	AC 100~240V, 50/60Hz
Storage and Transportation Temperature	-15~55℃
Operating Temperature	5-40℃
Operating Humidity	≤70%RH
Operating Atmospheric Pressure	700~1060hpa
Noise	The product should operate smoothly under normal conditions, with the A weighted sound pressure level not exceeding 28dB(A)

### 3. Packing List

1	Pillow and removable and washable pillowcase	2	Height adjustment pad
3	control box	4	Power Adapter/Charging Cable
5	User Manual (including warranty card and certificate of conformity)		

### 4. Instruction for Use

#### 4.1 Instruction of the light

Power light	The light turns on when powered.
	The light turns off when the power is disconnected.
Bluetooth Connection Indicator Light	Press and hold for 3 seconds to start Bluetooth pairing; the light will begin to flash.
	The light will remain steady once connected successfully.

#### 4.2 How to Use

1. Place the intelligent air pillow steadily in the correct position and orientation on the bed, then manage the pneumatic connecting tube smoothly and place the control box on the bedside table or the floor.
2. Plug in the adapter to connect to the power supply. The blue power indicator light will turn on.
3. Press and hold the Bluetooth button until the blue light flashes, indicating the device is ready to connect to a network.

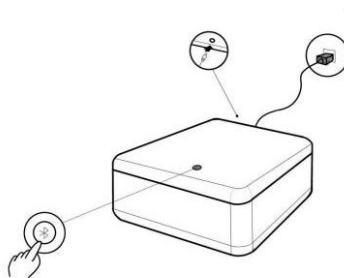

4. Lie flat with your head centered on the intelligent air pillow. The pillow will start gathering your sleep status data before you fall asleep or if you're not snoring, which may take around 5 minutes.

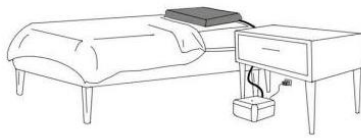

5. After the sleep data collection is complete, you can experience the intelligent air pillow 's snore-relief feature.

#### **Tips:**

- While the intelligent air pillow is collecting sleep data, the user should lie flat and remain still. Any movements during this time can interfere with accurate data collection.
- If there are movements like turning over or shifting your head, the pillow will assume the user is awake, and the system will not collect data on these movements.
- Due to variations in each person's head weight and lying position, the data collected by the sensor may differ. Therefore, it is necessary to recalibrate the data before use when switching to a different user.

## **5. Precaution**

### **5.1 Storage Precautions**

- 1) Whether in use or not, avoid dropping or bumping the control box.
- 2) Do not disassemble or modify the device without authorization.
- 3) Do not use outdoors, especially in humid environments, as this may cause malfunction.
- 4) Do not use in high-temperature or highly humid environments.

### **5.2 Precautions for Use**

- 1)The intelligent air pillow should only be used with the designated pillow core

provided by our factory.

- 2) Pillowcase can be disassembled and washed, not with boiling water.
- 3) The pillow core is not removable for cleaning.
- 4) The body of the machine and the pillow core can be wiped with a wet towel or a wrung-out towel.
- 5) Prohibited for epilepsy patients.
- 6) Consult a doctor before use if you have any of the following diseases:
  - People suffering from stroke, high blood pressure and other vascular diseases.
  - Users of neck and back surgery.
  - Patients with respiratory diseases.

## **6. Cleaning and Maintenance**

- The pillowcase can be removed and washed according to the instructions indicated on the wash label (inside of the pillowcase).
- Do not remove the pillow core protective cover as this may affect the normal operation of the sensitive technology components inside the pillow. If damaged, it will not be covered under the repair warranty.
- The pillow core itself should not be washed or dry cleaned. After removing the pillowcase, place the pillow in a ventilated area or gently wipe the surface of the protective inner cover with a slightly damp cloth to remove dust or stains.
- Do not place the product in water, near fire, in areas with high humidity, or in direct sunlight.

## 7. Common Malfunctions and Solutions

Fault Phenomenon	Fault Cause Analysis	Solutions
Pillow unresponsive	Noisy surroundings	Please use the product in a normal sleeping environment.
	Head not resting on pillow	Ensure the head is correctly positioned on the pillow when using the product
	Snoring not detected	Adjust sensitivity via the APP
	Faulty circuitry or sensors	Contact after-sales service for maintenance
Cannot boot properly	Loose or unconnected power supply	Check the power socket and power cord connection
	Circuit failure	Contact after-sales service for maintenance

## 8. Warranty Instructions

- The intelligent air pillow is covered by a one-year warranty starting from the date of purchase, including defects in raw materials or workmanship due to production under normal use and proper maintenance.
- The warranty does not cover normal wear and tear, excessive abuse or misuse.
- The warranty period will not be extended by exchange or repair.
- Warm tip: Warranty products need to provide proof of purchase (invoice or receipt).

### **The warranty does not apply in the following cases:**

- Failure to provide proof of purchase (receipt or invoice), or if the proof of purchase date exceeds the warranty period.
- Normal wear and tear, excessive abuse or misuse.
- Failure to use the product in accordance with the product instructions.

- Failure due to deliberate human damage or careless use.
- Components or parts have been repaired or modified by persons other than our company.
- Incomplete warranty sticker on the anti-tamper clasp on the pillow or on the control box.

## 9. Warranty Card

Product Name	Intelligent Air Pillow	Model	U Pillow Cube
Serial Number		Date of purchase	
Warranty Period	Product is warranted for one year from date of purchase. Warranty terms need to be met.		
Customer Address			
Place of purchase			
Maintenance record column			
Maintenance content		After-sales service stamp	Date
After sales service enterprise: Zhejiang Youdian Medical Technology Co.,Ltd Contact number: 4008550525 Address: 168 Juchuang Road, West Industrial Park, Guanhaiwei Town, Cixi City, Zhejiang Province			

FCC Statement:

This device complies with part 15 of the FCC Rules. Operation is subject to the following two conditions:

- (1) This device may not cause harmful interference, and
- (2) this device must accept any interference received, including interference that may cause undesired operation.

This equipment has been tested and found to comply with the limits for a Class B digital device, pursuant to part 15 of the FCC Rules. These limits are designed to provide reasonable protection against harmful interference in a residential installation. This equipment generates, uses and can radiate radio frequency energy and, if not installed and used in accordance with the instructions, may cause harmful interference to radio communications.

However, there is no guarantee that interference will not occur in a particular installation. If this equipment does cause harmful interference to radio or television reception, which can be determined by turning the equipment off and on, the user is encouraged to try to correct the interference by one or more of the following measures:

- Reorient or relocate the receiving antenna.
- Increase the separation between the equipment and receiver.
- Connect the equipment into an outlet on a circuit different from that to which the receiver is connected.
- Consult the dealer or an experienced radio/TV technician for help.

Caution: Any changes or modifications not expressly approved by the party responsible for compliance could void the user's authority to operate the equipment.

This equipment complies with FCC radiation exposure limits set forth for an uncontrolled environment. This transmitter must not be co-located or operating in conjunction with any other antenna or transmitter.

**Certificate of Conformity**

Product Name: Intelligent Air Pillow

Product Model: U Pillow Cube

Inspection Conclusion: The product has passed inspection and is approved for release from the factory.

Inspection Date:

Inspection Seal: