

Tenting

1. Turn off Create – Disconnect the USB-C cable and module and ensure that the power switches are in the OFF position.
2. Lift Create – With one hand, pick up the keyboard and firmly grasp the main body.
3. Grasp wing hinge – With the other hand place your thumb over the middle two wing keys and grasp firmly with your remaining fingers on the bottom.
4. Bend wing hinge – Apply steady pressure upwards (towards the keycaps) until the wing reaches the desired angle.
5. Grasp dock hinge – Grasp the dock by pressing your thumb onto the metal body (avoid pressing on connection pins), supporting the bottom of the dock with your remaining fingers.
6. Bend dock hinge – Apply downward force to the module dock, until it reaches the desired angle.
7. Repeat for both halves – Repeat this process for the other half of Create.

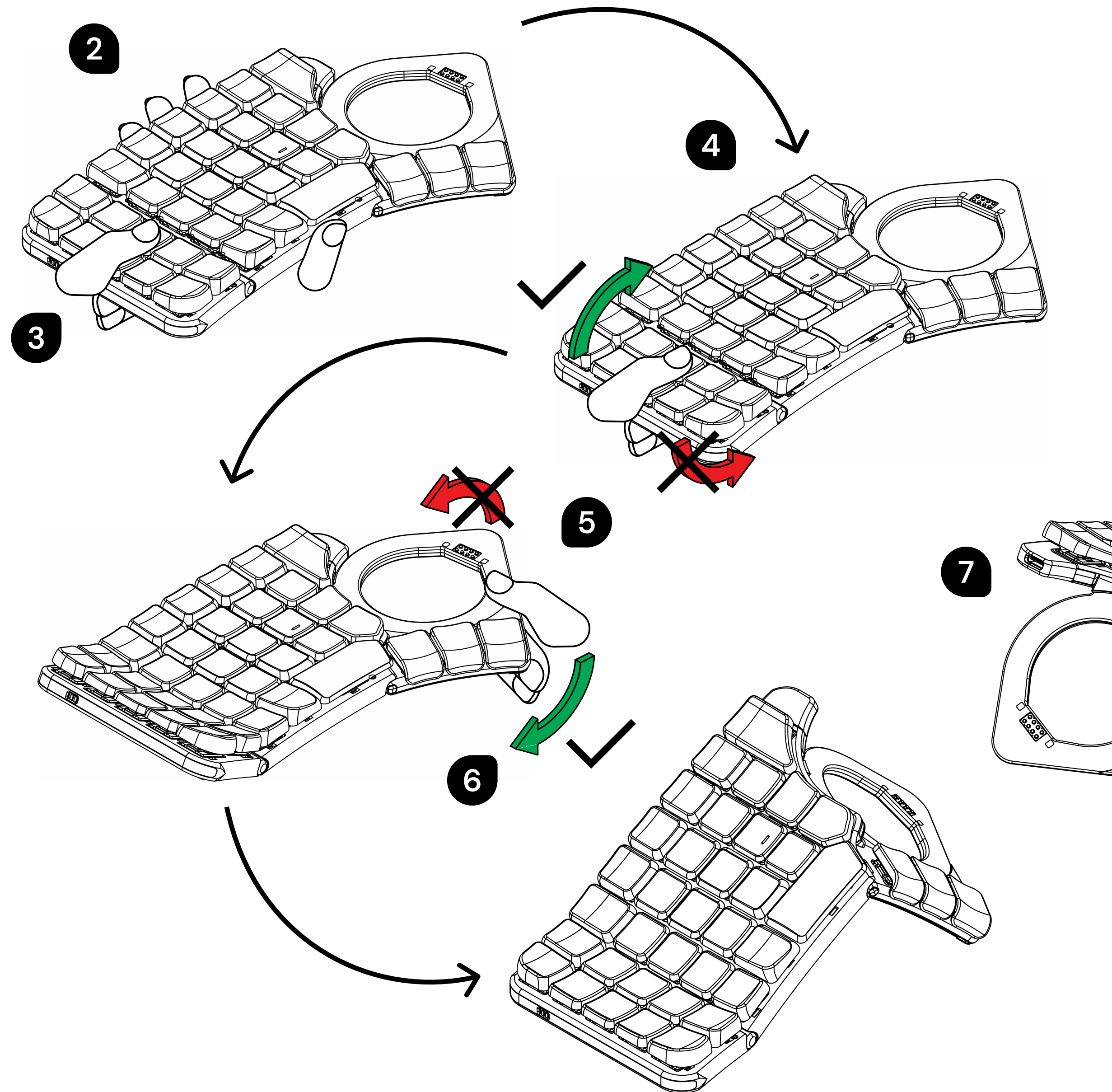
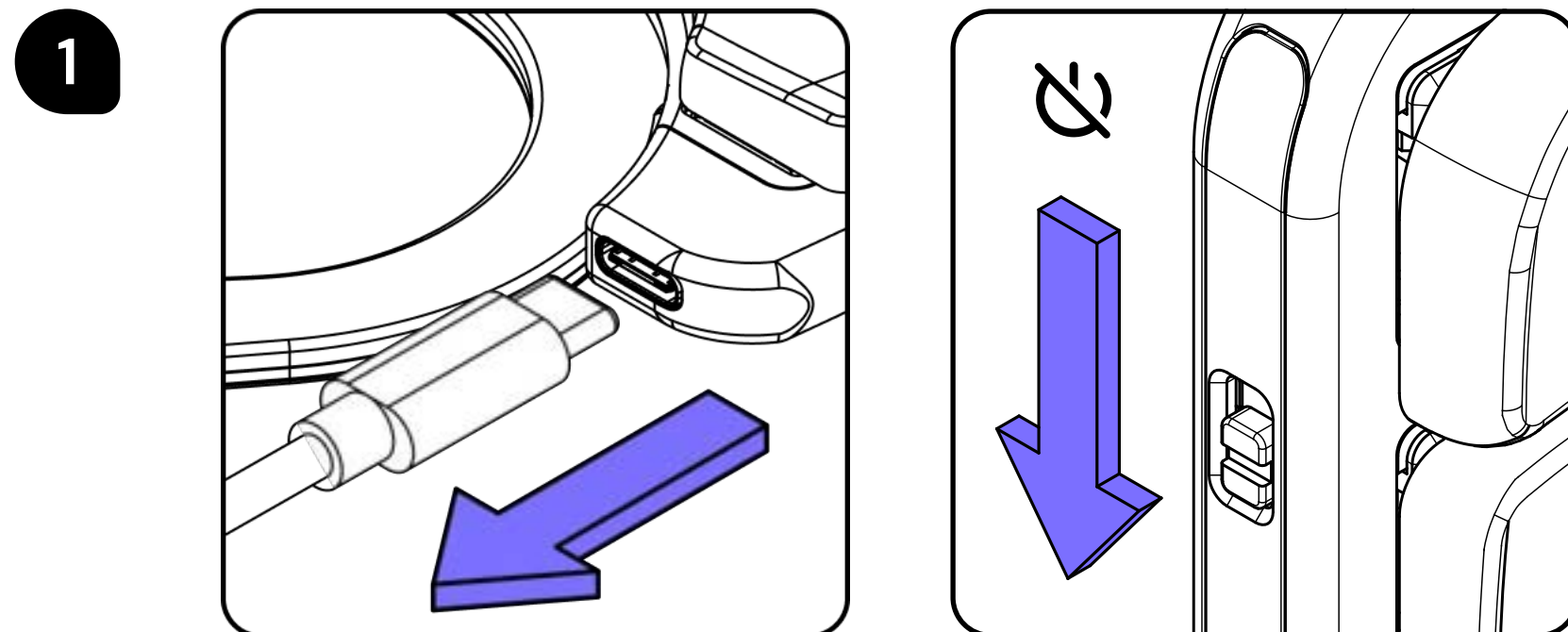

Do not attempt to force the hinges of Naya Create beyond their normal range of motion!

Docking & Removing Modules

Docking Modules

- 1. Align module – To dock a Naya module with your Naya Create keyboard, align the pogo pins of the module and keyboard.
- 2. Insert the module – Gently insert the module. The magnets in the dock and on the bottom of the module will attract and hold it in place.
- 3. Ensure proper seating – Make sure the module is seated completely flat. This ensures a proper connection with the data pins for full functionality.

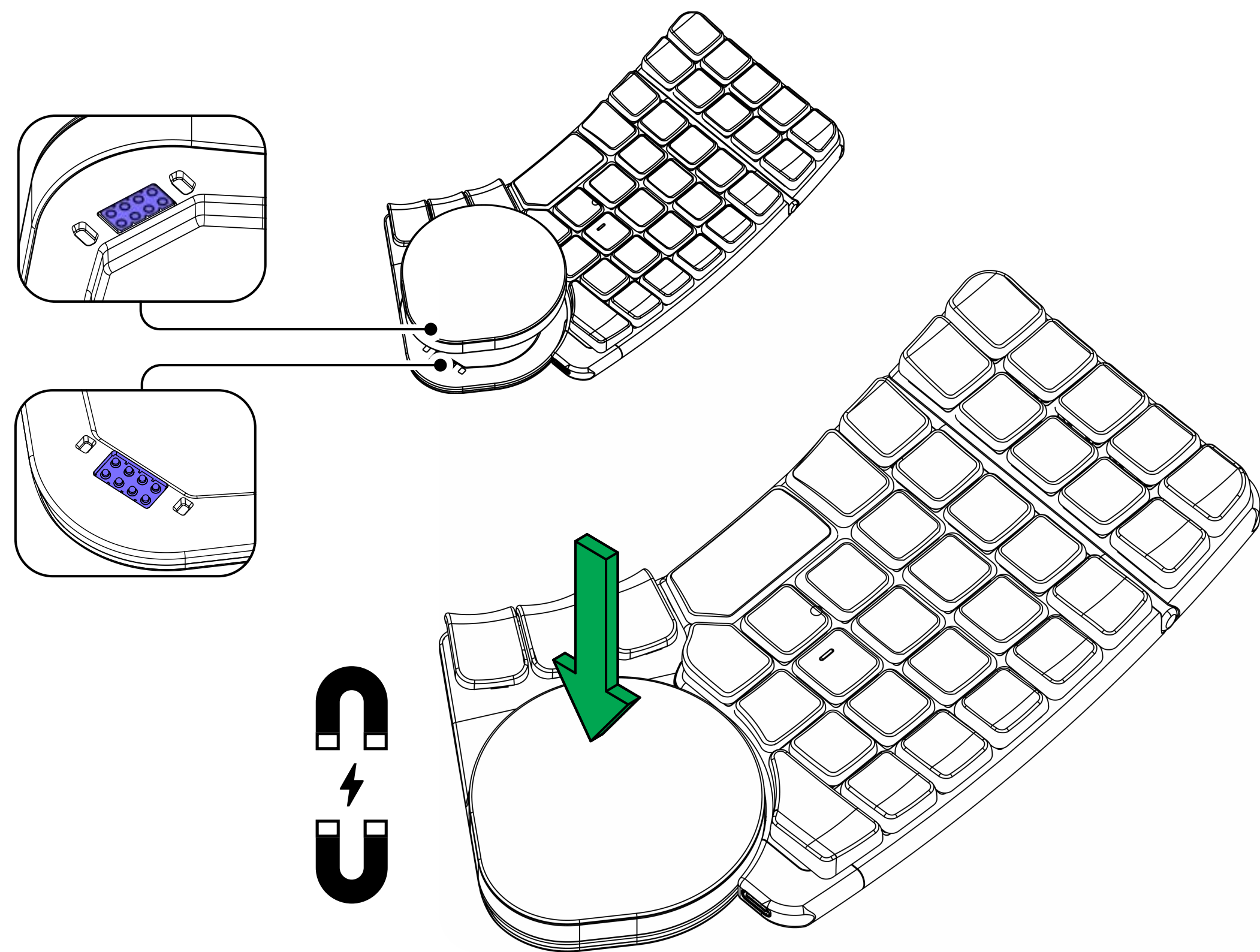

Be careful to not bridge pogo-pins while docking or undocking modules!

Removing Modules

- 1. Hold Create – Hold the keyboard aloft, or rest it tented on a flat surface for stability.
- 2. Grasp the module – Grasp the top of the module, placing one or more fingers underneath the module through the module dock cutout, and gently press upward.
- 3. Undock the module – The module will separate from the magnetic link with the module dock.
- 4. Refer to User Manual – For specific undocking guidance for individual modules, please refer to the user manual for that module.

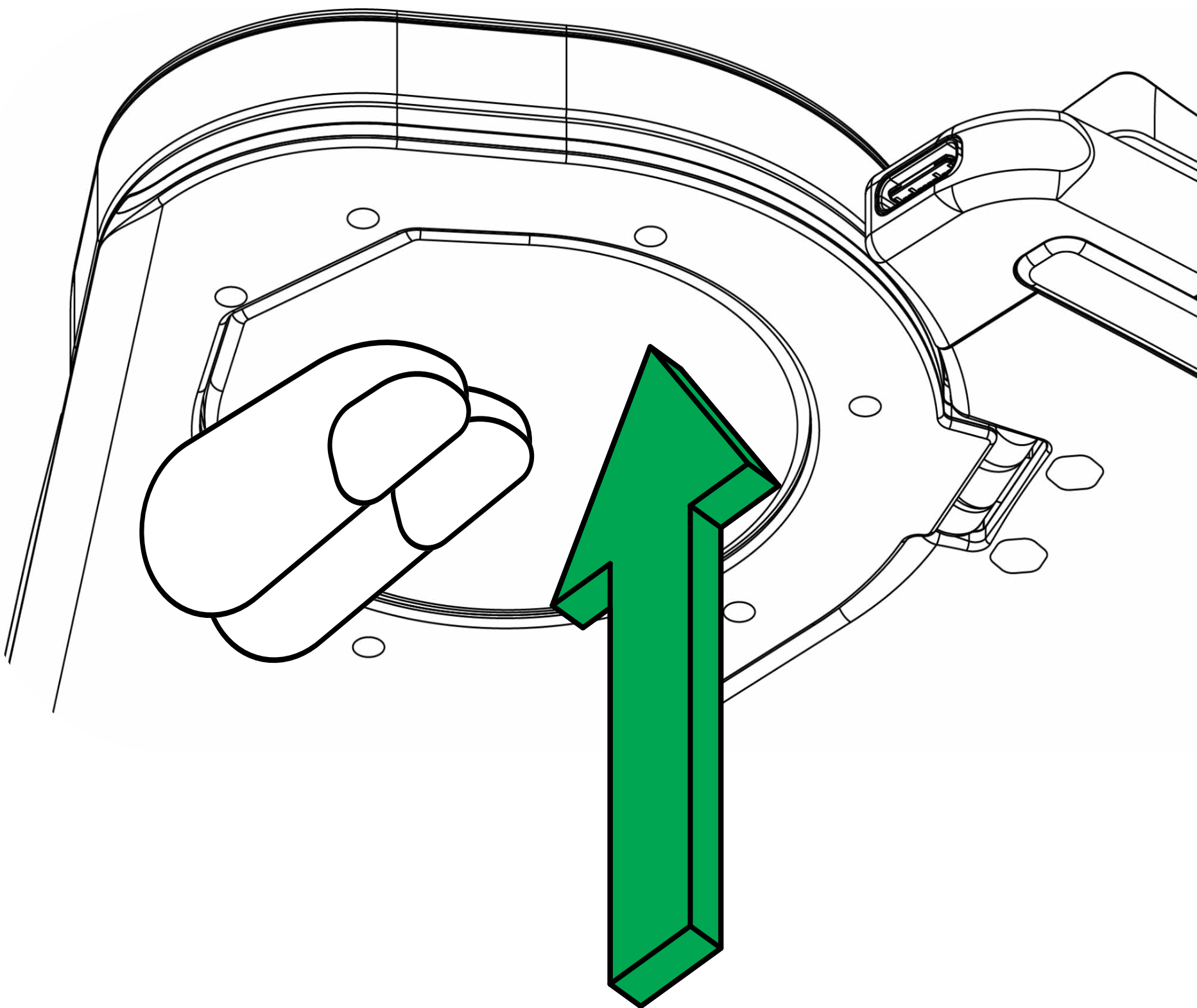

Maintenance & Care

- 1. Turn off Create – Disconnect the USB-C cable and ensure that the power switches are in the off position.
- 2. Remove dust and debris – Take a dry microfiber cloth and gently wipe the surface of the keyboard. Start by wiping the keycaps in a circular motion to remove dust and dirt.

 **Do not use liquid cleansers to clean Create!**

 **Do not clean pogo pin connections with liquids, chemicals or physical abrasion as you risk permanently damaging the connection.**

Storing Naya Create

Naya Create can be stored in your travel case with modules attached. Make sure to:

- Turn off both halves of your Naya Create to prevent accidental keypresses and preserve battery.
- Use the provided spacers to pack empty space and prevent shifting while stored.

