



## User Manual

Version 1.0.6

**Ergonomic detachable wireless  
mechanical keyboard  
NAYA-800-1(NAYA-CREATE)**

All rights reserved. Naya B.V.  
Wasaweg 3, 9723JD Groningen, Netherlands

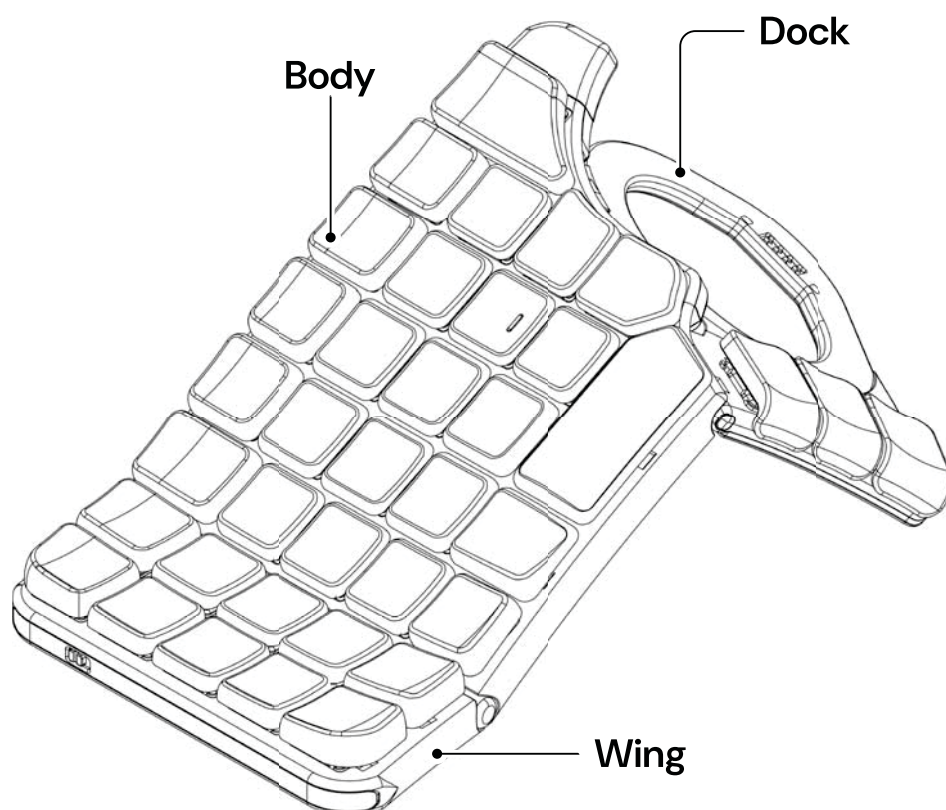

# Whats in The Box ?

- A** Travel Case
- B** Naya Create
- C** Speedlink Dongle
- D** 1m USB Type-C Y-Cable
- E** Keycap/Switch Puller
- F** Spare/Sample Switches (3x)
- G** Module Spacers (2x)

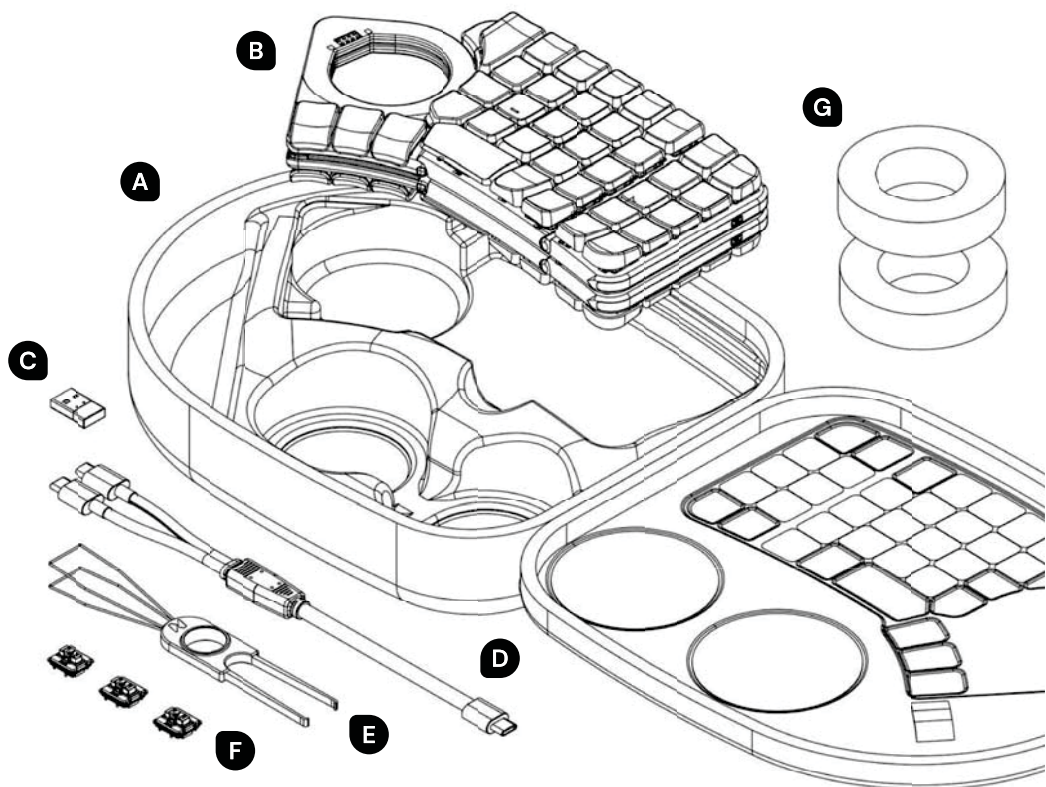

Whats in The Box?

Product Information

Power

Connectivity

Handling

Keybindings

Additional Information

# Product Information

Naya Create is a split-ergonomic keyboard design with a module dock on each half to hold specialized control modules. For more information on each module please refer to the user manual of that specific module.

## Features

- Programmable Key Behavior
- Programmable RGB Backlighting
- In-built tenting up to 27°
- Modular design for additional inputs
- Foam-suspended PCB for sound dampening
- Dedicated Customization Software

## OS Compatibility

- Windows 10 and Newer
- macOS Ventura and Newer
- Tested on Ubuntu 24.04 LTS

 Naya Hardware and Software may function on earlier OS versions but has not been tested and cannot be guaranteed to function.

## Third-Party Input Compatibility

Due to compatibility, versions, and drivers of Windows/macOS/Linux, functionalities of third-party input tools may be affected while using the keyboard. Please make sure your operating system and drivers are up to date.

## First Time Setup

 The first time you turn on your Naya Create, you should connect your keyboard to a computer via USB (minimum USB 2.0).

 **As a beta tester your unit might have outdated firmware, please use Naya Flow to update it!**

## Spec Sheet

Internal Battery	Capacity	45mA
	Type	Lithium Ion
Physical Specifications	Dimensions	212 x 118 x 18mm
	Weight	1.4kg
Materials	Body / Dock / Wing	Aerospace Grade Aluminum
	Keycaps	Polycarbonate
	Hot-Swappable Switches	Kailh CPG-1232 (0.45x0.42mm pin variant)
LEDs	Backlighting	Reprogrammable RGB
Connectivity	Bluetooth Version	5.4
	Speedlink Connection	Using Bluetooth v5.4
	USB	2.0 or newer
Power	Input Voltage	4.2V

# Power

## Powering Create

Naya Create is designed to function while drawing power from either of two sources:

1. From a computer device connected via a USB 2.0 or higher port.
2. From a docked module that contains a sufficient amount of charge.

Each half of the keyboard does contains a small internal battery that will keep the keyboard powered ON while hot swapping a module but is not intended to power normal operation of the keyboard. (The keyboard's internal battery will be charged automatically while the keyboard is drawing power.)

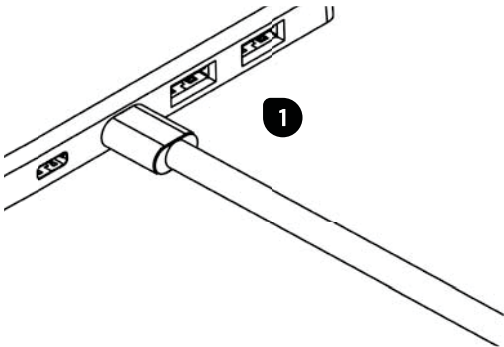

## Charging Modules

Docked modules will be charged (if necessary) when docked, if the keyboard is connected to a power source.





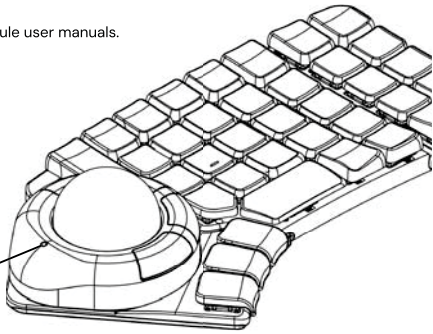

Docked modules can be charged with a Qi charger both when docked and when not.

While connected the LED indicators on each module will indicate the battery state and if the module is charging.

For more information see the dedicated module user manuals.



## Indicator LED

LED	Status
Blinking Red 	Battery low.
Solid Red 	There is a problem with the charging device.
Blinking Orange 	Battery charging.
Blinking Green 	Battery charging, close to full.
Solid Green 	Battery fully charged.
Blinking White 	Connecting to keyboard.
Solid White for 2 seconds 	Connected to keyboard and ready to be used.

## 2 Power ON

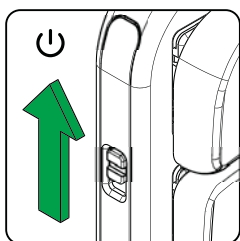

## 3 Power OFF

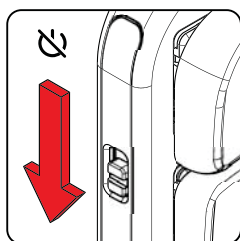

### Turning Create ON/OFF

1. Locate the power switch on the side of each keyboard wing. Each keyboard half has independent power control.
2. Power ON - To switch the keyboard ON slide the switch to the ON position.

When the keyboard is turned ON and has adequate power, the LEDs will light up to indicate it's been powered ON.

3. Power OFF - To switch the keyboard OFF slide the switch the OFF position.

### Sleep Mode

Sleep Mode is a power-saving feature designed to reduce energy consumption while also allowing your device to quickly resume full functionality. Sleep Mode helps extend battery life with minimal power use.

The keyboard will enter Sleep Mode when the device is idle for 1.5 minutes (configurable).

### Deep Sleep

Deep Sleep will disconnect bluetooth connections to preserve battery.

The keyboard will enter Deep Sleep when the device is idle for 10 minutes (configurable).

## Best Practices

⚡ When connecting or charging your keyboard via USB, please use the provided USB cable.

⚠ Do NOT connect Naya Create directly to a wall outlet. Charge your device by connecting the provided USB cable to a computer (USB 2.0 5V-1A).

🔌 Be sure to power OFF both halves of your Naya Create when not in use to preserve battery life.

What's in The Box?

Product Information

Power

Connectivity

Handling

Keybindings

Additional Information

# Output Modes

Create can be connected to multiple devices but will only output to a single device at a time. You can switch your active device by selecting the corresponding output mode.

## USB Output

1. Connect both short ends of the USB-C Y-Cable to the USB-C ports on Naya Create.
2. Connect the long end of the USB-C Y-Cable to a USB-C port on your computer.
3. Ensure your Create is powered ON.
4. Select USB output mode on the Naya Default Keymap by holding LAYER 2 (RA5) and pressing 'Z' (LC4) on your keyboard.

**Important Note:** The first time you turn on your Naya Create, you should connect your keyboard to a computer via USB (minimum USB 2.0).

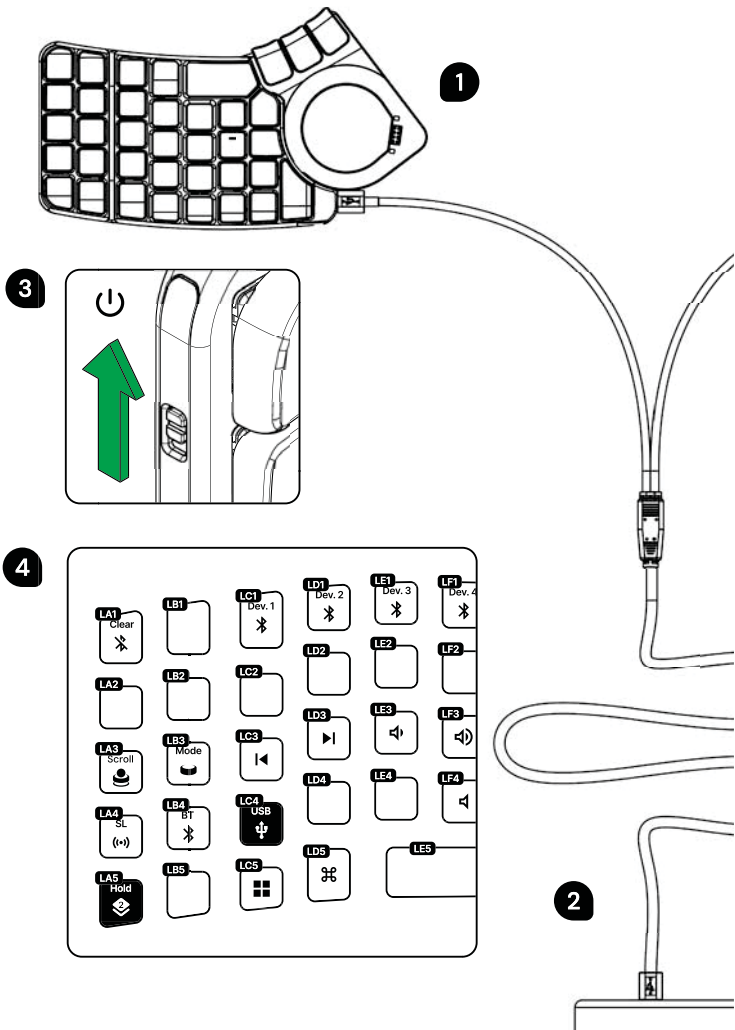

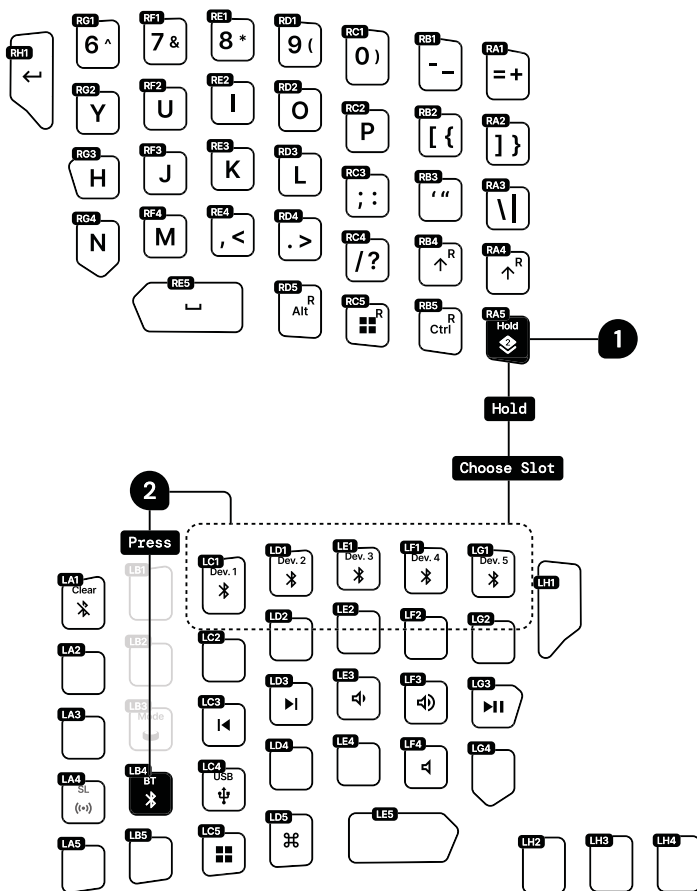

## Bluetooth Output

1. Select a device slot - Hold the Layer 2 Key and press one of the number keys 1-5 to select a device slot.
2. Enter Pairing Mode - Hold the Layer 2 Key and press the esc key to enter pairing mode. Naya Create should now be visible to your device and can be paired.
3. The slot selected will now always attempt to connect to the paired device, should the connection attempt fail Create will default back to the previous connection state.

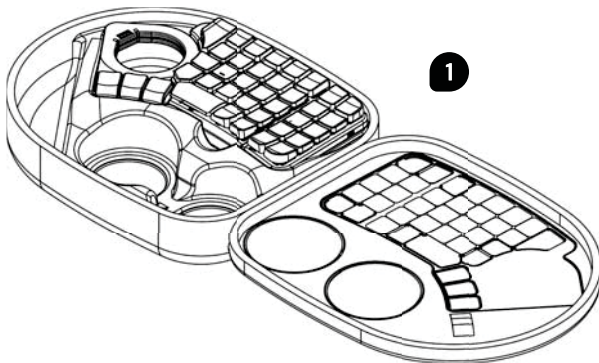

# Using Your Naya Create

## Handling

1. Open the Naya Travel Case on a flat surface. The two halves of Naya Create are magnetically attached to one another.
2. Gently remove both keyboard halves by grasping the keyboard by the metal body and lifting them out of the case. Do not grasp the keyboard by its keys when handling.
3. Separate the two halves by grasping the metal body of each half and pulling them apart.

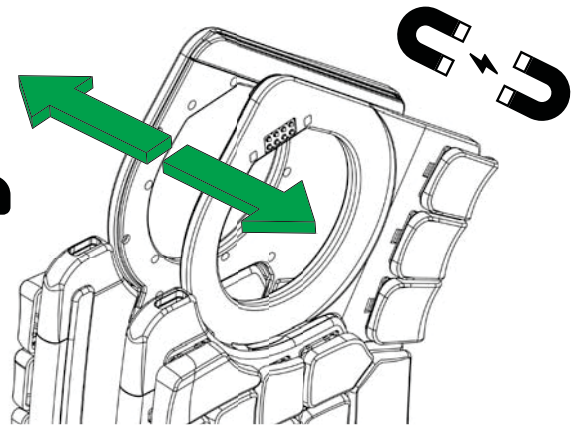
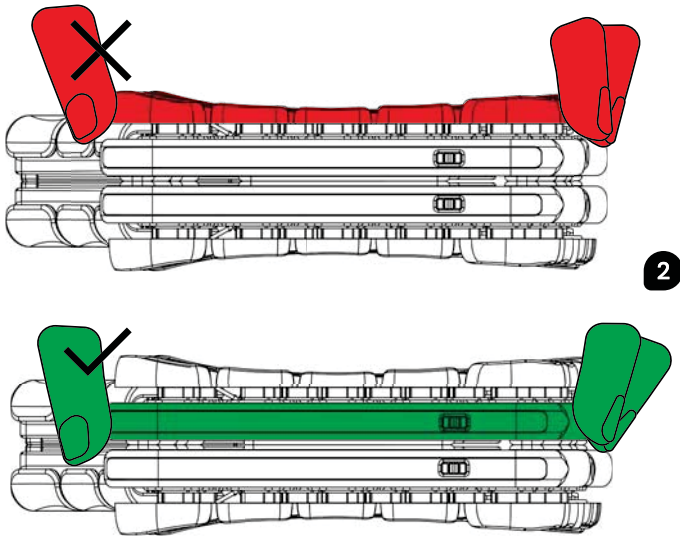



Handling

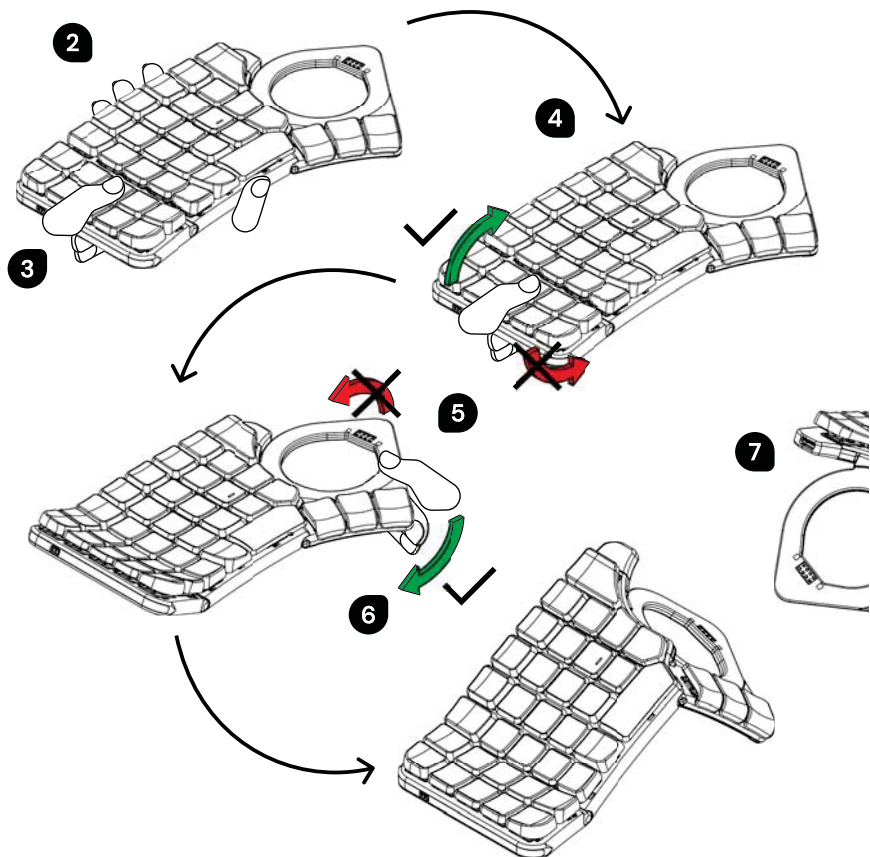
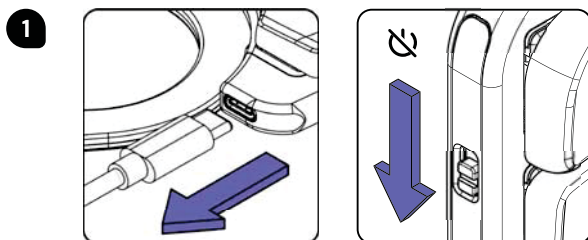

## Tenting

1. Turn off Create - Disconnect the USB-C cable and module and ensure that the power switches are in the OFF position.
2. Lift Create - With one hand, pick up the keyboard and firmly grasp the main body.
3. Grasp wing hinge - With the other hand place your thumb over the middle two wing keys and grasp firmly with your remaining fingers on the bottom.
4. Bend wing hinge - Apply steady pressure upwards (towards the keycaps) until the wing reaches the desired angle.
5. Grasp dock hinge - Grasp the dock by pressing your thumb onto the metal body (avoid pressing on connection pins), supporting the bottom of the dock with your remaining fingers.
6. Bend dock hinge - Apply downward force to the module dock, until it reaches the desired angle.
7. Repeat for both halves - Repeat this process for the other half of Create.



 Do not attempt to force the hinges of Naya Create beyond their normal range of motion!