







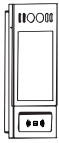
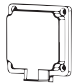

DH-G710S Series Quick Guide

1 | Preparation

PREPARATION

Prepare the following items before installation.

(1) Main device and accessories

DH-G710S  ×1	Back Cover  ×1	Hexagonal Wrench  ×1	Screw(M4×10)  ×1 Screw(ST4X20)  ×4	Screw(M3×6)  ×4 Drywall anchor  ×4	Screw(M4×30)  ×4 Rope  ×1
---	---	---	---	---	--

(2) For wall mounting



(3) For flush mounting

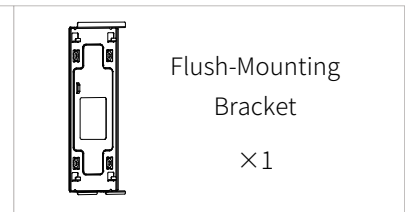
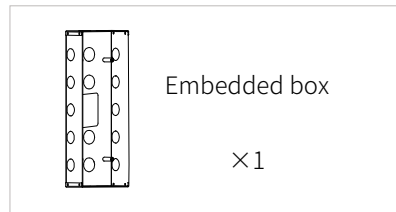

★ NOTE: Mounting accessories are packed separately.

2 | Product Overview

PRODUCT OVERVIEW

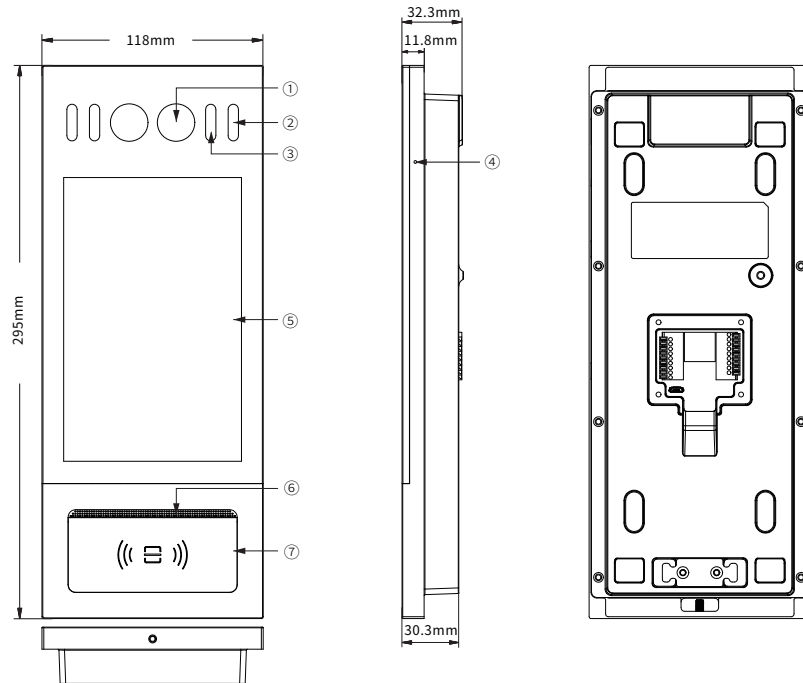

- | | | | |
|-----------------------|-------------------|----------------|-------|
| ① Camera | ② White Light LED | ③ Infrared LED | ④ Mic |
| ⑤ 7" Touch Screen LCD | ⑥ Speaker | ⑦ Card reader | |

DH-G710S Series Quick Guide

3 | Installation Environment

INSTALLATION ENVIRONMENT

The device can be installed in both indoor and outdoor environment.

Outdoor installation: Avoid to exposing the device to direct sunlight, which will cause damage to device and components due to high temperature.

Indoor installation: The device should be installed on somewhere 2 meters (6 feet) away from light or 3 meters (9 feet) away from window/door.

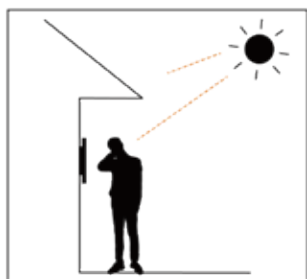

✗ Backlight

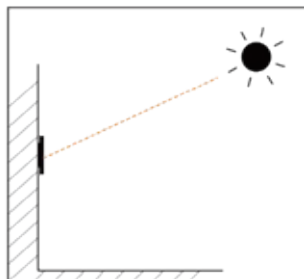

✗ Direct sunlight

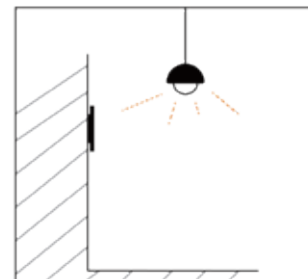

✗ Close to light

4 | Installation

4.1 Wall Mounting

STEP1

- ① Place the wall mounting box against the wall and around the cable outlet area, then mark the position of 4 drilling holes accordingly.
- ② Take the wall mounting box off, make sure the marked drilling holes are in right position around the cable outlet area (shown as diagram). Then drill holes with 6mm churn drill on each marked position.
Drive 4 drywall anchors into each drilling position.
- ④ Pull all cables and cords through the mounting box, then lock the box by four ST4×20 screws.

★ NOTE: You can refer to device user manual for more details.

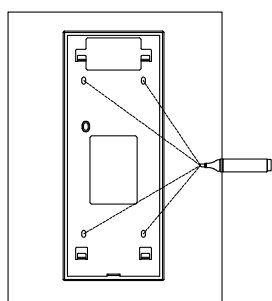

①

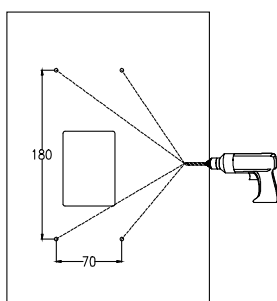

②

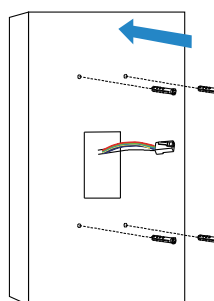

③

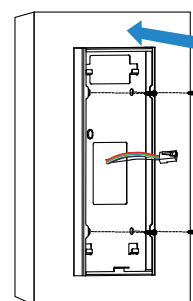

④

DH-G710S Series Quick Guide

STEP2

- ① Hang the device with wall mounting box by rope for device stabilization.
- ② Connect wires and cables into device correspondingly (you can refer to "Interfaces" for more details) . Once device are connected, lock the back cover by four M3×6 screws.
- ③ Take off the rope and attach the device into wall mounting box, press down to lock by hooks.
- ④ Use the Hexagonal Wrench to tighten the device with the M4×10 fixing screws that come with the device.
- ⑤ Installation is completed.

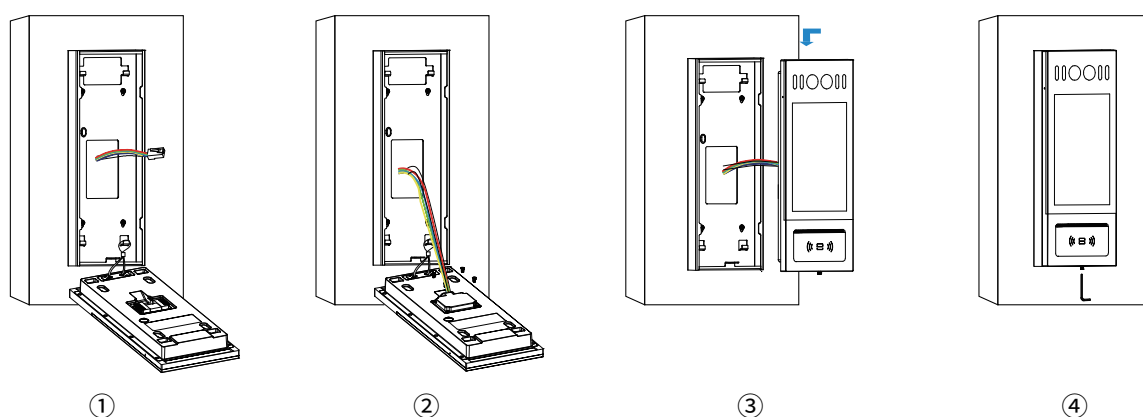

4.2 Flush mounting

STEP1

- ① Dig out a hole on wall. Hole dimension(mm): 290(H)×110(W)×55(D).
- ② Put the embedded box into the hole and mark the position of 4 drilling holes accordingly.
- ③ Take off the embedded box and drill holes with 6mm churn drill on each marked position.
- ④ Drive 4 drywall anchors into each drilling position.
- ⑤ Pull all cables and cords through the box, then lock the embedded box by four ST4×20 screws.
- ⑥ Fill the gap between wall and embedded box with cement or non-corrosive adhesive.
- ⑦ Pull all cables and wires through the flush-mounting bracket.
- ⑧ Put the flus-mounting bracket into embedded box, then lock the bracket by four M4×30 screws.

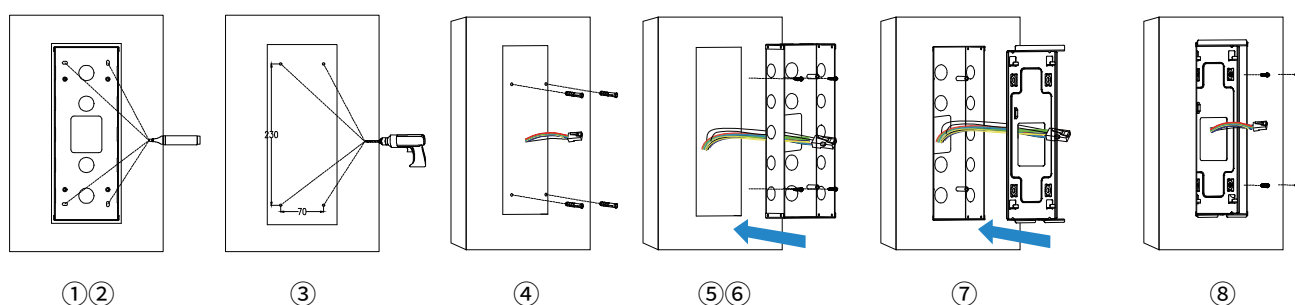

DH-G710S Series Quick Guide

STEP2

- ① Hang the device with flush mounting bracket by rope for device stabilization.
- ② Connect wires and cables into device correspondingly (you can refer to “Interfaces” for more details) . Once device are connected, lock the back cover by four M3×6 screws.
- ③ Take off the rope and attach the device into bracket, press down to lock by hooks.
- ④ Use the Hexagonal Wrench to tighten the device with the M4×10 fixing screws that come with the device.
- ⑤ Installation is completed.

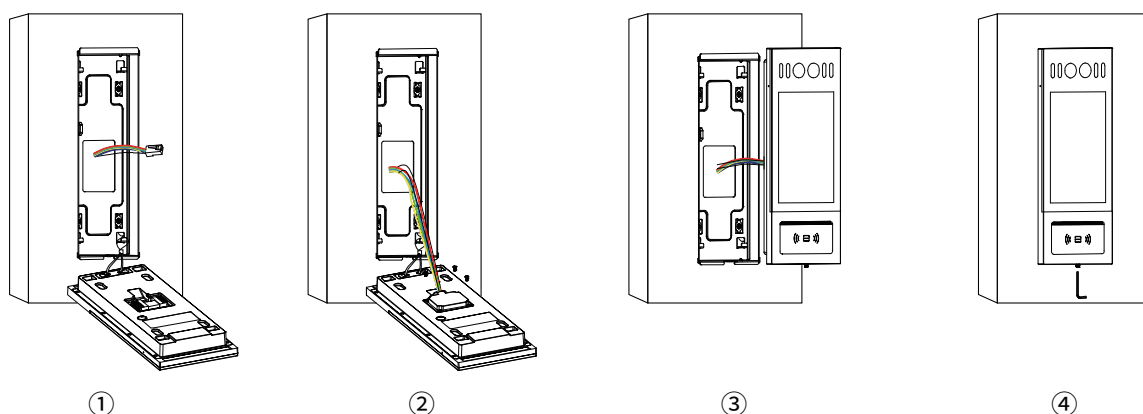

5 Interfaces

INTERFACES

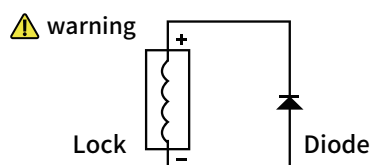
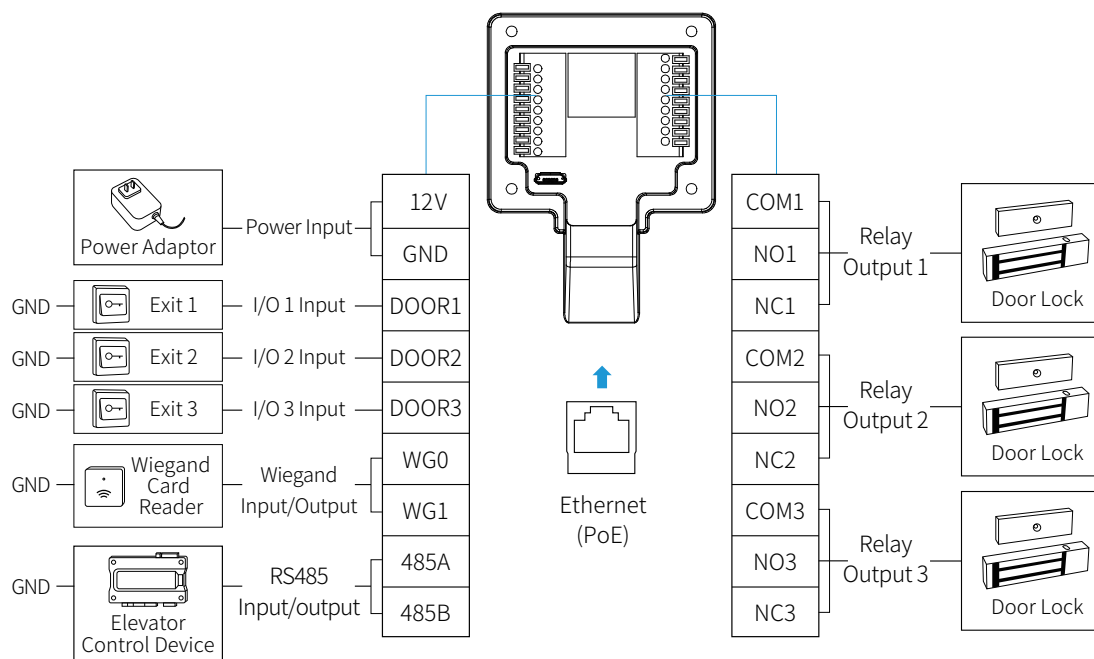

⚠ warning When the door unit is connected to a device with a coil, such as a relay or an electromagnetic lock, it is recommended that a diode 1 A / 500 V (included in the accessories) connected antiparallel to the device. It is used to protect the door unit against voltage peak while switching off the induction load.

DH-G710S Series Quick Guide



6 | Configurations

CONFIGURATIONS

● Initial Setup

The system Languages, Network Modes, Connection Modes, Time, Display Modes can be selected and configured when the initial booting of device.

● Check IP Address

The initial IP is 192.168.1.101, you can also enter 9999 in CALL menu then 3888 to get into the PROJECT SETTING, and tap STATUS to check the IP address.

● Set SIP Account

Log into Web configuration portal of device, set up SIP accounts in INTERCOM→ACCOUNT page.

● Set DTMF Code

Select DTMF mode and configure the code in DEVICE→INPUT-OUTPUT→RELAY page of Web configuration portal.

★ NOTE: You can refer to device user manual for more details.

7 | Functions

FUNCTIONS

● Make Calls

You can make calls from the device by select contacts or dial call number.

● Auto Answer

Incoming calls will be answered automatically by default.

● Face Unlock

Walk in front of camera, the device can recognize the face and unlock the door if the facial image is matched.

● PIN Unlock

Enter the access PIN set in device to unlock the door.

● Card/Key fob Unlock

Attach the saved access card or key fob on the card reader area of device to unlock the door.

DH-G710S Series Quick Guide

● DTMF Unlock

Press the configured DTMF code on keypad of device answering the call, the lock connected on DH-G710 will be unlocked remotely.

8 | **Fcc**

FCC

Note: This equipment has been tested and found to comply with the limits for a Class B digital device, pursuant to part 15 of the FCC Rules. These limits are designed to provide reasonable protection against harmful interference in a residential installation. This equipment generates, uses and can radiate radio frequency energy and, if not installed and used in accordance with the instructions, may cause harmful interference to radio communications. However, there is no guarantee that interference will not occur in a particular installation. If this equipment does cause harmful interference to radio or television reception, which can be determined by turning the equipment off and on, the user is encouraged to try to correct the interference by one or more of the following measures:

- Reorient or relocate the receiving antenna.
- Increase the separation between the equipment and receiver.
- Connect the equipment into an outlet on a circuit different from that to which the receiver is connected.
- Consult the dealer or an experienced radio/TV technician for help.

Any Changes expressly or modifications not approved by the party responsible for compliance could void the user's authority to operate the equipment.

This device complies with part 15 of the FCC Rules. Operation is subject to the following two conditions:

- (1) This device may not cause harmful interference, and
- (2) this device must accept any interference received, including interference that may cause undesired operation.

FCC Radiation Exposure Statement:

This equipment complies with FCC radiation exposure limits set forth for an uncontrolled environment. This transmitter must not be co-located or operating in conjunction with any other antenna or transmitter. This equipment should be installed and operated with minimum distance 20cm between the radiator & your body.



Notice Information

Information contained in this document is believed to be accurate and reliable at the time of printing. This document is subject to change without notice. The update version of this document can be viewed on NEXhome website: <http://www.nexhome.ai>

©Copyright 2022 NEXhome Ltd. All rights reserved.

NEXhome Smart Technologies Co., Ltd.

Add: 7th Floor, A Bldg Star-Net Plaza, No.33 Xingang Avenue, High-tech Zone, Fuzhou, Fujian, China
Web: www.nexhome.ai