

B13/ Wireless power bank

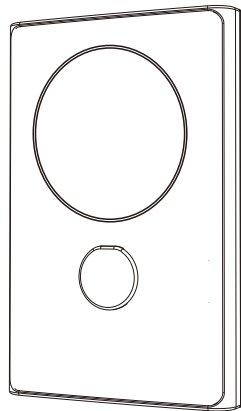

User Manual

Product parameters:

Model	B13
Battery capacity	10000mAh
Input and output	Type-C: 5V2.4A,9V2A,12V1.5A
Charging time	About 3.5hours
Net weight about	About 195 g
Total weight about	About 230 g
Product size	4.25* 2.75* 0.71inch (108*70*18.2mm)
Package size	6.06*3.38 *0.78inch (154*86 *19mm)

Points to note:

- 1.Must follow the instructions to use the device.
- 2.Do not disassemble, open, cut, or pierce the product with metal.
- 3.Please turn off the power and discontinue use immediately.If you notice sparks, smoke or odour during use.
- 4.Please do not expose the product to a heat source or flame,do not immerse it in water or fire, and avoid prolonged exposure to sunlight.

5.The working temperature of the device is 32-113°F and the relative humidity is 20-70%. Please keep it away from moisture,heat, water and fire.

6.The battery must be removed from the device before it is discarded. When removing the battery, the device must be powered down and the battery should be disposed of safely.

7.Please comply with local laws and regulations.

Usage method:

1. When the button is pressed, the 1-2-3-4 light hole blue light displays the power.
2. After the Type-C adapter is fully charged, the output will be turned off and the battery indicator will be turned off. Please use PD or QC series 18W or higher power fast charging adapters, low power adapters will extend charging time.
3. Support wireless charging while charging, and wireless charging while charging is preferred to maintain fast charging.
4. When using computer USB charging, the charging time will be increased by 2 times or more and the charging time will be longer. Please use PD or QC series Fast charging adapters with 18W or higher power for a better user experience.

[Output] time

1. When using wireless output: LED white bright, LED green flashing, blue long bright display current power.
2. When using Type-C cable to charge fast charge output: LED white bright, blue long bright display current power.
3. When the Type-C cable is used to charge the general charge output: The current battery is displayed in blue light.

[Input] time

1. When charging wireless fast: LED white light, LED green light flashing after detecting whether there is a wireless charging device, blue light flashing shows the current battery range.
2. When charging the wireless battery: the LED green light flashes after detecting whether there is a wireless charging device, and the blue light flashes the current battery range.

[Output/input] simultaneous

When the wireless charge is fast charged, and the wireless charge device is charged at the same time: the LED is white bright, the LED green light flashes, and the blue light flashes the current battery segment.

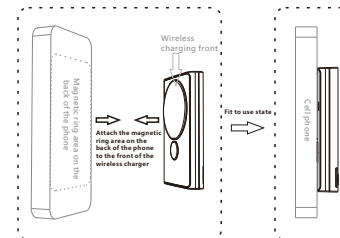

Warranty Ordinance:

From the date of purchase, the warranty period is 12 months. If it is due to issues with raw materials or defects and damages during the production process of the product, we guarantee a free replacement.

The warranty does not cover the following situations:

- 1.Unauthorized disassembly, modification, and other malfunctions.
- 2.Malfunctions arising from the use environment not meeting the product requirements.
- 3.Natural disasters (including earthquakes and floods).
- 4.Damage to the product casing caused during the use of the product.

- 5.Beyond the warranty period.
 - 6.Improper use methods.
 - 7.Damage caused by human factors (including hard scratches, etc.).
 - 8.The warranty card does not match the product model or the product model has been altered.
- For all cases that exceed the scope of free warranty, paid repair services can be provided. The company reserves the final interpretation right of the content of this warranty.

Guarantee Card:

Product Model:	
User Name:	
Contact Telephone:	
Address:	
Date of Purchase:	



THEMIS AR support ltd
85 Great Portland St. London, United Kingdom W1W 7LT
Christopher Jones
+44-02037332302 legal@themisar.com



THEMIS AR Unterstützung UG
Beedstrasse 54, In Dusseldorf, (40468), Deutschland
+49-21173714852
Technical service Christopher Jones
legal@themisar.com https://themisar.com/



Guangdong Aoyun Technology Co., Ltd. E-mail: gdaoyun@outlook.com
Building 45, Huizhou Zhongkai Zhongji Zhiguan Industrial Park, Shanpi Village, Lili Town, Zhongkai High Tech Zone, Huizhou City, Guangdong Province, P.R. China

MADE IN CHINA

FCC Warning

This device complies with part 15 of the FCC Rules. Operation is subject to the following two conditions:

- (1) This device may not cause harmful interference, and
- (2) this device must accept any interference received, including interference that may cause undesired operation.

Any Changes or modifications not expressly approved by the party responsible for compliance could void the user's authority to operate the equipment.

Note: This equipment has been tested and found to comply with the limits for a Class B digital device, pursuant to part 15 of the FCC Rules. These limits are designed to provide reasonable protection against harmful interference in a typical installation. This equipment generates uses and can radiate radiofrequency energy and, if not installed and used in accordance with the instructions, may cause harmful interference to radio communications. However, there is no guarantee that interference will not occur in a particular installation. If this equipment does cause harmful interference to radio or television reception, which can be determined by turning the equipment off and on, the user is encouraged to try to correct the interference by one or more of the following measures:

- Reorient or relocate the receiving antenna.
- Increase the separation between the equipment and receiver.
- Connect the equipment into an outlet on a circuit different from that to which the receiver is connected.
- Consult the dealer or an experienced radio/TV technician for help.

The FCC certification of this device refers to RF exposure testing performed in typical operating conditions, where a person is closer than 0 cm from the device surface at all times, except for non-repetitive patterns with transient time intervals in the order of a second. Only in the stated conditions, the device is shown to fully comply with the FCC RF Exposure requirements of KDB 447498.