

Ceiling Fans with Lights

User Manual for Fan Lamp Control

Size:

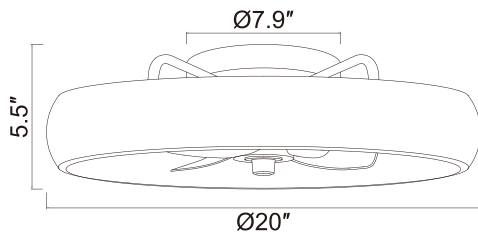

Ceiling Fan Light Specifications

Wattage	36W	Light Source Type	LED
Rated Voltage	120V	Color Temperature	2700K-7000K
Lumens	2000 Lumen	Material	Metal, Injection Molding
Control Method	Remote/APP/Wall	Working Temperature	-20°-85°/-4°-185°F
Switching Method	① Remote Control ② APP ③ Wall	Maximum Speed	1050
Lamp Type	Ceiling Mount	Minimum Speed	550
Wind Speed	1-6 Levels	Timer	1 hour / 2 hours
Remote Control Distance	8-20m/26,25-65,6ft	Remote Control Battery	AA 1.5V X2 (Included)

REMOTE CONTROLLER SETTING

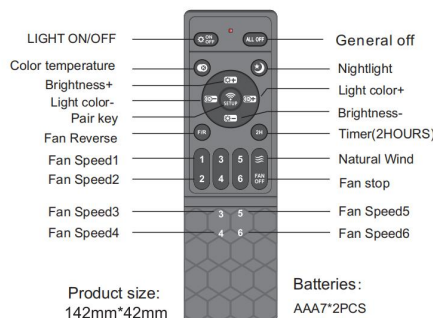

*Normally the remote is Preset, there's no do Pairing Process

*In case of remote's code lost, Please follow the steps below to re-match the code:

Switch on the Power, within 5 seconds, press the pairing button for about 2 seconds, then you will hear a "beep" sound, and the light flicks, which indicate the pairing success.

NOTE: If the product upgrades, the upgraded function shall Prevail.

CELLPHONE APP SETTING



Please download the Cellphone APP by scanning the QR code above.

APP Pairing:

Switch on the power, within 5 seconds, press the pairing button, then you will hear a "beep" sound, and the light flicks, which indicate the Pairing success.



pairing Button

NOTE: If the APP upgrades, please refer to the new version, and the function page might be different as well.

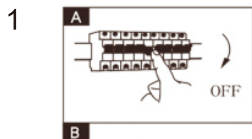

Please confirm that the voltage matches the product, and turn off the power at the installation location to ensure safety.

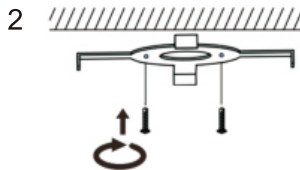

Securely attach the mounting plate to the ceiling.

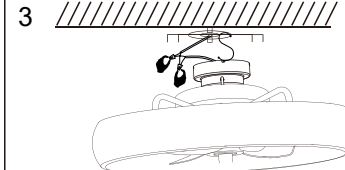

With the help of the S-hook, securely and correctly connect the lamp driver's input to the power source.

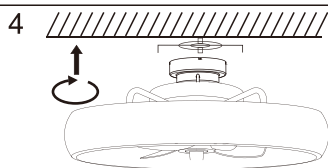

Rotate the lamp body to align the screws on the mounting plate with the holes on the leftmost hub.

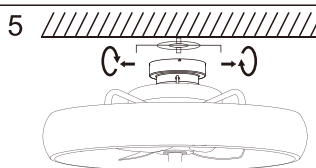

Tighten the four screws on the mounting plate to ensure the fixture is securely installed.

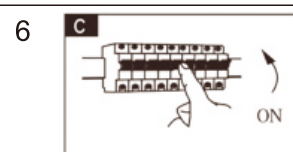

Turn on the power switch.

Precautions:

- Do not disassemble or modify the product on your own to avoid electric shock.
- Do not use this product in high-temperature, high-humidity, or outdoor environments.
- Clean the light fixture with a dry, soft cloth, and avoid using corrosive cleansers.
- Avoid using multiple appliances on the same outlet simultaneously to prevent short circuits or fires.
- During cleaning and maintenance, adhere to the operating instructions and cautions to prevent the risk of electric shock.
- Pay attention to the status of the ceiling fan light. If a malfunction occurs, stop using it immediately and contact the manufacturer's designated service center for repairs. Do not replace parts or disassemble for maintenance on your own. Ensure regular maintenance for safe use.

Safety Handling:

In the following situations, please immediately turn off the power and cease usage:

- When the main lamp tube is damp or comes into contact with liquid/rainwater.
- If there is smoke, sparks, or any anomalies within the main light body.
- If the LED light source is abnormally flickering or damaged.

Package Contents:

Preparation: Before starting the installation, please check and inspect all components. If any parts are missing or damaged, please contact Torondo customer service team.

Ceiling Fans with Lights	1
User Manual	1
Remote Control	1
S-shaped auxiliary hook	1

After-sales Service Guarantee

A 36-Month warranty is provided for the product from the date of purchase. If you have any question, please sign in to Amazon and contact us, or Email us via sales@mujicatech.com

Warning:

This appliance is not intended to be used by users (including children) with insufficient physiology, awareness, mental ability, experience or knowledge, unless it is safely used under the supervision or guidance of those responsible for the safety of women and children, electrical appliances.

This appliance should be installed with fan lights according to the instructions, and adhesive is not allowed.

When installing electrical appliances, the fan blades should be more than 2.3m above the ground (for electric fans installed at high places).

Made in China

FCC Warning:

This equipment has been tested and found to comply with the limits for a Class B digital device, pursuant to part 15 of the FCC Rules. These limits are designed to provide reasonable protection against harmful interference in a residential installation. This equipment generates, uses and can radiate radio frequency energy and, if not installed and used in accordance with the instructions, may cause harmful interference to radio communications. However, there is no guarantee that interference will not occur in a particular installation. If this equipment does cause harmful interference to radio or television reception, which can be determined by turning the equipment off and on, the user is encouraged to try to correct the interference by one or more of the following measures:

- Reorient or relocate the receiving antenna.
- Increase the separation between the equipment and receiver.
- Connect the equipment into an outlet on a circuit different from that to which the receiver is connected.
- Consult the dealer or an experienced radio/TV technician for help.

Caution: Any changes or modifications to this device not explicitly approved by manufacturer could void your authority to operate this equipment.

This device complies with part 15 of the FCC Rules. Operation is subject to the following two conditions:

(1) This device may not cause harmful interference, and (2) this device must accept any interference received, including interference that may cause undesired operation.

This equipment complies with FCC radiation exposure limits set forth for an uncontrolled environment. This equipment should be installed and operated with minimum distance 0cm between the radiator and your body.