

F81 Split-type Induction Doorbell

User Manual

Product Introduction

This split-type welcome device adopts advanced wireless transmission technology, full-voice button prompts, a powerful r control system, energy-saving design, high-capacity and high-quality voice processing technology, and integrates up to 50 songs. It is stable and reliable in performance. The receiver and transmitter are wirelessly learned and coded. It can be used as a doorbell, anti-theft device, and night light for welcoming guests. It can be equipped with a rechargeable lithium battery for use, which is convenient for users and eliminates the need to frequently purchase batteries. It is suitable for large villas, office buildings, high-end clubs, leisure centers, hotels, homes, shops, factories, conference rooms, etc.

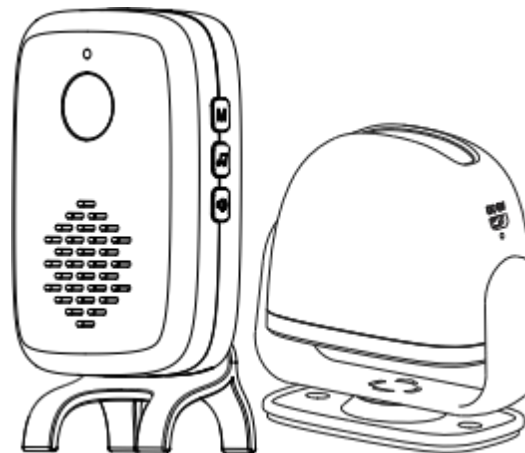

1.Appearance structure

1.1Receiver

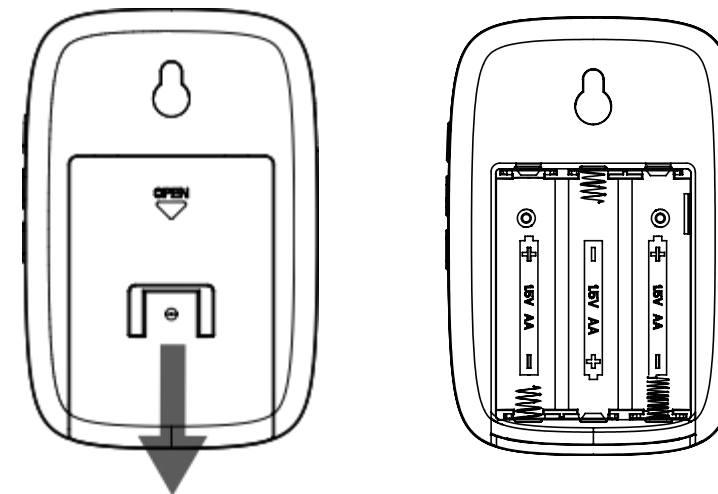
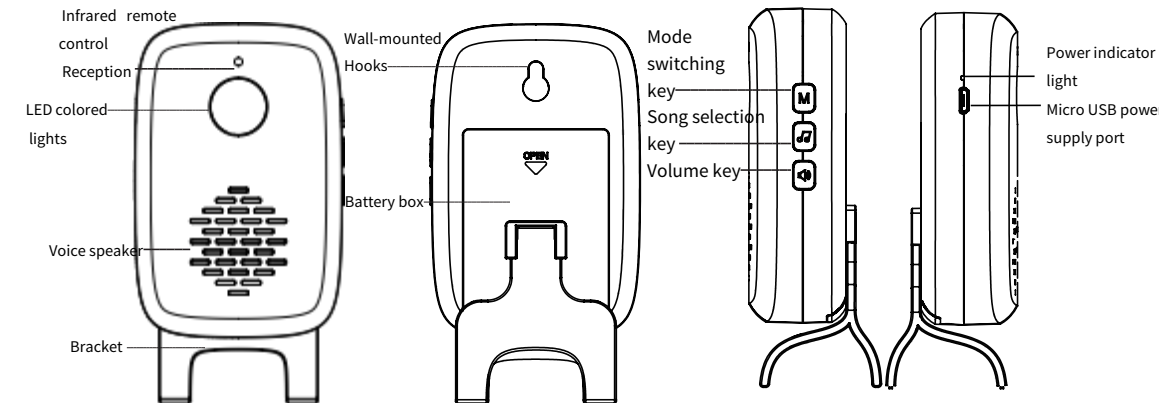

As shown in the picture, the battery cover of the receiver is pushed open from top to bottom
Install three AA batteries. Please pay attention to the polarity direction of the batteries

1.2Infrared sensor

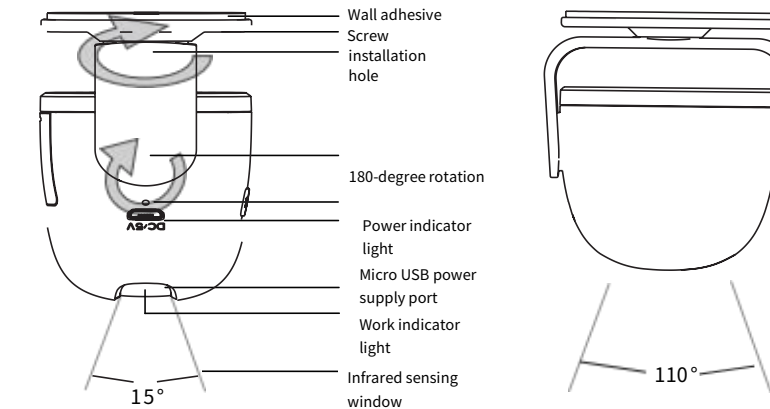

Sensing Angle: Vertical direction: 110 ° ,
horizontal direction: 15°
Sensing distance: 0-8 meters (related to the suitable ambient temperature)

2.Functions and User Instructions

2.1Power on/off (voice announcement)

Press the 【M】 key for 3 seconds in the startup state, and the main unit will shut down immediately. Press the 【M】 key for 3 seconds in the off state, and the main unit will turn on immediately.

2.2 Volume adjustment: After turning on the device, press the [🔊] key to adjust the volume. There are 4 levels of volume adjustment available. Voice broadcast: Mute/Volume 1 / Volume 2 / Volume 3 / Volume 4

2.3 Song selection: After turning on the device, press the [🎵] key to select the music. The music will be selected in a loop.

2.4 When this machine leaves the factory, the receiver and the infrared sensor have been defaulted to learn and pair.If necessary, please relearn the detector or lock the detector in the following way.

2.4.1 Learning Detector: After turning on the machine, press the [🎵] key and the [🔊] key simultaneously. The LED light will be illuminated, indicating that the learning detector has been entered. (Voice announcement) Learning detector, at this time.Please trigger the detector to send out a signal. After the receiver receives the signal, the LED will flash once (with voice announcement). Learning is successful,

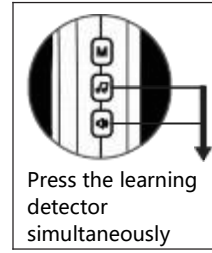

indicating that the learning is correct. If you want to continue learning, please trigger other detectors. Press any key or if no transmission signal is received for 30 consecutive seconds, the learning state will automatically exit.

2.4.2Lock detector First, select the voice to be broadcast, then press the [M] key and the [🎵] key simultaneously. The LED light will be illuminated, indicating that the detector has entered the locked state. (Voice broadcast) Learn the detector. At this time, please trigger the detector to send a signal. After the receiver receives the signal, the LED will flash once. (Voice broadcast) The lock is successful, indicating that the learning is correct. Press any key or do not receive the transmission signal for 30 consecutive seconds to automatically exit the learning state.

If you need to lock multiple detectors to correspond to different voices, please exit and repeat the above operation.

2.5 Learning accessories (infrared curtains, door magnets, call buttons, etc.) If accessories such as infrared curtains, door magnets, and call buttons are added, learning matching can be carried out.
*Note: Up to 10 accessories can be learned

3.Batteries and power supplies

3.1 The infrared sensor is installed with three No. 7 (AAA) alkaline batteries
The receiver is equipped with three AA alkaline batteries.

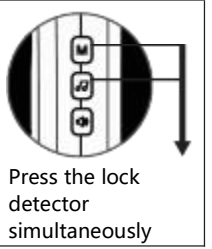

Please pay attention to the positive and negative terminals of the batteries.

3.2 The receiver lights up the colored lights for the first time when powered on.

Default: Welcome mode - Hello, welcome;
The infrared sensor power-on indicator light flashes three times, indicating that the battery is installed correctly.

3.3 It is recommended to use alkaline batteries. Using other batteries will shorten the standby time and change the sound
Whisper; It can also be powered by the Micro USB power supply. The green light will be on during charging. When it is fully charged or the battery power is sufficient and the light does not come on, the charging will be automatically disconnected.

4.Installation location

4.1 Infrared sensors are recommended to be installed on the top ceiling or side of the customer's entrance and exit. If used for anti-theft purposes, please install it in the passageway where thieves are likely to break in. It is recommended to install with screws. Double-sided tape installation is suitable for smooth and flat surfaces; otherwise, it is prone to falling off.
* This machine passively detects the change in infrared signals released when the body temperature is around 37 degrees.
* This machine is for indoor use only. Please do not install it in a place exposed to direct sunlight or rain.
To reduce false alarms, it should be installed away from air conditioning outlets, fans, air outlets and other places with large temperature variations and significant interference.

4.2 It is recommended that the receiver be placed on the desktop with a stand for convenient and flexible movement. It can also be installed by hanging it on the wall with screws.

4.3 After installation, press the power button on the receiver to enter the welcome mode, test the wireless transmission distance, adjust the detection Angle of the red outer curtain, and repeatedly test to ensure that it can sense when entering from different positions of the door and trigger the receiver to play sound.

5.factory data reset

When the device is turned on, press the [M] key and the [🔊] key simultaneously for 5 seconds to announce (factory Settings have been restored).
* Delete all accessories
* Default: Welcome Mode -Hello Welcome
* The volume is the largest.

This machine has five reminder modes. For instructions and operations, please refer to the table below

	Welcome mode (default)	Reminder mode	Doorbell mode	Alarm mode	Night light mode
Play when the sensor is triggered	The selected welcoming object	Selected music piece	Selected music piece	The alarm sound lasts for 30 seconds	Silent Keep the light on for 2 minutes
LED lighting	The colorful lights are flashing	The colorful lights are flashing	The colorful lights are flashing	Red light	White lamp
[🎵]key	Cyclic selection fourteen Welcome the object	Cyclic selection Sixteen reminder messages	Cyclic selection Twenty door bell sounds	Alarm sound	no
[🔊]key	Mute/Volume Level 1 / Volume Level 2 / Volume Level 3 / Volume Level 4				no

To turn off the LED light: Press and hold the [🎵] key for 10 seconds to turn off the LED light. To turn it on again, press and hold the [🎵] key for 10 seconds
The LED flashes three times to indicate that the light is on.

FCC Warning:

This equipment has been tested and found to comply with the limits for a Class B digital device, pursuant to part 15 of the FCC Rules. These limits are designed to provide reasonable protection against harmful interference in a residential installation. This equipment generates, uses and can radiate radio frequency energy and, if not installed and used in accordance with the instructions, may cause harmful interference to radio communications. However, there is no guarantee that interference will not occur in a particular installation. If this equipment does cause harmful interference to radio or television reception, which can be determined by turning the equipment off and on, the user is encouraged to try to correct the interference by one or more of the following measures:

- Reorient or relocate the receiving antenna.
- Increase the separation between the equipment and receiver.
- Connect the equipment into an outlet on a circuit different from that to which the receiver is connected.
- Consult the dealer or an experienced radio/TV technician for help.

Caution: Any changes or modifications to this device not explicitly approved by manufacturer could void your authority to operate this equipment.

This device complies with part 15 of the FCC Rules. Operation is subject to the following two conditions:

(1) This device may not cause harmful interference, and (2) this device must accept any interference received, including interference that may cause undesired operation.

This equipment complies with FCC radiation exposure limits set forth for an uncontrolled environment. This equipment should be installed and operated with minimum distance 0cm between the radiator and your body.