

MamaPro

Baby Camera



User Manual

CONTENTS

Safety instructions	01
Caution	02
What's in the box	03
Product overview	04
Product specifications	05
How to use	05
Quick Start Guide	09

SAFETY INSTRUCTIONS

- Strangulation Hazard—Children have STRANGLED in cords. Keep this cord out of the reach of children (more than 3 ft (0.9 m) away).

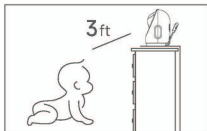

- NEVER place the camera or cord in or near the crib or playpen.
- NEVER mount the camera directly above the crib or playpen to avoid the risk of injury.
- Only use the AC adapters provided.
- Never use the unit near water, including near a bathtub, sink, laundry machine tube, wet basement, etc.
- Do not install near the product heat sources such as radiators, heat registers, stoves, or other devices that produce heat.
- Only use attachments and accessories specified by the manufacturer.
- Unplug this device when unused for long periods of time.

CAUTION

- NOT toys. Do not allow children to play with them.
- This product is NOT intended to replace adult supervision. You **MUST** check your child's activity regularly.
- This product is not intended for use as a medical camera and its use should not replace adult supervision.
- Unplug the product during lightning storms.
- Please check the operating range and condition of the camera carefully at the initial installation, and on a regular basis after that.
- Check the reception regularly. Test the camera before use and after changing the camera's location.
- For indoor use only.
- Clean the camera with a dry cloth only.
- Do not block any ventilation openings.

WHAT'S IN THE BOX



Camera



User Manual



FAQ



Power Adapter



Charging Cable



Wall Mount Screw Sets



Ejector Pin



Drilling Template

PRODUCT OVERVIEW

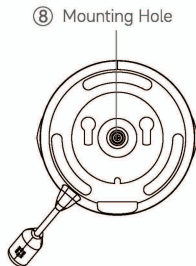
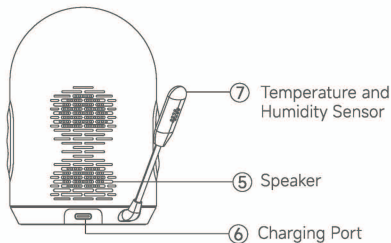
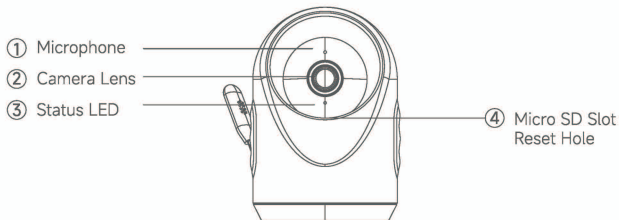

PRODUCT SPECIFICATIONS

Product Name	Baby Camera
Model Number	VM03
Input Voltage	DC 5V/1A
Power Adapter Input Voltage	110-240VAC, 50/60Hz
Storage Temperature	-20°C to 60°C/-4°F to 140°F
Operation Temperature	0°C to 40°C/32°F to 104°F

HOW TO USE

① Get the APP and account

Download and install the MamaPro app from the App Store(ios devices) or Google Play(Android devices), and sign up for an account.



HOW TO USE

② Power On the Baby Camera

Connect the Baby Camera to the power adapter (5V/1A), then plug the adapter into a power outlet.

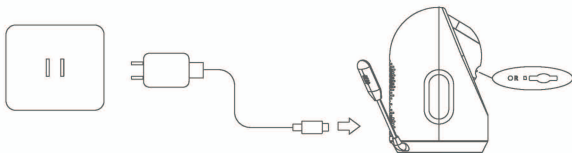

NOTE: 1) Only use the power adapters included in the package.

2) Do not place the camera and power cord within the reach of your baby.

HOW TO USE

③ Set up your camera

Follow the app instructions and tap "Get Started" or the "+" in the top right corner to add a device.

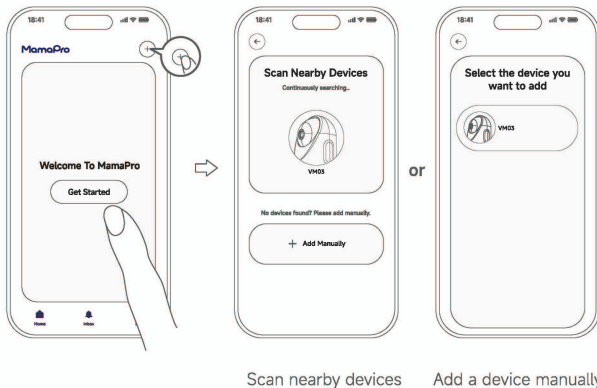

HOW TO USE

Remember: The baby camera transmits video and audio over a securely encrypted 2.4GHz/5GHz Wi-Fi connection. Connect it only to a private network that requires a secure password.

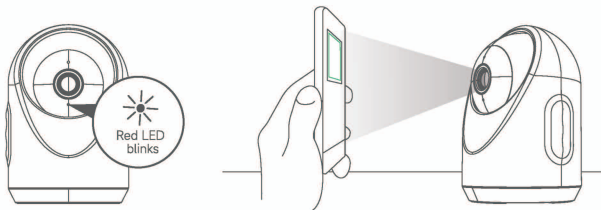

NO.	Status LED	Description
1	Solid Red	Powered On
2	Flashing Red	Waiting to Connect
3	Flashing Blue	Connecting
4	Solid Blue	Connected successfully

HOW TO USE

④ Place or mount your camera

The camera can be placed on a table or shelf, or can be installed on a wall or crib. Select a location and height that achieves your desired view and is within reach of a power outlet. Use the monitor to test the viewing angle from your desired mounting spot.

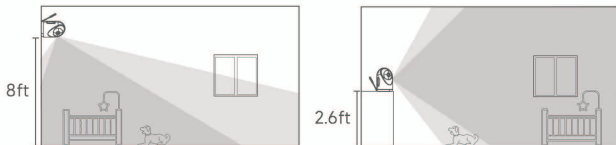

All trademarks are used for reference purposes only.

Thanks again for choosing our Baby Monitor!

Makelife safe in your hands!

Boost security mobility in your smartphone!



QUICK START GUIDE

Scan the QR code below to watch a video tutorial on adding a device.



FCC COMPLIANCE

This device complies with part 15 of the FCC Rules. Operation is subject to the following two conditions:

- (1) this device may not cause harmful interference, and
- (2) this device must accept any interference received, including interference that may cause undesired operation.

Any changes or modifications not expressly approved by the party responsible for compliance could void the user's authority to operate the equipment.

NOTE:

This equipment has been tested and found to comply with the limits for a Class B digital device, pursuant to part 15 of the FCC Rules. These limits are designed to provide reasonable protection against harmful interference in a residential installation. This equipment generates, uses, and can radiate radio frequency energy and, if not installed and used in accordance with the instructions, may cause harmful interference to radio communications. However, there is no guarantee that interference will not occur in a particular installation.

If this equipment does cause harmful interference to radio or television reception, which can be determined by turning the equipment off and on, the user is encouraged to try to correct the interference by one or more of the following measures:

- Reorient or relocate the receiving antenna.
- Increase the separation between the equipment and receiver.
- Connect the equipment to an outlet on a circuit different from that to which the receiver is connected.
- Consult the dealer or an experienced radio/TV technician for help.

Exposure to radio frequency energy. The radiated output power of this device meets the limits of FCC/IC radio frequency exposure limits. This device should be operated with a minimum separation distance of 20 cm (8 inches) between the equipment and a person's body.

MANUFACTURER: Shenzhen Yingfusi Technology Co., Ltd.

COMPANY ADD: 19th floor, VanleadGroup Building, Nanshan District, Shenzhen, China.

US IMPORTER:

COMPANY: Interfocus Inc

ADDRESS: 650 Castro Street Ste. 120-458, Mountain View, CA 94041, United States

SERVICE CALL: +1(888)379-3991

EMAIL: service@mamapro.com
