

Linkable Outdoor Wall Light

User Manual

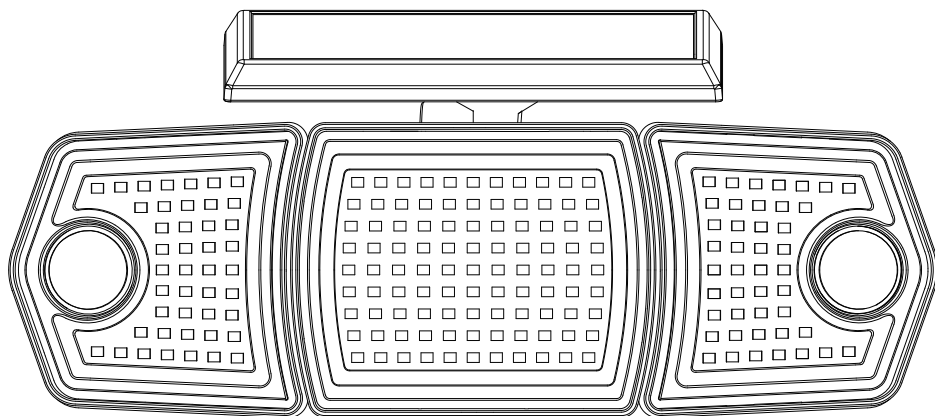

1. It is recommended to turn off the light and charge it under direct sunlight for 1-2 days before the first use. Make sure the product has enough power.
2. Be sure to keep the solar panels in an environment with sufficient sunlight and the solar panel surface clean to catch the sunlight.

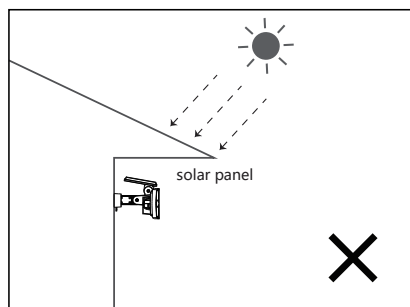
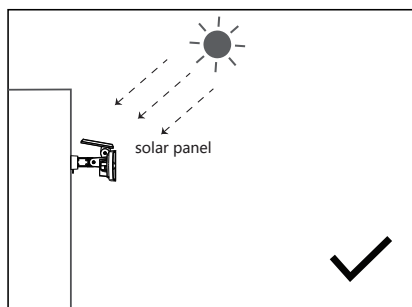

Incl.

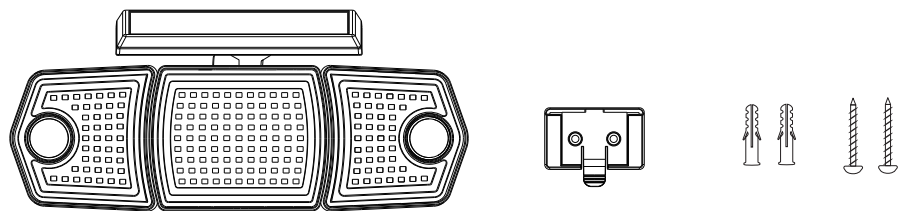

Excl.

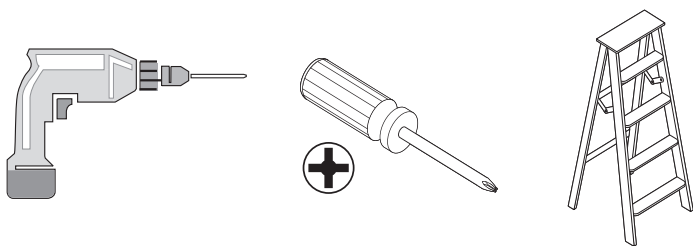

! MODE

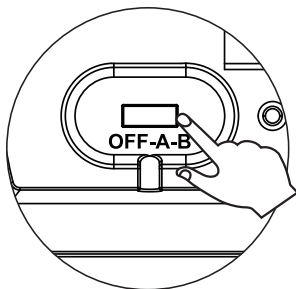

OFF:Power OFF.

A:Linkage of channel A.Ligth will stay dim at dusk for 6h timer, and light up when motion detected.

B:Linkage of channel B.Ligth will stay dim at dusk for 6h timer, and light up when motion detected.

1 Fix the bracket.

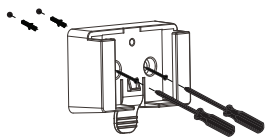

2 Mount & Remove.

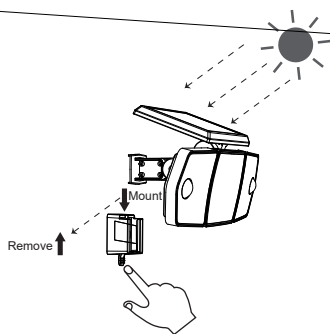

FCC Statement

to part 15 of the FCC Rules. These limits are designed to provide reasonable protection against harmful interference in a residential installation. This equipment generates.

interference to radio communications. However, there is no guarantee that interference will not occur a particular installation. If this equipment does cause harmful interference to radio or television

to correct the interference by one or more of the following measures:

- Reorient or relocate the receiving antenna.
- Increase the separation between the equipment and receiver.
- Connect the equipment into an outlet on a circuit different from that to which the receiver is connected.
- Consult the dealer or an experienced radio/TV technician for help.

could void the user's authority to operate the equipment.

This device complies with part 15 of the FCC Rules. Operation is subject to the following two conditions:

- (1) This device may not cause harmful interference, and (2) this device must accept any interference received, including interference that may cause undesired operation.

Radiation Exposure Statement:

This equipment complies with FCC/IC radiation exposure limits set forth for an uncontrolled environment.

This equipment should be installed and operated with minimum distance 0.5cm between the radiator & your body.