

Reference image
please refer to the actual product

Product Name : Fingerprint Password Lock
Model No: WLM13F-SNL

Installation Overview

Read this manual carefully before installing and operating!

1 Install the physical lock
(Step 1-7)

2 Detect door orientation
(Step 8-9)

Contents

Latch A	Strike B	Exterior Assembly C	Mounting Plate D	Interior Assembly E
Battery Cover F	Interior Assembly Screws G x 2	Latch & Strike Screws H x 4	Mounting Plate Screws I x 2	Backup Key K x 2
J x 1				

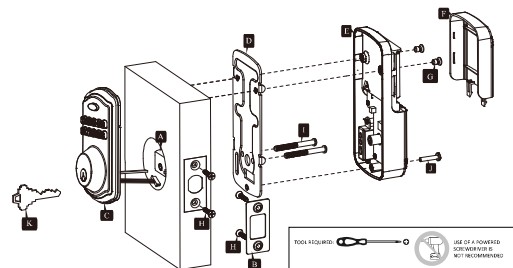

Installation

STEP

1

Prepare the door and check dimensions

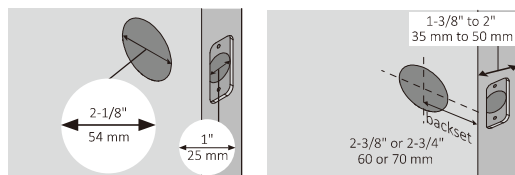

STEP

2

Determine backset and adjust the latch

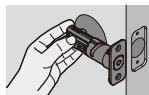

Hold the latch in front of the door hole, with the latch face flush against the door edge.
Is the slotted hole centered?

YES

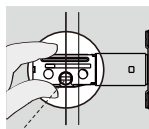

Slotted hole is centered.

No adjustment is required.
Proceed to next step.

NO

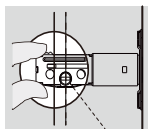

Slotted hole is NOT centered.

Rotate and pull the latch as shown to extend latch.

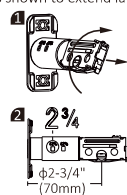

STEP

3

Install the latch

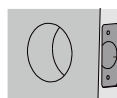

chiseled

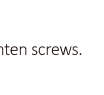
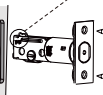
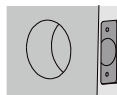
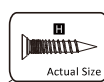

Do not overtighten screws.

STEP

4

Install strike and test alignment

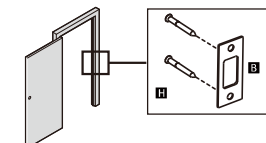

IMPORTANT: Make sure the hole in the door frame is drilled at a minimum of 1" (25 mm) deep.

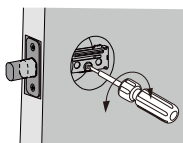

1. With the door closed, use a flat-head screwdriver to test if deadbolt works smoothly.

2. Check alignment between the latch and the strike, making sure when the deadbolt is extended, it is going into the bolt hole and not hitting the deadbolt strike or door frame.

STEP

5

Install exterior assembly

IMPORTANT: Do not insert the physical key until lock is completely installed.

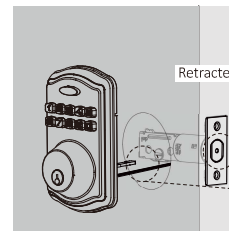

1. Before installation, make sure the latch is fully retracted (in the unlocked position).
2. Route the cable **below** the latch.

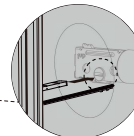

STEP

5

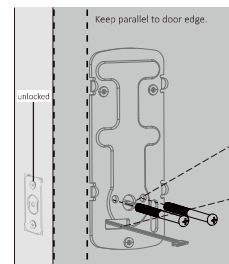

Secure the mounting plate with the screws I.
Do not overtighten screws.

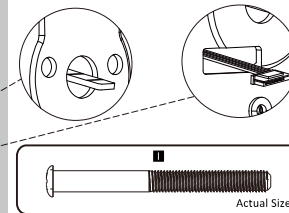

STEP

6

Remove battery cover

IMPORTANT: Do not load batteries until lock is completely installed.

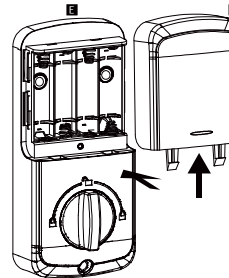

Press the battery cover and pull the cover up.

STEP

7

Install interior assembly

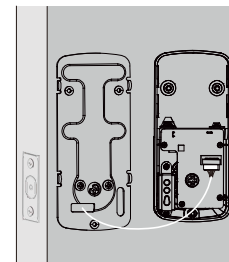

STEP

7

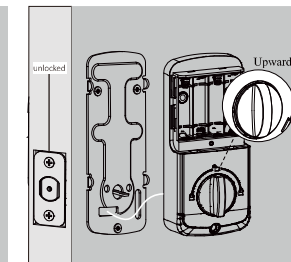

STEP

7

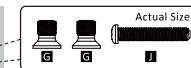
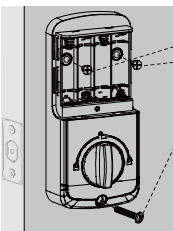

Attach Interior Assembly to Mounting Plate and tighten 3 screws.



IMPORTANT: Test the thumbturn for smooth rotation. If thumbturn doesn't rotate, repeat step 7B, making sure the thumbturn is in vertical position.

STEP

8

Handling of Door

IMPORTANT: Always run this step after installation.
The motor will not operate before completing the step.

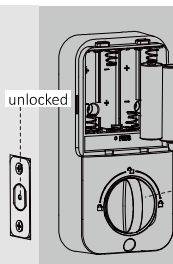

Perform a **factory reset** to detect the door orientation.

While the door is **OPENED** and **UNLOCKED** (latch retracted), load **3 AA** batteries into the battery compartment.

NOTE:
For best results, use new, non-rechargeable Alkaline batteries only. Do not mix old and new batteries.

STEP

8

IMPORTANT: If the latch doesn't extend within 10 seconds after doing this step 8B, please repeat step 7B and 8A to make sure the thumbturn is always **vertical** and latch is always **retracted**.

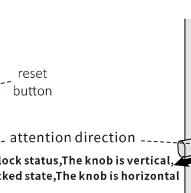
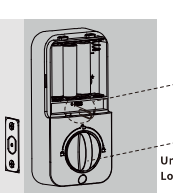

reset button

attention direction
Unlock status, The knob is vertical.
Locked state, The knob is horizontal

Hold the reset button while loading the 4th battery.

Do not release the reset button

keep holding the reset button, until the latch bolt extend.

STEP

9

Test the lock

Test with the door open to avoid an accidental lockout.



Lock
Press and hold lockbutton for 2 seconds.

Unlock
Enter default password 123456 → on keypad to unlock the door.

