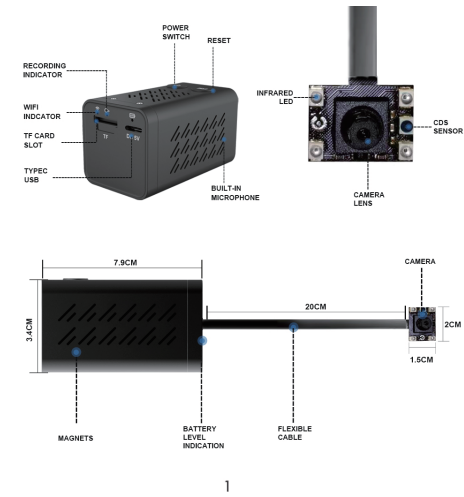



Table of Contents

1. Product overview	page 1
2. Set up guide	page 2
3. Reset instructions	page 7
4. Restart	page 7
5. Charing and power on/off	page 8
6. In the box	page 9
Recycle instructions	page 10
Warnings	page 10

1. Product Overview



2. Set Up Guide

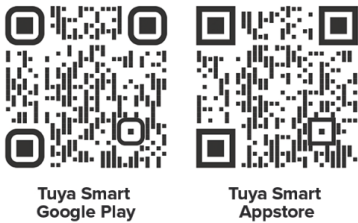

- 1A Download the Tuya app by scanning the QR code above.
- 1B Install the app. Making an account is optional, but grants you more features.
- 1C Installing the camera only take a few minutes. Additionally the app itself will guide you through most of the steps.

2.1 Add Device

- 2A Tap the '+' icon in the top right corner to add a device.
- 2B Scroll down and Select "Camera & Lock" from the options on the left.
- 2C Select "Smart Camera (2.4 GHz & 5 GHz)" from the available options. Only compatible with 2.4 GHz WiFi connections.



2.2 Connect with WiFi

- 3A Ensure the camera is powered on and ready to be connected.
- 3B Make sure the blue light is blinking and red light is on. Listen for a jingle or repeating sound, indicating that the camera is ready.
- 3C Connect the camera to your Wi-Fi network.



2.3 Establish Connection

- 4A The app will show a QR code. Scan the code by pointing the camera's lens towards the code. Keep a distance of 15-20 cm.
- 4B Wait for the message 'connection start'.
- 4C The device will start establishing a connection, which may take up to 2 minutes.
- 4D Ensure you are close to your Wi-Fi signal to expedite the process. Once connected, the device will prompt: "Network connection success."

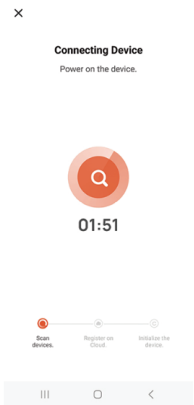

2.4 Final Steps

- 5A Give the camera a name based on its location.
- 5B You will be directed to the camera's live view.
- 5C In the bottom right corner, you can activate the alarm and adjust its sensitivity to your preferences.

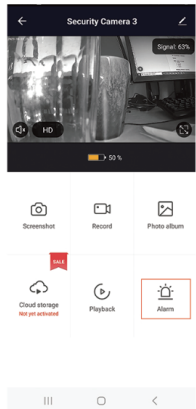

3. Reset Instructions

- 1A If you have issues connecting the camera hold the 'reset' button (RS) on top of the device for about 4 seconds. This will reset the connection and allow you to set it up again.
- 1B If successful the camera will prompt 'reset success'.
- 1C Follow the setup guide instructions from the start.

4. Restart

- 1A Every time you restart the camera it will have to establish a connection with your WiFi. Usually this takes less than 30 sec, but it is dependent on your signal strength.
- 1B The prompt sequence is: 'Welcome to Youth', 'Connection Start', and then 'Network Connection Start'.
- 1C If this process takes long try to move to a location with a better connection strenght to expedite the process.

5. Charing and power on/off

- 1A The package includes a 5V 1A (5W) charger. Please ensure that you exclusively utilize this charger or one with similar specifications for charging the device. Employing a more powerful charger, often referred to as fast chargers, could potentially damage the device.
- 2A How to open the camera
When the camera is turned off, hold down the power button for 3 seconds. When the blue light turns on, the camera starts to work.
How to turn off the camera
When the camera is in operation, press and hold the power button for 3 seconds. The blue light will go out and the camera will be turned off.

6. In the Box

- 1 Mini Camera
- 2 TypeC cable
- 3 Instruction manual

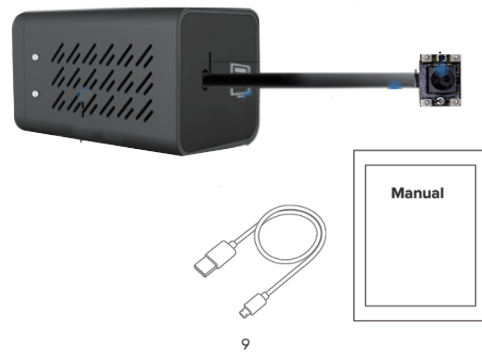

Recycling



- EN When recycling this product, please follow WEEE battery recycling procedures. Contact your local recycling organization for more information

Warnings



- EN Warnings: Don't drop, disassemble or attempt to repair the camera or charger by yourself. Avoid exposure to water or high humidity. Don't expose to any heat source. Keep out of reach of children. Don't use in the presence of flammable gas.

This device complies with part 15 of the FCC Rules. Operation is subject to the following two conditions: (1) This device may not cause harmful interference, and (2) this device must accept any interference received, including interference that may cause undesired operation.

Any Changes or modifications not expressly approved by the party responsible for compliance could void the user's authority to operate the equipment.

Note: This equipment has been tested and found to comply with the limits for a Class B digital device, pursuant to part 15 of the FCC Rules. These limits are designed to provide reasonable protection against harmful interference in a residential installation. This equipment generates uses and can radiate radio frequency energy and, if not installed and used in accordance with the instructions, may cause harmful interference to radio communications. However, there is no guarantee that interference will not occur in a particular installation. If this equipment does cause harmful interference to radio or television reception, which can be determined by turning the equipment off and on, the user is encouraged to try to correct the interference by one or more of the following measures:

- Reorient or relocate the receiving antenna.
- Increase the separation between the equipment and receiver.
- Connect the equipment into an outlet on a circuit different from that to which the receiver is connected.
- Consult the dealer or an experienced radio/TV technician for help.
- This equipment complies with FCC radiation exposure limits set forth for an uncontrolled environment. This equipment should be installed and operated with minimum distance 20cm between the radiator & your body.