

# **DREO** | Smart Tower Fan 554S

## USER MANUAL

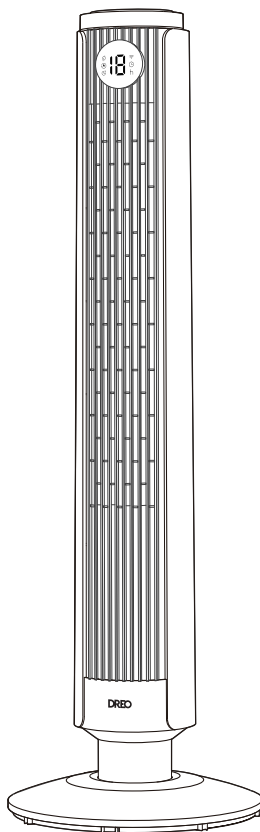

”

# Thanks for Choosing **DREO!**

Your support means the world to us.  
We hope you enjoy our product as much as  
we did creating it.

# CONTENTS

## 01

### IMPORTANT SAFETY INSTRUCTIONS

1-3

---

## 02

### ASSEMBLING YOUR TOWER FAN

4-7

---

## 03

### CONNECTING TO YOUR TOWER FAN

8-9

---

## 04

### KNOWING YOUR TOWER FAN

10

---

## 05

### USING YOUR TOWER FAN

11-14

---

## 06

### CLEANING AND MAINTENANCE

15-16

---

## 07

### TROUBLESHOOTING

17

---

## 08

### DREO CUSTOMER CARE

18-20

---

# IMPORTANT SAFETY INSTRUCTIONS

# 01



READ ALL CAUTIONARY MARKINGS ON THE APPLIANCE AND SAFETY INSTRUCTIONS IN THE USER MANUAL BEFORE USE.

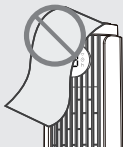

Do not cover the air inlet and outlet while in operation.



Do not use the fan near flammables and combustibles.

## General Safety

- 1.Children shall not play with the appliance. Cleaning and maintenance shall not be performed by children without supervision.
- 2.Use the appliance as described in the user manual only. Any other use not recommended in the user manual may cause fire, electrical shock, or personal injury.
- 3.This appliance can be used by children aged above 8 years and persons with reduced physical, sensory or mental capabilities or lack of experience and knowledge if they have been given supervision or instruction concerning use of this appliance in a safe way and understand the hazards involved.

## Operation Safety

1. Place the appliance on a flat, dry surface before use.
2. Do not immerse in water and any other liquids.
3. Do not use the appliance until the base is installed.
4. Do not insert your fingers, pencil and any other objects into the grilles while in operation.
5. Do not attempt to repair or modify any electrical or mechanical functions on the appliance. All servicing should be performed by qualified personnel only.
6. Ensure that the fan is switched off from the supply mains before removing the guard.

## Electricity Safety

1. Make sure that the voltage of your electricity supply is the same as that indicated on the appliance.
2. Always unplug before cleaning or leaving the appliance unused for a long period of time. Keep your hands dry when plugging/unplugging.
3. Do not operate any fan with a damaged cord or plug. Discard fan or return to an authorized service facility for examination and/or repair.
4. Do not run cord under carpeting. Do not cover cord with throw rugs, runners, or similar coverings. Do not route cord under furniture or appliance. Arrange cord away from traffic area and where it will not be tripped over.
5. **WARNING:** To reduce the risk of fire or electric shock, do not use this Fan with any solid-state speed control device.
6. This appliance employs overload protection (fuse). A blown fuse indicates an overload or short-circuit situation. If the fuse blows, unplug the product from the outlet. Replace the fuse as per the user servicing instructions and check the appliance. If the replacement fuse blows, a short-circuit may be present and the appliance should be discarded or returned to an authorized service facility for examination and/or repair.
7. This appliance has a polarized plug (one blade is wider than the other). To reduce the risk of electric shock, this plug is intended to fit in a polarized outlet only one way. If the plug does not fit fully in the outlet, reverse the plug. If it still does not fit, contact a qualified electrician. Do not attempt to defeat this safety feature.
8. **WARNING:** To reduce the risk of fire, electric shock or injury to persons, do not use replacement parts that have not been recommended by the manufacturer (e.g. parts made at home using a 3D printer).

# FOR HOUSEHOLD USE ONLY READ AND SAVE THESE INSTRUCTIONS

## Gentle Reminder:



Check the appliance regularly and refer to TROUBLESHOOTING or contact our customer support if it shows any of the following signs:

- Power cord or plug is damaged.
- Loud noise, unusual smell or excessive heat.

## Specifications

|              |            |
|--------------|------------|
| Model No.    | DR-HTF024S |
| Input        | 120V~60Hz  |
| Rated Power  | 35W        |
| Battery Type | AAA        |

# ASSEMBLING YOUR APPLIANCE

## 02

### Before Assembly

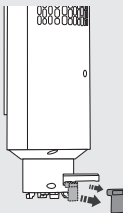

Make sure to remove the limiter before assembling the appliance.

### Before Assembly

When using the appliance for the first time, remove the wraps and attach the parts by following the steps below.

1

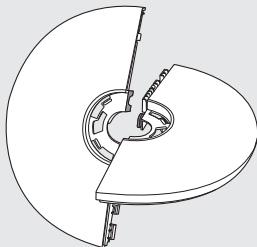

Intersect the two base halves diagonally.

2

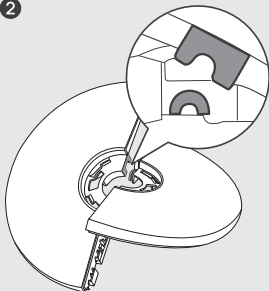

Match the arched cutout with the arched support on the base. Then, hook them together.

3

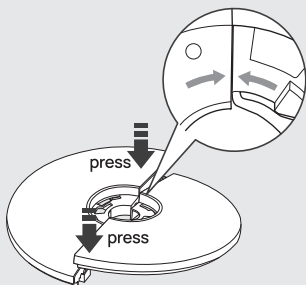

Press down on the edges to snap the two base halves together.

4

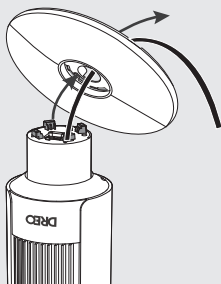

Thread the cord through the center hole and attach the base to the fan bottom.

5

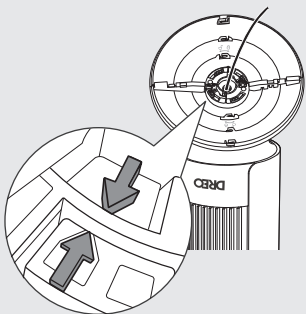

Make sure the pin on the fan bottom is aligned with the cavity on the base.

6

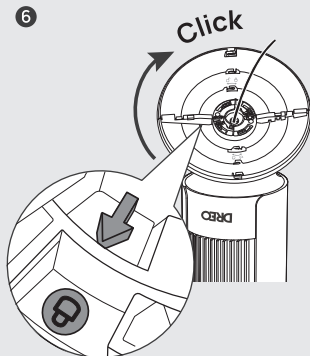

Turn the base clockwise until it **clicks** into place.



7

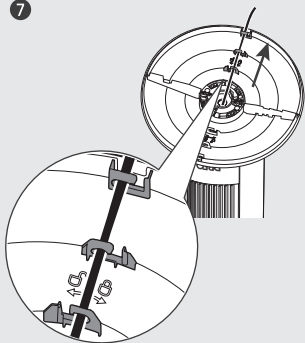

Thread the cord through all REAR cord keepers, then set the fan upright.

### ! CAUTION

- Do not operate the tower fan if the base has not been installed.
- Make sure to thread the cord through all rear cord keepers.

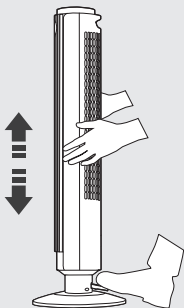
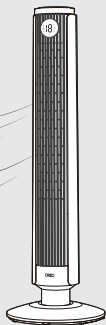

Move the fan body upwards or downwards to your desired height.

# Package Contents

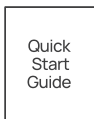
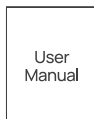
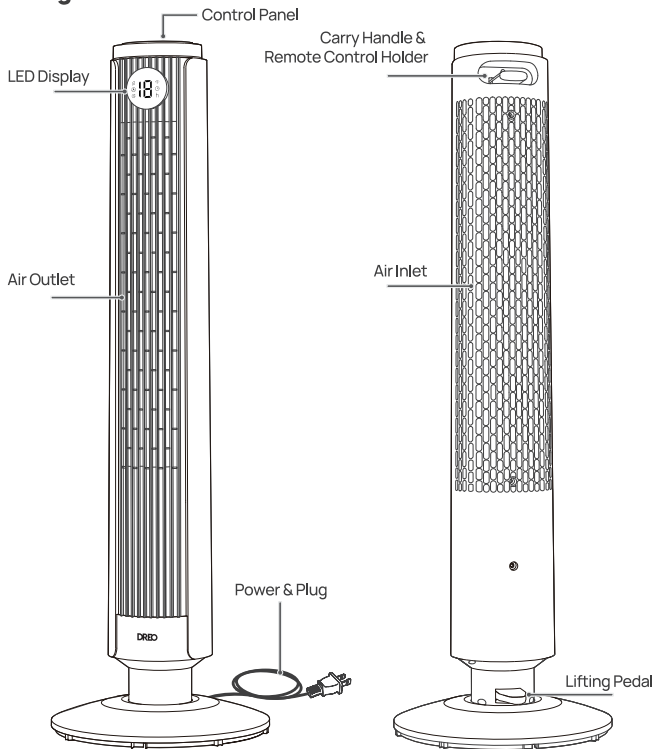

Remote Control

2x AAA Batteries

Base

# KNOWING YOUR APPLIANCE

# 03

## Control Panel



### Power Button

- Turn power on/off



### Mode Button

- Switch between Normal/Natural/Sleep/Auto Mode
- Long press for 3 seconds to mute/unmute



### Increase Button

- 1-9 speed levels



### Decrease Button

- 1-9 speed levels



### Timer Button

- Select to set a timer (0-12h)



### Oscillation Button

- Adjust airflow direction
- Long press for 5 seconds to start network settings and device pairing.

## LED Display

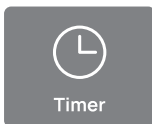
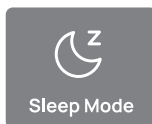
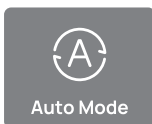
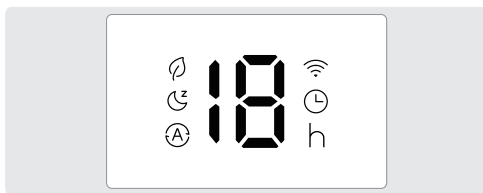

# CONNECTING TO YOUR APPLIANCE

# 04



Before connecting the appliance to your mobile device, please scan the QR code on the left or go to the app store and search "DREO", then select and download the app.



Download on the  
**App Store**





GET IT ON  
**Google Play**



Look for "Tower Fan 554S" when connecting your new appliance.



You can use the DREO app to connect your appliance to Amazon Alexa or Google Home. Please follow the in-app instructions to set up your voice assistant.

NOTE: You must create a DREO account to access voice assistants.

- 1 Launch DREO and sign in or create account by following in-app instructions.
- 2 Enable Bluetooth on your mobile device and plug in your appliance.
- 3 Hold  for 5 seconds to start WiFi connection settings.  
(Tip: The WiFi icon  will keep flashing when pairing.)
- 4 Tap + **Add Device** and select **Tower Fan 554S**.
- 5 Follow in-app instructions to complete WiFi connection.
- 6 You're now ready to control the appliance on your app.  
(Tip: To restart connection settings, hold the Oscillation button  again for 5 seconds.)

Long press  and  for 10 seconds to unpair WiFi and restore factory settings.

# USING YOUR APPLIANCE

# 05

## Working Modes



### Normal Mode

Fan runs at the fixed speed.



### Natural Mode

Fan speed goes up and down intermittently to replicate the natural breeze.



### Auto Mode

Fan automatically increases speed when room temp is higher and decreases speed when temp is lower.



### Sleep Mode

(Mute Auto On)

Balance comfort and noise by automatically decreasing fan speed as you fall sleep.



If the fan speed is 4 or higher, it will decrease two times at most, one speed every 30 minutes, then it will remain constant.

If the fan speed is 3 or lower it will remain constant.

## Additional Features



### Mute

Long press the  or press  on the remote control to turn on/off the button sounds.



### Firmware Update

Check the firmware version on the DREO app and update regularly for the fan to work more efficiently.



Display will show "U" during the update process. Do not operate until the update is completed.



### Timer

When the fan is ON/OFF, touch the timer button repeatedly to set a timer (1-12 h). When the timer ends, the fan will stop/start running automatically. To cancel, set the time to 0 hour.

**Note:** Display will return to fan speed after 3 seconds.



### Memory

If the fan is turned OFF or disconnected from power, it will operate under the previous settings (except the timer setting) when it is turned ON again.



### Display Auto Off

- Display turns off after 1 minute (after 5 seconds in sleep mode).
- Wake up the display with any button.

## Getting the Most out of Your Tower Fan

1. Remove any tall obstacles that might block the airflow from the fan.
2. Combine with your AC unit to get cooler air throughout the room.
3. Position the tower fan closer to you to get more direct airflow.
4. Place a bucket of ice in front of the fan for an extra cooling boost.

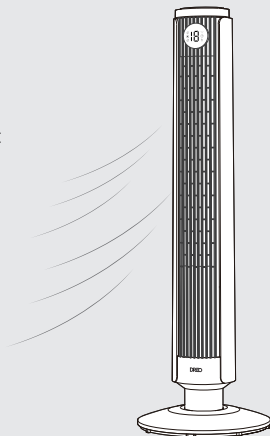

## Remote Control

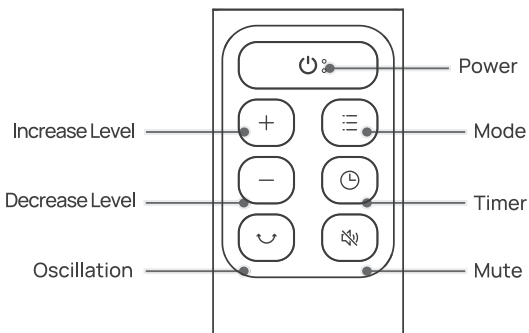

## Battery Replacement

1. Remove the battery cover in the direction indicated by the arrow.
2. Replace with two new AAA 1.5V batteries. Make sure that the positive (+) and negative (-) terminals are positioned correctly.
3. Push the battery cover back into place.

### WARNING

- Replace with new batteries of the same type when replacement is required.
- Remove the batteries when the remote control is unused for long period of time.
- Do not attempt to dismantle the batteries.
- Do not dispose the batteries in fire, batteries may explode or leak.
- Chemical burn hazard. Keep batteries away from children.
- Do not mix old and new batteries and Do not mix alkaline, standard (carbon-zinc) or rechargeable (ni-cad, ni-mh, etc.) batteries.

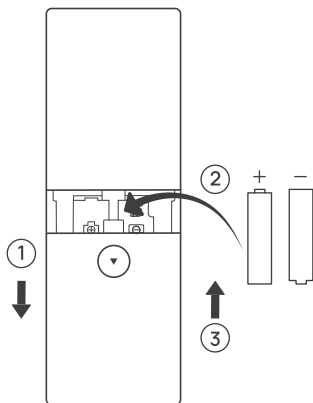



## Adjusting the Fan Height

This appliance comes with a unique lifting pedal. It can raise or lower the fan to your desired height. When you need to adjust the fan height, simply:

1

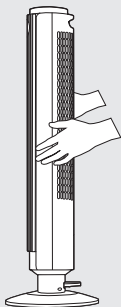

Hold the fan body with both hands.

2

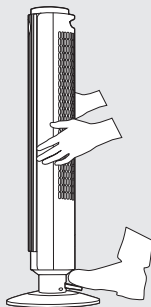

Step on the lifting pedal.

3

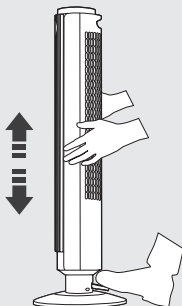

Move the fan body upwards or downwards to your desired height.

4

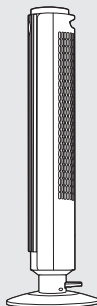

Release the pedal.

Note:

- The fan body can be adjusted to **any height between 40" - 45"**.
- If you step on the lifting pedal without holding the fan body, the fan will be automatically raised to the maximum height (45").

# CLEANING AND MAINTENANCE

# 06

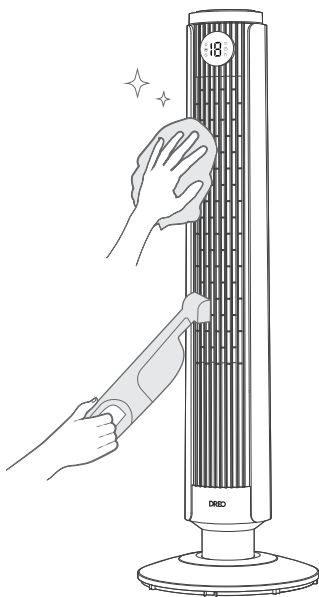

## Outer Surface

Gently wipe off the dust with a soft, dry cloth.

## Grilles & Blades

Remove the dust using a vacuum or air duster.

## Base

The base can be disassembled in the reverse order of assembly.



## CAUTION

1. Always unplug the fan before any cleaning or maintenance.
2. Do not immerse in water or get water inside the motor housing.
3. Do not use any chemical agents when cleaning the fan.
4. Store in a cool, dry place and cover it to protect from dust.

## User Servicing Instructions (Fuse)

This appliance features a fused safety plug that protects against overload or short-circuit situations. If the fuse blows, please cut off power and follow the below instructions or consult a qualified electrician.

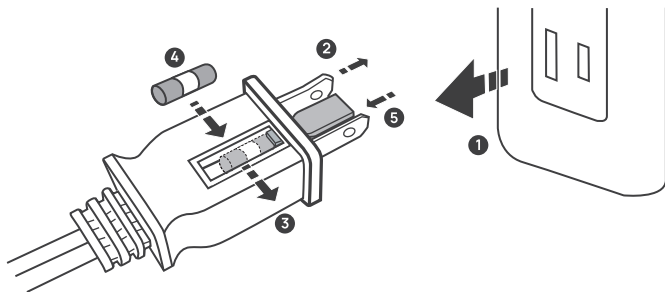

- 1 Grasp plug and remove from the receptacle or other outlet device. Do not unplug by pulling on cord.
- 2 Open fuse cover. Slide open fuse access cover on top of attachment plug towards blades.
- 3 Remove fuse carefully. Push the fuse from the other side to remove the fuse.
- 4 Risk of fire. Replace fuse only with 5 Amp.125 Volt fuse.
- 5 Close fuse cover. Slide closed the fuse access cover on top of attachment plug.



### WARNING

Risk of fire. Do not replace attachment plug. Contains a safety device (fuse) that should not be removed. Discard product if the attachment plug is damaged.

## My fan won't turn on!

Make sure that the cord is connected to a powered outlet and the mains voltage corresponds with the voltage indicated on the fan.

## My fan is shaky and wobbling!

1. Place the fan on a flat, level surface.
2. Incorrect installation might also cause shakiness. Please refer to the assembly instructions in **page 4-6**. Note that the power cord must be run through all rear keepers.

## My fan is making vibration and noise!

1. Place the fan on a flat, level surface.
2. Be sure not to insert anything into the air inlet and outlet.

If your problem is not listed or still persists, please contact our Customer Support (see page 20).

## 12-MONTH LIMITED WARRANTY

### What is Covered

DREO warrants to you that your product will be free from original defects in materials and workmanship for a period of twelve (12) months from the date of your purchase, when you use your product for intended purposes in accordance with this User Manual.

Please retain your proof of purchase. If you do not retain your proof of purchase, your warranty will start two (2) months from the date of manufacture printed on your product label.

### What is Not Covered

This limited warranty only applies to the original purchaser of your product and is non-transferable. This warranty is only valid if your product is used in the country in which you originally purchased it. In addition, this warranty will not apply, and DREO will not be liable for any costs, damages, or repairs, in connection with any of the following:

- Accidents or use of your product with inappropriate force;
- Damage or destruction caused by wrong voltage or unstable electric current;
- Normal wear and tear;
- Careless operation or handling, misuse, abuse, neglect, and/or failure to maintain or use your product in accordance with this User Manual;
- Any partially or completely altered, modified and/or dismantled products;
- Reduction in battery discharge time due to battery age or use (as applicable);
- Products with altered or removed serial numbers;
- Clearing any blockages from the product;
- Purchases from retailers and distributors not authorized by DREO to sell this product;
- Defects caused by or resulting from damages from shipping or handling by any third party not authorized by DREO to ship or handle your product; or
- Defects caused by or resulting from repairs, service, improper maintenance, or alteration to your product or any of its components by anyone other than a repair person authorized by DREO.

Any service and customer support that DREO provides to you under this limited warranty will not extend the duration of this limited warranty.

## Warranty Limitations and Exclusions

ANY IMPLIED WARRANTIES RELATING TO YOUR PRODUCT, INCLUDING BUT NOT LIMITED TO THE WARRANTY OF MERCHANTABILITY AND THE WARRANTY OF FITNESS FOR A PARTICULAR PURPOSE, ARE LIMITED TO THE DURATION OF THE LIMITED WARRANTY SET FORTH ABOVE AND ARE OTHERWISE DISCLAIMED.

THIS LIMITED WARRANTY SHALL BE THE SOLE REMEDY OF THE PURCHASER OR USER OF THE PRODUCT, AND DREO SHALL NOT BE LIABLE FOR AN ALLEGEDLY DEFECTIVE OR DAMAGED PRODUCT EXCEPT TO REPAIR OR REPLACE IT IN ACCORDANCE WITH THIS LIMITED WARRANTY. DREO WILL NOT BE LIABLE FOR SPECIAL, INCIDENTAL, INDIRECT, CONTINGENT, OR CONSEQUENTIAL DAMAGES OR LOSSES OF ANY NATURE THAT YOU MAY INCUR IN CONNECTION WITH YOUR PURCHASE OR USE OF YOUR PRODUCT.

Some jurisdictions do not allow limitations on how long an implied warranty lasts or the exclusion or limitation of incidental or consequential damages, so the above limitations or exclusions may not apply to you. This limited warranty gives you specific legal rights, and you also may have other rights which vary from jurisdiction to jurisdiction.

## Limited Remedies

If your product fails because of an original defect in material and/or workmanship during the warranty period, DREO will repair or replace (in DREO's sole discretion) your product.

To obtain warranty service on your product, contact us at [support@dreoworld.com](mailto:support@dreoworld.com) or at (888) 290-1688 (available from Monday-Friday, 9:00 AM-5:00 PM PST/PDT) for further instructions.

IN THE EVENT OF AN ORIGINAL DEFECT IN MATERIAL AND/OR WORKMANSHIP, TO THE EXTENT PERMITTED BY LAW, THE REMEDIES SET FORTH IMMEDIATELY ABOVE ARE YOUR SOLE AND EXCLUSIVE REMEDIES.

## FCC Statement

This device complies with Part 15 of the FCC Rules. Operation is subject to the following two conditions: (1) this device may not cause harmful interference, and (2) this device must accept any interference received, including interference that may cause undesired operation.

Please note that changes or modifications of this product is not expressly approved by the party responsible for compliance could void the user's authority to operate the equipment.

NOTE: This equipment has been tested and found to comply with the limits for a Class B digital device, pursuant to Part 15 of the FCC Rules. These limits are designed to provide reasonable protection against harmful interference in a residential installation. This equipment generates, uses and can radiate radio frequency energy and, if not installed and used in accordance with the instructions, may cause harmful interference to radio communications. However, there is no guarantee that interference will not occur in a particular installation.

If this equipment does cause harmful interference to radio or television reception, which can be determined by turning the equipment off and on, the user is encouraged to try to correct the interference by one or more of the following measures:

- Reorient or relocate the receiving antenna.
- Increase the separation between the equipment and receiver.
- Connect the equipment into an outlet on a circuit different from that to which the receiver is connected.
- Consult the dealer or an experienced radio/TV technician for help.

This equipment complies with FCC radiation exposure limits set forth for an uncontrolled environment. This equipment should be installed and operated with a minimum distance of 20cm between the radiator & your body. This transmitter must not be co-located or operating in conjunction with any other antenna or transmitter.

Model No.: DR-HTF024S  
Rev\_1.0\_EN

### We're Here to Help!

 (888) 290-1688 (Mon - Fri, 9:00 am-5:00 pm PST/PDT)

 support@dreo.com

 www.dreo.com



[www.dreo.com](http://www.dreo.com)

## Looking for help?

Contact us to get expert support.



[support@dreo.com](mailto:support@dreo.com)



[\(888\) 290-1688](tel:(888)290-1688)



[www.dreo.com](http://www.dreo.com)

Mon - Fri, 9:00 am-5:00 pm PST/PDT