

DC2700AC/DC2708AA

Single-channel Emitter

Instruction

Model number: DC2700AC/DC2708AA

FCC ID: 2BPAM-20251818

Instruction Of Buttons

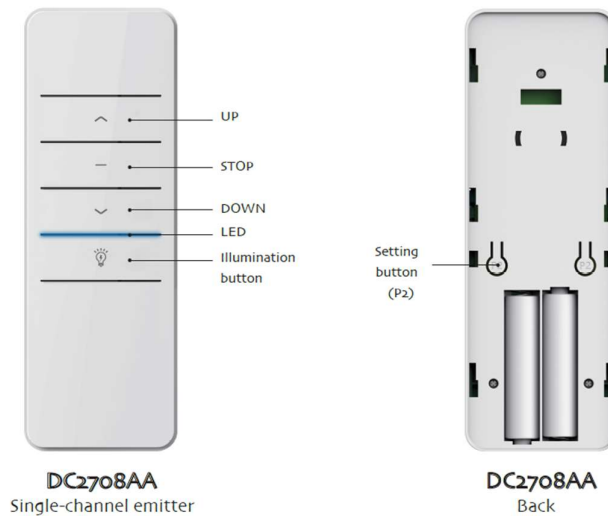

Technical specifications

Battery: 3V (AAA×2)	Battery life: >2year	Radio frequency: 433.05~434.79MHz
Transmitting power: 10mW	Static current: ≤5uA	Emission Current: ≤20mA
Working temperature: -5℃~50℃	Radio range: 35 meters indoor	

Warning

- 1, Emitter couldn't expose to moisture or be striked heavily, or else the emitter life will be affected.
- 2, If the emitter is not so sensitive or the radio range becomes shorter, pls check whether to change the battery.
- 3, If you press any button more than 10S, the emitter will stop sending radio signals;
- 4, It's forbidden to use different type battery to avoid any dangerous risk.
- 5, Dispose of used batteries properly.

Warning

Equipment containing one or more coin / button cell batteries shall have an instructional safeguard:

- 1) Do not ingest battery, Chemical Burn Hazard
- 2) This product contains a coin / button cell battery. If the coin / button cell battery is swallowed, it can cause severe internal burns in just 2 hours and can lead to death.
- 3) Keep new and used batteries away from children. If the battery compartment does not close securely, stop using the product and keep it away from children. If you think batteries might have been swallowed or placed inside any part of the body, seek immediate medical attention.
- 4) Replacement of a battery with an incorrect type that can defeat a safeguard Or Risk of fire or explosion if the battery is replaced by an incorrect type
- 5) Disposal of a battery into fire or a hot oven, or mechanically crushing or cutting of a battery, that can result in an explosion;
- 6) Leaving a battery in an extremely high temperature surrounding environment that can result in an explosion or the leakage of flammable liquid or gas;
- 7) A battery subjected to extremely low air pressure that may result in an explosion or the leakage of flammable liquid or gas.

This marking indicates that this product should not be disposed with other household wastes throughout the EU. To prevent possible harm to the environment or human health from uncontrolled waste disposal, recycle it responsibly to promote the sustainable reuse of material resources. To return your used device, please use the return and collection systems or contact the retailer where the product was purchased. They can take this product for environmental safe recycling.



This device complies with Part 15 of the FCC Rules. Operation is subject to the following two conditions: (1) this device may not cause harmful interference, and (2) this device must accept any interference received, including interference that may cause undesired operation.

Warning: Any changes or modifications to this unit not expressly approved by the party responsible for compliance could void the user's authority to operate the equipment.

NOTE: This equipment has been tested and found to comply with the limits for a Class B digital device, pursuant to part 15 of the FCC Rules. These limits are designed to provide reasonable protection against harmful interference in a residential installation. This equipment generates, uses and can radiate radio frequency energy and, if not installed and used in accordance with the instructions, may cause harmful interference to radio communications. However, there is no guarantee that interference will not occur in a particular installation. If this equipment does cause harmful interference to radio or television reception, which can be determined by turning the equipment off and on, the user is encouraged to try to correct the interference by one or more of the following measures:

- Reorient or relocate the receiving antenna.
- Increase the separation between the equipment and receiver.
- Connect the equipment into an outlet on a circuit different from that to which the receiver is connected.
- Consult the dealer or an experienced radio/TV technician for help.