

# 烟雾净化器 SMOKE PURIFIER

User Manual

V1.0

## 尊敬的用户:

感谢您选择Creality Falcon的产品。在这个旅途中，我们期待您创造出无限可能的作品。可以在Facebook,Tiktok,Instagram等社交媒体搜索Falcon Laser进行关注，在其中可分享您的作品并从他人那里获得灵感。

Creality Falcon团队时刻准备为您提供优质的服务。如在使用过程中您遇到问题，请参照产品说明书中所提供的电话、邮箱与我们进行联系。为了能够更好地体验我们的产品，您可以从维基百科([wiki.creality.com/zh/laser-engraver](http://wiki.creality.com/zh/laser-engraver))中获取相关使用说明及视频。或登录Creality Falcon官方商城([www.crealityfalcon.com](http://www.crealityfalcon.com))寻找相关软硬件、联系方式、设备操作、设备保养等信息。

## Dear User,

Thank you for choosing Creality Falcon's product. On this journey, we look forward to you creating works of unlimited possibilities. You can follow Falcon Laser on social media platforms such as Facebook, TikTok, and Instagram, where you can share your works and gain inspiration from others.

The Creality Falcon team is always ready to provide you with quality service. If you encounter any problems during use, please contact us using the phone number and email provided in the product manual. To better experience our products, you can obtain relevant instructions and videos from Wikipedia ([wiki.creality.com/en/laser-engraver](http://wiki.creality.com/en/laser-engraver)). Or visit the official Creality Falcon store ([www.crealityfalcon.com](http://www.crealityfalcon.com)) to find information on related hardware and software, contact methods, equipment operation, equipment maintenance, etc.

## 售后服务 / After-sales Service

Email: [support@crealityfalcon.com](mailto:support@crealityfalcon.com)

1.产品概览/Product Overview .....	01
2.装箱清单/Packing List .....	02
3.注意事项/Precautions .....	02
4.产品说明/Product Description .....	03
5.安装指引/User Guide .....	04
6.滤芯更换说明/Filter Replacement Guide.....	05
7.保险丝更换说明/Fuse Replacement Instructions.....	07

## 1.产品概览 /Product Overview

- 1.本产品适用于产生烟雾、异味、粉尘、有毒有害气体的应用场景，如激光雕刻、3D打印等。
- 2.凭借多重过滤设计和强劲吸力，可有效吸附和净化激光雕刻时产生的各种颗粒物和气态污染物，净化后的空气可直接在室内排放。
- 3.本产品可通过WiFi或type-C数据线与Falcon激光雕刻机连接,进入auto模式后,可自动同步启动和延时关闭净化。您还可以下载FalconDesignSpace App远程监控净化器。

- 1.This product is suitable for application scenarios that generate smoke, odors, dust, and toxic or harmful gases, such as laser engraving and 3D printing.
- 2.With its multi-stage filtration design and powerful suction, it effectively captures and purifies various particulate matter and gaseous pollutants produced during laser engraving. The purified air can be directly discharged indoors.
- 3.This product can connect to the Falcon laser engraver via WiFi or a Type-C data cable. In Auto mode, it will automatically synchronize to start and delay shutdown for purification. You can also download the FalconDesignSpace App for remote monitoring of the purifier.

## 产品参数 / Specifications

产品名称 Product Name	烟雾净化器/SMOKE PURIFIER
产品型号 Product Model	Falcon AP1
产品尺寸 Product Dimensions	460*270*430mm
净重 Net Weight	10kg
包装尺寸 Packaging Dimensions	650*344*532mm
毛重 Gross Weight	15kg
进风接口 Air Intake Port	φ65mm
输入电压 Input Voltage	120-230V~50-60Hz
输出电压 Output Voltage	DC24V
最大功率 Maximum Power	150W
噪音 Operating Noise	≤62dB
最大系统风量 Maximum Airflow Rate	250m³/h
工作温度 Operating Temperature	-10~50°C
安规认证 Safety Certifications	CE、ROHS、FCC、SGS
滤芯配置 Filter Cartridge Configuration	滤芯1: 高效HEPA夹碳布复合滤芯 滤芯2: 改性活性炭滤芯 Filter 1: High-efficiency HEPA composite filter Filter 2: Activated carbon filter

## 2. 装箱清单/Packing List

空气净化器主机\*1台、电源线\*1根、说明书\*1本、复合滤芯\*1套、type-C数据线（2m）\*1根、 $\phi 65\text{mm}$ 转接口\*1件、排气管（1.5m）\*1根、卡箍\*2。

Air purifier main unit \*1, power cord \*1, user manual \*1, composite filter \*1 set, Type-C data cable (2m) \*1,  $\phi 65\text{mm}$  adapter \*1, exhaust pipe (1.5m) \*1, hose clamp \*2.

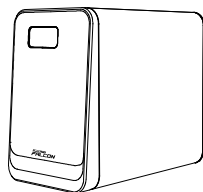

主机  
Main Unit

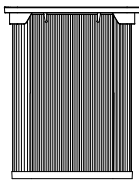

滤芯1  
Filter 1

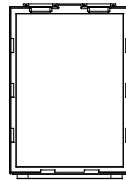

滤芯2  
Filter 2

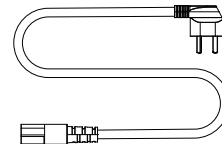

电源线  
Power Cord

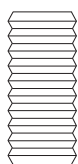

吸烟管  
Smoke Extraction Hose



连接管  
Duct Connector



手扭喉箍\*2  
Hand-Tightened Hose Clamps  $\times 2$



说明书  
User Manual

\*打开包装箱取出机器后，请仔细检查下列附件是否缺少或损坏，若发现有任何一项缺少或损坏，请与销售客服联系联系。

\*After removing the machine from the packaging box, please carefully check whether any of the following accessories are missing or damaged. If you find any missing or damaged items, please contact our sales customer service.

## 3. 注意事项/Precautions

1. 机器的电源输入应在规定的额定电压范围内使用（以机身上的功率标识为准），严禁电压过高或过低时使用。发现使用环境电压不稳定时请关闭机器并拔掉设备的电源插头，待电压稳定后再使用。
2. 使用机器时，进风口吸入的气体、粉尘的环境温度范围为：-20 至 50 °C，禁止高于或低于此温度范围使用。
3. 使用机器时，进风口吸入的气体、粉尘的湿度不应高于80%，湿度过高会使滤芯很快失效及机器内部电路损坏，禁止湿度高于80%的环境使用。
4. 严禁在没有放置过滤芯的状态下使用机器，直接吸进机器的油烟或粉尘颗粒物会造成风机及控制系统的损坏。以上状态下使用机器造成的故障需自费维修，会造成您更大的损失。
5. 严禁滤芯严重堵塞后仍继续使用机器，会大大缩短机器的使用寿命，甚至会造成机器损坏。应定期清理及维护机器，定期更换滤芯，以保证机器在良好的状态下工作。
6. 当您的机器滤芯堵塞吸力变小或除异味过滤芯失效不能去除异味时，请您更换原厂配置的滤芯。
7. 严禁私自打开机器内部进行维修。

- 1.The machine's power input must be used within the specified rated voltage range (refer to the power label on the machine). Do not operate the machine if the voltage is too high or too low. If unstable voltage is detected, turn off the machine, unplug the power cord, and only resume use once the voltage stabilizes.
- 2.During operation, the ambient temperature of gases and dust drawn into the air intake must be within the range of -20°C to 50°C. Do not use the machine above or below this temperature range.
- 3.During operation, the humidity of gases and dust drawn into the air intake must not exceed 80%. Excessive humidity will quickly degrade the filter and damage the internal circuitry. Do not use the machine in environments with humidity above 80%.
- 4.Never operate the machine without the filter installed. Directly inhaling oil fumes or dust particles can damage the fan and control system. Failures caused by such misuse will require paid repairs and may result in greater losses.
- 5.Do not continue using the machine if the filter is severely clogged, as this will significantly shorten its lifespan or even cause permanent damage. Regularly clean and maintain the machine, and replace the filter as needed to ensure optimal performance.
- 6.If suction power decreases due to a clogged filter or if the odor-removing filter fails to eliminate smells, replace it with an original manufacturer-approved filter.
- 7.Unauthorized disassembly or internal repairs of the machine are strictly prohibited.

## 4.产品说明/Product Description

	滤芯已失效提示图标, 请您及时更换滤芯, 以获得有效的净化效果 Filter Life End Indicator, Please replace the filter promptly to maintain optimal purification performance
	您正在通过数据线连接激光雕刻机, 净化器可选择auto模式, 与雕刻机加工任务同步启停 With data cable connection to laser engraver, select Auto mode for synchronized operation.
	图标闪烁时: 机器进入配网状态/Flashing Icon: The machine enters network configuration mode. 图标常亮时: 机器已正常联网/Steady Icon: The machine is successfully connected to the network
	图标亮起时: 机器未联网或网络错误/Icon Illumination: Machine Offline or Network Error
	数字: 净化器周边的PM2.5实时浓度单位为 $\mu\text{g}/\text{m}^3$ ,最高显示为 $999\mu\text{g}/\text{m}^3$ Digital Display: Real-time PM2.5 concentration around the purifier (unit: $\mu\text{g}/\text{m}^3$ ), with a maximum reading of $999\mu\text{g}/\text{m}^3$ .
	1.风速调节按钮: 单击可手动选择1-3级风挡, 当净化器通过WiFi或type-C数据线连接雕刻机时, 可选择auto模式; 2.净化器将与雕刻机的加工任务自动同步启停; 3.更换完滤芯后, 长按风速按键5秒可手动重置滤芯寿命。 1.Fan Speed Button: Press to manually select levels 1-3, or choose Auto mode when connected to the engraver via WiFi/Type-C cable. 2.The purifier will automatically synchronize its operation with the engraver's processing tasks. 3.After filter replacement, press and hold the fan speed button for 5 seconds to manually reset
	1.启动开关: 单击可启动/停止运行; 2.长按5秒可触发WiFi配网功能, 可通过FalconDesignSpace App完成联网和远程操控净化器。 1.Power Switch: Single Click - Starts/Stops operation 2.Press and hold for 5 seconds to activate WiFi pairing mode, enabling network configuration and remote control of the purifier via the FalconDesignSpace App
	船型开关: 电源开关 Rocking switch: Power switch
	数据线接口: 连接至激光雕刻机后, 可选择auto模式 Data port: When connected to the laser engraver, Auto mode becomes available
	进风口: 通过软管连接至雕刻机 Air inlet: Connect to the engraving machine via flexible hose
	出风口: 排出洁净空气, 请勿遮挡(请留意箭头方向, 朝下安装) Air outlet: Releases purified air. Do not block.(Note the arrow direction and install facing downward.)
	滤芯1: 高效HEPA夹碳布复合滤芯, 内置初效滤层 Filter 1: High-efficiency HEPA composite filter,Built-in primary filter layer
	滤芯2: 改性活性炭滤芯 Filter 2: Activated carbon filter

## 5. 安装指引/User Guide

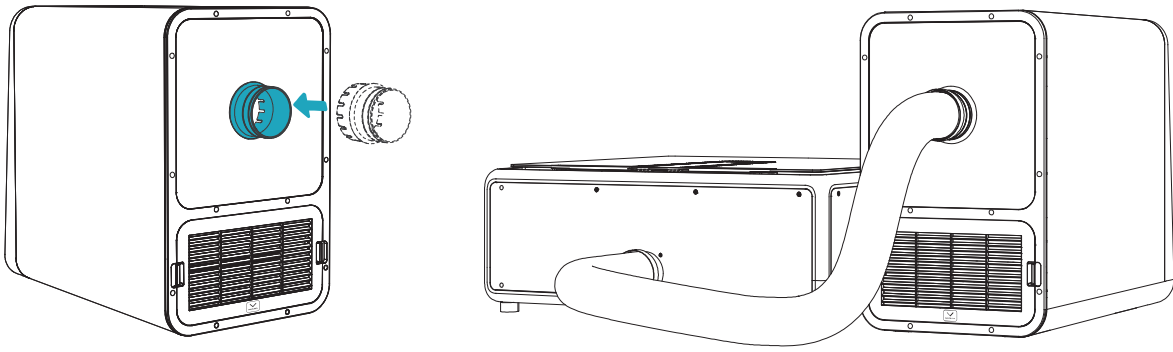

- 5.1 拆除包装后，将机器放置在平稳的桌面或地面上，装上吸烟管转接头，将排气管一头连接至净化器，另一头连接至雕刻机并拧紧卡箍；  
5.1 After unboxing, place the unit on a stable surface, install the Hand-Tightened Hose Clamps, then connect the exhaust hose between the purifier and engraver, securing both ends with clamps.

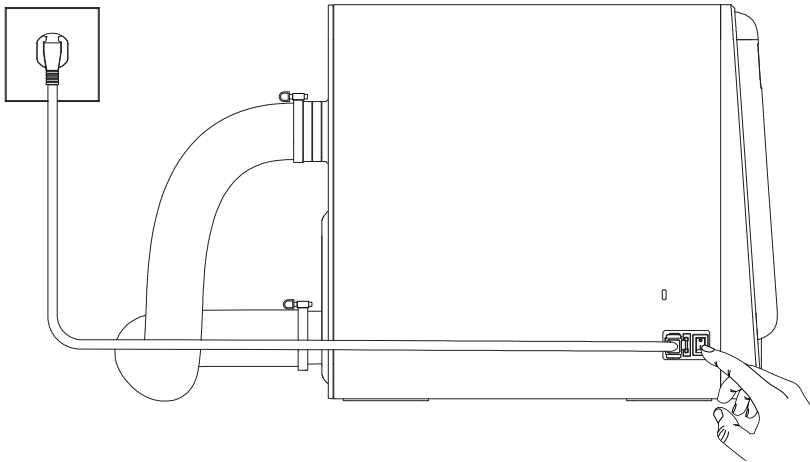

- 5.2 连接电源，拨动船型开关，通电后，船型开关亮起；  
5.2 Connect to power, flip the rocker switch to ON position – illuminated switch confirms power activation.

### 5.3 app连接与控制/App Connection & Control

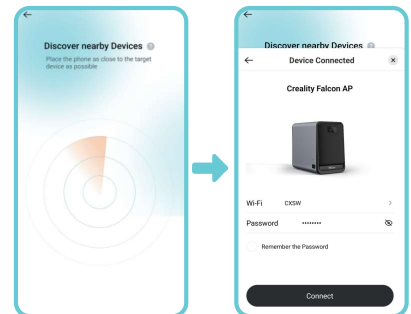
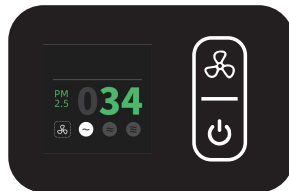

- 5.3.1 下载FalconDesignSpaceApp应用程序；  
5.3.1 Download FalconDesignSpace Ap

- 5.3.2 长按净化器启动开关5秒，净化器进入配网模式，打开手机蓝牙与WiFi功能后，在App内选择Connect Device，查找并选择净化器名称，根据页面提示输入WiFi密码，即可完成净化器配网。  
5.3.2 Press and hold the purifier's power button for 5 seconds to enter pairing mode, turn on the Bluetooth and Wi-Fi functions on your phone, then select 'Connect Device' in the app, choose your purifier from the list, and enter your WiFi password to complete setup.

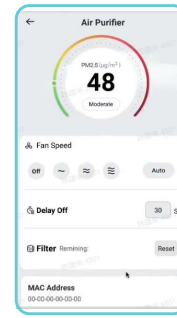
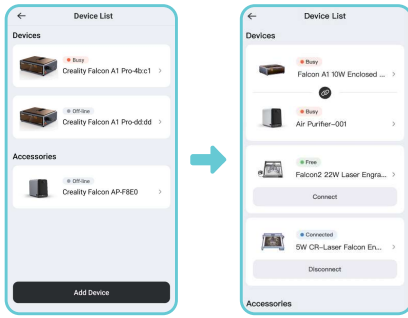

5.3.3在App内将净化器绑定雕刻机,选择auto模式后,可联动雕刻机的加工任务,同步启动、自动停止或延迟停止,您可在App内设置延时关闭净化器(默认为30秒),来持续排出雕刻机内残留的烟雾;

5.4.3 Link the purifier to your engraver in the app and select Auto mode to synchronize operations—the purifier will automatically start/stop with engraving tasks, with configurable delay shutdown (default: 30s) to clear residual smoke.

5.3.4 您可在App内远程开关、查看机器的信息与工作状态、重置滤芯等操作。

5.3.4 Through the app, you can remotely power on/off the machine, monitor its status and operational data, and reset the filter life indicator.

## 5.4 数据线连接/Data Cable Connection

通过数据线互联雕刻机与净化器,手动切换至auto模式,也可自动同步雕刻机的加工任务,实现自动启停功能。

Connect the engraver and purifier via data cable, manually switch to Auto mode for synchronized operation, enabling automatic start/stop with machining tasks.

## 6.滤芯更换说明/Filter Replacement Guide

**\*当出现以下几种情况时,请依据具体情况更换滤芯**

**\*Replace the filter when any of the following conditions occur**

### 设备状态一

系统仍然工作,但风量微弱,吸入力大幅降低。

原因:进风口堵塞或滤筒达到饱和失效而形成堵塞。

处理:检查是否有异物堵塞进风口;再检查出风口是否堵塞。若检查、处理无异样后,重新开机如果还是风量小,则需更换过一级过滤筒。

### Device Status 1

System remains operational but with significantly reduced airflow and suction power

Cause: Likely caused by either intake vent blockage or filter cartridge saturation leading to clogging

Check for foreign objects blocking the air intake, then inspect the exhaust outlet for obstructions. If no issues are found after inspection/treatment but airflow remains weak, replace the primary filter cartridge.

一级过滤筒更换步骤/ Primary Filter Cartridge Replacement Procedure:

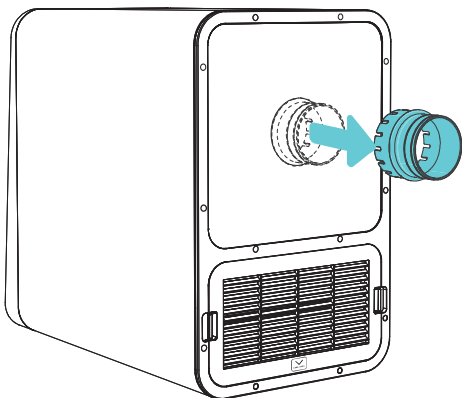

1. 拔出吸烟管转接头;
- 1.Removing the duct connector

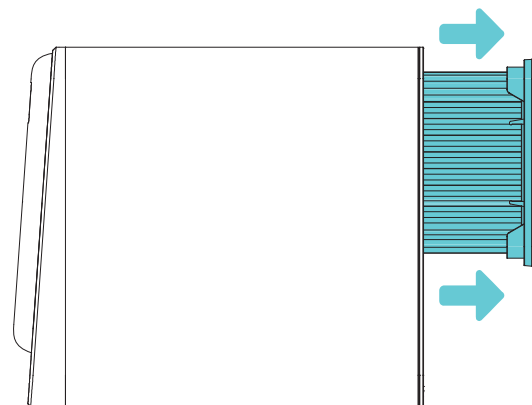

2. 抽出整个一级滤筒,并插入新的一级滤筒;(注意:滤筒齐平机箱为装好状态)
- 2.Pull out the entire primary filter cartridge and insert a new primary filter cartridge.(Note: The filter cartridge is properly installed when it is flush with the chassis)



## 设备状态二:

现象: 设备净化后的空气气味特别重。

原因: 二级滤芯吸附饱和和失效。

处理: 需更换二级过滤芯。

二级过滤筒更换步骤:

Secondary Filter Cartridge Replacement Procedure:

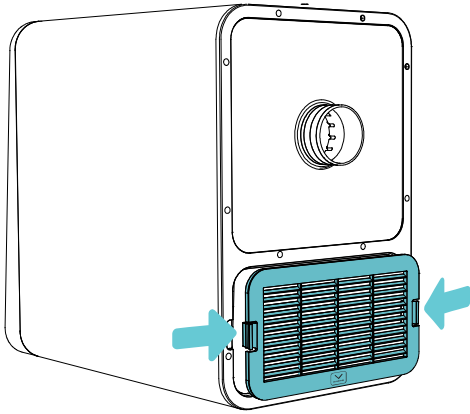

1. 按住出风口导风板两侧卡扣, 取下导风板; (注意: 箭头方向)

1. Press the buckles on both sides of the air outlet guide panel and remove it; (Note: Arrow direction)

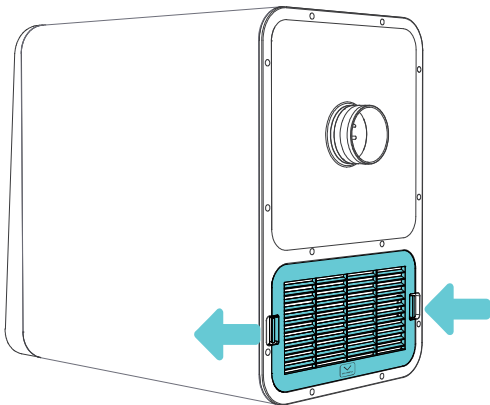

3. 扣上出风口导风板; (注意: 将导风口朝下)

Snap the air outlet guide panel back into place.

(Note: Orient the air vent downward.)

## Device Status 2:

Issue: Purified air has a heavy odor

Cause: The secondary filter cartridge has reached adsorption saturation and failed.

Solution: Replace the secondary filter cartridge.

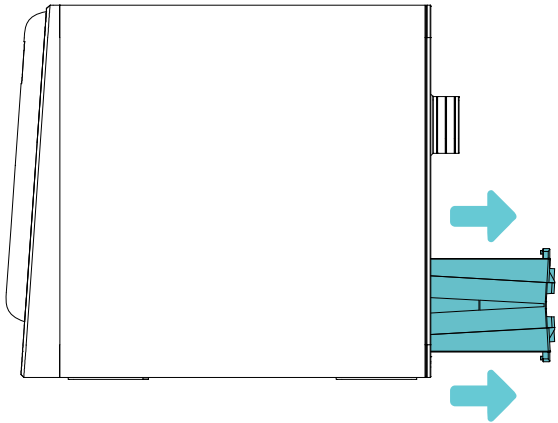

2. 抽出整个一级滤筒, 并插入新的一级滤筒;

(注意: 滤筒齐平机箱为装好状态)

2. Pull out the entire primary filter cartridge and insert a new one. (Note: The filter is properly installed when fully seated flush with the unit housing.)

## 设备状态三:

### Device Status 2:

净化器包含2件滤芯, 当滤芯吸附了大量污染物后, 会增加风阻, 当风阻达到一定程度时, 滤芯失效, 在App、显示屏上会出现滤芯失效图标, 每次开机会有滤芯失效的提醒, 您需要同时更换2件滤芯。

The purifier includes two filter elements. When the filters have adsorbed a large amount of pollutants, the air resistance will increase. Once the air resistance reaches a certain level, the filters will become ineffective. An indicator icon for filter failure will appear on the app and the display screen, and a filter replacement reminder will pop up every time the device is turned on. You need to replace both filter elements at the same time.

#### 滤芯使用注意

- \*不可不放置滤芯使用;
- \*不可水洗滤芯, 需整体更换;
- \*在更换和维护过滤系统之前, 请务必先切断电源;
- \*须使用原厂提供的滤芯, 否则可能造成机器故障。

#### Filter Usage Notes:

- \*Do not operate the purifier without the filters installed.
- \*Do not wash the filters with water—replace them entirely when needed.
- \*Always disconnect the power before replacing or servicing the filtration system.
- \*Only use original manufacturer-provided filters to avoid potential machine malfunctions.

## 7. 保险丝更换说明/Fuse Replacement Instructions

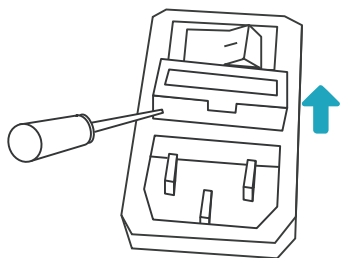

1. 先关掉电源,用螺丝刀撬出保险丝槽  
1. Turn off the power first, then use a screwdriver to pry out the fuse tray

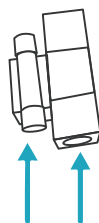

烧掉的保险丝      备用的保险丝  
The blown fuse      Spare fuse

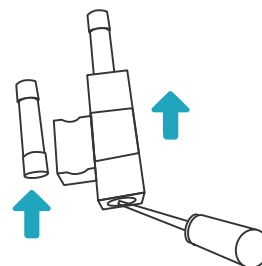

2. 拿掉坏掉的保险丝, 用螺丝刀把备用保险丝取出  
2. Remove the blown fuse, then use a screwdriver to take out the spare fuse.

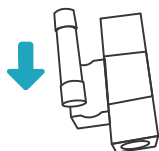

3. 把备用保险丝安装在保险槽的卡扣上  
3. Install the spare fuse into the clip of the fuse slot.

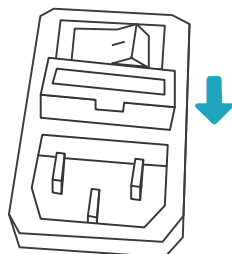

4. 把保险丝槽安装回三合一开关内  
4. Reinstall the fuse tray back into the three-in-one switch

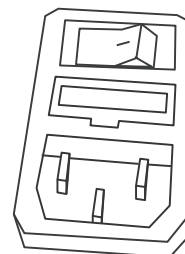

5. 更换保险丝完毕  
5. Fuse replacement completed



---

深圳市创想生态创新科技有限公司

SHENZHEN CREALITY ECOSYSTEM TECHNOLOGY CO., LTD.

Brand Website: [www.crealityfalcon.com](http://www.crealityfalcon.com)

E-mail: [support@crealityfalcon.com](mailto:support@crealityfalcon.com)

Business Tel: +86 755-8523 4565

Company Website: [www.creality.com](http://www.creality.com)

深圳市龙华区民治街道新牛社区梅龙大道锦绣鸿都大厦1205

Room 1205, JinXiuHongDu Building, Meilong Blvd., Longhua Dist., Shenzhen, China 518131



This device complies with part 15 of the FCC Rules. Operation is subject to the following two conditions:  
(1) This device may not cause harmful interference, and (2) this device must accept any interference received, including interference that may cause undesired operation.

Any Changes or modifications not expressly approved by the party responsible for compliance could void the user's authority to operate the equipment.

**Note:** This equipment has been tested and found to comply with the limits for a Class B digital device, pursuant to part 15 of the FCC Rules. These limits are designed to provide reasonable protection against harmful interference in a residential installation. This equipment generates uses and can radiate radio frequency energy and, if not installed and used in accordance with the instructions, may cause harmful interference to radio communications. However, there is no guarantee that interference will not occur in a particular installation. If this equipment does cause harmful interference to radio or television reception, which can be determined by turning the equipment off and on, the user is encouraged to try to correct the interference by one or more of the following measures:

- Reorient or relocate the receiving antenna.
- Increase the separation between the equipment and receiver.
- Connect the equipment into an outlet on a circuit different from that to which the receiver is connected.
- Consult the dealer or an experienced radio/TV technician for help.

This equipment complies with FCC radiation exposure limits set forth for an uncontrolled environment. This equipment should be installed and operated with minimum distance 20cm between the radiator & your body