

Helicopter components

Remote control toys XK919



Remote control component name



Battery installation usage

- 1 Use only AAAbatteries.
- 2 Do not mix different battery types.
- 3 Do not mix older and newer batteries.
- 4 Remove the batteries when the helicopter is not in use.
- 5 Do not recharge non-rechargeable batteries.
- 6 Insert the batteries with the correct polarity.
- 7 USE 3x 1.5V AAA BATTERIES(Not Included).

Helicopter charging

1. First remove the battery.
2. When charging, the battery light will become red.
3. insert the USB cable into the helicopter (and connect to the computer USB power.)
4. When the battery is fully charged, the battery light will be turned off.
5. The charging time is about 60minutes, and the flight time is about 12 minutes.



Steps for replacing the housing

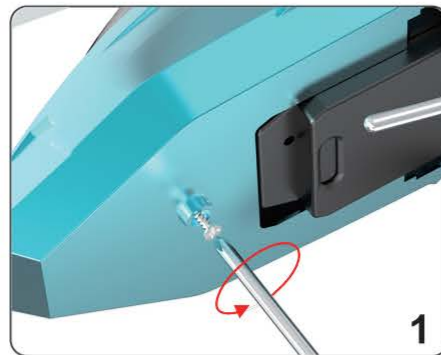

Turn the screw open



Opening the casing



Replacing the casing



Replacement completed

Flight environment

- Suitable for indoor flying!
- In for flight safety, please make sure that there are no pedestrians and other obstacles around the flight environment.
- Attention the wind generated by various electrical appliances and the wind from the outside world interfere with the helicopter to make it unsafe and unstable.

Flight Operations

- Turn on the helicopter power, indicator light flashes, and place the helicopter on a smooth surf ace.
- Make sure everything is safe and clear! Turn on the remote control and the current indicator flashes.
- Start searching for correct frequency, correct frequency successful remote control and helicopteindicator light is always on.
- Perform various functional operations.

Warning

- WARNING:CHOKING HAZARD-Small parts,Not for children under 3 years.
- If the helicopter hits something, restart the helicopter, Specific method: turn ONIOFF (ON/OFF) switch slide close, then open.

How To Connected Helicopter / Remote Control

1	Turn on the helicopter switch	1	
2	Turn on the remote control switch, the indicator light is flashing.	2	
3	Push the throttle lever up and down to match the frequency.	3	
4	The indicator light is always on, indicating successful frequency matching.	4	

Remote control flight mode

Method 1:Throttle Lever Pushed Up/aircraft RaisedThrottle Rod Downward/aircraft Down.	Method 1	Method 2
Method 2:Press the one key button and the helicopter blades will automatically rise to a certain height after slowly rotating		

Push the lever to the left/right, helicopter turning left/right.	
Push the joystick forward/backward to move the helicopter forward/backward.	

Corrective steps

When the helicopter automatically turns right, press this key continuously to correct the helicopter so that it does not rotate continuously.	
When the helicopter automatically turns left, press this key continuously to correct the helicopter so that it does not rotate continuously.	

Trouble shooting

PROBLEM	CAUSE	SOLUTION
Helicopter blades do not move	-Transmitter is off. -weak battery.	-Click the ON/OFF button to turn ON. -Charge the Battery.
Stops operating during flight	-Weak Battery.	-Charge the Battery.
The helicopter does not react to input	-Switch the channel on the transmitter.	-Charge the transmitter to the correct channel.
Remote light flashing	-No matching code. -Weak battery.	-Pair code -Replace the battery

Federal Communications Commission Notice

This device complies with part 15 of the FCC Rules. Operation is subject to the following two conditions: (1) This device may not cause harmful interference, and (2) this device must accept any interference received, including interference that may cause undesired operation.

Any Changes or modifications not expressly approved by the party responsible for compliance could void the user's authority to operate the equipment.

Note: This equipment has been tested and found to comply with the limits for a Class B digital device, pursuant to part 15 of the FCC Rules. These limits are designed to provide reasonable protection against harmful interference in a residential installation. This equipment generates uses and can radiate radio frequency energy and, if not installed and used in accordance with the instructions, may cause harmful interference to radio communications. However, there is no guarantee that interference will not occur in a particular installation. If this equipment does cause harmful interference to radio or television reception, which can be determined by turning the equipment off and on, the user is encouraged to try to correct the interference by one or more of the following measures:

- Reorient or relocate the receiving antenna.
- Increase the separation between the equipment and receiver.
- Connect the equipment into an outlet on a circuit different from that to which the receiver is connected.
- Consult the dealer or an experienced radio/TV technician for help.

The device has been evaluated to meet general RF exposure requirement.

The device can be used in portable exposure condition without restriction.