

Bluetooth headset manual

Product model: Y7

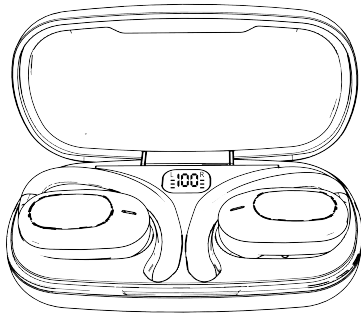

Y7

Functional operation diagram

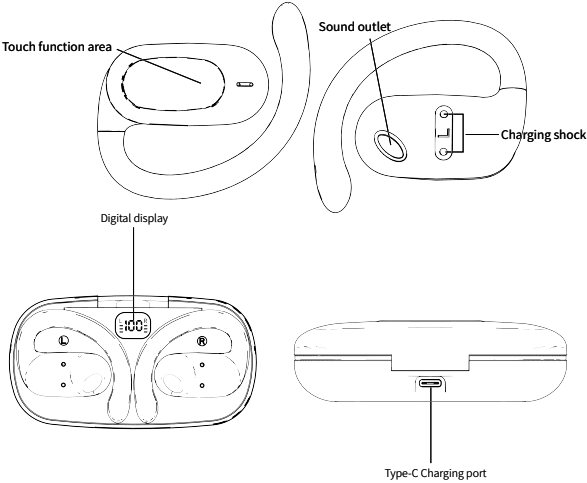

Headset function operation instructions

- 1. Connection: Search for Bluetooth name on the Bluetooth details page to connect to OWS-Y7
- 2. Voice Assistant: Enter the voice assistant by pressing the L/R three key function key
- 3. Play/Pause: L/R Click the function key to play/pause
- 4. Answering phone calls: Click the function key for L/R incoming calls
- 5. Refuse calls: Long press the 2S function key for L/R incoming calls
- 6. Hanging up the phone: Click the function key for L/R incoming calls
- 7. Previous song: Long press L earphones
- 8. Next song: Long press R earphones
- 9. Increase or decrease volume: Double click the function key R to increase the volume
- Double click the function key to decrease the volume
- 10. Low battery reminder for headphones: When the headphones are low battery, a beep sound will be triggered

Headset connection pairing operation

The earphones with the lid open automatically turn on, and the red and blue lights flash alternately, starting the device search.

As shown in the following picture

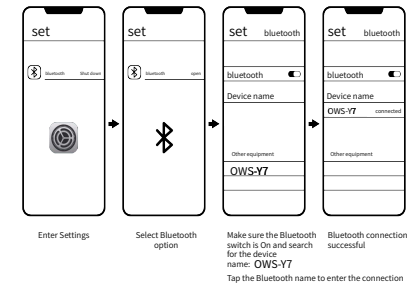

- 1. If the voltage is below 3.3V, a low battery warning will be given, indicating the need for charging.
- 2. The red light stays on when charging the charging compartment, and the blue light stays on when fully charged.
- 3. The charging compartment charges the earphones, the compartment red light stays on, and the fully charged light goes out.
- 4. When the headset is low, the prompt (beep) indicates a low -power prompt.

Product parameter

Frequency response range	100Hz-20KHz	
impedance	32Ω	
sensitivity	125±3db 1KHz	
Bluetooth receiving distance	≥10 m (standard environment)	
Bluetooth version	Bluetooth 5.4	
Support protocol	HSP/HFP/ADP/SBC/ ACC/ AVROP	
Transmission frequency	2402MHz-2480MHz	
Earphone charging time	50 minutes (headphones) about 1.5 hours (charging case)	
Play time	4-5 hours (50% volume)	
Talk time	3-4 hours (50% volume)	
Endurance time	Call the call time when the Bluetooth headset and the mobile phone opens the connection state; about 4-5 hours (two -ear call); standby time: about 100 hours.	
Charging voltage /current	Headset rated input: 5V===50mA	Charging box rated input: 5V===300mA
Product operating temperature	-10-45°c	
Product storage temperature	-10-45°c	

Product safety information

Please read all instructions and warnings before using this product, non-standard use will cause damage to the product or personal safety.

- 1. The product contains batteries, do not expose the product to strong sunshine or overheating environment such as heaters. Do not store this product in high temperature, strong light and strong magnetic field environment.
- 2. Do not place the product in harsh environment such as near the fire source, do not knock, throw, trample, squeeze or put into the fire, if bulging, do not use.
- 3. Ambient temperature : -10~45°C.
- 4. Do not violate the product instructions and use improperly, causing product damage or endangering personal and property safety, and bear the consequences.
- 5. Non-professional personnel are strictly prohibited from decomposing this product, otherwise it may lead to fire and even complete damage to this product.
- 6. Do not use the load that exceeds the output current of this product (electrical appliances), which will automatically stop working.
- 7. Please regularly clean the charging contact of the earphone with a clean cotton cloth to avoid the situation that the earphone cannot be charged or started due to long-term uncleaning.
- 8. Do not place the product in water (or washing machine). If the product is in water, please wait for it to dry naturally before use.

FCC WARNING

This device complies with part 15 of the FCC Rules. Operation is subject to the following two conditions: (1) This device may not cause harmful interference, and (2) this device must accept any interference received, including interference that may cause undesired operation.

Note: This equipment has been tested and found to comply with the limits for a Class B digital device, pursuant to part 15 of the FCC Rules. These limits are designed to provide reasonable protection against harmful interference in a residential installation. This equipment generates, uses and can radiate radio frequency energy and, if not installed and used in accordance with the instructions, may cause harmful interference to radio communications.

However, there is no guarantee that interference will not occur in a particular installation. If this equipment does cause harmful interference to radio or television reception, which can be determined by turning the equipment off and on, the user is encouraged to try to correct the interference by one or more of the following measures:

- Reorient or relocate the receiving antenna.
- Increase the separation between the equipment and receiver.
- Connect the equipment into an outlet on a circuit different from that to which the receiver is connected.
- Consult the dealer or an experienced radio/TV technician for help.

Note: The Grantee is not responsible for any changes or modifications not expressly approved by the party responsible for compliance. such modifications could void the user's authority to operate the equipment.

The device has been evaluated to meet general RF exposure requirement. This equipment complies with FCC's RF radiation exposure limits set forth for an uncontrolled environment. This device and its antenna(s) must not be co-located or conjunction with any other antenna or transmitter.