

HEX<sup>CO</sup>FORCE

# G1

## SMART FINGERPRINT PADLOCK

### Quick Start User Guide

EN



Scan QR code to find support.

#### What's Included

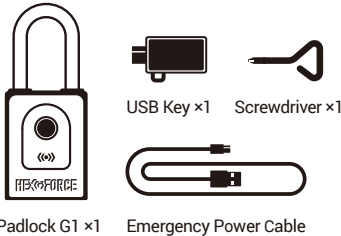

#### Fingerprint Setup



- Download the app by scanning the QR code.
- Connect your padlock to the app to set up fingerprints, create bluetooth keys, or manage access time.

You can also add fingerprints by using the USB key only.

- Use screwdriver to loosen the screws and take off the bottom cover (Due to anti-loss screws, the screws will not be fully removed).
- Press and hold fingerprint sensor for about 5 seconds until the blue light turns on.
- Repeat finger placement for several times, until the light turns green for about 1 seconds, it means fingerprint is successfully registered.
- Use the HEXFORCE® app to manage existing fingerprints.

#### LED Indications

Actions	Indications
Successfully Unlocked	Flash Green light 2 times
Incorrect Fingerprint	Flash Red light for 1 time
Fingerprint Recording	Blue light is constantly on
Low Battery	Flash Red light for 3 times
Battery Drained	Red light turns on for 1 seconds
Hard Reset in Progress	Red light breathing
Hard Reset Complete	Red light pulses 3 times then stays on for 1 second

#### Dimensions

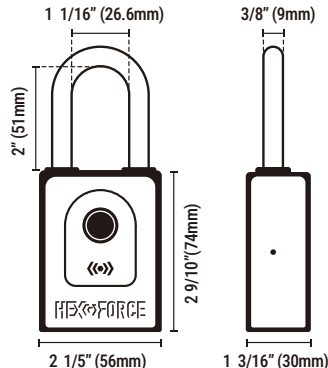

#### Replacing Battery



- Use the screwdriver to loosen the screws and take off the bottom cover (Due to anti-loss screws, the screws will not be fully removed).
- Insert a new CR2 battery with negative( - ) side facing spring. Put the bottom cover back in place. Tighten the screws moderately.

#### Emergency Jumpstart

- Remove the two screws with scwdriver and take off the bottom cover.
- Connect the padlock to a power bank.

#### Hard Reset

- Use the screwdriver to loosen the screws and take off the bottom cover (Due to anti-loss screws, the screws will not be fully removed). Take off the bottom cover. Insert the USB key.
  - Press and hold the fingerprint sensor for 10 seconds until the red light flashes.
  - Release your finger. Red light pulses 3 times, then stays on 1 second – hard reset complete.
- When delivered and after a reset, the lock can be opened with each touch of the sensor.
- For security reasons, the Padlock G1 can only be reset via the HEXFORCE® app (within Bluetooth range) with owner login or by using a USB key. Remote reset is not permitted, even by the manufacturer.

#### Technical data

Product model	G1
Body	Aluminum Alloy
Shackle	Stainless Steel
Size	56x134x30mm
Net	350g
Modes of access	Fingerprint, Bluetooth®
Battery life	Up to 18 months*
Number of fingerprints	40 pcs
App	iOS & Android
Emergency powering	USB-C
Battery type	1 x CR2 battery
Working temperature	-20°C to 60°C / -4°F to 140°F
Waterproof rating	IP67

\*Tested under energy saving mode, 5 times unlocking per day. Actual results may vary depending on use.

#### Warning

- This product contains a 3V CR2 battery.
- This product contains a 3V lithium battery (CR2). Batteries must be kept out of reach of children. Children may put batteries in their mouths and choke, which can cause serious injury. Seek immediate medical attention in such cases.
- Ensure the battery is inserted with the correct polarity (+ and -).
- Empty batteries should be promptly removed or replaced immediately.
- Avoid short-circuiting the battery terminals.
- Exposure to expired or damaged batteries may result in chemical burns! In such instances,

wear appropriate protective gloves and wipe the battery compartment with a dry cloth.

- Do not disassemble, puncture, physically damage, short-circuit, heat, or expose the batteries to open flames.
- Avoid using the lock in areas requiring quick or emergency access, such as medicine cabinets, defibrillator cabinets, chains, weapon storage, emergency doors, and similar locations. In stressful situations, sweaty fingers may hinder or prevent fast access.
- Avoid using or storing the product in environments where temperatures may fall below -20°C or rise above +60°C.
- This device is intended exclusively for its designated use. Any alterations or unauthorized modifications are not permitted.
- The fingerprint sensor is a sensitive component and should always be kept clean and free from grease to ensure optimal function.
- Finger injuries or skin abrasions may result in the fingerprint affected not being recognised.
- HEXFORCE® products are carefully designed and tested in accordance with applicable standards. This limited warranty covers defects due to materials or manufacturing only. If such a defect is confirmed, the product will be repaired or replaced at our discretion within the original warranty period.
- The warranty excludes damage from external factors (e.g. transport, misuse, wear and tear) or failure to follow the instructions. To make a claim, please return the product with proof of purchase and a brief description of the issue.
- HEXFORCE® brand holding company is not liable for printing or typographical errors.

#### ISED Statement

This device contains licence-exempt transmitters/receivers) that comply with Innovation, Science and Economic Development Canada's licence-exempt RSS(s). Operation is subject to the following two conditions:

- This device may not cause interference.
- This device must accept any interference, including interference that may cause undesired operation of the device.

Cet appareil contient un émetteur / récepteur sans licence conforme au RSS sans licence d'innovation, science et développement économique Canada.L'opération doit satisfaire aux deux conditions suivantes:

Cet équipement peut ne pas causer d'interférence.

L'équipement doit accepter toute interférence, y compris toute interférence qui pourrait entraîner un fonctionnement indésirable de l'équipement.

L'appareil a été évalué pour répondre aux exigences générales d'exposition aux RF. L'appareil peut être utilisé dans des conditions d'exposition portable sans restriction.

Cet équipement doit être installé et utilisé avec une distance minimale de 20 cm entre le radiateur et votre corps.

#### FCC Warning Statement

This equipment has been tested and found to comply with the limits for a Class B digital device, pursuant to part 15 of the FCC Rules. These limits are designed to provide reasonable protection against harmful interference in a residential installation. This equipment generates, uses and can radiate radio frequency energy and, if not installed and used in accordance with the instructions, may cause harmful interference to radio communications. However, there is no guarantee that interference will not occur in a particular installation. If this equipment does cause harmful interference to radio or television reception, which can be determined by turning the equipment off and on, the user is encouraged to try to correct the interference by one or more of the following measures:

- Reorient or relocate the receiving antenna.
- Increase the separation between the equipment and receiver.
- Connect the equipment into an outlet on a circuit different from that to which the receiver is connected.
- Consult the dealer or an experienced radio/TV technician for help.

Caution: Any changes or modifications to this device not explicitly approved by manufacturer could void your authority to operate this equipment.

This device complies with part 15 of the FCC Rules. Operation is subject to the following two conditions:

- (1) This device may not cause harmful interference, and
- (2) this device must accept any interference received, including interference that may cause undesired operation.

The device has been evaluated to meet general RF evexposure requirement.

#### FCC Radiation Exposure Statement:

This equipment complies with FCC radiation exposure limits set forth for an uncontrolled environment.

This equipment should be installed and operated with a mininum distance of 20 cm between the radiator and your body.



FCC ID : 2BP5B-G160ML IC : 34102-G1  
© 2025 HEXFORCE® is registered trade mark of ANDAZHI (Shanghai) Security Technology Co., Ltd.

<https://hexforce.ai2safety.com>  
 [hexforce\\_support@ai2safety.com](mailto:hexforce_support@ai2safety.com)