

# 85x125

## LED EAVES LIGHTS

User Manual/ YM2025-1

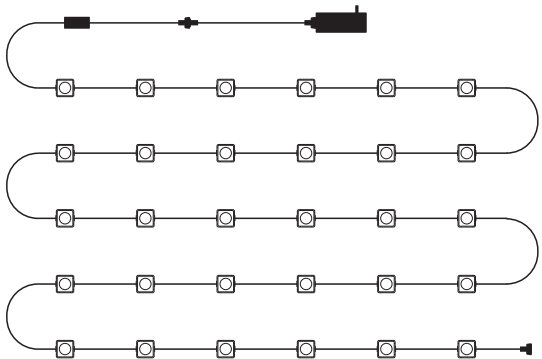

Please read this manual carefully before using the product, and keep it for records properly.



### Remote Control Description

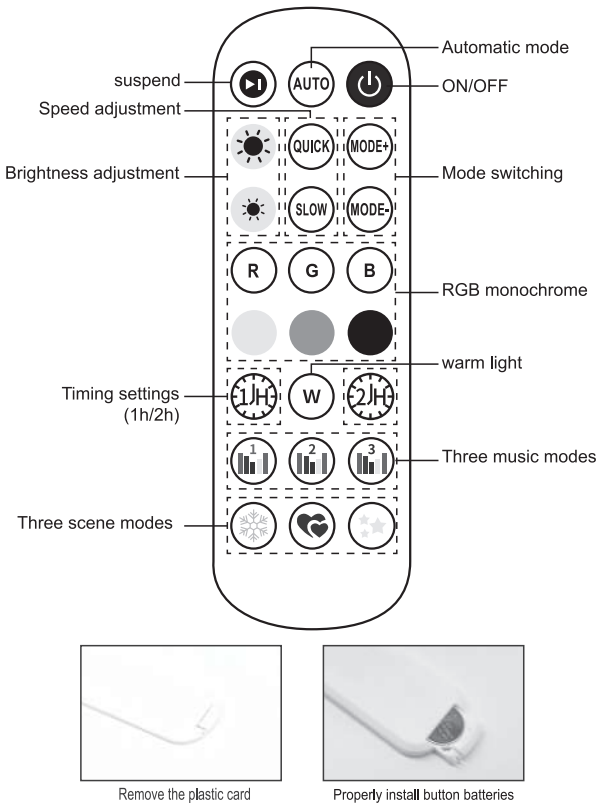

### Installation steps

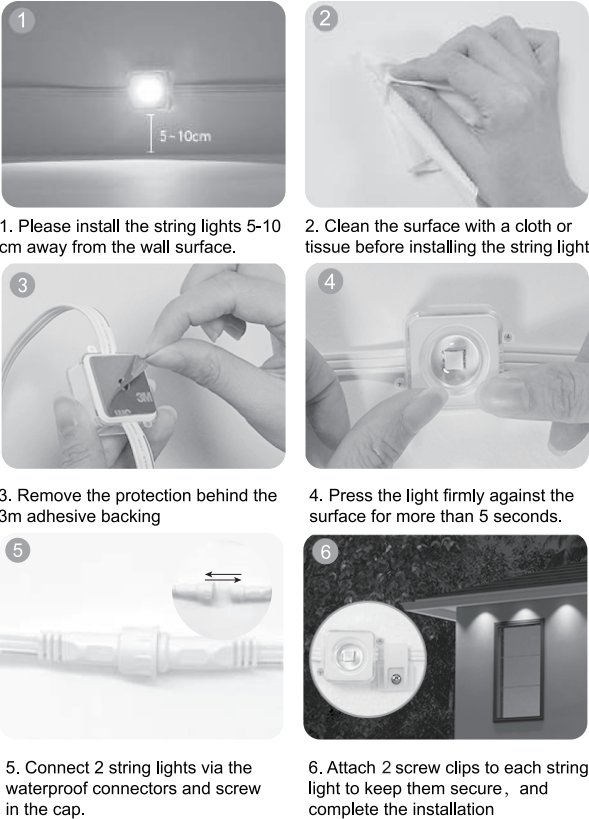

### Technical Parameters

model	YM2025-1
Product size	30.15x30.15mm
Input voltage	DC 12V/24V
Lamp power	1W
working voltage	DC 12V/24V
LED type	RGB 5056 LED
LEDs number	1
Color temperature	RGB addressable
Waterproof grade	IP67
Shell body material	ABS+PC
Beam angle	≥140°
Lifespan	≥50000h

Download and Install the “MOCMO HOME ” APP



Scan the QR-Code to download the APP or search for “ MOCMO HOME ” on Google Play or APP store to download it.

This APP support Android 4.3 above / IOS 8.0 above.

Click the "MOCMO HOME" icon to launch the APP

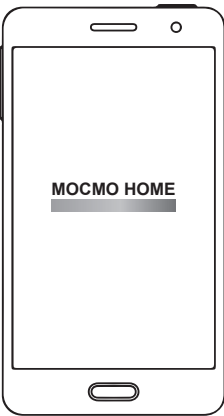

Click “Allow” to enable your Bluetooth.

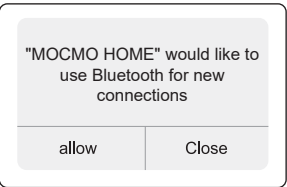

Switch to color and brightness interface:

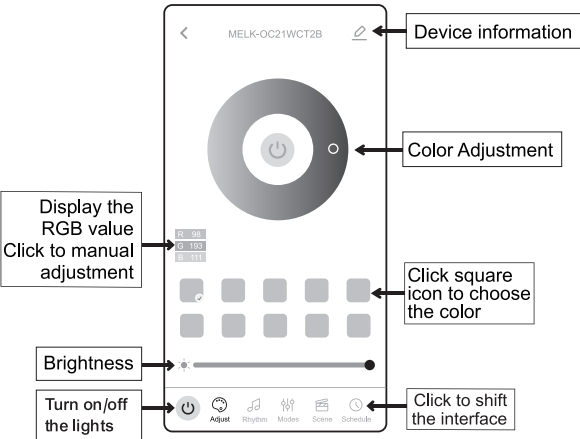

Switch to the microphone Mode

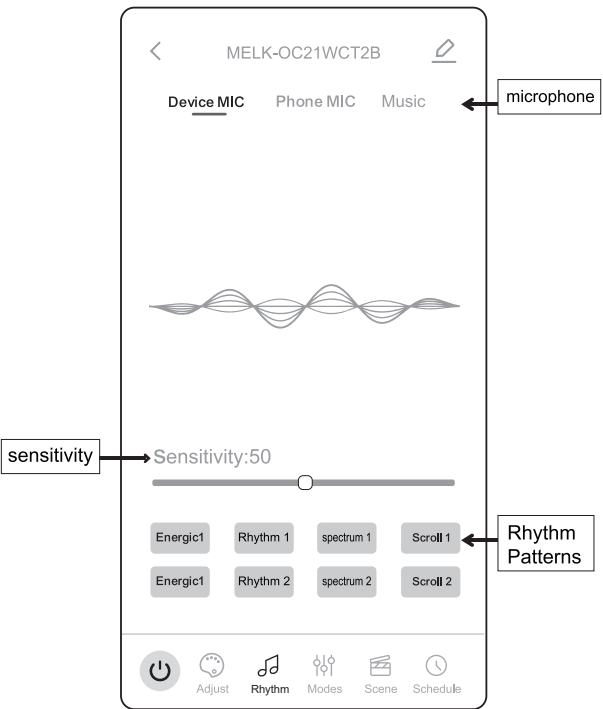

Switch to the Style Modes

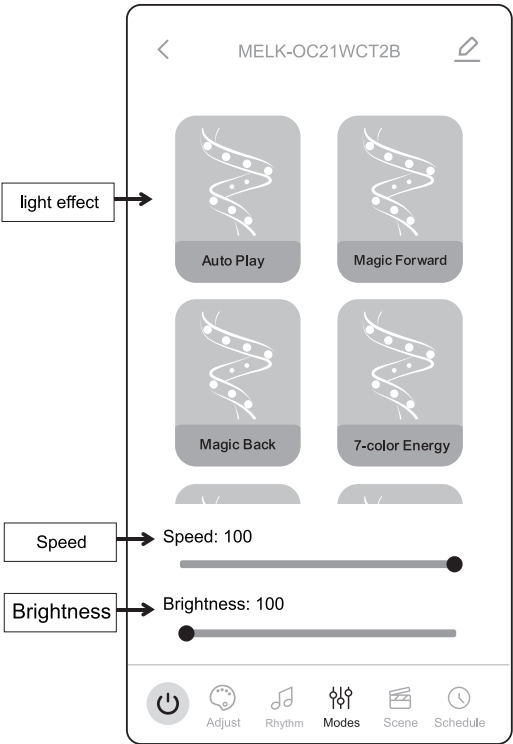

Personalized customized lighting

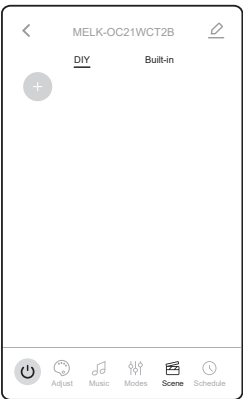

Built in atmosphere effect

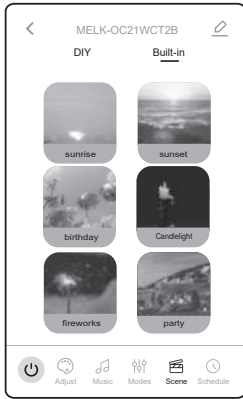

Switch to the schedule Mode

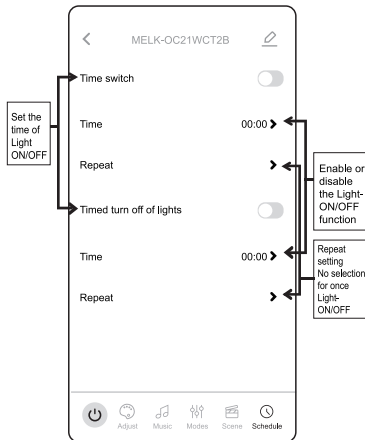

Download local music on Iphone

1. Install iTunes software on your computer(Apple or Windows)
2. Log in to iTunes with the same Apple ID account on Iphone
3. Use iTunes to import downloaded music files on your computer
4. The imported music files will be synchronized to Iphone in real time
- 5.Restart MOCMO HOME and switch to Music mode to see the newly imported music files

This device complies with Part 15 of the FCC Rules. Operation is subject to the following two conditions: (1) this device may not cause harmful interference, and (2) this device must accept any interference received, including interference that may cause undesired operation

NOTE: This equipment has been tested and found to comply with the limits for a Class B digital device, pursuant to Part 15 of the FCC Rules. These limits are designed to provide reasonable protection against harmful interference in a residential installation. This equipment generates, uses and can radiate radio frequency energy and, if not installed and used in accordance with the instructions, may cause harmful interference to radio communications. However, there is no guarantee that interference will not occur in a particular installation. If this equipment does cause harmful interference to radio or television reception, which can be determined by turning the equipment off and on, the user is encouraged to try to correct the interference by one or more of the following measures:

- Reorient or relocate the receiving antenna.
- Increase the separation between the equipment and receiver.
- Connect the equipment into an outlet on a circuit different from that to which the receiver is connected.
- Consult the dealer or an experienced radio/TV technician for help.

Warning: changes or modifications not expressly approved by the party responsible for compliance could void the user's authority to operate the equipment

The device has been evaluated to meet general RF exposure requirement, the device can be used in portable exposure condition without restriction