

# ROBOTIC POOL CLEANER

## User Manual

X1

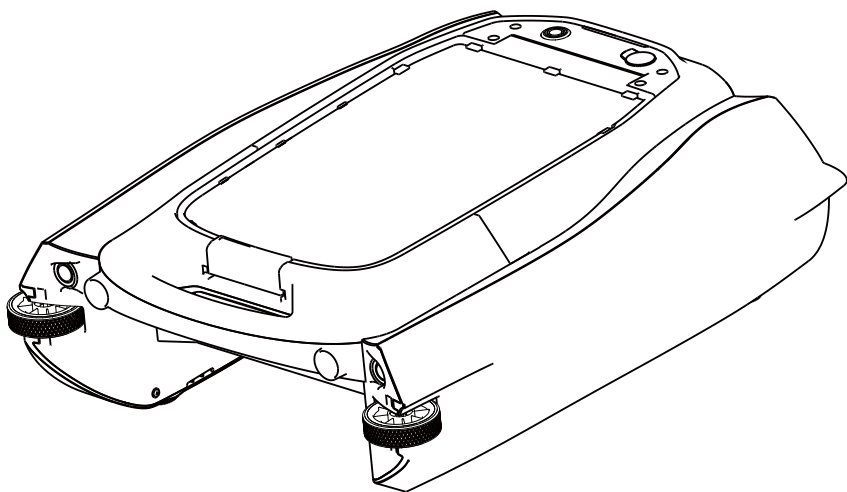

1 Full Charge = **50Hours**  
100%      Cleaning



## FCC Statement

**Note:** This equipment has been tested and found to comply with the limits according to Part 15 of the FCC Rules of a Class B digital device. These limits are designed to provide reasonable protection against harmful interference in a residential installation. This equipment generates, uses, and can radiate radio frequency energy and, if not installed and used in accordance with the instructions, may cause harmful interference to radio communications or persons. However, there is no guarantee that interference will not occur in a particular installation. If this equipment does cause harmful interference to radio or television reception, the user is encouraged to try to correct the interference by one or more of the following measures:

- Reorientate or relocate the receiving antenna.
- Increase the separation between the equipment and receiver
- Plug the equipment into an outlet on a circuit different from that to which the receiver is connected
- Consult the manufacturer or an experienced radio/TV technician for help.

## Warning

Changes or modifications of this product are not expressly approved by the party responsible for compliance (LOGO), and unauthorized modifications could void the user's authority to operate the equipment.

## Compliance Declaration

This device complies with Part 15 of the FCC Rules. Operation is subject to the following two conditions: (1) this device may not cause harmful interference, and (2) this device must accept any interference received, including interference that may cause undesired operation.

Thank you for choosing LOGO.

This user manual will help you maintain your LOGO pool cleaner and ensure it performs at its maximum efficiency for years to come. Please take a few minutes to read through this manual.

If you have any questions, please visit our website at [www.LOGO.com](http://www.LOGO.com) and contact our customer service team for assistance or more information.

 WhatsApp: +XXXXXXX

 Email: [service@XXXXXX.com](mailto:service@XXXXXX.com)

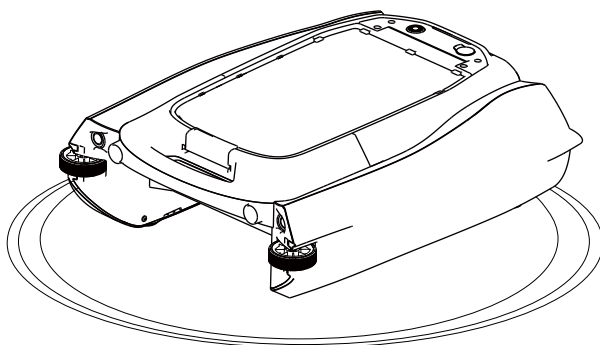

# CONTENTS

Important Safety Precautions -----	4
1. Structure -----	5
2. Specifications & Working Conditions -----	6
3. Charging -----	6
4. Using Your LOGO Pool Cleaner -----	8
5. Operating Your Device -----	8
6. Screen Display Introduction -----	10
7. Clock Setting and Scheduled Cleaning Setting -----	11
8. LED Indicator -----	12
9. Disassembly and Cleaning -----	13
10. Cleaning and Storage -----	15
11. Troubleshooting -----	16
12. Packing List -----	17
13. Warranty -----	17



## Important Safety Precautions

Please read this manual carefully and use your logo pool cleaner in accordance with the manual instructions. logo is not liable for any losses or injuries caused by improper use of this device.

**For your safety and optimal performance of this device, please read and follow the following suggestions.**

1. Do not operate your logo pool cleaner while people or animals are in the pool.
2. Turn the cleaner off while not in use or while performing maintenance.
3. Do not allow children to ride the LOGO pool cleaner under any circumstances. Please supervise children when they are around an operational logo pool cleaner.
4. Use only authorized logo power adapters.
5. The adapter cord should only be replaced by a qualified electrician or LOGO Customer Care.
6. It's suggested to plug the power adapter into a power strip or surge protector and not directly into an electrical outlet.
7. Ensure your device is powered off and the charging port is dry before charging. While charging, your logo pool cleaner should be kept in a cool place. Do not cover your LOGO pool cleaner while charging as this may cause components to overheat.
8. Please store the machine indoors or in a cool place when not in use.
9. Do not run your logo pool cleaner out of the water as it may lead to overheating.
10. Only certified professionals should disassemble the sealed driving kit of your LOGO pool cleaner.
11. Do not operate your logo pool cleaner and pool filter simultaneously.
12. The oil sealing around the motor contains grease, which may cause a small amount of water pollution if the motor is damaged. If you believe there is a leak, stop using the unit immediately.
13. Do not pierce the shell of your logo pool cleaner, throw, or damage the cleaner intentionally.
14. When putting your device into the water, the front of the machine must face upwards and should never be placed upside down or directly thrown into the swimming pool.

Please read this user manual carefully before operating the device.

1. Structure

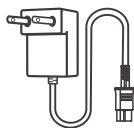
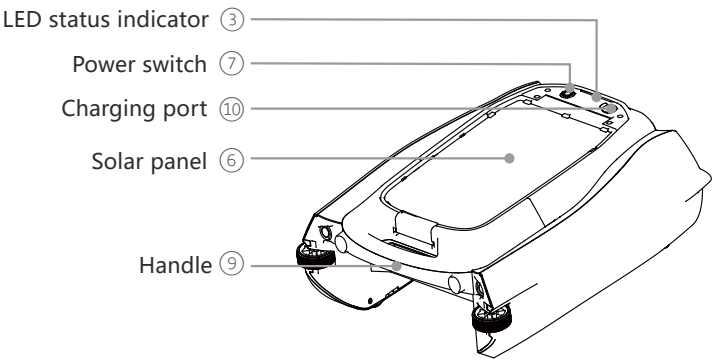
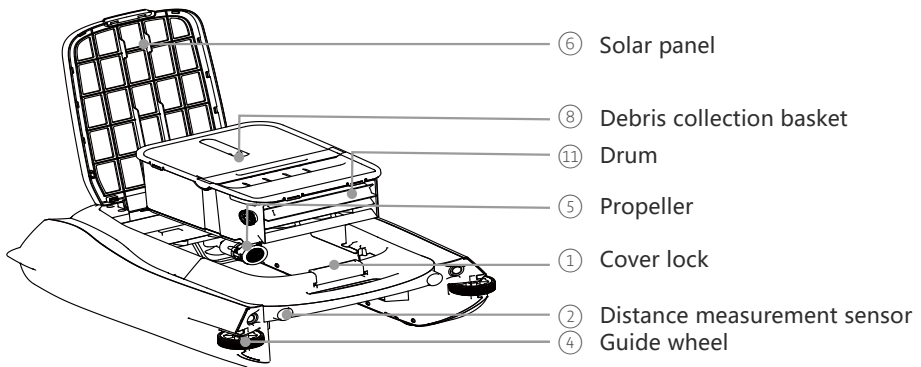

Charger

## 2. Specifications & Working Conditions

1. Pool Size: 1722 Sq.ft /160m<sup>2</sup>
2. Charger Input: 100~240VAC
3. Charger Output: 12V/1A
4. Charging Time: 5-8 hours (adapter charging)
5. Working Hours: 12-50 hours (depends on the sunny condition)
6. Battery Life: 500 cycles, at least 70% capacity
7. IP Grade: IPX8 waterproof
8. Water Depth: less than 0.5 meters
9. Motor Power: 1.5w
10. Battery Pack: 5200mAh
11. Battery Pack Voltage: 7.2V

## 3. Charging

### Charging Method

1. Open the charging port cover.
2. Turn off the device.
3. Align the charger tail connector with the charging port and insert it.
4. Plug: When charging, the indicator light turns on blue and breathing, and the machine will start charging.
5. When the charging indicator light turns blue and is solid, it means that it is fully charged and the adapter can be removed.
6. After charging, remove the adapter and put on the waterproof cover in time to prevent water from entering the charging port and affecting the charging effect.

When fully charged, the robot machine can operate continuously for up to 50 hours without sunlight. With sufficient sunlight, it takes 5-8 hours to recharge completely.

### Adapter precautions

1. The power adapter must be turned off when charging;
2. When charging with the adapter, the battery takes 5-8 hours to fully charge;
3. Do not charge for a long time;
4. Please use the original adapter for charging;
5. Please try to keep the body dry when charging;
6. Keep away from children when charging.

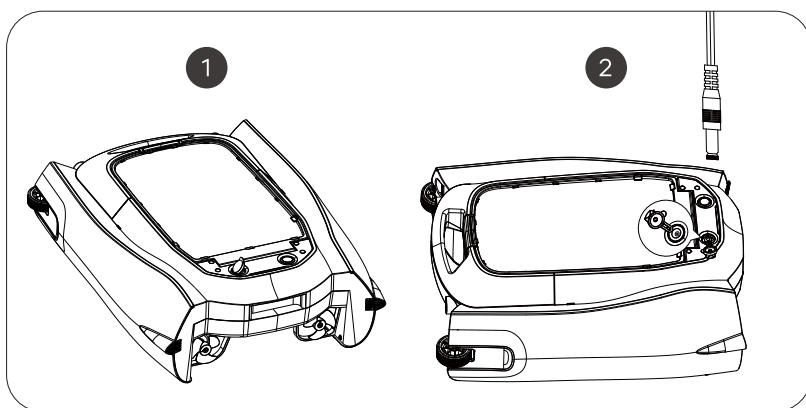

### Battery Runtime and Charging Times During the Fall and Winter

During the fall and winter, sunlight strikes the Earth at a shallower angle. These rays are more scattered, which results in less energy striking any given point. In addition, the long nights and short days prevent the X1's solar charging feature from being used as well as it should be. Therefore, you should expect the X1 Pool Cleaner to run for a shorter time than it would in the summer.

The smart pool cleaning robot can be charged by solar panels or an adaptor.

Solution 1: Use the Power Adapter (included in the package)

Solution 2: If the weather is bad, remove the robot from the pool and charge it outside the pool when the outdoor temperature is no less than 68 degrees Fahrenheit (20 degrees Celsius). Place the device against a wall at a 45-degree angle directly facing the sun with the power switch on, and let it charge throughout the day, changing positions as the sun moves.



## 4. Using Your logo Pool Cleaner

- a. This machine is suitable for cleaning floors, walls and water lines in areas up to 1722sq. Ft./160m<sup>2</sup>.

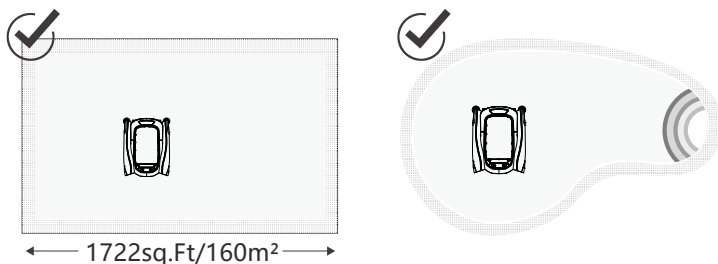

## 5. Operating Your Device

The machine can work as automatic mode and can also be controlled by a remote control.

If you are using solar panel charging, the power switch must be turned on.

If it does not work properly when you pair it, please check whether the power is sufficient. If the power is insufficient, please use the adapter to charge it and then turn it on. Be sure to keep it balanced with the pool surface when using it.

### a. Automatic mode

- Step 1: Press the power switch position to turn on the whole machine;  
The LED status indicator on the panel is steady blue, and the propeller and impeller will start to run;
- Step 2: Put it in your pool, and then it will start to move and clean up and collect the debris of the pool;

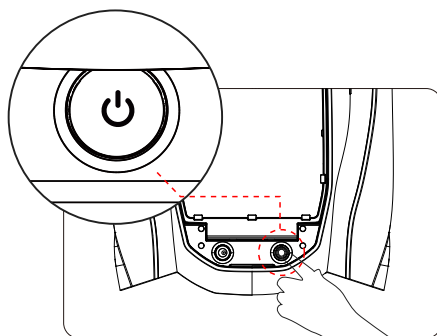

## b.Remote Control Mode

Pairing X1 with a new remote-control unit.

Your robot has been configured with a dedicated remote control by the factory. You can use it immediately after pairing successfully.

Press any button on the remote control, the X1 will immediately enter the remote control mode.

The following are instructions for using the remote control:

Remote Control Instructions

The remote control needs to be paired with the host for the first time

1. Turn on the power of the host.
2. Press and hold the "AUTO" and "automatic docking buttons" at the same time within 30 seconds.
3. The indicator light on the host flashes 8 times to indicate successful pairing.

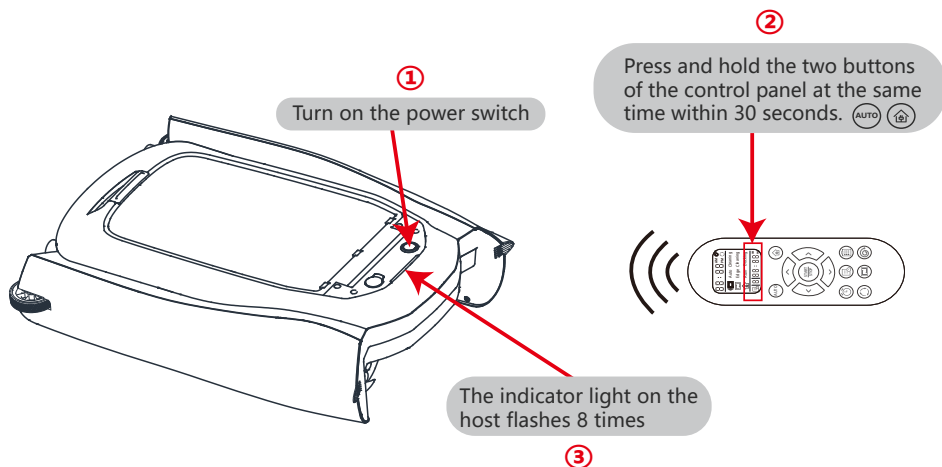

## 6. Screen Display Introduction

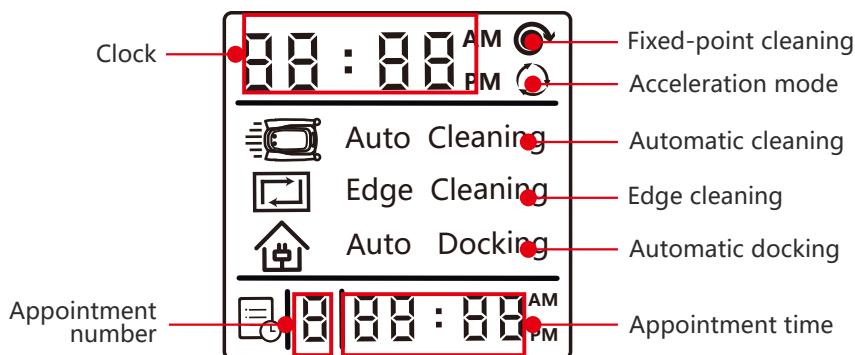

## Button Function Introduction

Button	Mode	Function
	Automatic cleaning	The machine automatically cleans the pool according to the planned path
	Automatic docking	The machine automatically finds the edge of the pool and docks
	Automatic/stop	The machine automatically cleans/stops the task
	Manual control	Manually controls the machine to move forward, backward, turn left, and turn right
	Clock setting	Used to set the current time
	Appointment setting	Used to set an appointment and clean the pool at a scheduled time
	Appointment query	Used to query the appointment time
	Acceleration mode	The machine cleans the pool at a faster speed
	Edge cleaning	The machine cleans the pool along the edge of the pool
	Fixed point cleaning	The machine cleans the pool in a small area centered on the current location

## 7. Clock Setting and Scheduled Cleaning Setting

### 1. Clock Setting (synchronize with local time):

Press the clock setting button → Use the up and down buttons to adjust the time, and the left and right buttons to switch between hours and minutes. → After adjusting the clock, press the clock setting button again to confirm the setting → The clock setting is complete.

### 2. Scheduled Cleaning Setting:

- (1) Use the appointment query button to switch to the appointment number that you aim to set.
- (2) Press the appointment setting button
- (3) At this time, you can use the up and down buttons to adjust the time, and use the left and right buttons to switch between hours and minutes
- (4) After adjusting the time you want to reserve, press the reservation setting button again to confirm the setting.

### Additional Notes:

- (1) When using the Scheduled Cleaning function, please make sure that the clock time is synchronized with the local time.
- (2) The remote control can set the cleaning tasks for 4 time periods.
- (3) Press the appointment query button to switch between the 4 appointment time periods.
- (4) Long press the appointment setting button to cancel the appointment for the time period currently displayed on the screen.
- (5) For each appointment time period, when the appointment time arrives, the machine will automatically clean for about 3 hours.
- (6) If the user has set the cleaning time in advance, the machine will start cleaning at the set time after it is turned on.

## 8. LED Indicator

Light Status	Mode Status	Description
Blue light steady on	Standard Mode	Power is available, the unit will continue to operate
Blue light flashes slowly	Intermittent Mode	Battery is low, unit is running erratically. Please try to charge it under sunlight or using an adaptor
All Lights Off	Sleep Mode	Power off, low battery, or fully discharged; or the machine is out of the planned cleaning time
Blue indicator light is breathing	Remote Mode	The unit is charging with the adapter
Orange light flashes quickly	Stripe Mode	The unit is not working properly in the propeller or impeller, the unit is stuck, or the obstacle avoidance sensor is abnormal and cannot run freely. In this case, it will automatically stop running.

## 9. Disassembly and Cleaning

- a. Set aside the device in a safe, secure location and open the top shell.

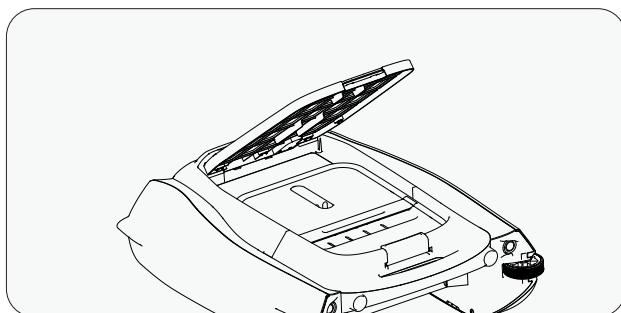

- b. Remove the filter basket by lifting its handle.

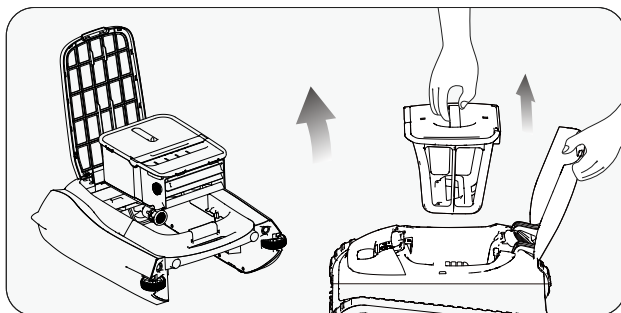

- c. Press the top shells latch of the filter basket and at the same time pull up on the top cover handle to open the filter basket.

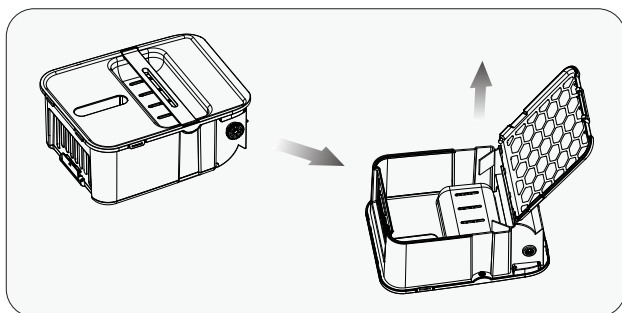

- d. Empty the filter basket, rinse, and replace the filter basket back into the device.

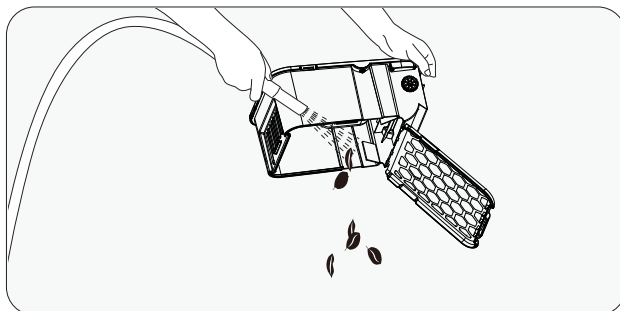

## 10. Cleaning and Storage

Always make sure the machine is balanced against the pool surface while it is running.

Make sure to clean the collection basket every 2-3 days to keep the X1 running efficiently.

- (1) Use the remote control to press the "Auto-Dock" button to let the machine automatically approach the shore so that you can safely pick up the pool cleaner.
- (2) Keep your balance when you use two hands to lift it, one on the front handle and the other on the lifting handle at the rear to prevent debris from falling out of the basket. Place it on a flat surface to operate.
- (3) Turn the power switch off.
- (4) Unlock the lid lock. Lift the basket upwards, remove the basket from the machine, and empty the debris.
- (5) Rinse the basket with a hose to keep it completely clean.
- (6) Return the collection basket to the unit, secure the lid lock, and turn the power on.
- (7) When cleaning the hanging basket, you can also clean the plastic panel. You may see some white residue on the solar panel, which is from the chemicals and minerals in the pool water. Rinse the residue with a hose and wipe it clean with a soft cloth. Do not use a pressure washer to clean it, or use any tool to scratch the panel to avoid damage.

### Winter and long-term storage

If you close your pool for the winter, remove the X1 pool cleaner and rinse it with a hose until it is completely dry. Place it indoors and dry it away from high temperatures. Before using it for the first time in the next season, check all parts for signs of damage. If it is normal, charge it and use it.



## 11. Troubleshooting

Note: The machine can only be charged by solar energy when the power button is turned on.

Problem	Possible Cause	Solution
Machine failure	Scenario 1: Sleep state - Status light is off, indicating low battery level or completely discharged.	<ul style="list-style-type: none"> <li>* Take the machine out of the pool. After sunrise the next day, the unit will start running at intervals after being charged by the solar panel;</li> <li>* Try to expose the unit's solar panel with good sunlight so that it can recharge;</li> <li>* You can also charge manually using the power charging adaptor</li> </ul>
	Scenario 2: Low battery state - the status light flashes slowly in blue, indicating that the battery is low	You can leave it in the pool and try to charge it in a sunny place and run it at interval
	Scenario 3: stranded state - The orange light flashes quickly, indicating that the machine is stuck on some structure, such as stairs, stools, or the propeller/impeller.	<ul style="list-style-type: none"> <li>* The built-in software will try to restart every 20 minutes in this state;</li> <li>* Make sure the basket is in place and that the cover lock is properly secured</li> <li>* Check the propeller and impeller for dirt, or rope and hair entanglement, etc.</li> </ul>
	Scenario 4: The machine is in unplanned operation time	You can use the remote control to press the "Auto Clean" button to start the machine cleaning operation.
Only works when there is enough sunlight, insufficient runtime	(1) There is residue on the solar panel. (2) The impeller or impeller is bound	<ul style="list-style-type: none"> <li>* Clean the solar pane.</li> <li>* Ensure the propeller and screw can turn freely.</li> <li>* Use the power adapter to charge.</li> </ul>
Keep the cycle moving	One or more propellers are stuck, causing the unit to run unbalanced.	Inspect propellers and impellers for dirt, rope, and hair.
Cannot be controlled remotely	If the light on the remote control does not illuminate when any button is pressed, the remote control batteries are low.	Replace the remote control batteries (2x AAA)
	The remote control is not paired with the X1.	Pair the remote control
	The X1 may be in sleep mode when the batteries are charged or completely discharge	When the fluorescent light is available, the device will exit the sleep mode and can then be controlled remotely; . Use after charging with the power adapter.

No power or shorter running time in autumn and winter	The sunlight angle and efficiency are low, and the duration of sunlight exposure is shorter.	If the weather conditions are not good, you can leave the water and place it at an angle facing the sun. At the same time, keep the power button on at all times. See the manual for 4.5 (battery runtime and fall/winter charging) and 4.6 (charging adapter instruction)
---	--	--

## 12. Packing List

NO.	Name	Model	QTY(pc)
1	Cleaner	X1	1
2	Charger	/	1
3	User Manual	/	1

## 13. Warranty

This product has passed quality control and safety test conducted by our technicians.

1. This product comes with a 24-month warranty that covers your item's battery and motor from the date of purchase.
2. This warranty is voided if the product has been altered, misused, or has been repaired by unauthorized persons.
3. This warranty extends only to manufacturing defects and does not cover damage resulting from the mishandling of the product by the owner.
4. The order number or record of purchase must be presented at the request of any repair claim during the warranty period.