

尺寸: 100x100mm

5 in 1 Wireless Charger

(Only for Pixel Watch 3/2)

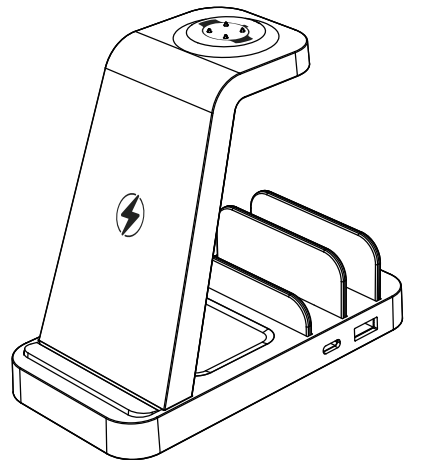

User Manual

Before use, please read this user manual carefully and keep this manual in a safe place for future reference.

Model:G807

Wireless Charger Guide

※Please use the Included DC Power Port Adapter



⊗With Metal Ring



⊗With Ring Stand

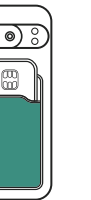

⊗With Credit Cards



⊗With Magnetism

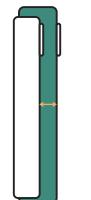

⊗Phone Cases≥5MM



▲Protective Case of Earbuds May Cause Unstable Charging

Proper Charging Tips

▲For foldable phones such as Pixel 9 Pro Fold / Pixel Fold... must be charged horizontally.

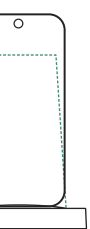

✔Put your devices on the center of the charger



⊗Do not place your devices on the edge



✔Devices place without gaps

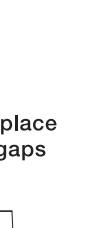

⊗Devices place gaps too large

Introduction:

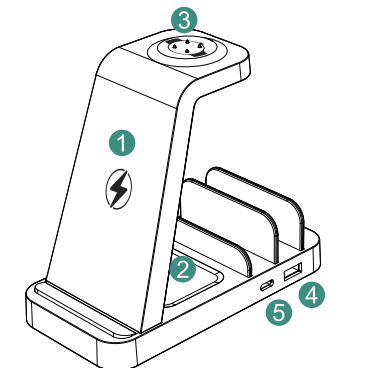

- 1 Wireless charging area of mobile phone.
- 2 Charging area of Earbuds.
- 3 Wireless charging area of watch.
- 4 USB-A output port.
- 5 USB-C output port.
- 6 DC power input port.
- 7 Operating indicator.

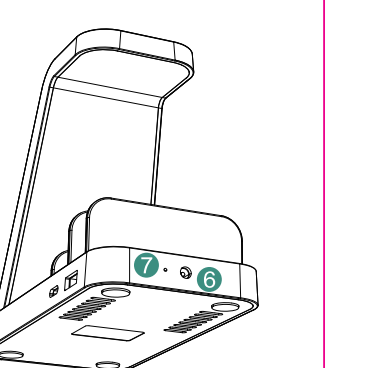

1.Charging the Pixel Watch 3/2: Place the watch in the wireless charging area according to the silkscreen direction and align it with the magnets. The "Charging Indicator Light"on the watch will light up, indicating that it is charging properly.

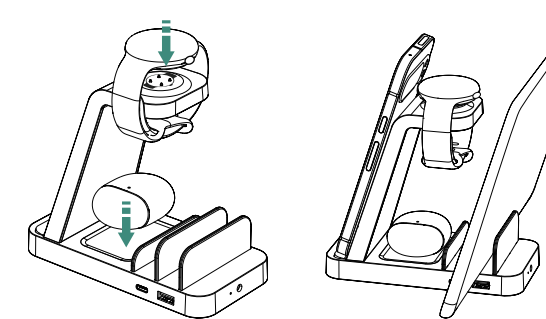

2.Charging the Earbuds: Please put the earbuds at the center of the charging area (Attention:A thick protective case on the charging compartment may cause poor contact and prevent charging. Please remove the case before charging.)

3.When plugged in with 12V-3A DC adapter, the blue LED light blinks 3 times. In standby mode, the light goes out. When the cell phone is charging: the blue indicator lights for 5s and then turn off. Indicator light goes out when fully charged Indicator light blinks when sensed by a foreign object/FOD.

Compatibility

1) For Phones:

- ①Google Pixel 9 Pro/9 Pro XL/9a/9/8 Pro/8a/8/7 Pro/7a/7/6 Pro/6/5 /4/4 XL/3/3 XL. When charging your Pixel 9 Pro Fold, please position the phone horizontally (Not for Pixel 6a/5a/4a/3a/2a)
- ②latest model of Google Phones that supports Qi wireless charging;
- ③Other Brand of phones support Qi wireless charging protocol (e.g. Samsung, iPhone and other Android devices)

2)For Google Pixel Watches:

- ①Google Pixel Watch 3(41mm and 45mm)/Pixel Watch 2
- ②Fitbit Versa 4/3/Sense 2/Sense (Not for Google Pxiel Watch 1st)

3)For Earbuds:

- ①Google Pixel Buds Pro/2
- ②Other Qi standard Earbuds charging devices.

4)For iPad/Tablet

- ※Included Type-C and Lighting to Charge Your iPad or Tablet
- ①iPad Pro 5th/iPad Pro 4th/iPad Pro 3th/iPad Pro 2th/iPad Pro
- ②iPad Air 7th/iPad Air 6th/iPad Air 5th/iPad Air 4th/iPad Air 3th/iPad Air 2th/iPad Air
- ③iPad mini 7th/iPad mini 6th/iPad mini 5th/iPad mini 4th/iPad mini 3th/iPad mini 2th/iPad mini

- ④Galaxy Tab S9 Ultra/ Galaxy Tab S9+/S9/S9 FE/S9 FE+
- ⑤Galaxy Tab S8 Ultra/S8+/S8/
- ⑥Galaxy Tab S7 FE/S7/S7+
- ⑦Galaxy Tab A9+/ Galaxy Tab A8
- ⑧Pixel Tablet/Pixel Slate/Pixel C (Also support the latest tablets/phones/earbuds, etc. that can be charged with typec or lightning ports.)

Specifications

Input	12V-3A	Output	36W(Max)
Phone Output	15W/10W/7.5W/5W	USB-A(1 Port Charging)	9V-2A(MAX)
Watch Output	3W	USB-C(1 Port Charging)	9V-2A(MAX)
Earbuds Output	5W	USB-A+USB-C simultaneously	5V=3.4A(MAX)
Package Included	5 in 1 Wireless Charger		
	36W DC Adapter		
	Charging Cable*3(Type A-C/Type C-C/Lightning)		

Q&A:

Q:Why is there heating in the charging of wireless charging inductive products?

A:During the charging process, there will be a certain loss of magnetoelectric conversion, which will be converted into heat, causing the mobile phone and charger to generate heat, which is a normal phenomenon.

Precautions

1. Only use certified 36W or higher DC Power Port Adapter to charge the device, do not plug into computer USB port or any other non-certified USB port.
2. Make sure to disconnect the device from power when cleaning. Do not plug or unplug electrical appliances with wet hands or your safety. Do not expose the wireless charger to rain or snow.
3. It is normal and safe to hear a humming noise when very close to the charger. It means that this wireless charger is adjusting its temperature to achieve a more efficient charge-ing speed.
4. If your device can not be fully charged, this may due to high environmental temperature, please recharge after the temperature is lowered. Our charger has temperature control to safeguard your device when charging.
5. Do not store device in high-temperature environment, including heat caused by intense sunlight or other forms of heat.
6. Do not place device in fire or other excessively hot environments. Exposure to fire or temperature above 212°F(100C) may cause explosion.
7. Do not use the wireless charger in excess of its output rating. Over loading outputs above rating may result in a risk of fire or injury to persons.
8. Do not place in a place easily accessible to infants and young children;
9. Do not modify, repair or disassemble the unity, if so, please contact the manufacturer. Switch off the wireless charger when not in use. The wireless charger will automatically switch off when disconnected from its wall charger.



FCC Warning

This device complies with part 15 of the FCC Rules. Operation is subject to the following two conditions:(1) This device may not cause harmful interference, and (2) this device must accept any interference received, including interference that may cause undesired operation.Any Changes or modifications not expressly approved by the party responsible for compliance could void the user's authority to operate the equipment.

This equipment has been tested and found to comply with the limits for a Class B digital device, pursuant to part 15 of the FCC Rules. These limits are designed to provide reasonable protection against harmful interference in a residential installation. This equipment generates uses and can radiate radio frequency energy and, if not installed and used in accordance with the instructions, may cause harmful interference to radio communications. However, there is no guarantee that interference will not occur in a particular installation. If this equipment does cause harmful interference to radio or television reception, which can be determined by turning the equipment off and on, the user is encouraged to try to correct the interference by one or more of the following measures:

- Reorient or relocate the receiving antenna.
 - Increase the separation between the equipment and receiver.
 - Connect the equipment into an outlet on a circuit different from that to which the receiver is connected.
 - Consult the dealer or an experienced radio/TV technician for help.
- FCC RF exposure statement:
The equipment complies with FCC radiation exposure limits set forth for an uncontrolled environment. This equipment should be installed and operated with minimum distance between 20cm the radiator your body.