

# User Manual

Version 1.0 CN

## Folded wing



Please install the protector first to protect the motor and prevent injury to others.

## Replace rotor blade

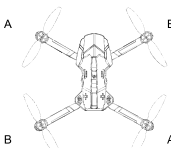

Please make sure that it is installed correctly, otherwise it will not be able to fly normally.

## Transmitter

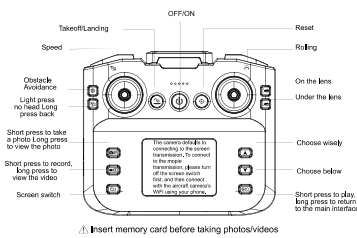

## Install battery for aircraft and transmitter

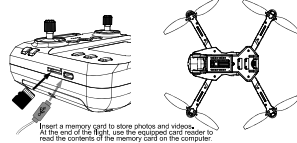

## Remote control charging

1. Insert the charging cable into the charging port.  
2. Connect the other end of the USB charging cable to the USB port on the computer. The indicator on the charging port on the remote control indicates that charging starts. When the charging cable is full, the indicator turns off.

## Aircraft lithium battery charging

1. Remove the battery from the aircraft.  
2. Insert the battery into the USB charging cable.  
3. Insert the other end of the USB charging cable into the USB port of the computer, and the red light on the USB charging cable will light up, indicating the start of charging.

Tips: please remove the battery from the USB charging cable when the battery is charged completely.  
Light on: Charging  
Light out: Complete

## Altitude hold function

After using the left joystick (Accelerator) to control the ascending/descending flight of the aircraft, free up the left joystick (Accelerator) and the aircraft will still hover at that height when the joystick is free.

Tips: the first push the left joystick up to start the motor, it doesn't make the aircraft fly; the second push the left joystick up to let the aircraft rise.

## Take off process

1. Ensure that the batteries on the aircraft are fully charged;  
2. Install the battery into the aircraft, press the power button on the top, and the blue light flashes to indicate normal connection.  
Place the aircraft on a level ground, and the aircraft warning light will flash, indicating that the aircraft has entered a code checking state;  
3. Press the power button on the remote control, and the blue light flashes to indicate entering the code matching state; Simultaneously press the display screen switch  
4. Turn on the remote control and aircraft switch, and the system will automatically check the code when turned on. If the lights on the aircraft remain on, it indicates that the code check is complete.  
5. Use the remote control joystick or press the reset button to calibrate the gyroscope. After the body light flashes quickly, the calibration is completed.

## Operating direction

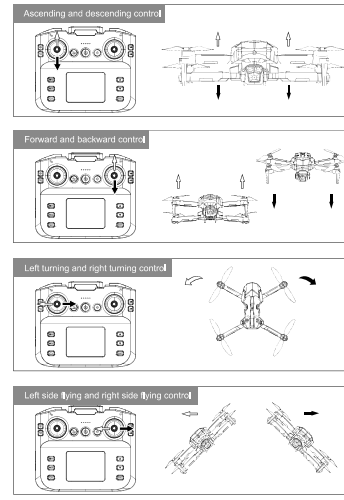

## Horizontal calibration

When the aircraft is drifting in a certain direction or rotating in place in the air, the horizontal calibration function can be used to calibrate the aircraft. Place the aircraft on a horizontal surface, turn the directional lever on the remote control outward, or press the reset button on the remote control. The remote control will emit a beep and the aircraft lights will flash. Wait for about 3 seconds, and the aircraft lights will remain on. Calibration is complete.

## 3D Rolling

The aircraft can perform a 360° roll motion. Firstly, fly the aircraft into the air at an altitude of 2-3 meters, press the button on the right side of the remote control, and the remote control will make a beep, beep, beep sound. Then, push the right joystick on the remote control, and the aircraft will perform a 360° roll motion.

Tips: 3D eversion goes better when battery power is enough

## Headless mode/One click back

No matter which direction the aircraft may rotate to, the flying direction direction will be as per the direction that the decoding is made.

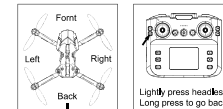

Tips: Before entering into the headless mode, please confirm the forward direction of the decoding

## Low voltage protection

When the aircraft is flying in the air, all indicator lights flashing indicate low battery, indicating an emergency return operation.

Tips: 3D eversion goes better when battery power is enough

## Once click up/One click descent

One click up: Place the aircraft on a level ground and press the one click up button on the remote control. At this time, the aircraft will automatically rise to a height of 1.5 meters.

One click descent: When the aircraft stays in the air, press the one click descent button on the remote control, and the aircraft will automatically land on the ground.

## Obstacle avoidance function



Short press the obstacle avoidance button to turn on or off the obstacle avoidance function

## Lens adjustment

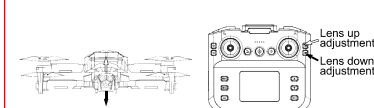

## FCC Warning

This device complies with part 15 of the FCC Rules. Operation is subject to the following two conditions: (1) This device may not cause harmful interference, and (2) this device must accept any interference received, including interference that may cause undesired operation.

Any Changes or modifications not expressly approved by the party responsible for compliance could void the user's authority to operate the equipment.

**Note:** This equipment has been tested and found to comply with the limits for a Class B digital device, pursuant to part 15 of the FCC Rules. These limits are designed to provide reasonable protection against harmful interference in a residential installation. This equipment generates uses and can radiate radio frequency energy and, if not installed and used in accordance with the instructions, may cause harmful interference to radio communications. However, there is no guarantee that interference will not occur in a particular installation. If this equipment does cause harmful interference to radio or television reception, which can be determined by turning the equipment off and on, the user is encouraged to try to correct the interference by one or more of the following measures:

- Reorient or relocate the receiving antenna.
- Increase the separation between the equipment and receiver.
- Connect the equipment into an outlet on a circuit different from that to which the receiver is connected.
- Consult the dealer or an experienced radio/TV technician for help.

The device has been evaluated to meet general RF exposure requirement. The device can be used in portable exposure condition without restriction.