

ENGLISH

User Manual

W1

Specification

- **Model Name:** W1
- **Battery Capacity:** 5000mAh / 3.7V / 18.5Wh
- **Input Power:** USB-C / USB-C Cable: 5V=3A / 9V=2A / 12V=1.5A
- **Output Power:**
 - USB-C / USB-C Cable: 5V=3A / 9V=2.22A / 12V=1.67A
 - Apple Watch / Samsung Galaxy Watch Charger: 5V / 2.5W
 - USB-C + USB-C Cable + Watch Charger: 5V=3A (15W max.)
- **Operating Temperature:** 0°C - 35°C
- **Size:** 86 x 32 x 30 mm
- **Weight:** 109 g
- **1-Year Limited Warranty**
- **Made in China**

*The product can only be used to charge smartphones / earbuds. Please refer to the user manual for instructions and more product information.

FCC Statement

This device complies with Part 15 of the FCC Rules. Operation is subject to the following two conditions: (1) This device may not cause harmful interference, and (2) This device must accept any interference received, including interference that may cause undesired operation.

Warning: Changes or modifications not expressly approved by the party responsible for compliance could void the user's authority to operate the equipment.

NOTE: This equipment has been tested and found to comply with the limits for a Class B digital device, pursuant to Part 15 of the FCC Rules. These limits are designed to provide reasonable protection against harmful interference in a residential installation.

This equipment generates uses and can radiate radio frequency energy and, if not installed and used in accordance with the instructions, may cause harmful interference to radio communications. However, there is no guarantee that interference will not occur in a particular installation.

If this equipment does cause harmful interference to radio or television reception, which can be determined by turning the equipment off and on, the user is encouraged to try to correct the interference by one or more of the following measures:

- Reorient or relocate the receiving antenna.
- Increase the separation between the equipment and receiver.
- Connect the equipment into an outlet on a circuit different from that to which the receiver is connected.
- Consult the dealer or an experienced radio/TV technician for help.

RF warning statement

The device has been evaluated to meet general RF exposure requirement. The device can be used in portable exposure condition without restriction.



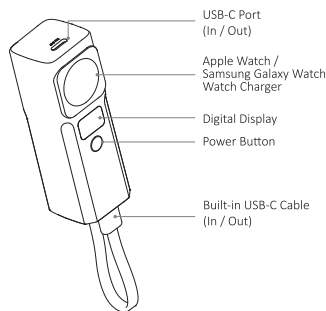

Product Introduction

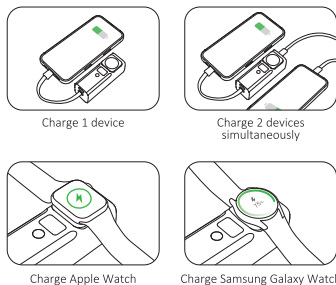

Charging Introduction

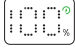

LED Display Introduction

- **Power on**

Press power button once.
- **Power off**

Press power button twice.
- **Fast charging**

The fast charge indicator turns green.
- **Low-current charging mode**
(Support Apple Watch, Samsung Galaxy Watch low-current devices in charging.)

Long press power button. The current battery indicator will blink.
*It will stop after long pressing the power button again.
- **Abnormal warning**

If current and voltage are too high. It will shutdown after the current battery indicator blink 5 times.

Protective Function

- Multiple circuit protection
- Over-current protection
- Short-circuit protection
- Over-voltage protection
- Flame retardant protection
- Over-heat protection

Attention

- Do not expose to liquids
- Do not shake while charging
- Unplug the device when fully charged
- Do not disassemble, puncture, drop, bend or modify
- For the fastest and safest charge, use an ADAM cable, your device's original cable or a certified cable (such as MFI)
- Keep away from children
- Avoid extreme temperatures
- 1 years warranty
- Please scan the QR code on the packaging for the user manual