

### AC POWER CONNECTION:

1. Insert the plug into the port on the back.
2. Plug the AC power cord into an AC outlet.
3. Clock display will light.

### BATTERY POWER:

1. Open the battery compartment on the bottom of the alarm clock .
2. Install 3 x AA batteries ensuring that the battery polarity corresponds to the polarity in the battery compartment.
3. Close the battery compartment cover.

### Specification:

Model: RA01SA  
Power: AC 120V 50/60Hz  
FM Band: 87.5-108 MHZ  
AM Band: 520-1710kHz  
Battery Required: 3\*AA Batteries  
(Battery not included)

### In the Package:

Alarm clock radio \* 1  
User mannual \* 1  
Warranty Card \* 1

- ①When changing batteries, keep AC power connected to save your settings.
- ②Battery only last 12 hours for radio, please keep plug in.
- ③Don' t mix different types of batteries or mix new and used batteries or mix different brand batteries.
- ④When use battery, screen will dimmed if no operation within 20 seconds.

### Setting the Clock

1. Press the button **SET TIME** , then the digits will start to flash.
2. Press the button **TUNE-(HOU)** to adjust the hour; Press the button **TUNE+( MIN)** to adjust the minute.
3. Press the button **SET TIME** again to exit and save the setting.

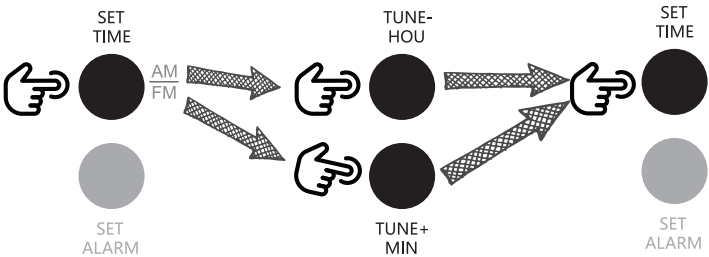

### Note:

1. Turn off radio before you set clock.
2. When you set the clock, the AM and PM indicator will tell a noon and afternoon time.

### Setting the Alarm

1. Press the button **SET ALARM** , then alarm time will start to flash,
2. Press the button **TUNE-(HOU)** to adjust the hour; Press the button **TUNE+( MIN)** to set the minute.
3. Press the buttons **-|||+** to adjust alarm volume (3-16 volume levels).
4. Press the button **SET ALARM** to exit and save the setting.

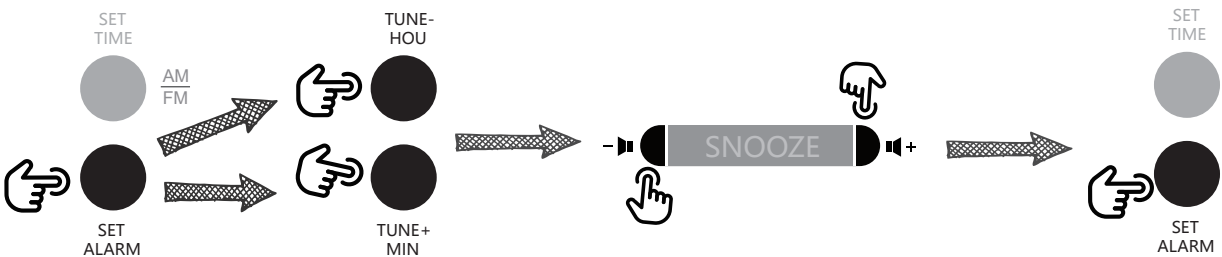

### Note:

1. Turn off radio before you set alarm clock.
2. When you set the alarm, the **AM PM** will tell you am and pm time.
3. If you set radio alarm, alarm clock will goes off with the lastest sation you listening to.

### Setting Alarm Ringtone

Slide the ringtone switch to (the left), alarm will goes off with radio.

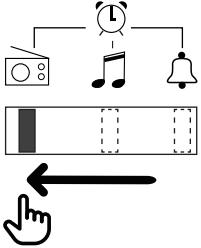

Slide the ringtone switch to (the middle), alarm will goes off with music.

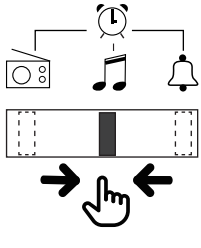

Slide the ringtone switch to (the right), alarm will goes off with beep.

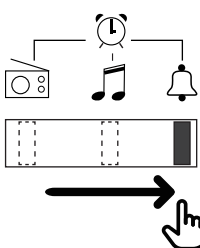

### Turn on/off Alarm

Slide the switch to **ON** to turn on alarm, then the indicator will light on the screen.

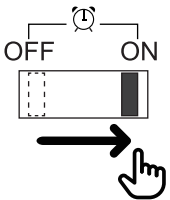

Slide the switch to **OFF** to turn off alarm, then the indicator will off and disappear from screen.

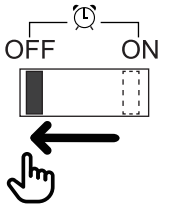

### Snooze

1. When alarm goes off, press the button **SNOOZE** to mute the alarm for 9 minutes. The alarm can be muted 3 times.
2. When alarm goes off, press other buttons **except SNOOZE** to turn the alarm off for 24 hours.

**Note:** The alarm indicator will blink in snooze mode.



### Playing the Radio

Press the button **ON/OFF** to turn on radio, then press the button **SET TIME (AM/FM)** to switch AM FM band. Press the buttons **TUNE+** and **TUNE-** to tune frequency and press and hold **TUNE+** or **TUNE-** for 2 seconds, the radio will automatically locate the next station with frequency up or down. Press the buttons **-|||+** to adjust radio volume. Press the button **ON/OFF** to turn off radio.

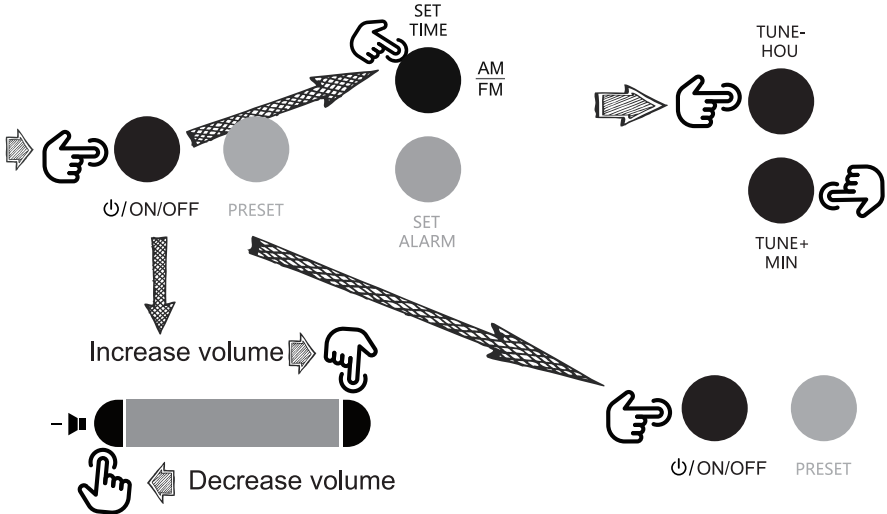

### Note:

If no operations within 10 seconds, the screen will display time. Press any button to let screen display frequency again.



### Setting Radio Presets

While listen to the station, press the button **PRESET**, then the screen will display “P01”, Press the buttons **◀▶** to select another location. Press the button **PRESET** to exit and save.

Press the buttons **◀▶** to listen to the preset stations.

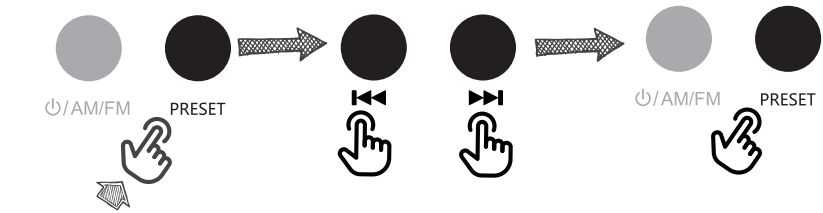

### Setting the Sleep Timer

Press the button **SNOOZE** when listen to radio, the screen will show “90”. Press the button **SNOOZE** to select among 90MIN, 80MIN, 70 MIN, 60 MIN, 50 MIN, 40 MIN, 30 MIN, 20 MIN, 10 MIN and off.



### Adjusting the Dimmer

Rotate the knob **DIMMER** adjust the display brightness .

#### Note:

There are 15 FM and 15 AM preset locations.

The old preset station will be replaced when you preset new station with the same preset location.

### MANUFACTURE:

**SHENZHEN HUIXING ELECTRONICS CO., LTD**

Address: 1B701, Haoya Gardon, Fuqian Rd,  
Guanlan Streeet, Longhua District, Shenzhen  
China

ZIP Code:518110 Mail:support@ratakee.com

### Contact US

#### By Email

Insert “ **support@ratakee.com**” or scan the  
QR code with Mail App

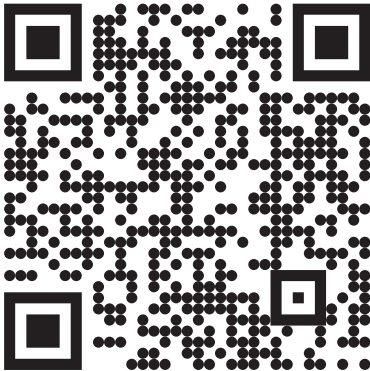

### Our Warranty:

90 Days Money Back Guarantee

365 Days Free Replacement

Quick Respond After-sales Support

### On Amazon

Open the Amazon App or Amazon website,  
then click “orders” to enter order page.

Choose the order to send message.

### TROUBLESHOOTINGS

SYMPTOM	POSSIBLE CAUSE	POSSIBLE SOLUTION
GENERAL		
Power does not come on.	AC cord not plugged in.	Insert plug firmly into AC outlet.
RADIO		
No sound.	Power is not on.	Turn the unit on.
	Volume control at minimum position.	Turn the volume control up.
Noise or sound distorted on AM or FM.	AM: Interference.	Position the radio for better AM reception.
	FM: Antenna wire not extended.	Extend antenna wire.
CLOCK		
Incorrect time.	Clock not set.	Set the clock.
	Batteries inserted incorrectly, not connected or depleted.	Check batteries.
Alarm does not turn on.	Alarm is not set to turn on.	Slide the alarm switch to turn on alarm
	Clock is not set.	Set the clock.
	Alarm time is not set.	Set alarm time.

Dear Customer,

Sincerely thanks for choosing Ratakee, and hope that you'll be satisfied with our product.

Always satisfying customer, providing them with high quality and grade product as well as the service are our aim.

You may have questions or issues while using the item, hope that you could give us a chance to improving. Just feel free to tell us on amazon or by email, we will do our best to help you and make you feel happy.

Thanks&Best regards.  
Ratakee

1) FCC 15.19

This device complies with part 15 of the FCC Rules. Operation is subject to the following two conditions:

(1) This device may not cause harmful interference, and (2) this device must accept any interference received, including interference that may cause undesired operation.

2) FCC 15.21

Warning: Changes or modifications to this unit not expressly approved by the part responsible for compliance could void the user's authority to operate the equipment.

3) FCC 15.105

For a Class B digital device or peripheral, the instructions furnished the user shall include the following or similar statement, placed in a prominent location in the text of the manual:

Note: This equipment has been tested and found to comply with the limits for a Class B digital device, pursuant to part 15 of the FCC Rules. These limits are designed to provide reasonable protection against harmful interference in a residential installation. This equipment generates, uses and can radiate radio frequency energy and, if not installed and used in accordance with the instructions, may cause harmful interference to radio communications. However, there is no guarantee that interference will not occur in a particular installation. If this equipment does cause harmful interference to radio or television reception, which can be determined by turning the

equipment off and on, the user is encouraged to try to correct the interference by one or more of the following measures:

- Reorient or relocate the receiving antenna.
- Increase the separation between the equipment and receiver.
- Connect the equipment into an outlet on a circuit different from that to which the receiver is connected.
- Consult the dealer or an experienced radio/TV technician for help.