

HT-927大无刷四轴飞行器

使用说明书

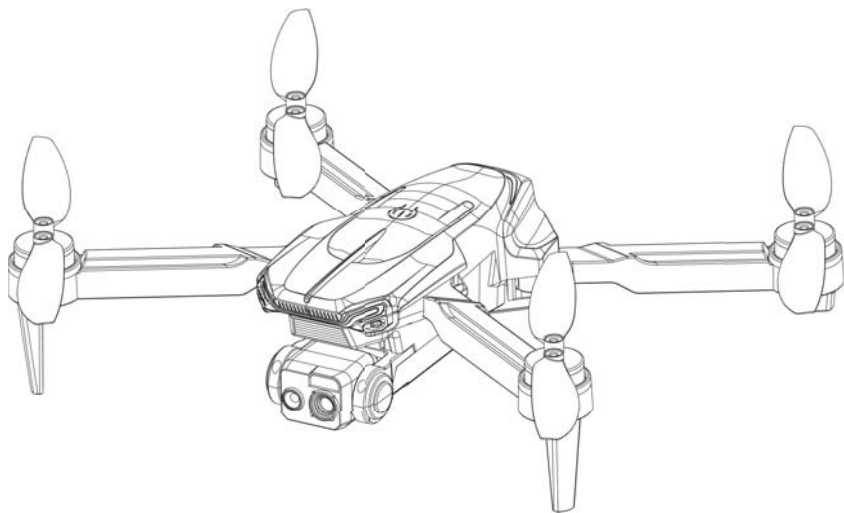

向右转动摄像头向上
向左转动摄像头向下

速度档

油门控制杆

短按一键上升/下降
长按一键急停

短按拍照
长按录像

翻滚

电源开关

方向控制杆

短按无头模式
长按微调模式

一键后退

电源指示灯

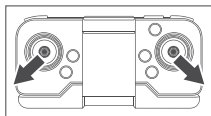

两侧摇杆外八解锁(油门摇杆向上推解锁)
两侧摇杆内八, 校准功能

进入遥控世界之前必须告诉您许多相关的知识与注意事项, 以确保您能够在学习的过程中得心应手。
在开始操作之前请务必详阅此说明书, 相信一定能够给您带来相当大的帮助, 也请您妥善保管这本说明书, 以供日后参考。

安全须知

1. 本产品不适合未满14周岁及其他不具备完全民事行为能力的人士使用。
2. 本产品具有高速旋转的螺旋桨和强大的飞行动力，在运行时具有一定的危险性，请产品运行时靠近且触碰本产品。
3. 使用本产品时，请远离机场、铁路、高速公路、高层建筑、电线等危险环境。
4. 使用本产品时，请远离手机基站，大功率发射设备等高电磁干扰的环境。
5. 使用本产品时，请远离各种载人飞行器。
6. 请勿在下雨、雷电、沙尘、雾气、下雪、大风、低温等恶劣环境使用本产品。
7. 本产品为非防水设计，请勿在水域附近操作本产品。
8. 操作本产品时，请始终保持无人机和人或动物之间10米左右的安全距离。
9. 请始终保持无人机在操作者目视范围内飞行。
10. 不要将本产品悬停或飞越人群上空，请勿以惊吓他人之乐。
11. 请勿在儿童嬉戏的场所附近操作本产品。
12. 请勿使用本产品追逐交通工具或影响交通工具的正常运行。
13. 非紧急情况下，产品在空中飞行时请勿关闭电机。
14. 本产品不可在饮酒、疲劳、服用药物、身体不适等情况下使用。
15. 请在每次使用前对本产品进行检查，包括但不限于零部件的牢固度、机体和螺旋桨的裂痕和磨损。电池电量、指示灯的有效性等。当发现异常时，请立即停止使用并更换相应配件。
16. 工作状态异常的无人机可能会发生意外，切勿启动螺旋桨或勉强飞行。
17. 请勿尝试阻止本产品工作中的任何运动部件。
18. 请勿改装本产品，或将本产品用于非原设计用途。
19. 请勿在法律法规的禁飞区操作本产品。
20. 飞行器中使用的材料种类众多，高温会损坏无人机的内部结构，并导致不可预知的后果，因此，请使无人机设备远离热源并避免将无人机长时间暴露在阳光直射下。
21. 请按照产品说明书进行操作。
22. 请使用原厂配件进行维护和替换。
23. 转借给其他人员操作，请确保操作人员理解和遵守本安全须知。
24. 不可混用不同类型的电池。
25. 膨胀、泄露或破损的电池请勿使用。
26. 电池充电时请勿靠近易燃物品（如毛毯，实木家具和木板等）。
27. 请使用原厂配置的充电线充电，请勿使用其他品牌和有破损的充电线充电。
28. 请与高速旋转的螺旋保持安全距离，以免发生绞伤、割伤危险。
29. 模型不要靠近耳朵使用！误用可能导致听力损坏。
30. 飞行器要在尽可能远离其他电器设备和磁性物件的地方使用，它们可能会造成互相干扰。
31. 请不要短路、挤压电池，以免发生爆炸。
32. 电机为发热部件，请勿触碰，以免发生烫伤危险。

1. 遥控器电池安装

请依照箭头方向先将电池盖打开，然后将3节1.5V碱性AAA电池依照电池箱的极性依次装入（电池需另购，且不可混用新旧不一或者类型不同的电池）

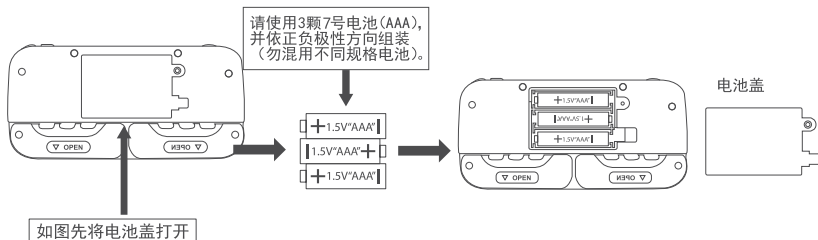

2. 飞行器的电池充电

- ①、将USB充电器插入已打开电脑的USB接口或手机充电器插口内。
- ②、将USB充电连接线另一端插入飞行器电池盒的充电孔，此时电池盒指示灯亮起，说明充电连接正常。
- ③、充电约2小时，电池盒指示灯熄灭，表明充电完成，请断开所有连接并放于安全位置（如长期存放，请勿将电池满电或没电存放）。

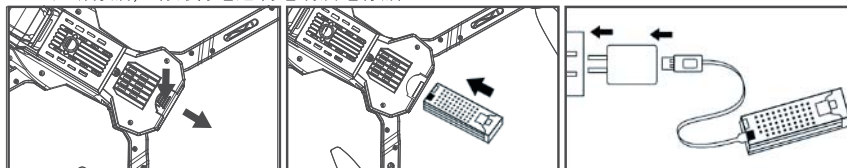

按住图所示的地方
然后向后拉出来即可取出电池

安装电池：将电池如图所示
推入电池仓即可

将充电器连接电源座

充电注意事项

1. 使用锂电池有一定的风险，可能对人和财产造成重大的损失，请谨慎使用，自行承担所有相关责任。
2. 如果电池发生泄露，请避免液体与皮肤和眼睛接触。若碰到皮肤，请立即以香皂和清水清洗。若接触眼睛，请立即以大量的清水冲洗并立即就医。
3. 如果充电器发出可疑异味，噪音或者烟雾，请立即拔出电源。

充电说明

1. 请使用原厂配送专用充电器充电，禁止使用破损或其他品牌充电器。
2. 请勿对膨胀，泄漏或破损的电池充电。
3. 请勿对电池过度充电。一旦电池完全充满电后，请拔出充电器。
4. 请勿在靠近易燃物（地毯、木地板、实木家具等）或导电的物体表面上充电。充电时请保持电池在视角范围内。
5. 切勿在使用产品后，电池散热的时候立即充电，需静置10-15分钟等待电池冷却。
6. 电池充电的温度应该介于0℃到40℃之间。

3. 镜头上调/下调

使用无人机时，可以按镜头上调和下调键来调整摄像头方向（具体根据飞行器型号是否带有可调整镜头而定）

向右转动摄像头向上
向左转动摄像头向下

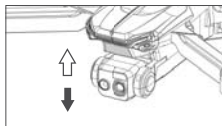
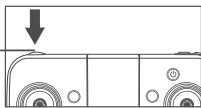

飞行器对码操控方法：

- 1、将飞行器电池模块装入机身电池仓并到位，打开飞行器开关并放于平整地面，飞行器指示灯闪烁且不要移动机身。
- 2、打开遥控器电源开关，此时听到遥控器“滴”声，飞行器灯快速闪烁直至飞行器灯常亮，表示对码成功，可进行操控飞行器。”
- 3、当多部飞行器同时操控时，必须逐个对码，避免对不上或对错造成的危险。

4. 飞行器的操作与控制



若飞行器不能垂直上升，可对飞行器进行校正：将遥控器左摇杆向右下方打，右摇杆向左下方打，飞行器灯快闪放开遥控器摇杆，飞行器灯常亮，校正完成。
(注：校正功能必须确保飞行器处于水平状态)

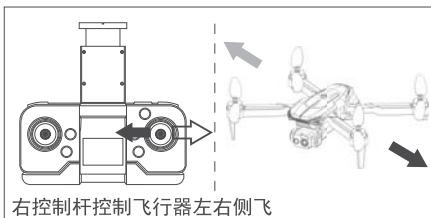
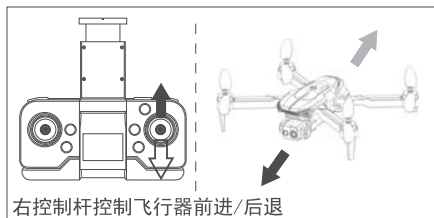
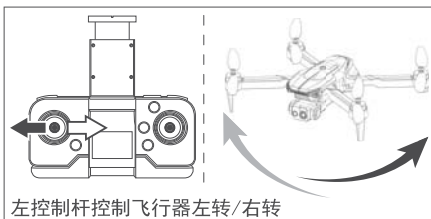
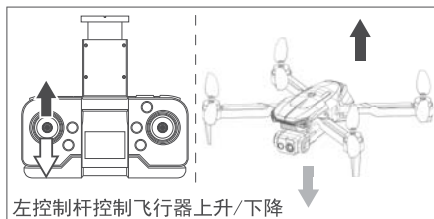
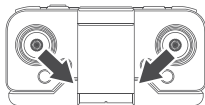

5. 微调

当飞行器在空中悬停时出现（前、后、左、右）任何一方偏飞时，届时长按微调功能键进入微调功能，然后依照飞行器偏飞的方向，将右手摇杆向反方向拨动，直至飞行器调至平稳悬停，再长按微调键，退出微调功能。

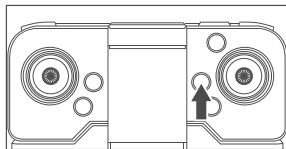

6. 快慢档调节

此款飞行器可以实现3种速度模式操作：低档（30%）、中档（60%）、高档（100%）

按压“速度转换”开关进行设置：

按压后遥控器发出“嘀”一声，表示进入低档模式

按压后遥控器发出“嘀嘀”二声，表示进入中档模式

按压后遥控器发出“嘀嘀嘀”三声，表示进入高档模式。飞行器开机默认低档模式。

! 通过此按键可调节飞行器的敏感度，敏感度数值越大，飞行器反应越快；反之越慢。

7. 翻滚模式

此飞行器通过下面的操控可以做360度的翻滚飞行。为了更好的执行翻滚功能，确保飞行器和地面保持2米以上的高度，最好在上升的过程中操作进行翻滚，这样飞行器翻滚后更容易保持高度。

1. 左侧空翻：按一下“翻滚键”，然后把右控制杆向左边推到最大。飞行器翻滚后，将控制杆拨回中间位置。

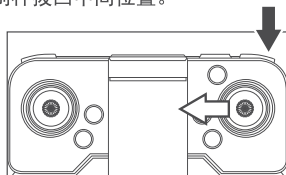

2. 右侧空翻：按一下“翻滚键”，然后把右控制杆向右边推到最大。飞行器翻滚后，将控制杆拨回中间位置。

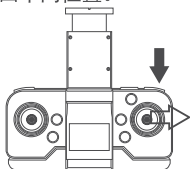

3. 前空翻：按一下“翻滚键”，然后把右控制杆向前边推到最大。飞行器翻滚后，将控制杆拨回中间位置。

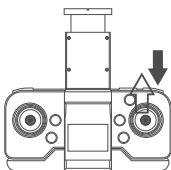

4. 后空翻：按一下“翻滚键”，然后把右控制杆向后面推到最大。飞行器翻滚后，将控制杆拨回中间位置。

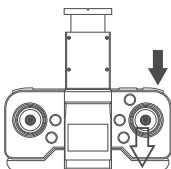

! 进入“翻滚模式”后，如果不需要翻滚功能，需再按一下“翻滚键”按键退出此模式。

8. 无头模式与一键后退

即在飞行中，不管飞行器处于什么位置，不管它的姿态在什么方向，只要您点击无头模式按键，飞行器自动锁定起飞时的方向。当飞行中发现飞行器已经离开您很远，分不清方向的时候，届时点击无头模式按键，就可以不用辨认方向的去控制飞行器；或点击一键后退键，飞行器将自行向起飞方向后退。

1. 对码时飞行器的机头必须朝前方（不然无头模式和一键后退模式打开后方向会错乱）
2. 当你需要使用无头模式时，点击无头模式按键，飞行器就会以飞行器前进的方向锁定位置。
3. 当你不需要使用无头模式时，再点击无头模式按键，退出无头模式
4. 当你需要自动后退时，长按一键后退键，飞行器就会按照起飞的方向自动退回
5. 自动后退过程中可手动控制飞行器的左右方向推进操纵杆可退出自动后退功能。（一键后退是按照机头方向来识别的）

警告：尽量选择视野开阔处和行人较少的地方使用此飞行器，以免造成不必要的损失！

9. 一键急停

在飞行器飞行时，即将撞到障碍物时，或者飞机因操作失误导致失控时，可以长按一键急停按功能键，届时飞行器四个螺旋桨叶会同时停止工作，飞行器自行掉落地面

10. 拍照/录像

1. 拍照功能：短按拍照录像功能键，进入抓拍功能，届时抓拍的照片会自动存储到手机相册和APP相册里面。2. 摄像功能：长按拍照按键功能键，进入摄像功能，在长按拍照摄像功能键，退出摄像功能。拍摄的视频同步存储在手机相册和APP相册里面。

11. 信号链接

当无人机与遥控器超距断信号时 遥控器会发出滴滴滴的急促声音来，届时无人机将自行降高度至2米以下悬停，等待信号连接，如连接上可以继续控制无人机。没有连接将持续悬停约2米高度。

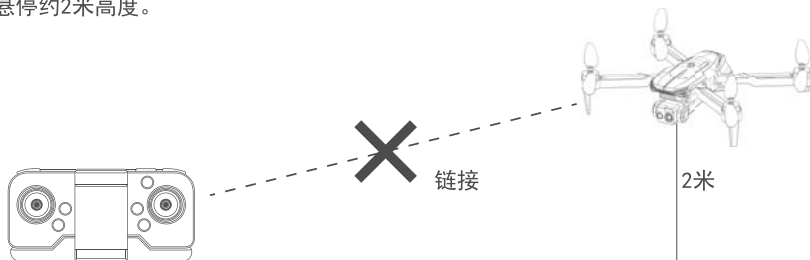

12. 如何拍出飞行器中的状态

	状况	原因	对策
1	接上飞行器电池接收器指示灯持续闪烁，操作无反应	遥控器与接收器未对频成功	请重新执行遥控器与接收机板的对频动作
2	接上飞行器电池后飞行器没有任何反应	1. 检查遥控器和接收器是否接通电源 2. 检查遥控器和接收电池的电压 3. 电池极片接触不良	1. 打开发射器与确认插入飞行器电池至定位 2. 使用完全充电饱满的电池 3. 重新插入电池，确认电池盒电池极片的接触是否正常
3	推动油门摇杆时马达不转，且接收器指示灯开始闪烁	飞行器锂聚电池电量不足	将电池充电或更换另一个充饱的电池
4	飞行器主旋翼有持续转动但不能起飞	1. 主旋翼变形 2. 飞行器电池电量不足	1. 更换主旋翼 2. 将电池充电或更换另一个充饱的电池
5	飞行器震动的很厉害	主旋翼变形	更换主旋翼
6	已调整方向微调，但是机身仍会打转，左旋/右旋速度不一致	1. 尾旋翼变形 2. 尾马达不良	1. 更换主翼 2. 更换主马达
7	飞行器仍会往前或往后偏移	陀螺仪中点不对	开机后将升降微调归中立点，重新开机
8	飞行器跌落后飞不起来	1. 电机脱落 2. 牙轮松脱	1. 重新装回电机 2. 把牙轮装紧



FOLD DRONE

INSTRUCTION FOR USE

14+
AGES

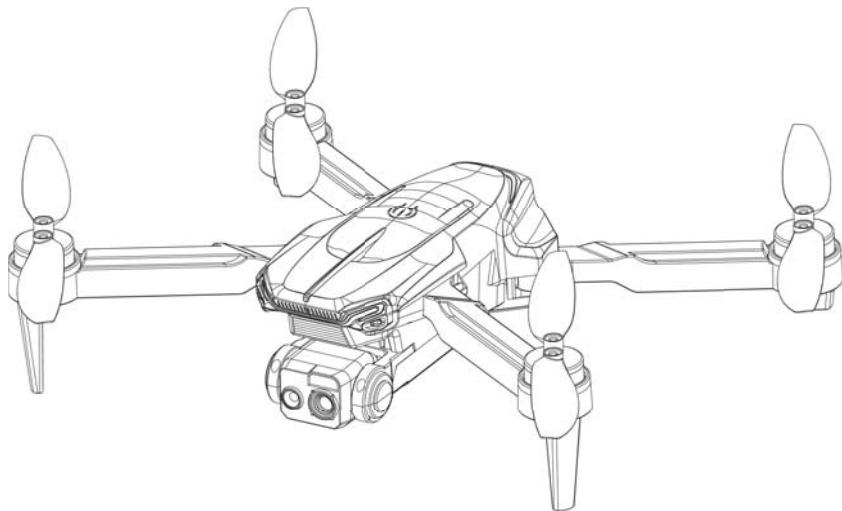

Turn the camera up to the right
Turn the camera down to the left

speed

Throttle control lever

Short press
one button to rise/fall
Long press
one button emergency stop

Short press to take a photo
Long press recording

360°roll

power switch

Direction control lever

Short press
headless mode
Long press fine-tuning
mode

one-key backward

Power indicator lamp

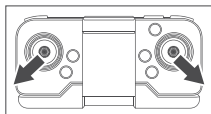

Unlock the outer eight levers on both sides
(push the throttle lever upwards to unlock)

Eight inner rocker rods on both sides, calibration function

The knowledge and safety notes below are useful for you in the remote control world. Please read this manual carefully before operating this product and keep it for further reference.

SAFETY NOTICE

1. This product is not suitable for use by persons under the age of 14 and others who do not have full capacity for civil conduct.
2. This product has a high-speed rotating propeller and strong flight power, which is dangerous during operation. Please approach and touch this product.
3. When using this product, please keep away from dangerous environments such as airports, railways, highways, high-rise buildings, and wires.
4. When using this product, please keep away from the environment with high electromagnetic interference such as mobile phone base stations and high-power transmitting equipment.
5. When using this product, please stay away from various manned aircraft.
6. Do not use this product in harsh environments such as rain, lightning, sand, fog, snow, strong wind, and low temperature.
7. This product is non-waterproof design, please do not operate this product near water.
8. When operating this product, please always keep a safe distance of about 10 meters between the drone and people or animals.
9. Always keep the drone flying within the operator's visual range.
10. Do not hover or fly over the crowd, and do not take pleasure in scaring others.
11. Do not operate this product near where children play.
12. Do not use this product to chase vehicles or affect the normal operation of vehicles.
13. In non-emergency situations, do not turn off the motor when the product is flying in the air.
14. This product cannot be used in the case of drinking, fatigue, taking drugs, physical discomfort, etc.
15. Please check this product before each use, including but not limited to the firmness of parts, cracks and wear. Battery level, indicator light availability, etc. When an abnormality is found, please stop using it immediately and replace the corresponding accessories.
16. Unmanned aerial vehicles in abnormal working conditions may have accidents. Do not start the propeller or fly reluctantly.
17. Do not attempt to stop any moving parts in the work of this product.
18. Do not modify this product, or use this product for purposes other than its original design.
19. Do not operate this product in the no-fly zone of laws and regulations.
20. There are many kinds of materials used in the aircraft, and high temperature will damage the internal structure of the drone and cause unpredictable consequences. Therefore, Please keep the drone equipment away from heat sources and avoid exposing the drone to direct sunlight for long periods of time.
21. Please operate according to the product manual.
22. Please use original parts for maintenance and replacement.
23. If it is lent to other personnel for operation, please ensure that the operator understands and abides by this safety instruction.
24. Do not mix different types of batteries.
25. Do not use swollen, leaked or damaged batteries.
26. Do not get close to flammable items (such as blankets, solid wood furniture and wooden boards, etc.) when the battery is charging.
27. Please use the original charging cable for charging, please do not use other brands and damaged charging cables to charge.
28. Please keep a safe distance from the high-speed rotating screw to avoid the risk of strangulation and cutting.
29. Do not use the model near the ear! Misuse can cause hearing damage.
30. The aircraft should be used as far away as possible from other electrical equipment and magnetic objects, which may interfere with each other.
31. Please do not short-circuit or squeeze the battery to avoid explosion.
32. The motor is a heating part, please do not touch it to avoid the danger of scalding.

1. THE INSTALLATION OF BATTERY OF REMOTE CONTROL DEVICE

Please open the battery cover in the direction of the arrow first, and then install three 1.5V alkaline AAA batteries according to the polarity of the battery box (batteries need to be purchased separately and cannot be mixed with old and new batteries or batteries of different types)

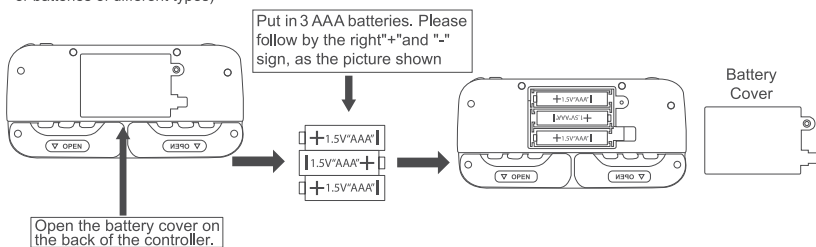

2. THE BATTERY CHARGING OF FLYING DEVICE

- ① Insert the USB charger into the USB port of the opened computer or the mobile phone charger socket.
- ② Insert the other end of the USB charging cable into the charging hole of the aircraft battery box.
At this time, the battery box indicator light is on, indicating that the charging connection is normal.
- ③ After charging for about 2 hours, the indicator light of the battery box will turn off, indicating that the charging is completed, please disconnect all connections and put it in a safe place (if it is stored for a long time, please do not store the battery fully or empty).

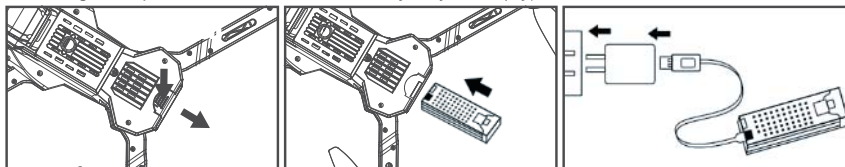

Press and hold the place shown in the picture then pull back out to remove the battery

Install the battery: place the battery as shown push in the battery compartment

Connect the charger to the power cradle

CHARGING PRECAUTIONS

1. The use of lithium batteries has certain risks, which may cause major losses to people and property. Please use it with caution and bear all relevant responsibility.
2. If the battery leaks, please avoid contact of liquid with skin and eyes. In case of contact with skin, wash immediately with soap and water. In case of contact with eyes, flush with plenty of water and seek medical attention immediately.
3. If the charger emits suspicious smell, noise or smoke, please unplug it immediately.

CHARGING INSTRUCTIONS

1. Please use the original special charger for charging, and it is forbidden to use damaged or other brand chargers.
2. Do not charge swollen, leaking or damaged batteries.
3. Do not overcharge the battery. Once the battery is fully charged, unplug the charger.
4. Do not charge on surfaces near flammable objects (carpets, wooden floors, solid wood furniture, etc.) or conductive objects. Keep the battery within the viewing angle when charging.
5. Do not charge the battery immediately after using the product, when the battery is dissipating heat, it needs to stand for 10-15 minutes, etc. Let the battery cool down.
6. The temperature at which the battery is charged should be between 0 ° C and 40 ° C.

3. LENS UP/DOWN

When using a drone, you can press the lens up and down buttons to adjust the camera direction (depending on whether the aircraft model has an adjustable lens)

Press the lens down button:
Camera down adjustment

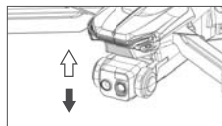

How to control the code of the aircraft:

1. Put the aircraft battery module into the battery compartment of the fuselage and place it in place. Turn on the aircraft switch and place it on a level ground. The aircraft indicator light flashes and do not move the fuselage.
2. Turn on the power switch of the remote control. At this time, you can hear the "beep" sound of the remote control, and the aircraft light flashes rapidly until the aircraft light is always on, indicating that the code is successfully matched and the aircraft can be controlled. "
3. When multiple aircrafts are controlled at the same time, the codes must be checked one by one to avoid the danger of incorrect or incorrect alignment.

4. THE OPERATION AND CONTROL OF FLYING DEVICE



If the aircraft cannot rise vertically, you can calibrate the aircraft: press the left stick of the remote control down to the right, Move the right stick to the lower left, the aircraft light flashes quickly, release the remote control stick, the aircraft light stays on, and the calibration is complete. (Note: The calibration function must ensure that the aircraft is in a level state)

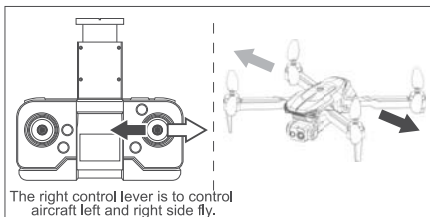
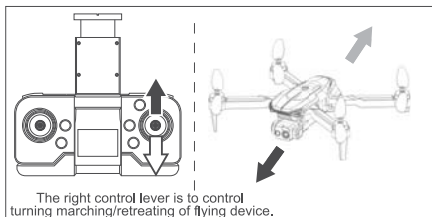
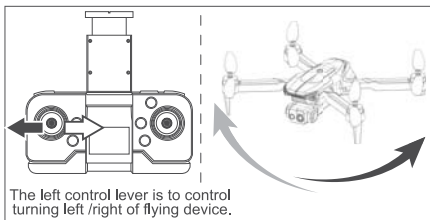
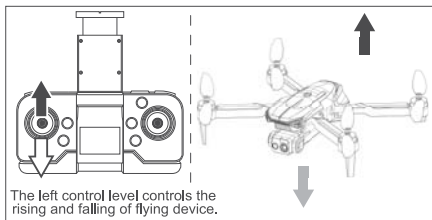
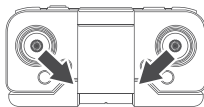

5. FINE ADJUSTMENT

When the aircraft is hovering in the air and either side deviates (front, rear, left, right), press and hold the fine adjustment function key to enter the fine adjustment function. Then, according to the direction of the aircraft's deviation, move the right joystick in the opposite direction until the aircraft is adjusted to a stable hover, and then press and hold the fine adjustment key to exit the fine adjustment function.

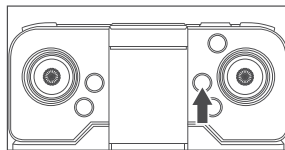

6. THE SETTINGS OF SENSITIVITY

This aircraft can operate in three speed modes: low gear (30%), medium gear (60%), and high gear (100%)
Press the "Speed Conversion" switch to set:

After pressing, the remote control emits a "beep" sound, indicating that it has entered low gear mode

After pressing, the remote control emits two beeps, indicating that it has entered mid range mode

After pressing, the remote control emits three beeps, indicating that it has entered high-end mode. The default low gear mode for aircraft startup.



Through this key, it can adjust sensitivity of flying device, the greater the sensitivity value is, the faster the flying device response: conversely, it is slower.

7. THE ROLLING MODEL

The flying device can perform rolling flight of 360 degrees by following operation. In order to better implement rolling function, and endure flying device is kept five meters height above the ground, it is better to operate rolling in the process of rising up. In this case, the flying device can be kept with height after flying device performs rolling action.

1. Left side somersault: Click "scroll key", and then push the right-control lever to left in maximum. After the flying device rolls it is to turn control lever to the middle position.

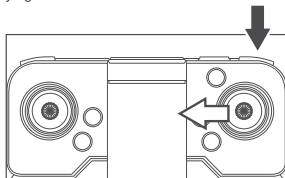

2. Right side somersault: Click "scroll key" and then push the right-control lever to right in maximum. After the flying device rolls, it is to turn control lever to the middle position.

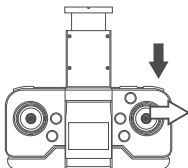

3. Front somersault: Click "mode of conversion" and then push the right-control lever to front in maximum.
After the flying device rolls, it is to turn control lever to the middle position.

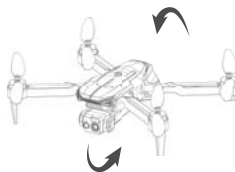
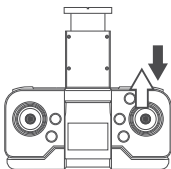

4. Backward somersault: Click "mode of conversion", and then push the right-control lever to backward in maximum.
After the flying device rolls, it is to turn control lever to the middle position.

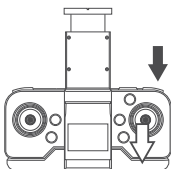

AFTER ENTERING INTO THE "ROLL MODE", IF THERE IS NO NEED OF ROLLING FUNCTIONS, THEN CLICK THE "MODE CONVERSION" KEY

8. HEADLESS MODE AND ONE-KEY BACKWARD

That is, in flight, no matter where the aircraft is, no matter what its attitude in the direction, as long as you click the headless mode button aircraft automatically lock the direction of take-off. When the flight found that the aircraft has been far away from you, do not know the direction of the time, this is the click of the headless mode button, you can not identify the direction of the aircraft to control; or click the back button, the aircraft will back away from take-off on its own.

1. The nose of the craft must be facing forward (or the headless mode and the one-button retreating mode will confuse the back direction).
2. When you need to use headless mode, click the headless mode button, the aircraft will lock in position in the direction of the aircraft's advance.
3. When you don't need to use headless mode, then click on the headless mode button, exit headless mode
4. When you need to automatically back, long press one button back button, the aircraft will take off in accordance with the direction of the automatic back to automatically back 5, automatic back process can manually control the aircraft's left and right direction to push the joystick can be withdrawn from the automatic back function. Warning: try to use the aircraft in a place with wide field of view and few pedestrians, so as not to cause unnecessary damage!

9. One click emergency stop

When the aircraft is about to collide with an obstacle during flight, or when the physical operation of the aircraft causes time and space, you can press and hold the one button emergency stop button to press the function button. At that time, the four propeller blades of the aircraft will stop working at the same time, and the aircraft will fall to the ground on its own

10. Photo / Video

1. Camera function: Short press the camera recording function key to enter the capture function. The captured photos will be automatically stored in the phone album and app album. 2. Camera function: Long press the camera button function key to enter the camera function. Long press the camera function key, Exit the camera function. The captured videos are synchronously stored in the phone album and app album.

11. SIGNALING LINKS

When the UAV and the remote control are separated from each other, the remote control will emit a beeping sound. The UAV will then descend to a height of less than 2 meters and hover, waiting for the signal to connect, if connected, you can continue to control the UAV. No connection will keep hovering about 2 meters high.

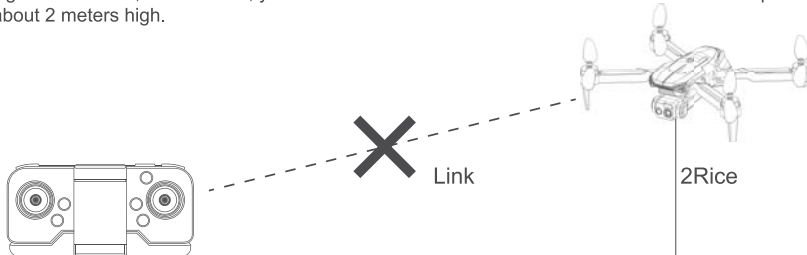

12. TROUBLE SHOOTING DURING DURING FLIGHT

	Situation	Cause	Way to deal
1	Receiver status LED blinks continuously for more than 4 seconds after flight aircraft battery inserted. No response to control input.	Unable to bind to transmitter.	Repeat the power up initializing process.
2	No response after battery is connected to flight aircraft.	1. Power to transmitter and receiver. 2. Check transmitter and receiver voltage. 3. Poor contact on battery terminals.	1. Turn on transmitter and ensure flight aircraft battery is inserted properly. 2. Use fully charged batteries. 3. Re-seat the battery and ensure good contact between battery contacts.
3	Motor does not respond to throttle stick, receiver LED flashes.	Flight vehicle battery depleted.	Fully charge the battery, or replace with a fully charged battery.
4	Main rotor spins but unable to take off.	1. Deformed main blades 2. Flight vehicle battery depleted.	1. Replace main blades. 2. Charge or replace with fully charged battery.
5	Strong vibration of flight vehicle.	Deformed main blades.	Replace main blades.
6	Tail still off trim after tab adjustment, or inconsistent speed during left/right pirouette.	1. Damaged tail rotors. 2. Damaged tail drive motor.	1. Replace main blades. 2. Replace the main motor
7	Flight vehicle still wobbles forward after trim adjustment during hover.	Gyroscope midpoint not.	The boot will lift fine-tune the normalized neutral point, reboot.
8	Flight vehicle still wobbles left/right after trim adjustment during hover.	1. Motor off. 2. Cone loose.	1. Replace the motor. 2. Installed tight cone.

This device complies with Part 15 of the FCC Rules. Operation is subject to the following two conditions: (1) this device may not cause harmful interference, and (2) this device must accept any interference received, including interference that may cause undesired operation.

Changes or modifications to this unit not expressly approved by the party responsible for compliance could void the user's authority to operate the equipment.

NOTE: This equipment has been tested and found to comply with the limits for a Class B digital device, pursuant to Part 15 of the FCC Rules. These limits are designed to provide reasonable protection against harmful interference in a residential installation. This equipment generates uses and can radiate radio frequency energy and, if not installed and used in accordance with the instructions, may cause harmful interference to radio communications.

However, there is no guarantee that interference will not occur in a particular installation.

If this equipment does cause harmful interference to radio or television reception, which can be determined by turning the equipment off and on, the user is encouraged to try to correct the interference by one or more of the following measures:

- Reorient or relocate the receiving antenna.
- Increase the separation between the equipment and receiver.
- Connect the equipment into an outlet on a circuit different from that to which the receiver is connected.
- Consult the dealer or an experienced radio/TV technician for help.

This device and its antenna(s) must not be co-located or operation in conjunction with any other antenna or transmitter.

Radiation Exposure Statement of Remote Control:

The device has been evaluated to meet general RF exposure requirement in portable exposure condition without restriction.

Radiation Exposure Statement of Aircraft:

To maintain compliance with FCC's RF Exposure guidelines, This equipment should be installed and operated with minimum distance of 20cm from your body.