

TWS无线耳机

- 使用说明书 -

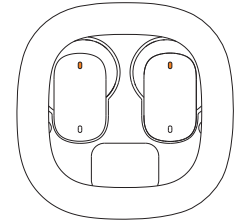
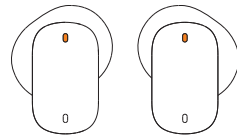

D01

包装清单

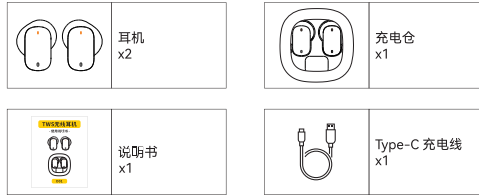

产品示意图

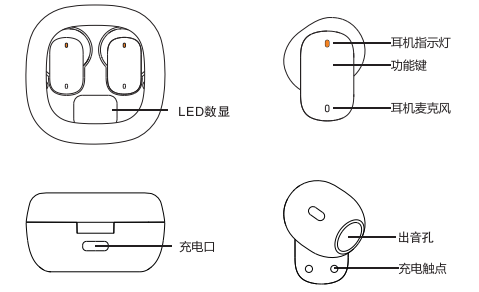

温馨提示

- 除说明书有特殊标示的操作方式以外，请勿尝试拆卸或更换产品内的任何零件。
- 请勿将产品放入水或其他任何液体中，此产品非防水设计。
- 如果有任何液体不小心进入产品内时，请立即断开连接并移开此产品。
- 为避免触电，请在安装或卸载产品时，确保手上没有沾水。
- 请勿将此产品放置于热源附近或直接暴露在火源附近。
- 请勿将本产品放置于有强大电磁力的环境中，否则会导致产品故障。
- 请勿私自拆卸电池，勿将电池暴露在烘烤或类似过热的环境中，避免引发火灾。

产品规格

蓝牙版本：5.4
喇叭规格：Φ13mm
耳机电池：33mAh*2
耳机防水等级：IPX5
充电仓电池：300mAh
音乐时间：约 4.0 小时 (80% 音量)
通话时间：约 3.5 小时 (80% 音量)
配合充电仓总续航：约 16 小时

充电指示

- 耳机需充电时，请将耳机放入充电盒。
- 将USB端插入DC5V充电器插口，将Type-c端连接到耳机充电口进行充电，充电时LED数码显示屏个位跳动，并显示当前电量，充满常亮。
- 充电仓充满：约1小时。
- 若耳机电量低于3.4V，每一分钟播报一次“Please charge”。



产品操作说明

开机

请从充电盒中拿出耳机，耳机自动开机。(手动长按功能键3秒也可开机)

关机

- 把耳机放回充电盒，耳机自动关机。(手动长按功能键5秒也可关机)
- 低电自动关机；

配对

- 耳机从充电盒取出会自动开机，此时LED指示灯快速交替闪烁；并左右互联，互联成功后副耳灭灯，主耳继续闪烁；然后进入蓝牙配对模式，打开手机搜索蓝牙配对名“D01”连接，完成配对。
- 双耳取出充电盒自动连上次配对的手机。



耳机状态与提示音

状态	提示音
开机	Power ON
关机	Power OFF
左右耳机连接	DU DU
连接成功	Connected
断开连接	Dis Connected
电量低	Please charge

功能操作

■ 常规模式

- 语音助手：长按左耳2秒
- 音量加：右耳单击
- 音量减：左耳单击

■ 通话模式

- 接听电话：双击任意耳机
- 挂断电话：双击任意耳机
- 拒接来电：长按任意耳机2秒

■ 注意

任何状态下连击5次任意耳机，可清除耳机所有连接记录并关机。

耳机APP下载



耳机APP连接

1. 手机添加设备

先在手机系统设置里面完成蓝牙连接



2. APP添加设备

手机连接上设备后，打开APP按以下步骤操作

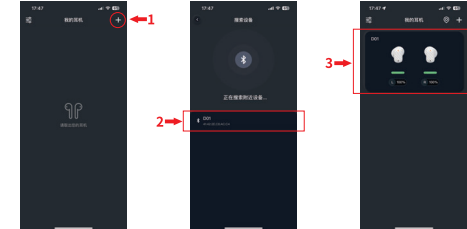

APP功能介绍

■ 连接成功-设备信息显示

连接成功后显示您的设备信息，可以查看当前电量，设置EQ音效、切换游戏模式、设置按键定义、修改您的设备名称等，可根据用户习惯，自行修改。

■ 特别说明

不带AI翻译功能的耳机，APP默认不翻AI翻译。



注意事项

请遵守以下注意事项以免造成听力伤害。

- 长时间使用高音量会刺激耳部，可能会导致听力减弱。
- 为了更好的保护耳部听力，请注意防止音量过高的情况。
- 提高音量时请逐渐进行，突然加高音量可能会损伤耳部。

如在使用本机时出现皮肤过敏等症，请尽快停止使用并询问医生，或联系维修中心，或联系购买时的贩售店进行询问。

TWS Wireless Earphones

-User Manual-

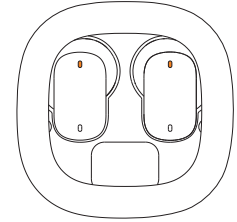
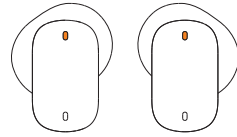

D01

Packing List

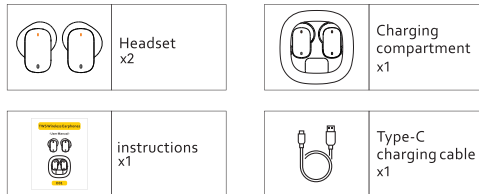

Product Schematic Diagram

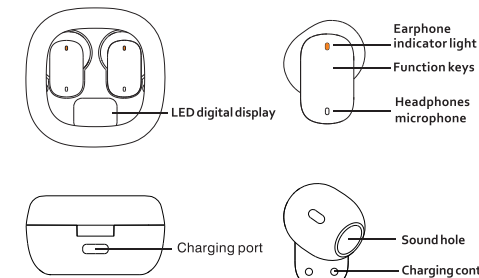

Tips

- Do not attempt to disassemble or replace any parts inside the product, except for the operation methods indicated in the manual.
- Do not put the product in water or any other liquid. This product is not waterproof.
- If any liquid accidentally enters the product, disconnect and remove the product immediately.
- To avoid electric shock, please make sure that your hands are not stained with water when installing or uninstalling the product.
- Do not place this product near a heat source or directly expose it to a fire source.
- Do not place this product in an environment with strong electromagnetic force, otherwise it may cause product malfunction.
- Do not disassemble the battery without authorization, and do not expose the battery to baking or similar overheating environments to avoid causing a fire.

Product Specifications

Bluetooth version: 5.4
Speaker specification: Medium 13mm
Earphone battery: 33mAh * 2
Waterproofing of earphones: IPX5
Charging compartment battery: 300mAh
Music duration: approximately 4.0 hours (80% volume)
Talk time: approximately 3.5 hours (80% volume)
Combined with the charging compartment, the total battery life is about 16 hours

Charge indicator

- When the earphones need to be charged, please put them into the charging case.
- Insert the USB end into the DC 5V charger socket and connect the Type-C end to the headphone charging port for charging. During charging, the LED digital display screen will jump and show the current battery level, and it will remain on when fully charged.
- Charging case fully charged: about 1 hour. If the headphone battery level is below 3.4V, broadcast "Please charge" once every minute.



Product Operation Instructions

Power on

Power on: Take out the earphones from the charging case, and the earphones will automatically turn on. (Manually press and hold the function key for 3 seconds to turn on the device)

Shutdown

- Put the earphones back into the charging case, and the earphones will automatically turn off (Manually press and hold the function key for 5 seconds to shut down)
- Low power automatic shutdown;

Pair

- When the earphones are removed from the charging case, they will automatically turn on, and the LED indicator light will flash rapidly alternately. And connect left and right, after successful connection, the auxiliary ear will turn off the light, and the main ear will continue to flash; Then enter Bluetooth pairing mode, open your phone and search for the Bluetooth pairing name "D01" to connect and complete the pairing.
- Remove the charging case from both ears and it will automatically reconnect to the last paired phone.

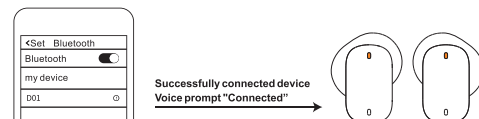

Headphone Status And Prompt Sound

state	prompt sound
Power ON	Power ON
Power OFF	Power OFF
Left and right headphone connections	DU DU
Connected	Connected
Dis Connected	Dis Connected
Low Battery	Please charge

Functional Operation

■ Normal Mode

- Voice assistant: Long press the left ear for 2 seconds
- Volume plus: Right ear click
- Volume reduction: Left ear click

■ Call mode

- Answering a call: Double click on any earphone
- Hanging up the phone: Double click on any earphone
- Reject call: Long press any earphone for 2 seconds

■ Pay attention to

Press any earphone 5 times in any state to clear all connection records and shut down the earphone.

Headphone App Download



Earphone App Connection

1. Add a device to your phone

First, complete the Bluetooth connection in your phone system settings

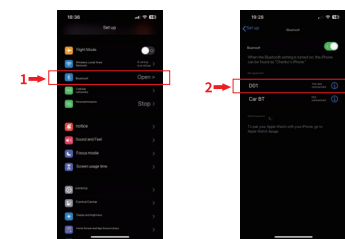

2. APP add device

After the phone is connected to the device, open the app and follow the following steps

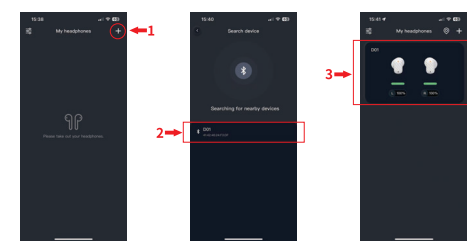

Introduction To APP Functions

■ Connection successful-Device information displayed

After successful connection, your device information will be displayed, allowing you to view the current battery level, set EQ sound effects, switch game modes, define buttons, modify your device name, etc. You can modify it according to user habits.

■ Special note

Headphones without AI translation function, the app defaults no AI translation

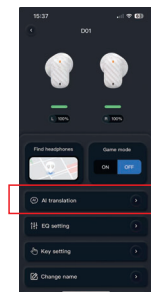

Precautions

Please follow the following precautions to avoid hearing damage.

- Long term use of high volume can stimulate the ears and may lead to hearing loss.
- In order to better protect the hearing of the ears, please pay attention to preventing situations where the volume is too high.
- Please gradually increase the volume, sudden increase in volume may damage the ears.

If you experience symptoms such as skin allergies while using this device, please stop using it as soon as possible and consult a doctor, or contact a repair center, or contact the seller at the time of purchase for consultation.

FCC Statement

This device complies with part 15 of the FCC Rules. Operation is subject to the following two conditions: (1) This device may not cause harmful interference, and (2) this device must accept any interference received, including interference that may cause undesired operation.

This equipment has been tested and found to comply with the limits for a Class B digital device, pursuant to part 15 of the FCC Rules. These limits are designed to provide reasonable protection against harmful interference in a residential installation. This equipment generates, uses and can radiate radio frequency energy and, if not installed and used in accordance with the instructions, may cause harmful interference to radio communications. However, there is no guarantee that interference will not occur in a particular installation. If this equipment does cause harmful interference to radio or television reception, which can be determined by turning the equipment off and on, the user is encouraged to try to correct the interference by one or more of the following measures:

- Reorient or relocate the receiving antenna.
- Increase the separation between the equipment and receiver.
- Connect the equipment into an outlet on a circuit different from that to which the receiver is connected.
- Consult the dealer or an experienced radio/TV technician for help.

Caution: Any changes or modifications to this device not explicitly approved by manufacturer could void your authority to operate this equipment.

RF Exposure Information

The device has been evaluated to meet general RF exposure requirement. The device can be used in portable exposure condition without restriction.