



vakiav

Smart Bird Feeder

Model: VK-ST



vakiav

Contact us



[Facebook.com/Vakiav](https://www.facebook.com/Vakiav)

[Twitter.com/Vakiav](https://twitter.com/Vakiav)

[Instagram.com/Vakiav](https://www.instagram.com/Vakiav)

www.vakiav.com

VK-ST

User Manual

CONTENTS

01 -How to pair devices?

02 -How to install the product?

03 -FAQ

This device complies with part 15 of the FCC rules,operation is subject to the following two conditions:

1)this device may not cause harmful interference and

2)this device must accept any interference received, including interference that may cause undesired operation;

NOTE: this equipment has been tested and found to comply with the limits for a Class B digital device, pursuant to Part 15 of the FCC Rules. These limits are designed to provide reasonable protection against harmful interference in a residential installation. This equipment generates, uses and can radiate radio frequency energy and , if not installed and used in accordance with the instructions, may cause harmful interference to radio communications.

However ,there is no guarantee that interference will not occur in a particular installation.

If this equipment does cause harmful interference to radio or television reception, which can be determined by turning the equipment off and on, the user is encouraged to try to correct the interference by one or more of the following measures;

Reorient or relocate the receiving antenna.

Increase the separation between the equipment and receiver.

Connect the equipment into an outlet on a circuit different from that to which the receiver is connected.

Consult the dealer or an experienced for help.

Pursuant to section 15.21 of the FCC rules, changes or modifications to a product by the user that are not expressly approved by the party responsible for compliance could void the user's authority to operate the equipment.

The device meets the FCC radio Frequency Emission Guidelines, Information on the product is on file with the FCC and can be found by inputting such products FCC ID(which can be found on the device)into the FCC ID Search form available at <https://www.fcc.gov/oet/ea/fccid>

The party responsible for FCC compliance is:

VANIMAGE CO LTD 92 CORPORATE PARK STE C 204 IRVINE, CA 92606

FCC Radiation Exposure Statement

This device complies with FCC radiation exposure limits set forth for an uncontrolled environment and it also complies with Part 15 of the FCC RF Rules. This equipment must be installed and operated in accordance with provided instructions and the antennas used for this transmitter must be installed to provide a separation distance of at least 20 cm from all persons and must not be co-located or operating in conjunction with any other antenna or transmitter. End-users and installers must be provided with antenna installation instructions and consider removing the no-collocation statement.

SPECIFICATIONS

AI Recognition	Support
Resolution	5M 1080P
Cloud	Support replay
Number of connected devices	Unlimited
Battery Capacity	3.6V 5200mAh Li-ion battery
Input	5V1A

What's in the box?

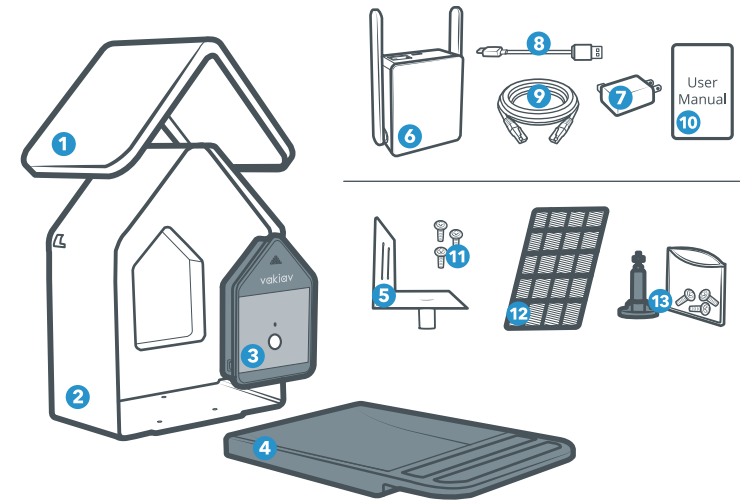

1. Roof

2. Subject

3. Camera

4. Tray

5. Metal bracket

6. VK-ST signal transmitter
7. Adapter

8. Charging cable

9. Network cable

10. User manual

11. PWB Screw 4*20 X3

12. Solar panels

13. Solar panel accessories

1. Button description

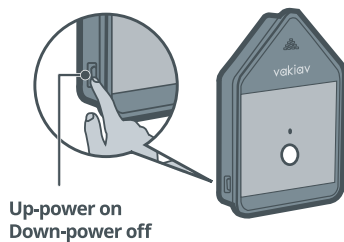

2. Camera indicator light description

 Red light flashes – pairing status

 Green light constant – charging

 The green light goes out – charging is completed

3. Signal transmitter indicator instructions



Red light – Unable to connect to camera

Green light – working normally

How to pair devices?

Preparations before pairing

- 1 Connect to the router or internet

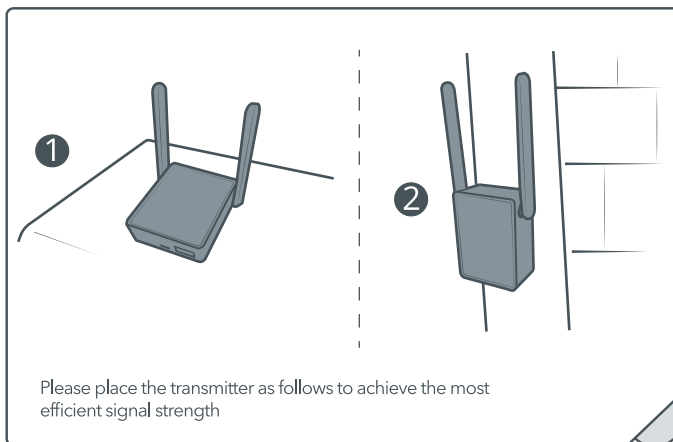
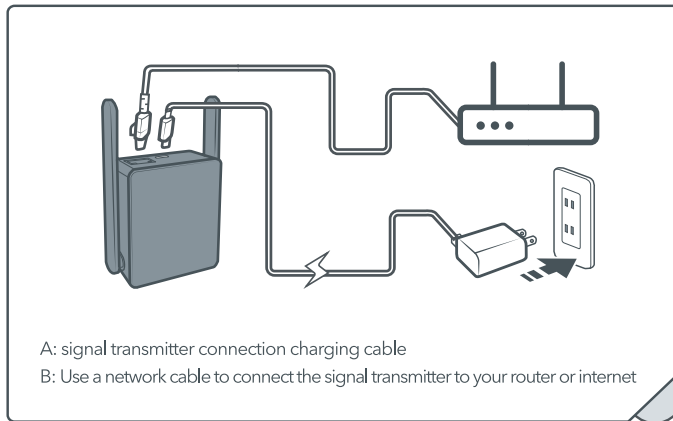

- ② Turn on the power switch of the camera - there will be birds chirping and red light flashing

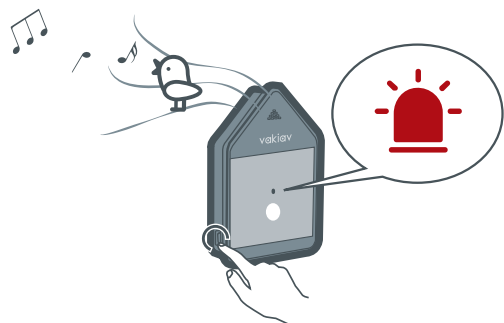

- ③ Download the Vakiav APP



- ④ open the Vakiav APP, Register an account

*** If registration fails, please log in to the official website and contact customer service staff**

www.vakiav.com



- ⑤ Device paired successfully

Please perform the pairing operation according to the video instruction in the APP

After entering the add device interface, scan the QR code on the back of the camera to successfully bind it.

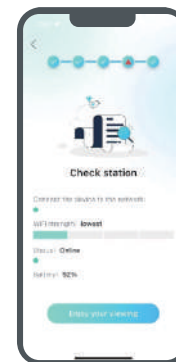
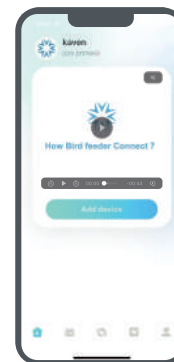

*** If unsuccessful, please check the frequently asked questions in this manual to find the relevant problem.**

If it still cannot be solved, please contact the customer service staff on the official website. www.vakiav.com

How to install the product?



Step1:
Install the feeder roof

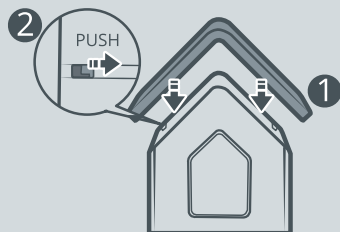

Step2:
Place the tray

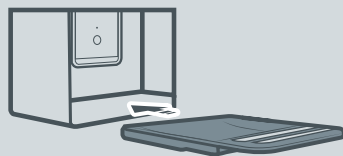

Step3:
Install the metal bracket

a) Installed outdoors
Fix the metal bracket to a wooden board or tree, and then fix the bird feeder to the metal bracket

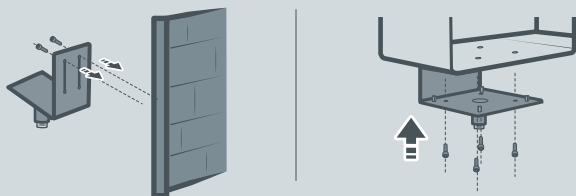

b) mounted on bird pole
Attach the metal bracket to the bird feeder and then to the bird pole

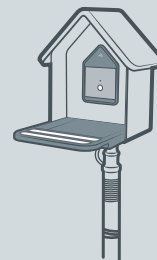

Step4:
Install solar panels
Contains following accessories:



① Please find a place which has sunlight for most of a day and adjust the angle to make sure maximum exposure. The solar panel needs few hours of direct sunlight to convert solar energy into electricity. The conversion efficiency is affected by weather conditions, seasonal changes, geographic locations, etc.

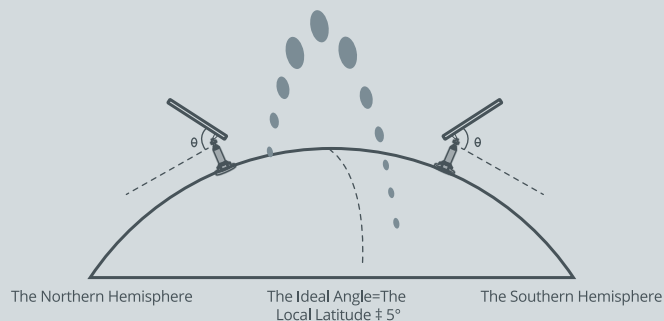

② Mount the bracket with the mounting template and the screws provided in the package.

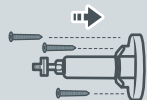

③ Slot the solar panel into the bracket and make sure it's secure.

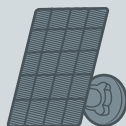

④ Loosen the adjusting control on the bracket and adjust the angle of the solar panel to make it receive direct sunlight, and then retighten the adjusting control to secure your setting.

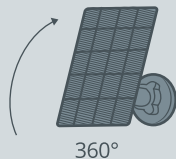

⑤ Connect the solar panel to the camera with the micro USB cable.

Connect to the camera through the silicone plug on the back of the bird feeder

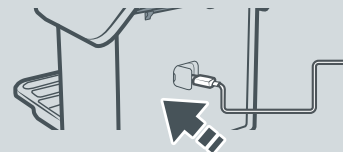

Step5:
Put camera in bird feeder

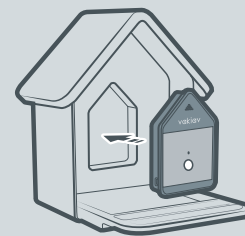

1. Make sure that there is NO blocking on the solar panel. The energy harvesting efficiency drops drastically even when a small portion of the solar panel is blocked.
2. Please don't install the solar panel completely horizontally. Otherwise, your solar panel might accumulate dust and other debris easily. Its advised to install the solar panel angularly to make it receive direct sunlight.
3. Wipe the solar panel regularly to remove the dust or debris.



Charge

The camera can be removed for charging

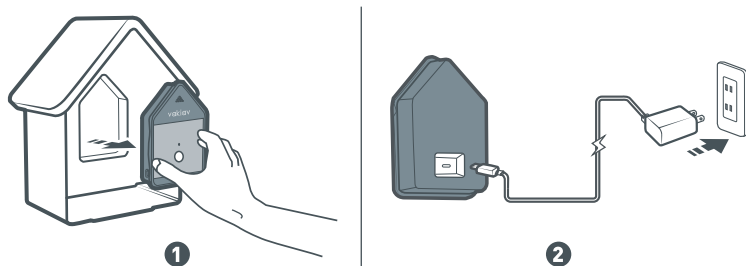

Cleaning

The tray can be pulled out for cleaning

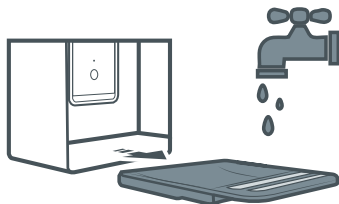

FAQ



— Unable to connect to the Internet

- preliminary work -

- Check the transmitter: Please check whether the transmitter is connected to the router. After the connection is successful, the transmitter will have a green light that is always on, and if it is abnormal, the red light will be on.
- Check the camera: Please confirm that the transmitter is properly connected to the router, and turn on the camera switch.

Pairing successful—no chirping or lights

Not paired—birds chirping and red light on

- Solution -

If the above methods do not resolve the issue, contact customer support for assistance.

— Unable to scan the code/no response after scanning

- preliminary work -

- Please check whether your phone is connected to the network
- Please check whether you enabled the scanning function when adding the device in Vakiav APP?

- Solution -

- If your phone currently has Internet access, you can open other applications to access the Internet.
- Click Vakiav APP/Add Device/VA-G1 PRO Select Model/Next/Next/Scan

— The red light of the transmitter and camera is always on

- preliminary work -

- Please check whether the transmitter is connected to your router
- Please check whether the camera is turned on and there is bird chirping (appears when pairing for the first time)

- Solution -

- Make sure your router can connect to the Internet normally
- The red light means that the camera cannot connect to the transmitter.
- There is no problem after checking the above, but the red light is still on, please contact customer service.

— The solar panel cannot be charged/ cannot be charged normally

- preliminary work -

- Is the solar panel power cord connected to the camera?
- Is the black side of the solar panel exposed to sunlight?
- Use the adapter to charge the camera

- Solution -

- The indicator light will stay on green when the camera is charging, and the green light will go out when it is fully charged.
- When using the solar panel to charge, the indicator light on the camera should be bright green most of the time.
- Charging the solar panel requires a long period of sunlight. If the sunlight cannot satisfy the camera's usage time, an adapter can be used to charge the camera. Then put it back into the bird feeder.

*** If the above methods do not resolve the issue,
contact customer support for assistance.**



Facebook.com/Vakiav



Instagram.com/Vakiav



Twitter.com/Vakiav

FCC Warning

This device complies with Part 15 of the FCC Rules. Operation is subject to the following two conditions:

(1) This device may not cause harmful interference, and (2) this device must accept any interference received, including interference that may cause undesired operation.

NOTE 1: This equipment has been tested and found to comply with the limits for a Class B digital device, pursuant to part 15 of the FCC Rules. These limits are designed to provide reasonable protection against harmful interference in a residential installation. This equipment generates, uses and can radiate radio frequency energy and, if not installed and used in accordance with the instructions, may cause harmful interference to radio communications. However, there is no guarantee that interference will not occur in a particular installation. If this equipment does cause harmful interference to radio or television reception, which can be determined by turning the equipment off and on, the user is encouraged to try to correct the interference by one or more of the following measures:

- Reorient or relocate the receiving antenna.
- Increase the separation between the equipment and receiver.
- Connect the equipment into an outlet on a circuit different from that to which the receiver is connected.
- Consult the dealer or an experienced radio/TV technician for help.

NOTE 2: Any changes or modifications to this unit not expressly approved by the party responsible for compliance could void the user's authority to operate the equipment.

RF Exposure Statement

To maintain compliance with FCC'S RF Exposure guidelines, This equipment should be installed and operated with minimum distance of 20cm between the radiator and your body. This device and its antenna(s) must not be co-located or operation in conjunction with any other antenna or transmitter.