

CAR AUDIO

CAR MP3 PLAYER WITH RADIO USB/SD/MMC MANUAL



1.Remote control Operations

1.Poweron/off

2.Band

3.Number1/Stop/Play

4.Number2/Scan

5.Number4/Random

6.Number5/last 10songs

7.Mute

8.Last10songs

9.EQ

10.Displaythe setting

11.Volume decrease

12.Soundeffect setting

13.Lastsong/Hangup

14.Pause

15.MODE

16.Number3/Repeat

17.Number6/Next10songs

18.Next10songs

19.As/Pageselect

20.Volumeincrease

21.Nextsong/Answerthephone

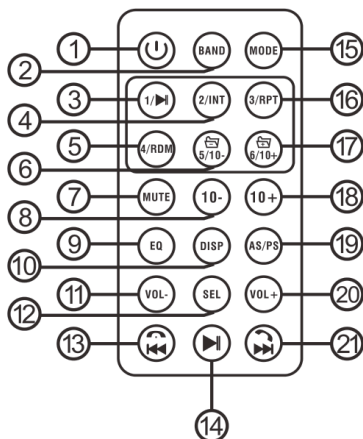

2.Basic Operation

1. Power on/ off

Short press this button power on or power off .

2. Volume button/ Sound effect change

Turn this button to control the volume. Short press repeatedly to change the sound effect as follows:

Volume—BASS—TREBLE—BAL—FAD—EQ OFF/ON—LOUD OFF/ON

When you choose the mode you need , you can turn left or right Volume Knob to select.

3.LCD

It shows radio frequency and content of SD/USB.

4. Change radio channel /Search automatically/Storage button

In radio mode, short press this button to change the band: FM1-FM2-FM3 AM1-AM2. Long press to search and save the radio station into the Number (1-6) automatically.

5.Radio memory number(1.2.3.4.5.6)

In the radio mode, when you get the radio you like, You can long press any number button (1-6) to save this radio station into this number. Such you press the number 2, next time you press number 2, it will show the station directly.

6.Radio search backward /Previous song

In the radio mode, short press this button to search the radio backward. and it will stop and play when it get the radio station.

Long press this button (about three second) to search the radio by manual, then you can short press this button to search the station, and if you don't press any button for 5 seconds. it will quit this function.

7. Radio search forward /Next song

In the radio mode, short press this button to search the radio forward. and it will stop and play when it get the radio station.

Long press this button (about three second) to search the radio by manual. then you can short press this button to search the station. and if you don't press any button for 5 seconds, it will quit this function.

8. Mode/answer the all/Ring off

Short press to change mode: Radio—USB—TF(SD) —AUX IN.

9. Clock

Short press this button to display the current time. Long press this button until the clock time flash, then you can turn VOL right and left to adjust time (hour/minute) respectively.

10.Aux in

Short press Mode button to go to AUX in, you can play external music by inserting in this Aux in hole.

11.TF slot

Insert TF card into slot, Press the MODE to go into TF mode. Then it will read the music (MP3/WMA) of the TF card.

PS: When you read TF card . It cannot change to SD mode. Only can change to USB mode.

12. USB slot

Insert U disk into (8)USB Slot it will read the music in U disk..

13. EQ

Short press this button to go to EQ function. EQ POPS- ROCK- CLASS- FLAT.

14.

1). Insert TF /USB into slot, short press  is pause function. short press again can go on playing.

2). Insert SD/MMC/USB into slot, short press , it will read the next song .

3). Insert SD/MMC/USB into slot, short press , it will read the previous song .

4). Insert SD/MMC/USB into slot, short press INT is scan function.

5). Insert SD/MMC/USB into slot, short press RPT is repeat function.

6). Insert SD/MMC/USB into slot, short press RDM is random play function.

7). Insert SD/MMC/USB into slot, short press -10/6 last 10 songs function Long press is last file function .

8). Insert SD/MMC/USB into slot, short press + 10/6 next 10 songs function. Long press is next file function .

16. Fast charge USB

This USB slot only for cellphone charge .

3. Bluetooth operation

1. Bluetooth is turned on by default when you power on the player , short press MODE to select BT MODE. And you will see the Bluetooth symbol flashing all the time.The Bluetooth symbol would not flashing. Then the mobile phone succeed in connecting with Bluetooth

2. In the Bluetooth mode. You can play the music of the mobile phone through the Bluetooth.

3. In the Bluetooth mode. Short press  to  answer and ring off the call.

4. Technical Parameters

Tuner Part:

FM Frequency Range	87.5MHz-108MHz
FM noise-limited sensitivity	FM $\leq 26\text{dB}$
FM signal to noise ratio (S/N)	$\geq 45\text{dB}$

USB/MMC/SD Part:

Frequency Response	100Hz- 10kHz(+ 10dB)
MP3 bit rates	8-320kbps
Channel balance	$\leq 3\text{ dB}$
Channel Separation	$\leq 22\text{dB}$
MP3 Signal to noise ratio (S/N)	$\geq 55\text{dB}$
Working voltage	12V DC
Real power output	4*25W/14.4V
Speaker impedance	4 Ω -8 Ω
Size dimensi	180mm(W)x52mm(H) x151(L)

5. INSTALLATION/UNMOUNTING

Before installation check the power supply of the vehicle. the condition of the device and if all functions work properly on the device. Always use the supplied accessories for the mounting, using of different parts may result faulty operation. Make sure when you mount the device that it can not cause any injury in case of braking. Avoid the mounting on places where the device is exposed to direct heat, dust etc.

Installation of the device: Place the mounting face into the dashboard, push the dips of the frame then push the radio in until it stays secure and fastened.

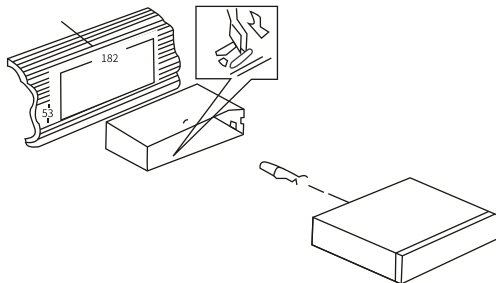

Unmounting of the device: Place the enclosed 'keys' (as seen on the picture) into the holes on both sides of the device until you hear a click sound, then pull the device-while holding the 'keys'-from the dashboard.

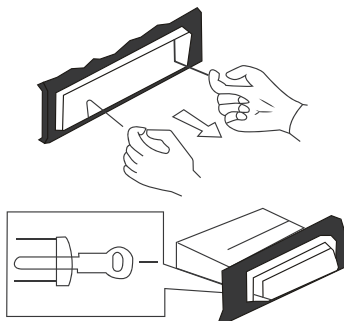

6. Wiring Diagram

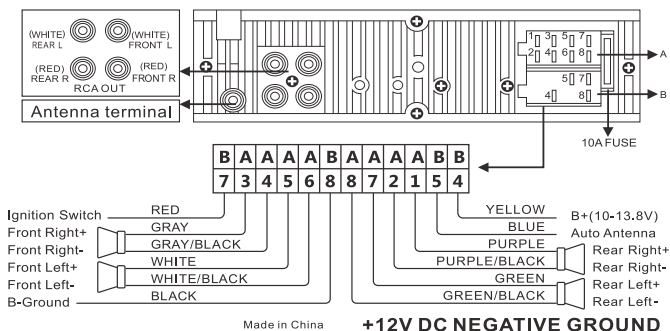

7. Trouble shooting

Fault	Reasons	Solutions
LCD doesn't display	1.Yellow wire is not connected with battery + 2.Fuse of red wire is open	Assure yellow wire is connected with battery +Replace fuse
No sound	1.No power supply 2. Speaker wire is open circuit 3.SD/MMC card, U disk don't have song with corresponding format. 4.SD/MMC card, U disk golden finger is dirt which causes bad contact.	Connect the power wire. Connect speaker wire. Check the contents of SD/MMC card, U disk. Clean with absolute alcohol.
LOW sound (not clear)	1.Power internal resistance is high. 2.Antenna is bad contact.	Replace the power supply Tighten the antenna plug.
Mono track	1.One channel of speaker wire is open circuit 2.Amplifier integrated circuit is damaged.	Connect speaker wire Replace the IC of amplifier

Note: Technical data is subject to change without prior notify.

This device complies with part 15 of the FCC Rules. Operation is subject to the following two conditions: (1) this device may not cause harmful interference, and (2) this device must accept any interference received, including interference that may cause undesired operation.

Any changes or modifications not expressly approved by the party responsible for compliance could void the user's authority to operate the equipment.

NOTE: This equipment has been tested and found to comply with the limits for a Class B digital device, pursuant to Part 15 of the FCC Rules. These limits are designed to provide reasonable protection against harmful interference in a residential installation. This equipment generates, uses and can radiate radio frequency energy and, if not installed and used in accordance with the instructions, may cause harmful interference to radio communications. However, there is no guarantee that interference will not occur in a particular installation.

If this equipment does cause harmful interference to radio or television reception, which can be determined by turning the equipment off and on, the user is encouraged to try to correct the interference by one or more of the following measures:

- Reorient or relocate the receiving antenna.
- Increase the separation between the equipment and receiver.
- Connect the equipment into an outlet on a circuit different from that to which the receiver is connected.
- Consult the dealer or an experienced radio/TV technician for help.

The device has been evaluated to meet general RF exposure requirement. The device can be used in portable exposure condition without restriction