

1.Product Introduction

Screen hanging light, using long aspect design, wide luminous effect, five color temperature adjustable, no video flash, light clear and comfortable, with Bluetooth sound.

2.Product Features

- 1.Five color temperature adjustment
- 2.Bluetooth
- 3.Sedentary reminder mode
- 4.Flicker Free
- 5.Lamp Head Angle Adjustment

3.Product Parts List

LED Desk Lamp	*1
User Manual	*1

4.Product Parameters

Product model: TB-300SFBT
Product material: ABS+Metal
Product color: black
Rated voltage: 5V ---
Product power:
5W (48X0, 5W/LED+6x0, 2W/LED module)
Rated current: 1A ---
Light source: LED
Color rendering index (Ra) : >80
Working temperature: -5 ~ +45
Color temperature:
3000K-4050K-4450K-4900K-7150K
Illuminance (LUX) : ≈700
Product weight: ≈495g
Product size: 420*135*110MM
Packing size: 438*136*76MM

5.Product Part Name

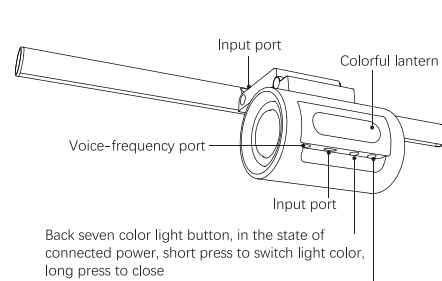
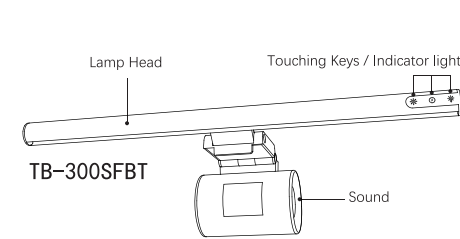

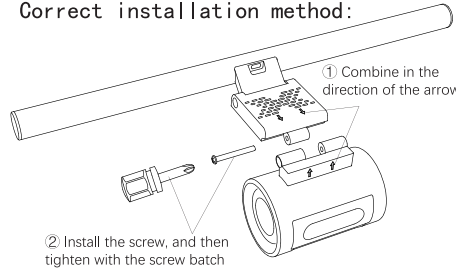

Bluetooth on key, when connected to the power, long press (turn Bluetooth on or off), when connected to Bluetooth and play music, short press (pause or continue to play)

Correct installation method:



6.Product Instructions

(1): Connect the USB cable to your computer or adapter and connect the product to the other end, Indicator light is white.

(2): TB-300SFBT: Press  by hand for about 1 second to turn on the screen hanging light, then press to turn off the screen hanging light. With the screen light on, press  to switch the light color. When the screen light is on, short press  to adjust the brightness, long press this key for 3 seconds to enter the sedentary reminder mode, then the indicator will light up green, every hour or so, the screen light will breathe to remind attention to rest, and then long press for 3 seconds to turn off the sedentary reminder mode.

(3): Bluetooth connection: Long press the Bluetooth key to turn on Bluetooth, find "TB-300SFBT" in the Bluetooth pairing of the phone and click to connect.

(4): The product has an audio port, connect one end of the audio cable to the audio port, and connect the other end to the computer /MP3/MP4 and other audio devices.

(5): The operation method is as the following sketch.

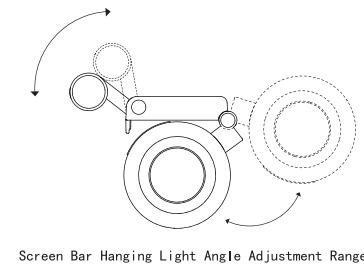
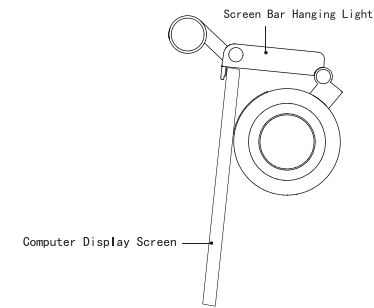

7. Notes

Warning:

- 1.The product does not have waterproof function, do not use it in a wet environment.
- 2.Please do not disassemble the product by yourself.
- 3.To avoid danger,do not cover the product.
- 4.Keep children away from the lamp,this product is not a children's lamp/toy.
- 5.Cut off the power supply quickly in case of abnormal phenomenon,and contact with the seller.

Note:

- 1.The light source of the secondary lamp is not replaceable. When the light source reaches the end of its life, the whole lamp should be replaced.
- 2.SELV LED with CCC certification is powered by AC electronic control device.
- 3.This product is suitable for indoor use.

This device complies with part 15 of the FCC Rules. Operation is subject to the following two conditions: (1) This device may not cause harmful interference, and (2) this device must accept any interference received, including interference that may cause undesired operation.

Any Changes or modifications not expressly approved by the party responsible for compliance could void the user's authority to operate the equipment.

Note: This equipment has been tested and found to comply with the limits for a Class B digital device, pursuant to part 15 of the FCC Rules. These limits are designed to provide reasonable protection against harmful interference in a residential installation. This equipment generates uses and can radiate radio frequency energy and, if not installed and used in accordance with the instructions, may cause harmful interference to radio communications. However, there is no guarantee that interference will not occur in a particular installation. If this equipment does cause harmful interference to radio or television reception, which can be determined by turning the equipment off and on, the user is encouraged to try to correct the interference by one or more of the following measures:

- Reorient or relocate the receiving antenna.
- Increase the separation between the equipment and receiver.
- Connect the equipment into an outlet on a circuit different from that to which the receiver is connected.
- Consult the dealer or an experienced radio/TV technician for help.

FCC Radiation Exposure statement

The device has been evaluatec to meel general RF exposure requirement. The device can be used in portable exposure condition without restriction.