

尺寸: 90x45mm 长x宽
版本号: V1.1

正面

DOMRAEM 2.4G LED Controller DOM-WLE-AM



Scan to view the detail manual
Email: domraem@163.com



SUCCESS COURIER SL

CALLE RIO TORMES NUM.1, PLANTA 1, DERECHA
OFICINA 3, Fuenlabrada, Madrid, 28947 Spain
successservice2@hotmail.com

DOM-WLE-0001_V1.3



After resetting the product, the LED strip will not illuminate. Please do not be concerned, as this is designed to reduce power consumption. After reconfiguration, power off and restart, it can be used normally! Additionally, if the controller indicator is on but the LED strip still does not work, you may also try this method.

Here are the specific steps: In your phone's WiFi settings, locate the hotspot "WLED-AP" and tap to access the configuration page for setup. For more detailed instructions, please scan the QR code and refer to pages 16-20 of the user manual.

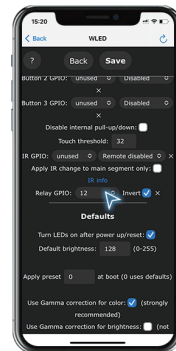

The configuration method is as follows:
Relay GPIO: 12 "invert" ✓

反面

Wiring Terminal instructions:

The WLED controller supports three output channels. The terminal connections "G D V" correspond to the "GND, DATA, VCC" pins of the digital LED strips.

Product Model: DOM-WLE-ADM / DOM-WLE-AM / DOM-WLE-A
Module: ESP32

LED Strip Interface: GPIO16 (default output group, prioritize use) and GPIO2 (requires configuration via the APP).

Extended Interface: GPIO33 (used for connecting PUSH switches or sensors, requires configuration via the APP).

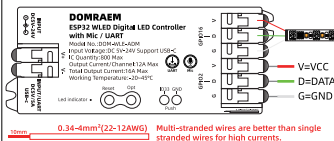

The button functions of WLED products are as follows:

Reset:

Pressing the button will power off the controller module. releasing it will power it back on. Useful when the controller needs to be restarted after configuring the microphone.

Opt:

1. Short press: Power on/off.
2. Long press for 1 second to switch colors.
3. Long press for more than 10 seconds: The WLED device will be reset to factory settings and the WLED-AP hotspot will be activated. Do not use unless it is an emergency! If the factory settings have been restored, please refer to the instruction manual to configure the device correctly.

Note: GPIO16 and GPIO2 are the default output ports; after the controller is reset, the lights connected to these two ports may flash.

Firmware update (OTA):

Please perform the firmware update carefully, and you must select the correct file. Otherwise, this may cause functional abnormalities or even damage to the device. For details, please scan the QR code to refer to the OTA instructions.



1. The controller does not change the voltage, the power supply needs to be selected based on the voltage and current requirements of the LED strip.
2. Before turning on the power, please ensure that all wiring is correct and secure. Do not operate while the power is on.
3. Please use wires with good conductivity and ensure secure connections to prevent excessive current from causing high temperatures.



This device complies with part 15 of the FCC Rules. Operation is subject to the following two conditions: (1) This device may not cause harmful interference, and (2) this device must accept any interference received, including interference that may cause undesired operation.

Any Changes or modifications not expressly approved by the party responsible for compliance could void the user's authority to operate the equipment.

Note: This equipment has been tested and found to comply with the limits for a Class B digital device, pursuant to part 15 of the FCC Rules. These limits are designed to provide reasonable protection against harmful interference in a residential installation. This equipment generates uses and can radiate radio frequency energy and, if not installed and used in accordance with the instructions, may cause harmful interference to radio communications. However, there is no guarantee that interference will not occur in a particular installation. If this equipment does cause harmful interference to radio or television reception, which can be determined by turning the equipment off and on, the user is encouraged to try to correct the interference by one or more of the following measures:

- Reorient or relocate the receiving antenna.
- Increase the separation between the equipment and receiver.
- Connect the equipment into an outlet on a circuit different from that to which the receiver is connected.
- Consult the dealer or an experienced radio/TV technician for help.
- This equipment complies with FCC radiation exposure limits set forth for an uncontrolled environment. This equipment should be installed and operated with minimum distance 20cm between the radiator & your body.